

NEW MEXICO OIL CONSERVATION COMMISSION

Well Location and Acreage Dedication Plat

Section A.

Date May 29. 58
Operator Gulf Oil Corp Lease W. A. Ramasy NCT-A 51
Well No. 43 Unit Letter C Section 27 Township 21 S Range 36 E NMPM
Located 660 Feet From North Line, 1980 Feet From West Line
County Lea G. L. Elevation _____ Dedicated Acreage 40 Acres
Name of Producing Formation Queen Pool Eumont

1. Is the Operator the only owner* in the dedicated acreage outlined on the plat below?
Yes X No _____.
2. If the answer to question one is "no," have the interests of all the owners been consolidated by communitization agreement or otherwise? Yes _____ No _____. If answer is "yes," Type of Consolidation _____
3. If the answer to question two is "no," list all the owners and their respective interests below:

Owner

Land Description

Section B

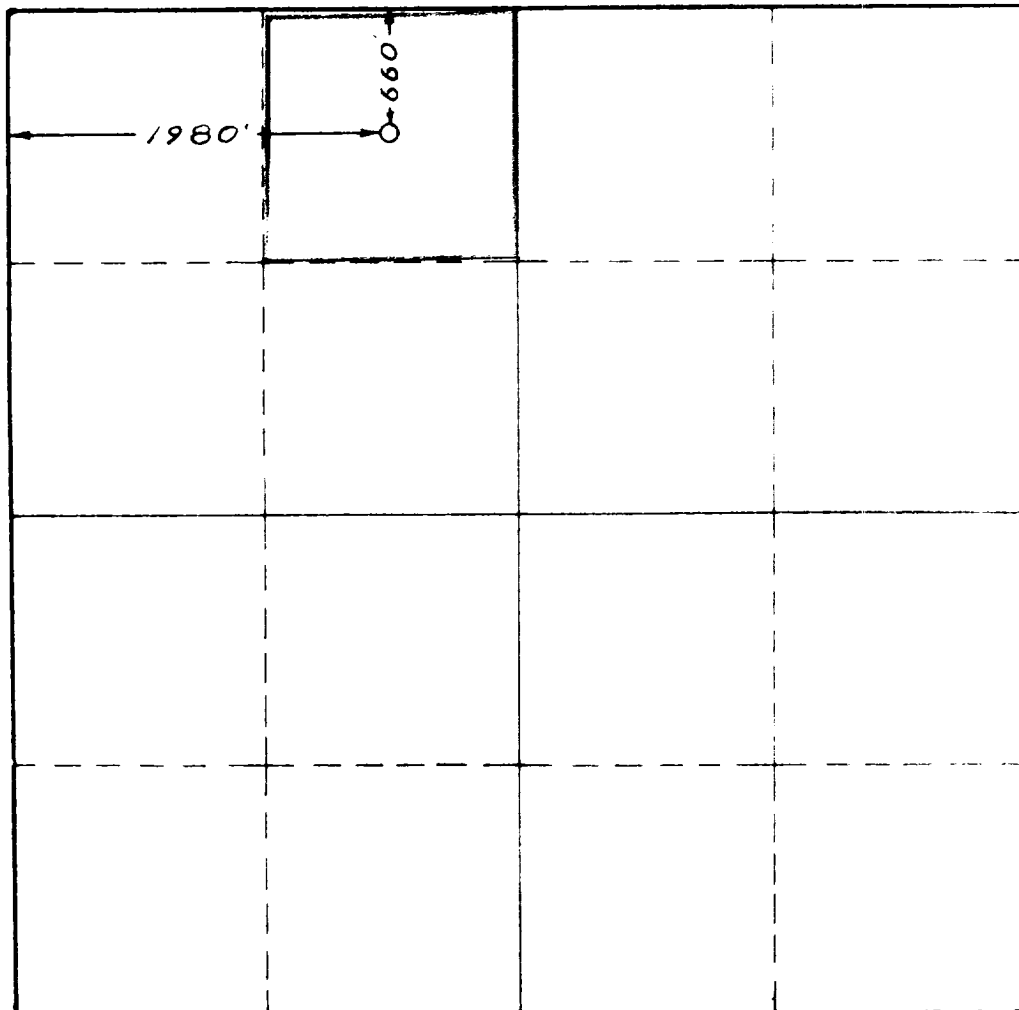

This is to certify that the information in Section A above is true and complete to the best of my knowledge and belief.

Gulf Oil Corporation

(Operator)

John Russell

(Representative)

Ass't Area Production Supt.

Box 2167 - Hobbs, New Mexico

Address

This is to certify that the well location shown on the plat in Section B was plotted from field notes of actual surveys made by me or under my supervision and that the same is true and correct to the best of my knowledge and belief.

Date Surveyed May 29. 58

John W. West

Registered Professional Engineer and/or Land Surveyor.

0 300 660 990 1320 1680 1980 2340 2640 2900 3200 3500 3800 4100 4400 4700 5000 5300 5600 5900 6200 6500 6800 7100 7400 7700 8000 8300 8600 8900 9200 9500 9800 10100 10400 10700 11000 11300 11600 11900 12200 12500 12800 13100 13400 13700 14000 14300 14600 14900 15200 15500 15800 16100 16400 16700 17000 17300 17600 17900 18200 18500 18800 19100 19400 19700 20000

Certificate No. 676

(See instructions for completion this form on the reverse side)