

NEW MEXICO OIL CONSERVATION COMMISSION

Santa Fe, New Mexico

NOTICE OF INTENTION TO DRILL

Notice must be given to the Oil Conservation Commission or its proper agent and approval obtained before drilling begins. If changes in the proposed plan are considered advisable, a copy of this notice showing such changes will be returned to the sender. Submit this notice in triplicate. One copy will be returned following approval. See additional instructions in Rules and Regulations of the Commission.

Midland, Texas,

Jan. 8, 1934

OIL CONSERVATION COMMISSION,
Santa Fe, New Mexico

Place

Date

Gentlemen:

You are hereby notified that it is our intention to commence the drilling of a well to be known as
Humble Oil & Refining Co., N. M. State "B" Well No. **8** in **SE/4 of SE/4**

Company or Operator **Humble** Lease **B-255** Field, **Lea** County.
of Sec. **29**, T. **21-S**, R. **34-E**, N. M. P. M., **640** feet [N.] [S.] of the **South** line and **600** feet
N. [E.] [W.] of the **East** line of **Section 29**

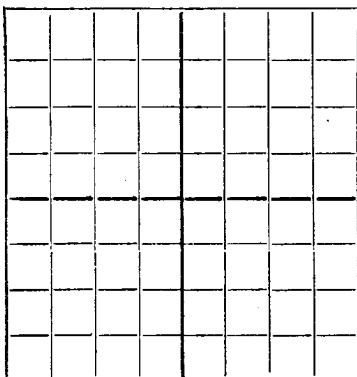

AREA 640 ACRES
LOCATE WELL CORRECTLY

The well is **640** feet [N.] [S.] of the **South** line and **600** feet
[E.] [W.] of the **East** line of **Section 29**

(Give location from section or other legal subdivision lines. Cross out wrong directions.)

If state land the oil and gas lease is No. **B-255** Assignment No. **-**

If patented land the owner is _____

Address _____

If government land the permittee is _____

Address _____

The lessee is **Humble Oil & Refining Company**

Address **Houston, Texas**

We propose to drill well with drilling equipment as follows: _____

Rotary Rig

The status of a bond for this well in conformance with Rule 39 of the General Rules and Regulations of the Commission
Now on file in Commission Office
is as follows: _____

We propose to use the following strings of casing and to land or cement them as indicated:

Size of Hole	Size of Casing	Weight Per Foot	New or Second Hand	Depth	Landed or Cemented	Sacks Cement
17-1/2	15"	50#	Second-hand	250'	Cemented	180
12-1/4	8-5/8"	32#	"	1700'	"	950
6-3/4	5-1/2"	17#	New	5850'	"	125

If changes in the above plan become advisable we will notify you before cementing or landing casing. We estimate
that the first productive oil or gas sand should occur at a depth of about **5900** feet.

Additional information: _____

Approved _____, 19____
except as follows: _____

Sincerely yours,

Humble Oil & Refining Company

Company or Operator
By **R. C. Barbour**

Position **Division Superintendent**

Send communication regarding well to

Name **R. C. Barbour**

Address **Drawer W, Midland, Texas**

OIL CONSERVATION COMMISSION,

By _____

Title _____

1. *Chlorophyll a* and *Chlorophyll b* contents were determined by spectrophotometry using the method of Lichtenthal and Whistler (1987).

[illegible]

Figure 1

[illegible]

Figure 1. The effect of the concentration of the *Agrobacterium* suspension on the transformation efficiency of *Agrobacterium* strains.

Figure 1. The effect of the concentration of the *Agrobacterium* suspension on the transformation efficiency of *Agrobacterium* strains.

$\frac{d}{dt} \left(\frac{\partial L}{\partial \dot{x}} \right) = \frac{\partial L}{\partial x}$	$\frac{d}{dt} \left(\frac{\partial L}{\partial \dot{y}} \right) = \frac{\partial L}{\partial y}$	$\frac{d}{dt} \left(\frac{\partial L}{\partial \dot{z}} \right) = \frac{\partial L}{\partial z}$	$\frac{d}{dt} \left(\frac{\partial L}{\partial \dot{\theta}} \right) = \frac{\partial L}{\partial \theta}$	$\frac{d}{dt} \left(\frac{\partial L}{\partial \dot{\phi}} \right) = \frac{\partial L}{\partial \phi}$	$\frac{d}{dt} \left(\frac{\partial L}{\partial \dot{\psi}} \right) = \frac{\partial L}{\partial \psi}$
$\frac{d}{dt} \left(\frac{\partial L}{\partial \dot{x}} \right) = -\frac{\partial V}{\partial x}$	$\frac{d}{dt} \left(\frac{\partial L}{\partial \dot{y}} \right) = -\frac{\partial V}{\partial y}$	$\frac{d}{dt} \left(\frac{\partial L}{\partial \dot{z}} \right) = -\frac{\partial V}{\partial z}$	$\frac{d}{dt} \left(\frac{\partial L}{\partial \dot{\theta}} \right) = -\frac{\partial V}{\partial \theta}$	$\frac{d}{dt} \left(\frac{\partial L}{\partial \dot{\phi}} \right) = -\frac{\partial V}{\partial \phi}$	$\frac{d}{dt} \left(\frac{\partial L}{\partial \dot{\psi}} \right) = -\frac{\partial V}{\partial \psi}$

10-10-76

100-443887-100

[illegible]

1997年12月29日，在《人民日报》第1版刊登了《中共中央、国务院关于加强和改进党的作风建设的决定》。

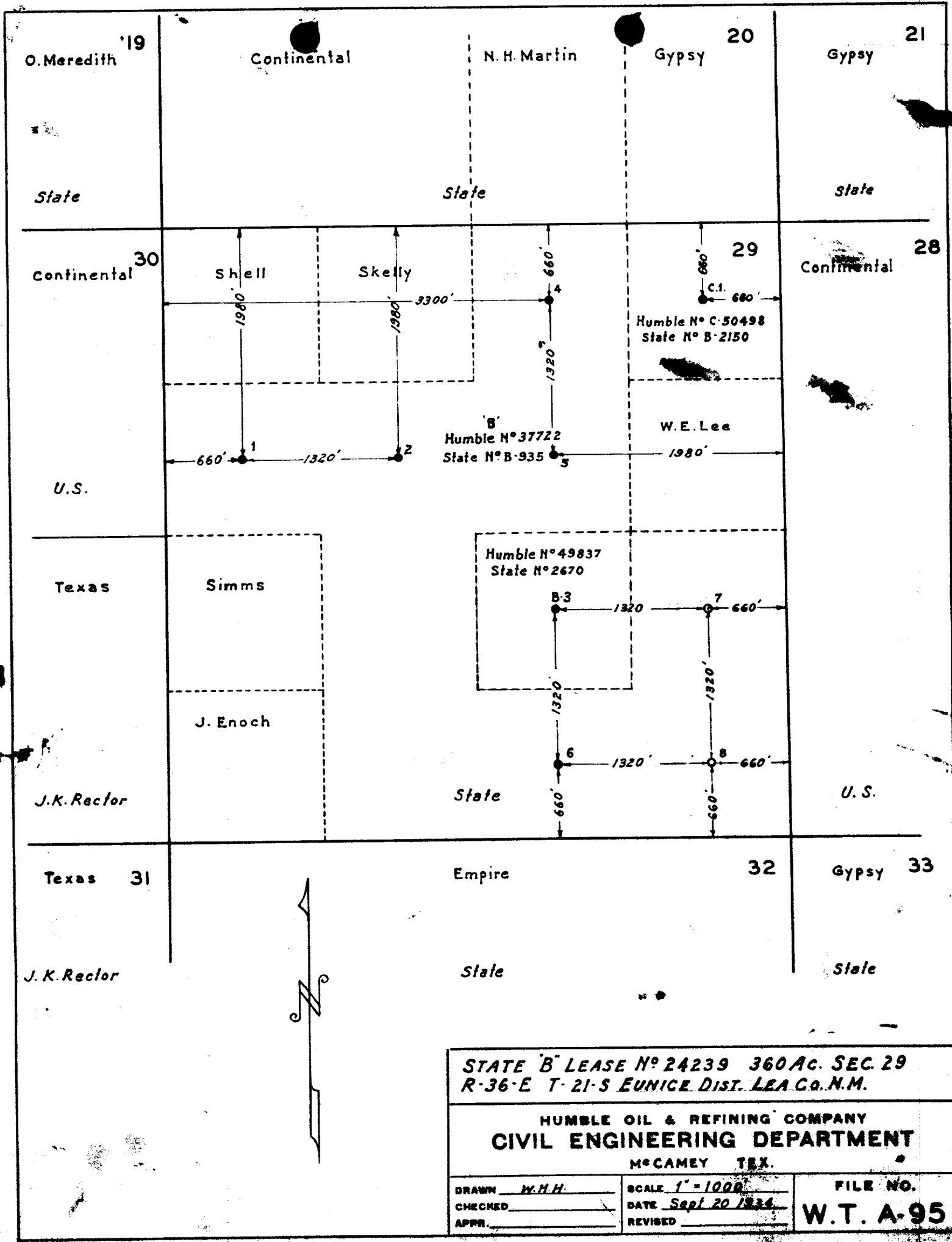

STATE B LEASE N° 24239 360 AC. SEC. 29
R-36-E T-21-S EUNICE DIST. LEA Co. N.M.

HUMBLE OIL & REFINING COMPANY
CIVIL ENGINEERING DEPARTMENT

MOCAMEY TEX.

DRAWN W.H.H.
CHECKED _____
APPR. _____

SCALE 1" = 1000'
DATE Sept 20 1934
REVISED _____

FILE NO.
W.T. A-95

