

NEW MEXICO
OIL CONSERVATION COMMISSION

Form C-128

Well Location and/or Gas Exploration Plat

Date 10-12-56

Operator Continental Oil Co. 1956 OCT 23 Lease 9: 69 Blockhart B-30

Well No. 2 Section 30 Township 21 S Range 36 E NMPM

Located 990 Feet From South Line, 660 Feet From West Line,

Lea County, New Mexico. G. L. Elevation _____

Name of Producing Formation _____ Pool _____ Dedicated Acreage _____

(Note: All distances must be from outer boundaries of Section)

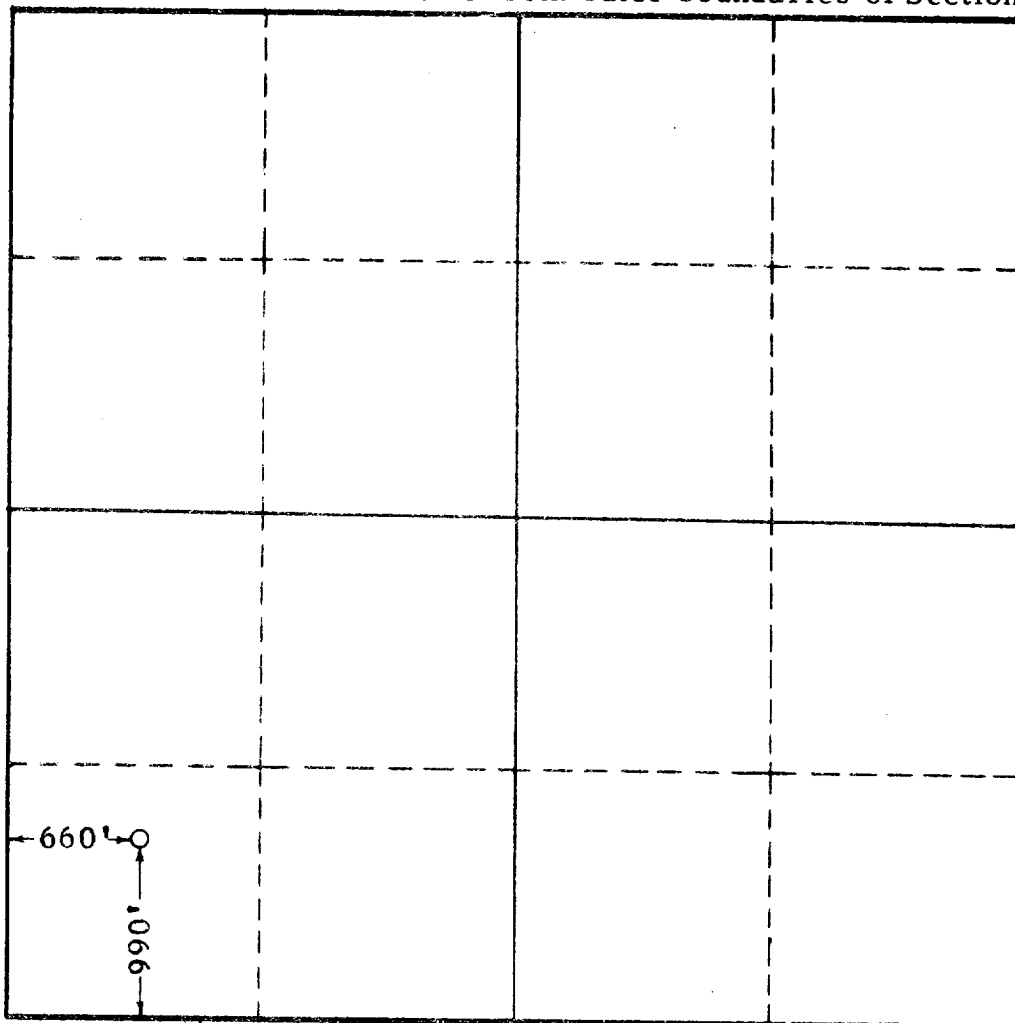

SCALE: 1" = 1000'

1. Is this Well a Dual Comp. ? Yes ☐ No ☐.
2. If the answer to Question 1 is yes, are there any other dually completed wells within the dedicated acreage ? Yes ☐ No ☐.

This is to certify that the above plat was prepared from field notes of actual surveys made by me or under my supervision and that the same are true and correct to the best of my knowledge and belief.

Name _____
Position _____
Representing _____
Address _____

Date Surveyed 10-11-56

Registered John W. West
Professional Engineer and/or
Land Surveyor



IN REPLY REFER TO:

UNITED STATES
DEPARTMENT OF THE INTERIOR
GEOLOGICAL SURVEY

P. O. Box 1838
Hobbs, New Mexico

October 19, 1956

Continental Oil Company
Box 427
Hobbs, New Mexico

Re: Lease Las Cruces 032099(b)

Gentlemen:

Receipt is acknowledged of "Notice of Intention to Drill" dated October 12, 1956, covering your well No. 2 Leachart B-30 on the subject leasehold in the SW $\frac{1}{4}$ SW $\frac{1}{4}$ sec. 30, T. 21 S., R. 36 E., N.M.P.M., Elephant Pool, Lea County, New Mexico.

Your proposed work is approved subject to compliance with the provisions of the "Oil and Gas Operating Regulations" revised May 25, 1942, copy of which will be furnished you on request, and subject to the following condition:

1. Drilling operations so authorized are subject to the attached sheet (revised February 1955) for general conditions of approval.

Very truly yours,

H. A. DuPont
District Engineer

UNITED STATES
DEPARTMENT OF THE INTERIOR
GEOLOGICAL SURVEY

1. *Chlorophyll a* and *Chlorophyll b* contents were determined by the method of Lichtenthaler and Whistler (1973). The total protein content was determined by the method of Lowry (1956).

