

NEW MEXICO
OIL CONSERVATION COMMISSION

Form C-128

Well Location and/or Gas Proration Plat

Date 10-6-56

Operator Cities Service Oil Co.

Lease State "D"

Well No. 6 Section 32 Township 21 S Range 36 E NMPM

Located 1980 Feet From North Line, 1980 Feet From West Line,

Lea County, New Mexico. G. L. Elevation 3625

Name of Producing Formation Seven Rivers Pool Eumont Dedicated Acreage 40

(Note: All distances must be from outer boundaries of Section)

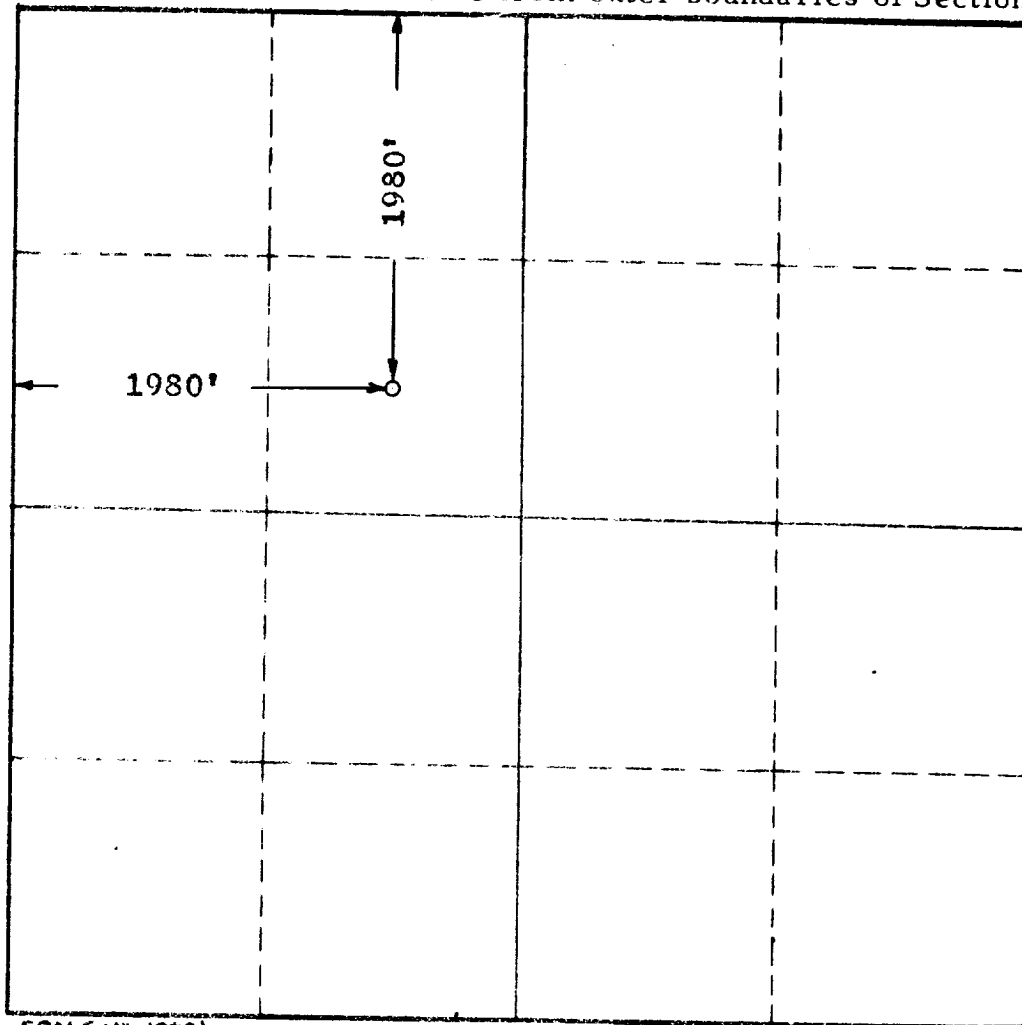

SCALE: 1"=1000'

1. Is this Well a Dual Comp. ? Yes No .
2. If the answer to Question 1 is yes, are there any other dually completed wells within the dedicated acreage ? Yes No .

This is to certify that the above plat was prepared from field notes of actual surveys made by me or under my supervision and that the same are true and correct to the best of my knowledge and belief.

Name
Position
Representing
Address

Date Surveyed 10-6-56

John W. West
Registered Professional Engineer and/or
Land Surveyor