

NEW MEXICO  
OIL CONSERVATION COMMISSION

Form C-128

Well Location and/or Gas Proration Plat

Date November 24, 1956

Operator J. H. MOORE

Lease TECH-STATE  
NOV 27 AM 9:49

Well No. 2 Section 32 Township 21S Range 36E NMPM

Located 1,980 Feet From West Line, 1,880 Feet From South Line,

Lea County, New Mexico. G. L. Elevation Est. 8,615'

Name of Producing Formation Yates Pool Jalisco Dedicated Acreage 160

(Note: All distances must be from outer boundaries of Section)

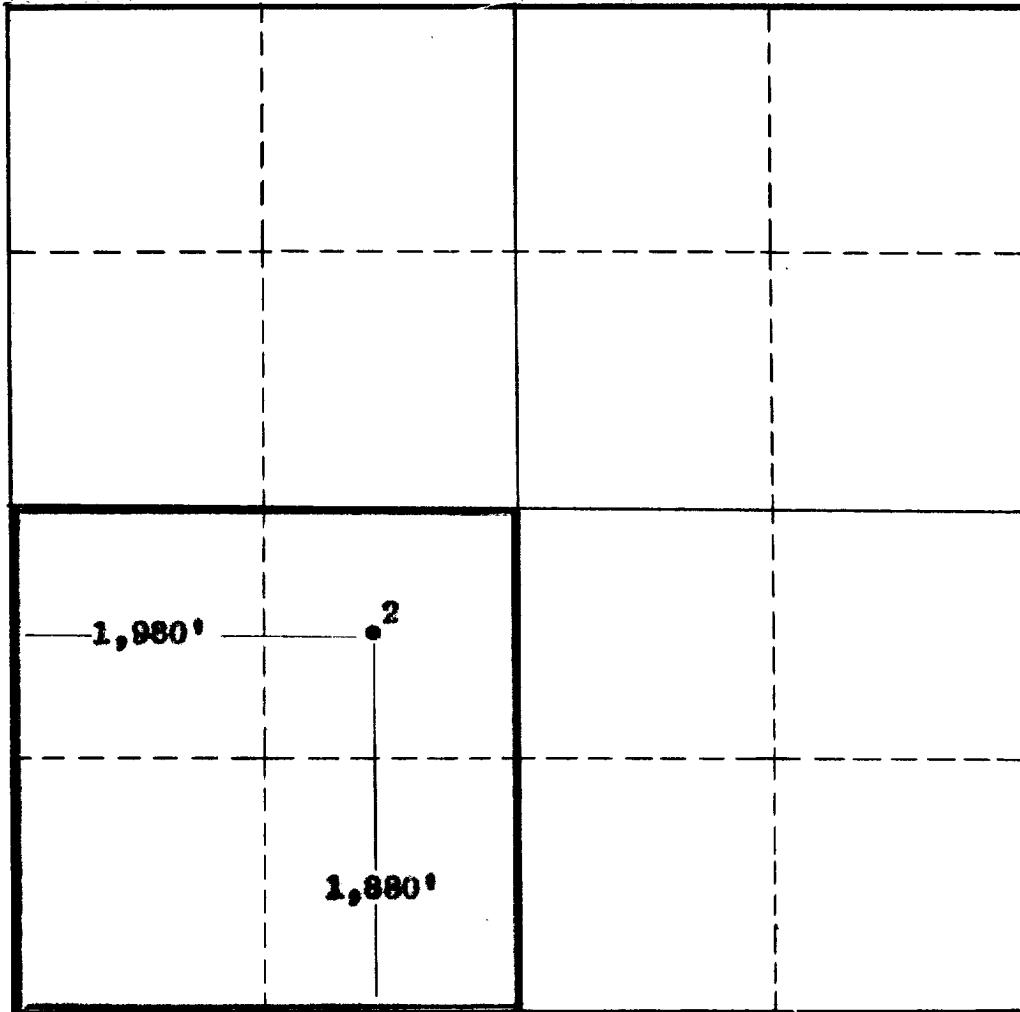

SCALE: 1"=1000'

1. Is this Well a Dual Comp. ? Yes X No     .
2. If the answer to Question 1 is yes, are there any other dually completed wells within the dedicated acreage ? Yes      No X.

This is to certify that the above plat was prepared from field notes of actual surveys made by me or under my supervision and that the same are true and correct to the best of my knowledge and belief.

Name                       
Position OPERATOR  
Representing J. H. MOORE  
Address BOX 1537, HOBBS, NEW MEXICO

Date Surveyed November 20, 1956  
John N. West  
Registered Professional Engineer and/or  
Land Surveyor