

Submit 5 Copies
Appropriate District Office
DISTRICT I
P.O. Box 1980, Hobbs, NM 88240

DISTRICT II
P.O. Drawer DD, Artesia, NM 88210

DISTRICT III
1000 Rio Brazos Rd., Aztec, NM 87410

State of New Mexico
Energy, Minerals and Natural Resources Department

OIL CONSERVATION DIVISION
P.O. Box 2088
Santa Fe, New Mexico 87504-2088

Form C-104
Revised 1-1-89
See Instructions
at Bottom of Page

REQUEST FOR ALLOWABLE AND AUTHORIZATION
TO TRANSPORT OIL AND NATURAL GAS

Operator Shell Western E. & P. Inc.		Well API No. 30-025-06351
Address P. O. Box 576, Houston, TX 77001		
Reason(s) for Filing (Check proper box) New Well <input type="checkbox"/> <input checked="" type="checkbox"/> Other (Please explain) Recompletion <input type="checkbox"/> Change in Transporter of: Change in Operator <input checked="" type="checkbox"/> Oil <input type="checkbox"/> Dry Gas <input type="checkbox"/> Casinghead Gas <input type="checkbox"/> Condensate <input type="checkbox"/> Effective date 8-1-90 Change lease name from Harry Leonard NCT-F		
If change of operator give name and address of previous operator Chevron U.S.A. Inc. P.O. Box 1150, Midland, TX 79702		

II. DESCRIPTION OF WELL AND LEASE

Lease Name Harry F. Leonard "F"	Well No. 7	Pool Name, Including Formation Blinbry Oil and Gas	Kind of Lease State, Federal or Free	Lease No.
Location Unit Letter <u>I</u> : <u>4302.8</u> Feet From The <u>South</u> Line and <u>2317</u> Feet From The <u>East</u> Line Section <u>2</u> Township <u>21S</u> Range <u>37E</u> , <u>NMPM</u> , <u>Lea</u> County				

III. DESIGNATION OF TRANSPORTER OF OIL AND NATURAL GAS

Name of Authorized Transporter of Oil Shell Pipeline <input checked="" type="checkbox"/> or Condensate <input type="checkbox"/>	Address (Give address to which approved copy of this form is to be sent) P. O. Box 1910, Midland, TX 79701	
Name of Authorized Transporter of Casinghead Gas Warren Petroleum Co. / Texaco Prod. Co. <input checked="" type="checkbox"/> or Dry Gas <input type="checkbox"/>	Address (Give address to which approved copy of this form is to be sent) Box 1909, Eunice N.M. 88231/Box 3000, Tulsa	
If well produces oil or liquids, give location of tanks. Unit <u>0</u> Sec. <u>2</u> Twp. <u>21S</u> Rge. <u>37E</u>	Is gas actually connected? <input type="checkbox"/>	When? O.K. 74102

If this production is commingling with that from any other lease or pool, give commingling order number:

IV. COMPLETION DATA

Designate Type of Completion - (X)	Oil Well	Gas Well	New Well	Workover	Deepen	Plug Back	Same Res'v	Diff Res'v
Date Spudded	Date Compl. Ready to Prod.		Total Depth		P.B.T.D.			
Elevations (DF, RKB, RT, GR, etc.)	Name of Producing Formation		Top Oil/Gas Pay		Tubing Depth			
Perforations					Depth Casing Shoe			
TUBING, CASING AND CEMENTING RECORD								
HOLE SIZE	CASING & TUBING SIZE		DEPTH SET		SACKS CEMENT			

V. TEST DATA AND REQUEST FOR ALLOWABLE

OIL WELL (Test must be after recovery of total volume of load oil and must be equal to or exceed top allowable for this depth or be for full 24 hours.)

Date First New Oil Run To Tank	Date of Test	Producing Method (Flow, pump, gas lift, etc.)	
Length of Test	Tubing Pressure	Casing Pressure	Choke Size
Actual Prod. During Test	Oil - Bbls.	Water - Bbls.	Gas - MCF

GAS WELL

Actual Prod. Test - MCF/D	Length of Test	Bbls. Condensate/MMCF	Gravity of Condensate
Testing Method (pilot, back pr.)	Tubing Pressure (Shut-in)	Casing Pressure (Shut-in)	Choke Size

VI. OPERATOR CERTIFICATE OF COMPLIANCE

I hereby certify that the rules and regulations of the Oil Conservation Division have been complied with and that the information given above is true and complete to the best of my knowledge and belief.

Signature J. H. Smitherman
Printed Name J. H. Smitherman, Regulatory Supervisor
Date 3/13/91 Title 713-870-3210
Telephone No.

OIL CONSERVATION DIVISION

Date Approved APR 01 1991

By ORIGINAL BY DE LOREY SEXTON

Title REGULATORY SUPERVISOR

INSTRUCTIONS: This form is to be filed in compliance with Rule 1104

- 1) Request for allowable for newly drilled or deepened well must be accompanied by tabulation of deviation tests taken in accordance with Rule 111.
- 2) All sections of this form must be filled out for allowable on new and recompleted wells.
- 3) Fill out only Sections I, II, III, and VI for changes of operator, well name or number, transporter, or other such changes.

Submit to Appropriate
District Office
State Lease - 4 copies
Fee Lease - 3 copies

State of New Mexico
Energy, Minerals and Natural Resources Department

Form C-102
Revised 1-1-89

OIL CONSERVATION DIVISION

P.O. Box 2088
Santa Fe, New Mexico 87504-2088

DISTRICT I
P.O. Box 1980, Hobbs, NM 88240

DISTRICT II
P.O. Drawer DD, Artesia, NM 88210

DISTRICT III
1000 Rio Brazos Rd., Aztec, NM 87410

WELL LOCATION AND ACREAGE DEDICATION PLAT

All Distances must be from the outer boundaries of the section

Operator SHELL WESTERN E&P INC.			Lease HARRY F. LEONARD "F"		Well No. 7
Unit Letter J	Section 2	Township 21S	Range 37E	NMPM	County LEA
Actual Footage Location of Well: 4302.8 feet from the SOUTH line and 2317 feet from the EAST line					
Ground level Elev. 3496'		Producing Formation BLINEBRY		Pool BLINEBRY OIL & GAS	Dedicated Acreage: 40 Acres

1. Outline the acreage dedicated to the subject well by colored pencil or hatchure marks on the plat below.
2. If more than one lease is dedicated to the well, outline each and identify the ownership thereof (both as to working interest and royalty).
3. If more than one lease of different ownership is dedicated to the well, have the interest of all owners been consolidated by communitization, unitization, force-pooling, etc.?
☐ Yes ☐ No If answer is "yes" type of consolidation _____
If answer is "no" list the owners and tract descriptions which have actually been consolidated. (Use reverse side of this form if necessary). _____
No allowable will be assigned to the well until all interests have been consolidated (by communitization, unitization, forced-pooling, or otherwise) or until a non-standard unit, eliminating such interest, has been approved by the Division.

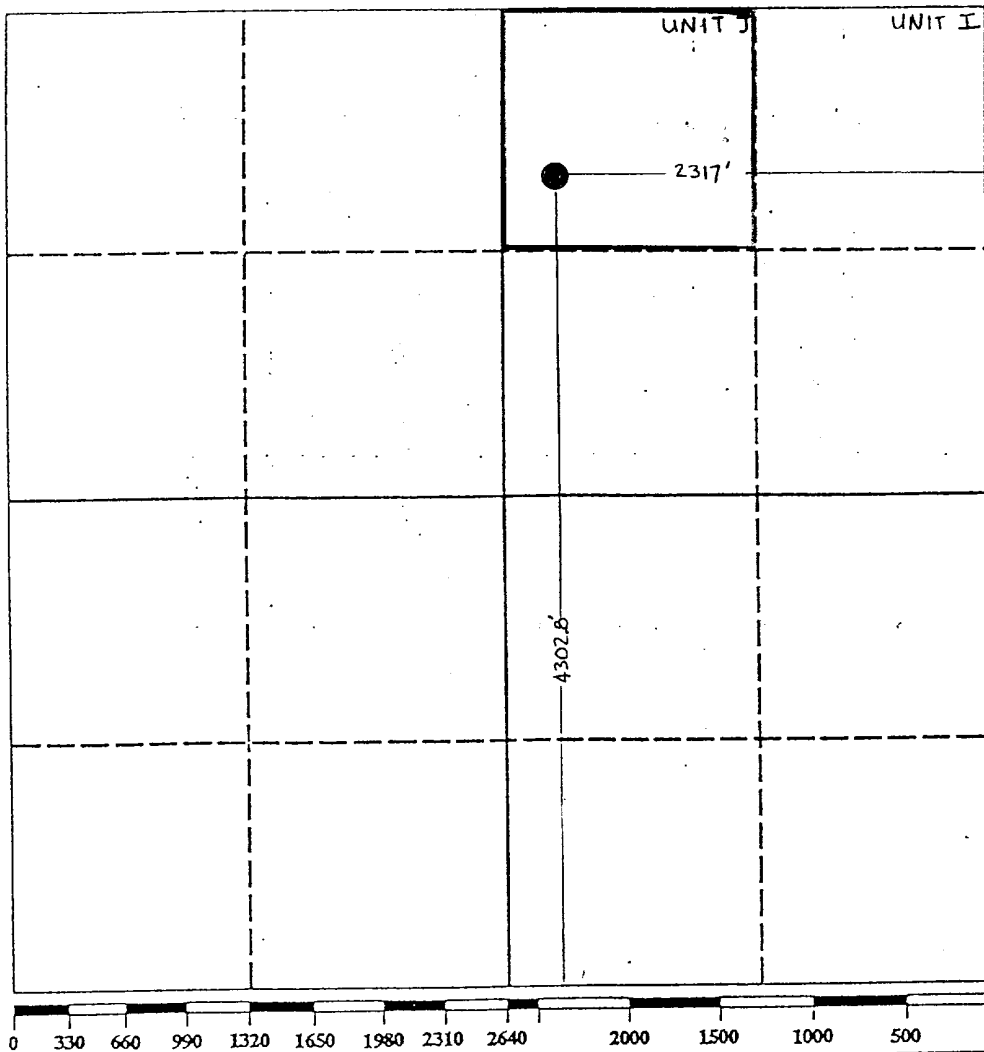

OPERATOR CERTIFICATION

I hereby certify that the information contained herein is true and complete to the best of my knowledge and belief.

Signature
J. H. Smitherman
Printed Name
J. H. SMITHERMAN
Position
REGULATORY SUPV.
Company
SHELL WESTERN E&P INC.
Date
3-26-91

SURVEYOR CERTIFICATION

I hereby certify that the well location shown on this plat was plotted from field notes of actual surveys made by me or under my supervision, and that the same is true and correct to the best of my knowledge and belief.

Date Surveyed

Signature & Seal of
Professional Surveyor

Certificate No.

RECEIVED

MAR 29 1991

LIBRARY
HOBBS