

DISTRICT I  
P.O. Box 1980, Hobbs, NM 88240

DISTRICT II  
P.O. Drawer DD, Artesia, NM 88210

DISTRICT III  
1000 Rio Brazos Rd., Aztec, NM 87410

OIL CONSERVATION DIVISION

P.O. Box 2088  
Santa Fe, New Mexico 87504-2088

WELL API NO.

5. Indicate Type of Lease  
STATE ☒ FEE ☐

6. State Oil & Gas Lease No.

SUNDRY NOTICES AND REPORTS ON WELLS  
(DO NOT USE THIS FORM FOR PROPOSALS TO DRILL OR TO DEEPEN OR PLUG BACK TO A  
DIFFERENT RESERVOIR. USE "APPLICATION FOR PERMIT"  
(FORM G-101) FOR SUCH PROPOSALS.)

1. Type of Well:  
OIL WELL ☒ GAS WELL ☐ OTHER

2. Name of Operator  
SHELL WESTERN E & P INC. (4431 WCK)

3. Address of Operator  
P.O. BOX 576, Houston, TX 77001-0576

7. Lease Name or Unit Agreement Name  
NORTHEAST DRINKARD UNIT

8. Well No.  
319

9. Pool name or Wildcat  
NORTH LUNICE BLINEBRY-TUBB-  
DRINKARD OIL & GAS

4. Well Location  
Unit Letter Q : 1650 Feet From The South Line and 990 Feet From The East Line  
Section 2 Township 21-S Range 37-E NMPM Lea County

10. Elevation (Show whether DF, RKB, RT, GR, etc.)  
3481' GR

11. Check Appropriate Box to Indicate Nature of Notice, Report, or Other Data

NOTICE OF INTENTION TO:

PERFORM REMEDIAL WORK ☐ PLUG AND ABANDON ☐  
TEMPORARILY ABANDON ☐ CHANGE PLANS ☐  
PULL OR ALTER CASING ☐  
OTHER: ☐

SUBSEQUENT REPORT OF:

REMEDIAL WORK ☐ ALTERING CASING ☐  
COMMENCE DRILLING OPNS. ☐ PLUG AND ABANDONMENT ☐  
CASING TEST AND CEMENT JOB ☐  
OTHER: Recomplete from Wantz Abo to unitized intervals ☒

12. Describe Proposed or Completed Operations (Clearly state all pertinent details, and give pertinent dates, including estimated date of starting any proposed work) SEE RULE 1103.

9-9-88 thru 9-15-88:

POOH w/ prod equip. Perf Blinebry/Tubb/Drinkard 5786' - 6888' w/ 1JSPF. Selectively  
AT Blinebry/Tubb/Drinkard 5786' - 6888' w/ 11,550 gals 15% HCl acid + 1050# rock salt +  
37 ball sealers, using RBP's and pkr's. RIH w/ prod equip.  
Returned well to production 9-15-88.

10-15-88:

24 hr test: 32 bbl oil + 9 bbl water + 45 mcf gas.

I hereby certify that the information above is true and complete to the best of my knowledge and belief.

SIGNATURE A.J. Fore A.J. FORE TITLE SUPV. REG. & PERMITTING DATE FEB 2 1989

TYPE OR PRINT NAME

TELEPHONE NO.

(This space for State Use)

Orig. Signed by  
Paul Kautz  
Geologist

APPROVED BY

TITLE

DATE

CONDITIONS OF APPROVAL, IF ANY:

FEB 06 1989

RECEIVED

FEB 6 1995

OCD  
HOBBS OFFICE

Submit to Appropriate  
District Office  
State Lease - 6 copies  
Fee Lease - 5 copies

DISTRICT I  
P.O. Box 1980, Hobbs, NM 88240

DISTRICT II  
P.O. Drawer DD, Artesia, NM 88210

DISTRICT III  
1000 Rio Brazos Rd., Aztec, NM 87410

State of New Mexico  
Energy, Minerals and Natural Resources Department

Form C-105  
Revised 1-1-89

OIL CONSERVATION DIVISION

P.O. Box 2088  
Santa Fe, New Mexico 87504-2088

WELL API NO.
5. Indicate Type of Lease STATE <input checked="" type="checkbox"/> FEE <input type="checkbox"/>
6. State Oil & Gas Lease No.

WELL COMPLETION OR RECOMPLETION REPORT AND LOG

1a. Type of Well: OIL WELL <input checked="" type="checkbox"/> GAS WELL <input type="checkbox"/> DRY <input type="checkbox"/> OTHER <input type="checkbox"/>		7. Lease Name or Unit Agreement Name  NORTHEAST DRINKARD UNIT	
5. Type of Completion: NEW WELL <input type="checkbox"/> WORK OVER <input type="checkbox"/> DEEPEN <input type="checkbox"/> PLUG BACK <input type="checkbox"/> DIFF RESVR <input checked="" type="checkbox"/> OTHER <input type="checkbox"/>		8. Well No. 319	
2. Name of Operator SHELL WESTERN E & P INC. (4431 WCK)		9. Pool name or Wildcat NORTH EUNICE BLINEBRY-TUBB- DRINKARD OIL & GAS	
3. Address of Operator P.O. BOX 576, Houston, TX 77001-0576			
4. Well Location Unit Letter <u>Q</u> : <u>1650</u> Feet From The <u>South</u> Line and <u>990</u> Feet From The <u>East</u> Line Section <u>2</u> Township <u>21-S</u> Range <u>37-E</u> NMPM LEA County			
10. Date Spudded 5-22-53	11. Date T.D. Reached 7-5-53	12. Date Compl. (Ready to Prod.) 9-15-88	13. Elevations (DF & RKB, RT, GR, etc.) 3481' GR
14. Elev. Casinghead ---			
15. Total Depth 8300'	16. Plug Back T.D. 7030'	17. If Multiple Compl. How Many Zones?	18. Intervals Drilled By Rotary Tools <u>X</u> Cable Tools
19. Producing Interval(s), of this completion - Top, Bottom, Name 5786' - 6888' BLINEBRY/TUBB/DRINKARD			20. Was Directional Survey Made NO
21. Type Electric and Other Logs Run			22. Was Well Cored NO

23. CASING RECORD (Report all strings set in well)

CASING SIZE	WEIGHT LB/FT.	DEPTH SET	HOLE SIZE	CEMENTING RECORD	AMOUNT PULLED
13-3/8"	48#	309'	17-1/4"	350 sxs	---
8-5/8"	28.32#	3099'	11"	1575 sxs	---
5-1/2"	14, 15.5, 17#	0' - 6019'	7-7/8"	600 sxs	---
		7095' - 8300'		180 sxs	---

24. LINER RECORD					25. TUBING RECORD		
SIZE	TOP	BOTTOM	SACKS CEMENT	SCREEN	SIZE	DEPTH SET	PACKER SET
4"	5571'	7587'	825 sxs				

26. Perforation record (interval, size, and number)  5786' - 6888' w/ 1JSPF	27. ACID, SHOT, FRACTURE, CEMENT, SQUEEZE, ETC.	
	DEPTH INTERVAL	AMOUNT AND KIND MATERIAL USED
	5786' - 6888'	AT w/ 11,550 gals 15% HCl

28. PRODUCTION

Date First Production 9-15-88		Production Method (Flowing, gas lift, pumping - Size and type pump) pumping - 1-1/4" slim hole pmp				Well Status (Prod. or Shut-in) prod	
Date of Test 10-15-88	Hours Tested 24	Choke Size	Prod'n For Test Period	Oil - Bbl. 32	Gas - MCF 45	Water - Bbl. 9	Gas - Oil Ratio 1500:1
Flow Tubing Press. 30	Casing Pressure ----	Calculated 24-Hour Rate	Oil - Bbl.	Gas - MCF	Water - Bbl.	Oil Gravity - API - (Corr.)	
29. Disposition of Gas (Sold, used for fuel, vented, etc.) sold						Test Witnessed By	

30. List Attachments  
C-102, C-103, C-104

31. I hereby certify that the information shown on both sides of this form is true and complete to the best of my knowledge and belief

Signature A.J. Fore Printed Name A.J. FORE

SUPV. FEB 2 1989  
Title REG. & PERMITS Date

# INSTRUCTIONS

This form is to be filed with the appropriate District Office of the Division not later than 20 days after the completion of any newly-drilled or deepened well. It shall be accompanied by one copy of all electrical and radio-activity logs run on the well and a summary of all special tests conducted, including drill stem tests. All depths reported shall be measured depths. In the case of directionally drilled wells, true vertical depths shall also be reported. For multiple completions, Items 25 through 29 shall be reported for each zone. The form is to be filed in quintuplicate except on state land, where six copies are required. See Rule 1105.

## INDICATE FORMATION TOPS IN CONFORMANCE WITH GEOGRAPHICAL SECTION OF STATE

### Southeastern New Mexico

T. Anhy \_\_\_\_\_ T. Canyon \_\_\_\_\_  
 T. Salt \_\_\_\_\_ T. Strawn \_\_\_\_\_  
 B. Salt \_\_\_\_\_ T. Atoka \_\_\_\_\_  
 T. Yates \_\_\_\_\_ T. Miss \_\_\_\_\_  
 T. 7 Rivers \_\_\_\_\_ T. Devonian \_\_\_\_\_  
 T. Queen \_\_\_\_\_ T. Silurian \_\_\_\_\_  
 T. Grayburg \_\_\_\_\_ T. Montoya \_\_\_\_\_  
 T. San Andres \_\_\_\_\_ T. Simpson \_\_\_\_\_  
 T. Glorieta \_\_\_\_\_ T. McKee \_\_\_\_\_  
 T. Paddock \_\_\_\_\_ T. Ellenburger \_\_\_\_\_  
 T. Blinebry 5733' T. Gr. Wash \_\_\_\_\_  
 T. Tubb 6202' T. Delaware Sand \_\_\_\_\_  
 T. Drinkard 6653' T. Bone Springs \_\_\_\_\_  
 T. Abo \_\_\_\_\_ T. \_\_\_\_\_  
 T. Wolfcamp \_\_\_\_\_ T. \_\_\_\_\_  
 T. Penn \_\_\_\_\_ T. \_\_\_\_\_  
 T. Cisco (Bough C) \_\_\_\_\_ T. \_\_\_\_\_

### Northwestern New Mexico

T. Ojo Alamo \_\_\_\_\_ T. Penn. "B" \_\_\_\_\_  
 T. Kirtland-Fruitland \_\_\_\_\_ T. Penn. "C" \_\_\_\_\_  
 T. Pictured Cliffs \_\_\_\_\_ T. Penn. "D" \_\_\_\_\_  
 T. Cliff House \_\_\_\_\_ T. Leadville \_\_\_\_\_  
 T. Menefee \_\_\_\_\_ T. Madison \_\_\_\_\_  
 T. Point Lookout \_\_\_\_\_ T. Elbert \_\_\_\_\_  
 T. Mancos \_\_\_\_\_ T. McCracken \_\_\_\_\_  
 T. Gallup \_\_\_\_\_ T. Ignacio Otzte \_\_\_\_\_  
 Base Greenhorn \_\_\_\_\_ T. Granite \_\_\_\_\_  
 T. Dakota \_\_\_\_\_ T. \_\_\_\_\_  
 T. Morrison \_\_\_\_\_ T. \_\_\_\_\_  
 T. Todilto \_\_\_\_\_ T. \_\_\_\_\_  
 T. Entrada \_\_\_\_\_ T. \_\_\_\_\_  
 T. Wingate \_\_\_\_\_ T. \_\_\_\_\_  
 T. Chinle \_\_\_\_\_ T. \_\_\_\_\_  
 T. Permian \_\_\_\_\_ T. \_\_\_\_\_  
 T. Penn "A" \_\_\_\_\_ T. \_\_\_\_\_

### OIL OR GAS SANDS OR ZONES

No. 1, from \_\_\_\_\_ to \_\_\_\_\_ No. 3, from \_\_\_\_\_ to \_\_\_\_\_  
 No. 2, from \_\_\_\_\_ to \_\_\_\_\_ No. 4, from \_\_\_\_\_ to \_\_\_\_\_

### IMPORTANT WATER SANDS

Include data on rate of water inflow and elevation to which water rose in hole.

No. 1, from \_\_\_\_\_ to \_\_\_\_\_ feet \_\_\_\_\_  
 No. 2, from \_\_\_\_\_ to \_\_\_\_\_ feet \_\_\_\_\_  
 No. 3, from \_\_\_\_\_ to \_\_\_\_\_ feet \_\_\_\_\_

### LITHOLOGY RECORD (Attach additional sheet if necessary)

From	To	Thickness in Feet	Lithology	From	To	Thickness in Feet	Lithology
0	45'		Caliche		3567		Anhydrite
	1334		Red Bed		7397		Lime
	1546		Red Bed, Anhydrite, Bed Rock		7610		Lime & Shale
	1560		Anhydrite & Gyp		7628		Shale
	2543		Anhydrite & Salt		7713		Lime & Shale
	2938		Anhydrite		7752		Shale
	2950		Sand		7778		Shale & Gyp
	2960		Anhydrite		7795		Shale
	2971		Sand		7817		Shale & Lime
	3099		Anhydrite		7907		Shale
	3100		Shale		8300		Shale & Sand
	3174		Anhydrite				
	3357		Anhydrite & Lime				

**RECEIVED**

**FEB 6 1989**

**OCD  
HOBBS OFFICE**

STATE OF NEW MEXICO  
ENERGY AND MINERALS DEPARTMENT

CONSERVATION DIVISION

P. O. BOX 2088  
SANTA FE, NEW MEXICO 87501

Form C-101  
Revised 10-1-78

NO. OF COPIES RECEIVED	
DISTRIBUTION	
SANTA FE	
FILE	
U.S.G.S.	
LAND OFFICE	
OPERATOR	

5A. Indicate Type of Lease  
STATE ☒ FEE ☐

5. State Oil & Gas Lease No.  
B-1732

APPLICATION FOR PERMIT TO DRILL, DEEPEN, OR PLUG BACK

1a. Type of Work DRILL <input type="checkbox"/> DEEPEN <input type="checkbox"/> PLUG BACK <input checked="" type="checkbox"/>		7. Unit Agreement Name NORTHEAST DRINKARD UNIT
b. Type of Well OIL WELL <input checked="" type="checkbox"/> GAS WELL <input type="checkbox"/> OTHER <input type="checkbox"/> SINGLE ZONE <input checked="" type="checkbox"/> MULTIPLE ZONE <input type="checkbox"/>		8. Farm or Lease Name NORTHEAST DRINKARD UNIT
2. Name of Operator SHELL WESTERN E&P INC.		9. Well No. 319
3. Address of Operator P. O. BOX 576, HOUSTON, TX 77001 (WCK 4435)		10. Field and Pool, or Wildcat NORTH EUNICE BLINEBRY-TUBB-DRINKARD OIL & GAS
4. Location of Well UNIT LETTER 0 LOCATED 1650 FEET FROM THE SOUTH LINE AND 990 FEET FROM THE EAST LINE 0" SEC. 2 TWP. 21S RGE. 37E NMPM		12. County LEA
19. Proposed Depth 8300' (TD)		19A. Formation BLINEBRY-TUBB-DRINKARD
20. Rotary or C.T. ROTARY		
21. Elevations (Show whether DF, RT, etc.) 3480.75' GR	21A. Kind & Status Plug. Bond BLANKET	21B. Drilling Contractor WORKOVER RIG
22. Approx. Date Work will start UPON APPROVAL		

23. PROPOSED CASING AND CEMENT PROGRAM

SIZE OF HOLE	SIZE OF CASING	WEIGHT PER FOOT	SETTING DEPTH	SACKS OF CEMENT	EST. TOP
17-1/4"	13-3/8"	48#	309'	350	SURF
11"	8-5/8"	28, 32#	3099'	1575	1495'
7-7/8"	5-1/2"	14, 15.5, 17#	0-6019'	600	2400'
			7095-8300'	180	7270'
	4" LNR	10.46#	5571-7587'	825	TOL

MOST RECENT PRODUCTION WAS FROM THE WANTZ ABO. WELL WAS PLUGGED BACK 12-31-87. WE NOW PROPOSE TO RECOMPLETE TO THE UNITIZED INTERVAL AS FOLLOWS:

1. POH w/prod equip.
2. Perf Blinebry/Tubb/Drinkard 5786' - 6888' (1 JSPF).
3. Acdz perms 5786' - 6888' w/11,550 gals 15% HCl-NEA + 1000# rock salt using RBP & pkr.
4. POH w/RBP & pkr.
5. Install prod equip & ret well to prod.

IN ABOVE SPACE DESCRIBE PROPOSED PROGRAM; IF PROPOSAL IS TO DEEPEN OR PLUG BACK, GIVE DATA ON PRESENT PRODUCTIVE ZONE AND PROPOSED NEW PRODUCTIVE ZONE. GIVE BLOWOUT PREVENTER PROGRAM, IF ANY.

I hereby certify that the information above is true and complete to the best of my knowledge and belief.

Signed A. J. Fore A. J. FORE Title SUPERVISOR REG. & PERMITTING Date 10-04-88

(This space for State Use)  
ORIGINAL SIGNED BY JERRY SEXTON  
DISTRICT 1 SUPERVISOR

APPROVED BY \_\_\_\_\_ TITLE \_\_\_\_\_ DATE \_\_\_\_\_

CONDITIONS OF APPROVAL, IF ANY:

RECEIVED

OCT 6 1988

OCD  
HOBBS OFFICE

NEW MEXICO OIL CONSERVATION COMMISSION  
WELL LOCATION AND ACREAGE DEDICATION PLAT

Form C-102  
Supersedes C-128  
Effective 1-1-65

All distances must be from the outer boundaries of the Section.

Operator <b>SHELL WESTERN E&amp;P INC.</b>			Lease <b>NORTHEAST DRINKARD UNIT</b>		Well No. <b>319</b>
Unit Letter <b>0</b>	Section <b>2</b>	Township <b>21S</b>	Range <b>37E</b>	County <b>LEA</b>	
Actual Footage Location of Well: <b>1650</b> feet from the <b>SOUTH</b> line and <b>990</b> feet from the <b>EAST</b> line					
Ground Level Elev. <b>3480.75'</b>	Producing Formation <b>BLINEBRY-TUBB-DRINKARD</b>		Pool <b>NORTH EUNICE BLINEBRY-TUBB-DRINKARD OIL &amp; GAS</b>		Dedicated Acreage: <b>40</b> Acres

1. Outline the acreage dedicated to the subject well by colored pencil or hachure marks on the plat below.
2. If more than one lease is dedicated to the well, outline each and identify the ownership thereof (both as to working interest and royalty).
3. If more than one lease of different ownership is dedicated to the well, have the interests of all owners been consolidated by communitization, unitization, force-pooling, etc?

☒ Yes ☐ No If answer is "yes," type of consolidation UNITIZATION

If answer is "no," list the owners and tract descriptions which have actually been consolidated. (Use reverse side of this form if necessary.) \_\_\_\_\_

No allowable will be assigned to the well until all interests have been consolidated (by communitization, unitization, forced-pooling, or otherwise) or until a non-standard unit, eliminating such interests, has been approved by the Commission.

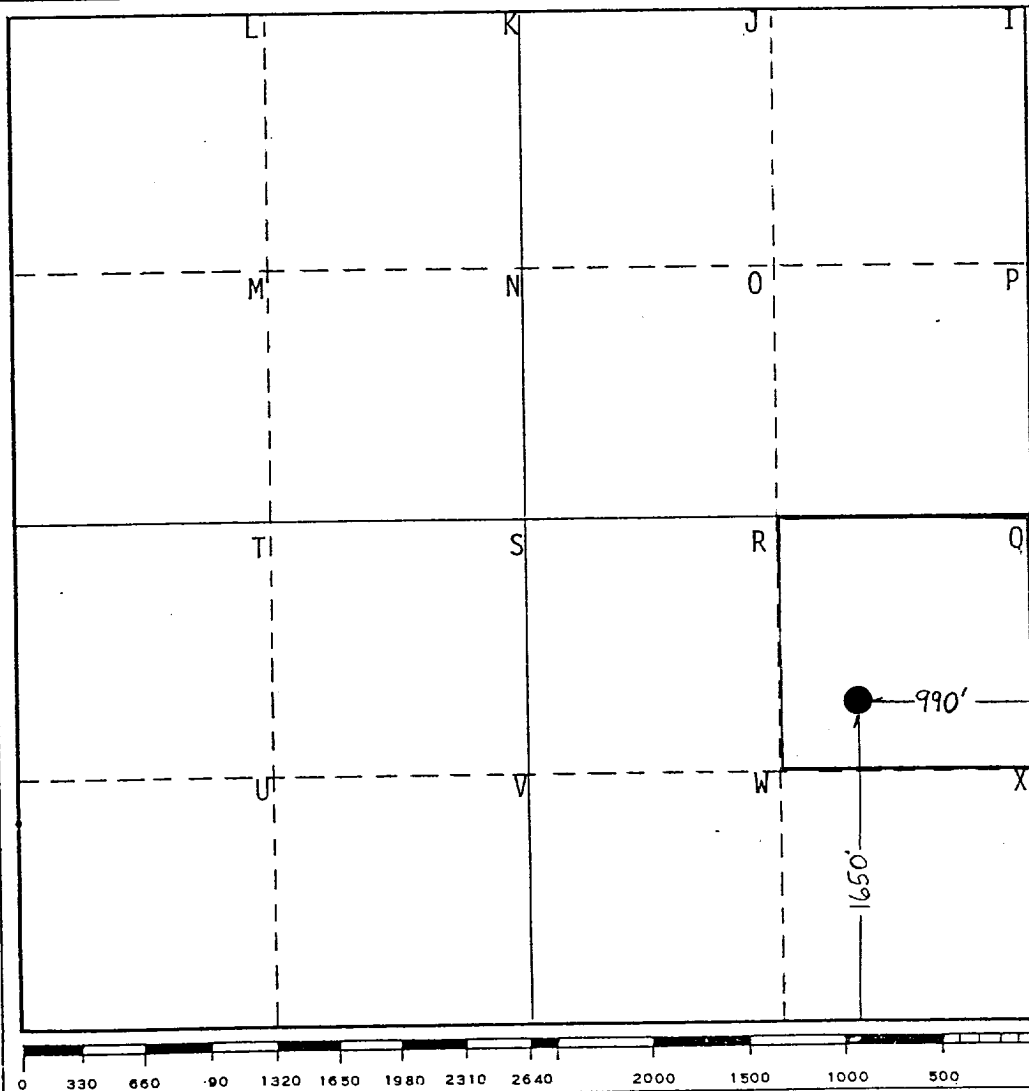

CERTIFICATION

I hereby certify that the information contained herein is true and complete to the best of my knowledge and belief.

Name  
A. J. FORE  
Position  
SUPERVISOR REG. & PERMITTING  
Company  
SHELL WESTERN E&P INC.  
Date  
10-04-88

I hereby certify that the well location shown on this plat was plotted from field notes of actual surveys made by me or under my supervision, and that the same is true and correct to the best of my knowledge and belief.

Date Surveyed

Registered Professional Engineer and/or Land Surveyor

Certificate No.

RECEIVED

OCT 6 1988

OCD  
HOBBS OFFICE



STATE OF NEW MEXICO  
ENERGY AND MINERALS DEPARTMENT

NO. OF COPIES RECEIVED	
DISTRIBUTION	
SANTA FE	
FILE	
U.S.G.S.	
LAND OFFICE	
OPERATOR	

OIL CONSERVATION DIVISION  
P. O. BOX 2088  
SANTA FE, NEW MEXICO 87501

Form C-103  
Revised 10-7-

5a. Indicate Type of Lease  
State ☒ Fee ☐  
5. State Oil & Gas Lease No.

SUNDRY NOTICES AND REPORTS ON WELLS

(DO NOT USE THIS FORM FOR PROPOSALS TO DRILL OR TO DEEPEN OR PLUG BACK TO A DIFFERENT RESERVOIR. USE "APPLICATION FOR PERMIT" (FORM C-101) FOR SUCH PROPOSALS.)

1. CIL WELL <input checked="" type="checkbox"/> EAB WELL <input type="checkbox"/> OTHER <input type="checkbox"/>	7. Unit Agreement Name NORTHEAST DRINKARD UNIT
2. Name of Operator SHELL WESTERN E&P INC.	8. Farm or Lease Name NORTHEAST DRINKARD UNIT
3. Address of Operator P. O. BOX 576, HOUSTON, TX 77001 (WCK 4435)	9. Well No. 319
4. Location of Well UNIT LETTER <u>Q</u> <u>1650</u> FEET FROM THE <u>SOUTH</u> LINE AND <u>990</u> FEET FROM THE <u>EAST</u> LINE, SECTION <u>2</u> TOWNSHIP <u>21S</u> RANGE <u>37E</u> N.M.P.M.	10. Field and Pool, or Wildcat NORTH EUNICE BLINEBRY-TUBB-DRINKARD OIL & GAS
15. Elevation (Show whether DF, RT, GR, etc.) 3480.75' GL	12. County LEA

Check Appropriate Box To Indicate Nature of Notice, Report or Other Data.  
NOTICE OF INTENTION TO: SUBSEQUENT REPORT OF:

PERFORM REMEDIAL WORK <input type="checkbox"/>	PLUG AND ABANDON <input type="checkbox"/>	REMEDIAL WORK <input type="checkbox"/>	ALTERING CASING <input type="checkbox"/>
TEMPORARILY ABANDON <input type="checkbox"/>	CHANGE PLANS <input type="checkbox"/>	COMMENCE DRILLING OPNS. <input type="checkbox"/>	PLUG AND ABANDONMENT <input type="checkbox"/>
PULL OR ALTER CASING <input type="checkbox"/>	OTHER <input type="checkbox"/>	CASING TEST AND CEMENT JOB <input type="checkbox"/>	OTHER <input checked="" type="checkbox"/> SET CIBP

17. Describe Proposed or Completed Operations (Clearly state all pertinent details, and give pertinent dates, including estimated date of starting any proposed work) SEE RULE 1103.

WORKED PERFORMED BY CHEVRON

12-31-87: Set CIBP @ 7065' & capped w/35' cmt. Left well SI.

18. I hereby certify that the information above is true and complete to the best of my knowledge and belief.

AS AGENT FOR CHEVRON USA INC.

SIGNED A. J. FORE TITLE SUPERVISOR REG. & PERMITTING DATE 2-19-88

ORIGINAL SIGNED BY JERRY SEXTON  
DISTRICT I SUPERVISOR

APPROVED BY JERRY SEXTON TITLE DISTRICT I SUPERVISOR DATE FEB 25 1988

CONDITIONS OF APPROVAL, IF ANY:

TA expires 3-1-89

RECEIVED  
FEB 24 1988  
OCD  
HOBBS OFFICE