

OIL CONSERVATION DIVISION
P. O. BOX 2088
SANTA FE, NEW MEXICO 87501

NO. OF COPIES RECEIVED	
DISTRIBUTION	
SANTA FE	
FILE	
U.S.O.S.	
LAND OFFICE	
TRANSPORTER	OIL
	GAS
OPERATOR	
PERMITS OFFICE	

REQUEST FOR ALLOWABLE
AND
AUTHORIZATION TO TRANSPORT OIL AND NATURAL GAS

I. Operator
SHELL WESTERN E&P INC.

Address
P. O. BOX 576, HOUSTON, TX 77001 (WCK 4435)

Reason(s) for filing (Check proper box)

<input type="checkbox"/> New Well	Change in Transporter of:	Other (Please explain) The Harry Leonard NCT F well #17 Drinkard pool. Unitization R-8540
<input type="checkbox"/> Recompletion	<input type="checkbox"/> Oil	
<input checked="" type="checkbox"/> Change in Ownership	<input type="checkbox"/> Casinghead Gas	
	<input type="checkbox"/> Dry Gas	
	<input type="checkbox"/> Condensate	

If change of ownership give name and address of previous owner **Chevron U.S.A., P.O. Box 670, Hobbs, NM 88240**

II. DESCRIPTION OF WELL AND LEASE

Lease Name NORTHEAST DRINKARD UNIT	Well No. 122	Pool Name, including Formation NORTH EUNICE BLINEBRY-TUBB- DRINKARD OIL & GAS	Kind of Lease State, Federal or Fee State	Lease No. B-1732
Location Lot Letter A ; 897 Feet From The North Line and 990 Feet From The East				
Line of Section 2 Township 21S Range 37E , NMPM, LEA County				

III. DESIGNATION OF TRANSPORTER OF OIL AND NATURAL GAS

Name of Authorized Transporter of Oil <input checked="" type="checkbox"/> or Condensate <input type="checkbox"/> Shell Pipeline Corporation	Address (Give address to which approved copy of this form is to be sent) P.O. Box 1910, Midland, TX 79702
Name of Authorized Transporter of Casinghead Gas <input checked="" type="checkbox"/> or Dry Gas <input type="checkbox"/> Warren Petroleum	Address (Give address to which approved copy of this form is to be sent) P.O. Box 1589, Tulsa, OK 74102
If well produces oil or liquids, give location of tanks.	Unit Sec. Twp. Rge. Is gas actually connected? When
	0 2 21S 37E Yes 10/22/85

If this production is commingled with that from any other lease or pool, give commingling order number: _____

NOTE: Complete Parts IV and V on reverse side if necessary.

VI. CERTIFICATE OF COMPLIANCE

I hereby certify that the rules and regulations of the Oil Conservation Division have been complied with and that the information given is true and complete to the best of my knowledge and belief.

A. J. Fore A. J. FORE
(Signature)
SUPERVISOR REGULATORY & PERMITTING
(Title)
DEC. 1 1987
(Date)

OIL CONSERVATION DIVISION

APPROVED **JAN 11 1988**, 19____

BY **Jerry S. Sinton**
DISTRICT I SUPERVISOR

TITLE _____

This form is to be filed in compliance with RULE 1104.
If this is a request for allowable for a newly drilled or deepened well, this form must be accompanied by a tabulation of the deviation tests taken on the well in accordance with RULE 111.
All sections of this form must be filled out completely for allowable on new and recompleted wells.
Fill out only Sections I, II, III, and VI for changes of owner, well name or number, or transporter, or other such change of condition.
Separate Forms C-104 must be filed for each pool in multiply completed wells.

1-11-88
A. J. Fore

IV. COMPLETION DATA

Designate Type of Completion - (X)		Oil Well	Gas Well	New Well	Workover	Deepen	Plug Back	Same Res'v.	Diff. Res'v.
Date Spudded	Date Compl. Ready to Prod.		Total Depth			P.B.T.D.			
Elevations (DF, RKB, RT, GR, etc.)	Name of Producing Formation		Top Oil/Gas Pay			Tubing Depth			
Perforations						Depth Casing Shoe			
TUBING, CASING, AND CEMENTING RECORD									
HOLE SIZE	CASING & TUBING SIZE			DEPTH SET			SACKS CEMENT		

V. TEST DATA AND REQUEST FOR ALLOWABLE (Test must be after recovery of total volume of load all and must be equal to or exceed top allowable for this depth or be for full 24 hours)

Date First New Oil Run To Tank	Date of Test	Producing Method (Flow, pump, gas lift, etc.)		
Length of Test	Tubing Pressure	Casing Pressure		Choke Size
Actual Prod. During Test	Oil - Bbls.	Water - Bbls.		Gas - MCF

GAS WELL

Actual Prod. Test - MCF/D	Length of Test	Bbls. Condensate/MMCF		Gravity of Condensate
Testing Method (pilot, back pr.)	Tubing Pressure (Ghat-in)	Casing Pressure (Ghat-in)		Choke Size

NEW MEXICO OIL CONSERVATION COM. ION
 WELL LOCATION AND ACREAGE DEDICATION PLAT

Form C-102
 Supersedes C-128
 Effective 1-1-65

All distances must be from the outer boundaries of the Section.

Operator SHELL WESTERN E&P INC.		Lease NORTHEAST DRINKARD UNIT			Well No. 122
Unit Letter A	Section 2	Township 21S	Range 37E	County LEA	
Actual Postage Location of Well: 897 feet from the North line and 990 feet from the East line					
Ground Level Elev. 3521	Producing Formation		Pool NORTH EUNICE BLINEBRY-TUBB- DRINKARD OIL & GAS	Dedicated Acreage: 37.14 Acres	

- Outline the acreage dedicated to the subject well by colored pencil or hachure marks on the plat below.
- If more than one lease is dedicated to the well, outline each and identify the ownership thereof (both as to working interest and royalty).
- If more than one lease of different ownership is dedicated to the well, have the interests of all owners been consolidated by communitization, unitization, force-pooling, etc?

Yes No If answer is "yes," type of consolidation UNITIZATION

If answer is "no," list the owners and tract descriptions which have actually been consolidated. (Use reverse side of this form if necessary.) _____

No allowable will be assigned to the well until all interests have been consolidated (by communitization, unitization, forced-pooling, or otherwise) or until a non-standard unit, eliminating such interests, has been approved by the Commission.

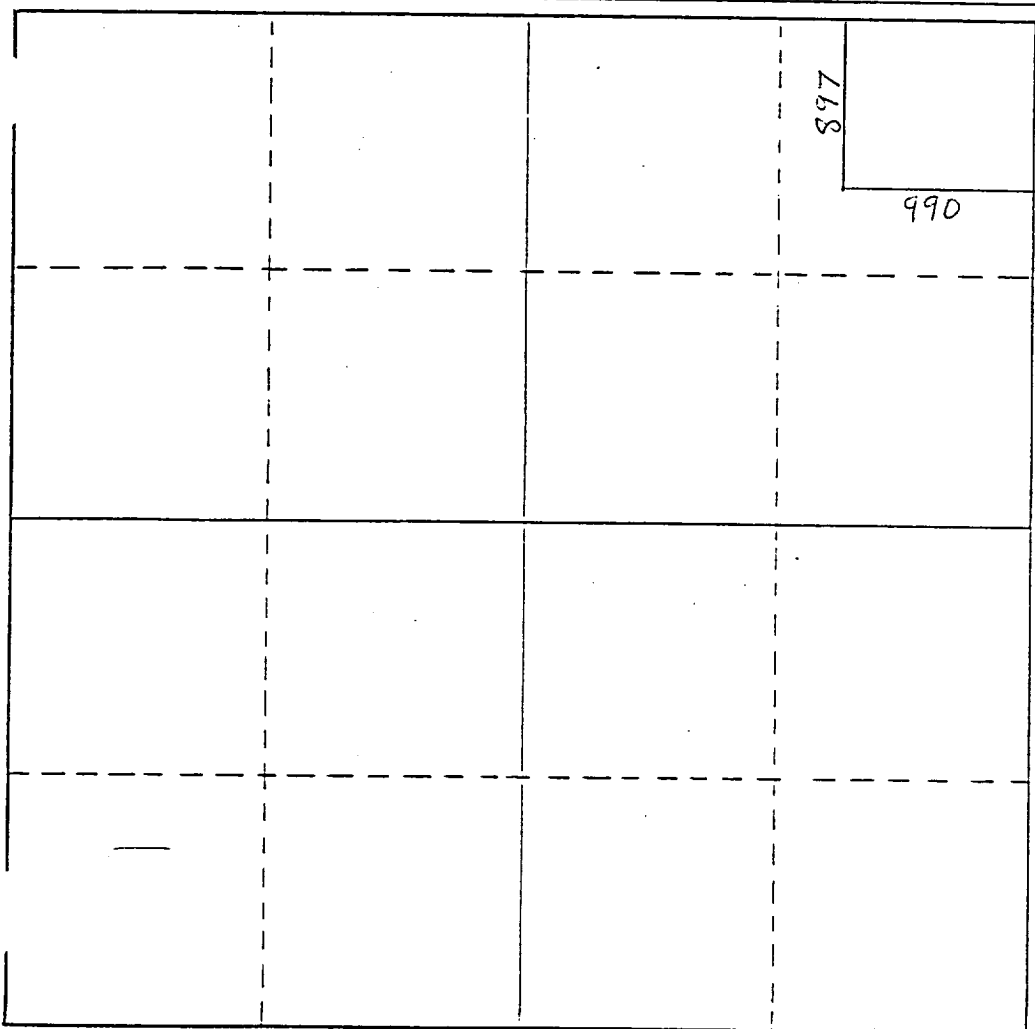

CERTIFICATION

I hereby certify that the information contained herein is true and complete to the best of my knowledge and belief.

Name
A. J. Fore A. J. FORE

Position
 SUPV. REG. & PERMITTING

Company
 SHELL WESTERN E&P INC.

Date
 DEC 1 1987

I hereby certify that the well location shown on this plat was plotted from field notes of actual surveys made by me or under my supervision, and that the same is true and correct to the best of my knowledge and belief.

Date Surveyed

Registered Professional Engineer and/or Land Surveyor

Certificate No.

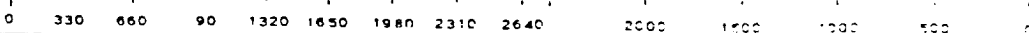

RECEIVED
JAN 9 1988
OCD
HOBBS OFFICE