

NEW MEXICO OIL CONSERVATION COMMISSION
WELL LOCATION AND ACREAGE DEDICATION PLAT

Form C-102
 Supersedes C-128
 Effective 1-1-65

All distances must be from the outer boundaries of the Section.

Operator Shell Oil Company			Lease Taylor Glenn			Well No. 2		
Unit Letter I	Section 3	Township 21S	Range 37E	County Lea				
Actual Footage Location of Well:								
4620 feet from the South line and			660 feet from the East line					
Ground Level Elev. 3491	Producing Formation Tubb		Pool Tubb Gas			Dedicated Acreage: 40 Acres		

1. Outline the acreage dedicated to the subject well by colored pencil or hachure marks on the plat below.
2. If more than one lease is dedicated to the well, outline each and identify the ownership thereof (both as to working interest and royalty).
3. If more than one lease of different ownership is dedicated to the well, have the interests of all owners been consolidated by communitization, unitization, force-pooling, etc?

☐ Yes ☐ No If answer is "yes," type of consolidation _____

If answer is "no," list the owners and tract descriptions which have actually been consolidated. (Use reverse side of this form if necessary.) _____

No allowable will be assigned to the well until all interests have been consolidated (by communitization, unitization, forced-pooling, or otherwise) or until a non-standard unit, eliminating such interests, has been approved by the Commission.

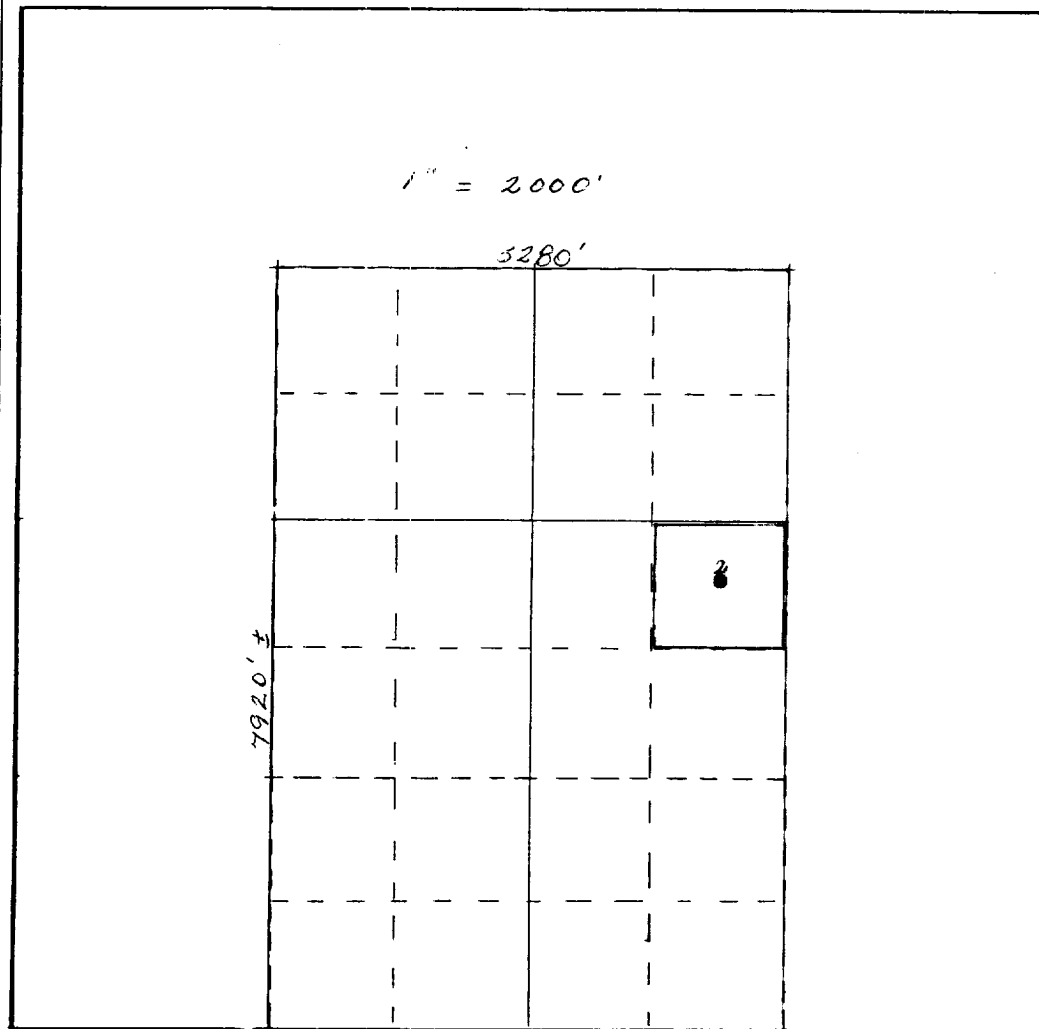

CERTIFICATION

I hereby certify that the information contained herein is true and complete to the best of my knowledge and belief.

J. E. Sullivan

Name
J. E. Sullivan

Position
Senior Engineering Technician

Company
Shell Oil Company

Date
8-10-78

I hereby certify that the well location shown on this plat was plotted from field notes of actual surveys made by me or under my supervision, and that the same is true and correct to the best of my knowledge and belief.

Date Surveyed

Registered Professional Engineer
 and/or Land Surveyor

Certificate No.

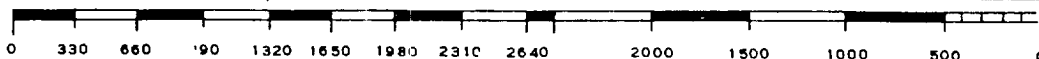

RECEIVED

AUG 14 1978

GR. CONSERVATION COMM.
HOBBS, N. M.

NEW MEXICO OIL CONSERVATION COMMISSION
Well Location and Acreage Dedication Plat

Section A.

Date September 30, 1958

Operator Shell Oil Company Lease 1938 GGT G 41 7 32
Well No. 2 Unit Letter I Section 3 Township 21-S Range 37-E NMPM
Located 4620 Feet From South Line, 660 Feet From East Line
County Lee G. L. Elevation 3481 Dedicated Acreage 160 Acres
Name of Producing Formation Tubb Pool Tubb Gas

1. Is the Operator the only owner* in the dedicated acreage outlined on the plat below?
Yes X No _____.
2. If the answer to question one is "no," have the interests of all the owners been consolidated by communitization agreement or otherwise? Yes _____ No _____. If answer is "yes," Type of Consolidation _____
3. If the answer to question two is "no," list all the owners and their respective interests below:

Owner

Land Description

Section. B

R-37-E

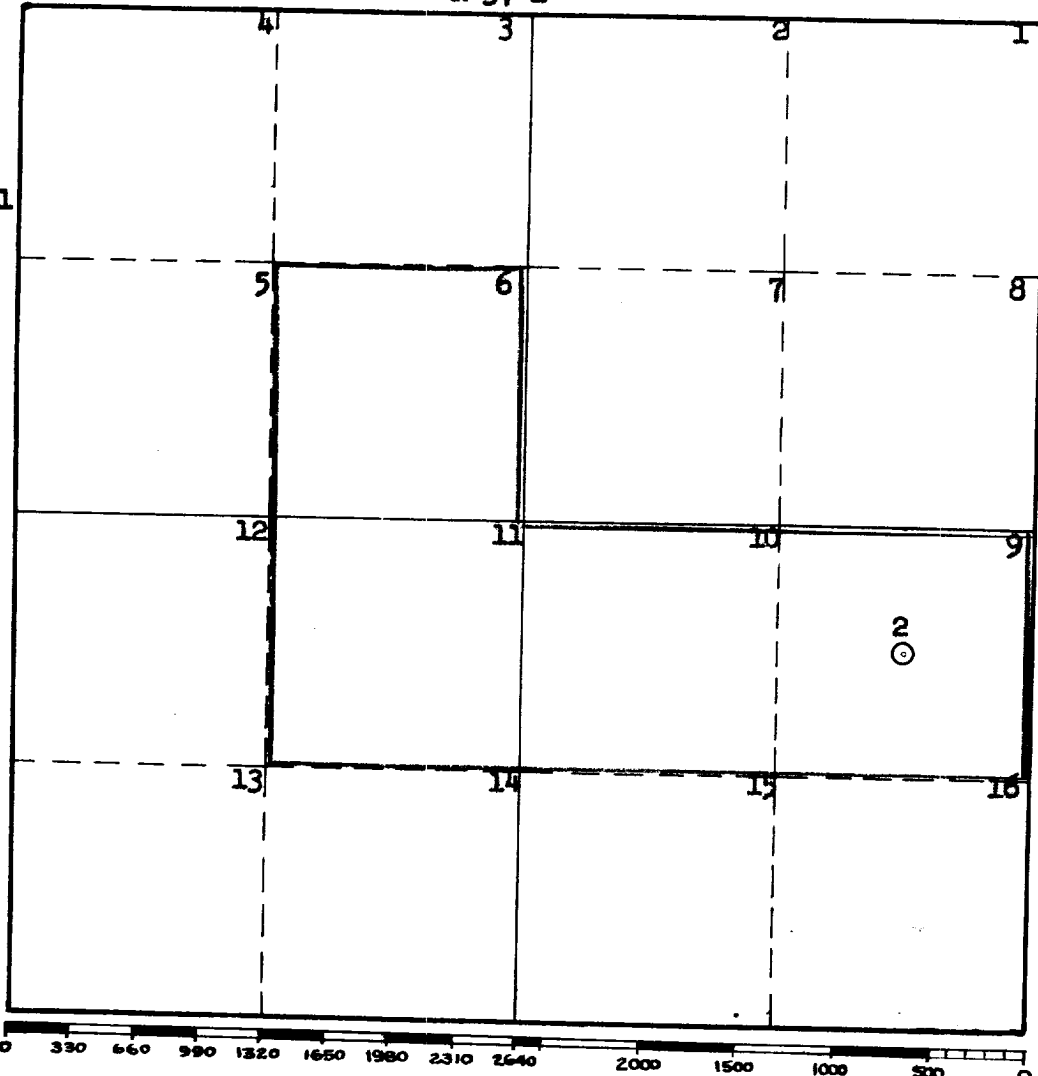

This is to certify that the information in Section A above is true and complete to the best of my knowledge and belief.

Shell Oil Company

(Operator) Original Signed By
Rex C. Cabaniss

Rex C. Cabaniss

(Representative)

Roswell, New Mexico

Address

This is to certify that the well location shown on the plat in Section B was plotted from field notes of actual surveys made by me or under my supervision and that the same is true and correct to the best of my knowledge and belief.

Date Surveyed _____

Registered Professional
Engineer and/or Land Surveyor.

Certificate No. _____

(See instructions for completing this form on the reverse side)

INSTRUCTIONS FOR COMPLETION:

1. Operator shall furnish and certify to the information called for in Section A.
2. Operator shall outline the dedicated acreage for both oil and gas wells on the plat in Section B.
3. A registered professional engineer or land surveyor registered in the State of New Mexico or approved by the Commission shall show on the plat the location of the well and certify this information in the space provided.
4. All distances shown on the plat must be from the outer boundaries of Section.
5. If additional space is needed for listing owners and their respective interests as required in question 3, Section A, please use space below

* "Owner" means the person who has the right to drill into and to produce from any pool and to appropriate the production either for himself or for himself and another. (65-3-29 (e) NMSA 1953 Comp.)