

NEW MEXICO OIL CONSERVATION COMMISSION

WELL LOCATION AND ACREAGE DEDICATION PLAT

FORM C-128
Revised 5/1/57

SEE INSTRUCTIONS FOR COMPLETING THIS FORM ON THE REVERSE SIDE **UCC**

Operator Continental Oil Company				SECTION A Lease			
Unit Letter E	Section 10	Township 21S	Range 37E	State 10	County Los	Well No. 00 2	
Actual Footage Location of Well: 1980 feet from the North line and 990 feet from the West line							
Ground Level Elev. 3456		Producing Formation Blinsbry		Pool Blinsbry (Oil)		Dedicated Acreage: 40 Acres	

1. Is the Operator the only owner in the dedicated acreage outlined on the plat below? YES ☒ NO ☐ . ("Owner" means the person who has the right to drill into and to produce from any pool and to appropriate the production either for himself or for himself and another. (65-3-29 (e) NMSA 1935 Comp.)
2. If the answer to question one is "no," have the interests of all the owners been consolidated by communitization agreement or otherwise? YES ☐ NO ☐ . If answer is "yes," Type of Consolidation _____
3. If the answer to question two is "no," list all the owners and their respective interests below:

Owner	Land Description

SECTION B

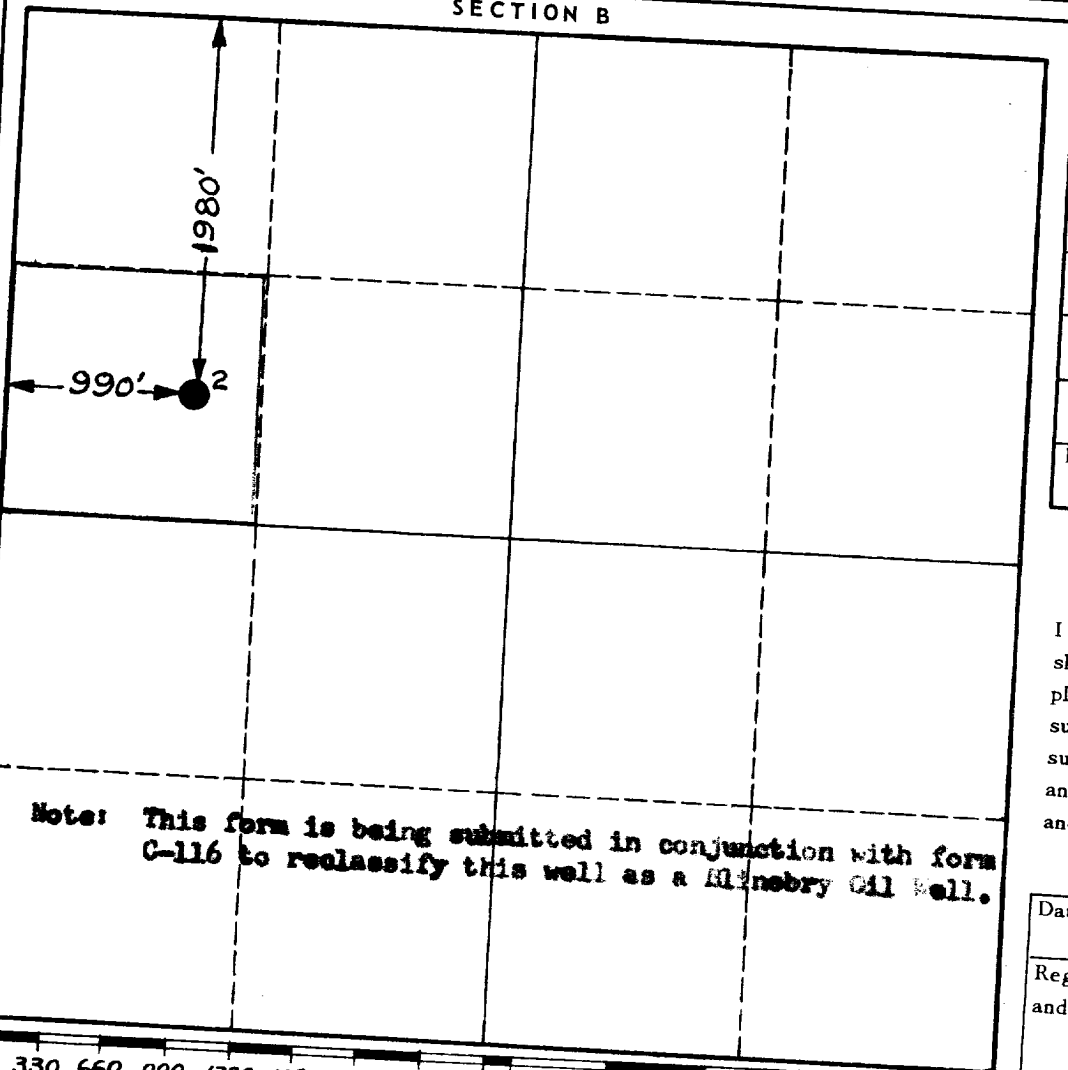

Note: This form is being submitted in conjunction with form C-116 to reclassify this well as a Blinsbry Oil well.

CERTIFICATION

I hereby certify that the information in SECTION A above is true and complete to the best of my knowledge and belief.

Name J. R. Parker
 Position District Superintendent
 Company Continental Oil Company
 Date 6-26-52

I hereby certify that the well location shown on the plat in SECTION B was plotted from field notes of actual surveys made by me or under my supervision, and that the same is true and correct to the best of my knowledge and belief.

Date Surveyed _____
 Registered Professional Engineer and/or Land Surveyor _____

Certificate No. _____

0 330 660 990 1320 1650 1980 2310 2640 2970 3300 3600

Dist: 3-AMCC; - WMS - FILE

INSTRUCTIONS FOR COMPLETION OF FORM C-128

1. Operator shall furnish and certify to the information called for in Section A.
2. Operator shall outline the dedicated acreage for *both* oil and gas wells on the plat in Section B.
3. A registered professional engineer or land surveyor registered in the State of New Mexico or approved by the Commission shall show on the plat the location of the well and certify this information in the space provided.
4. All distances shown on the plat must be from the outer boundaries of the Section.
5. If additional space is needed for listing owners and their respective interests as required in question 3 of Section A, please use space below.

NEW MEXICO
OIL CONSERVATION COMMISSION

Gas Well Plat

WORMS STEELER OCC
Date 8/22/54

Continental
Operator

State 10
Lease

115 62 2-D
Well No: 18

Name of Producing Formation Blinebry Pool Blinebry

No. Acres Dedicated to the Well 160

SECTION 10 TOWNSHIP 21 RANGE 37

3-D 1-S	4-S		
2-D	4-E 3-S		
NOTE: The State 10 Lease containing 80 acres, the E/2 NW/4, and 80 acres of the Hawk B-10 Lease, the E/2 NE/4, have been communitized, thereby making possible the allocation of 160 acres to the State 10 #2-D.			

I hereby certify that the information given above is true and complete to the best of my knowledge.

Name W.R. Allen
Position District Superintendent
Representing Continental Oil Co.
Address Box 66, San Jose, N. M.

(over)

INSTRUCTIONS

1. Is this gas well a dual completion? Yes ☒ No ☐
2. If the answer to Question 1 is Yes, are there any other dually completed wells within the dedicated acreage? Yes ☒ No ☐

A separate plat must be filed for each gas well, outlining the area dedicated to such well and showing the location of all other wells (oil and gas) within the outlined area.

Mail in duplicate to the district office for the district in which the well is located.