

OCC
Humble

HUMBLE OIL & REFINING COMPANY

May 8, 1957

DC-434
443
Jan 17 23/57
(43)

New Mexico Oil Conservation Commission
Box 871
Santa Fe, New Mexico

Gentlemen:

This letter is to request that Humble Oil & Refining Company be granted a permit to dually complete our New Mexico State "V" Well No. 1, located 660' from the South and West lines of Section 10, T-21-S, R-37-E, Lea County, New Mexico. This request is made under regulations as set forth in Order R-316, Rule 112-A. In support of this application we present the following information:

1. New Mexico State "V" Well No. 1 is now completed as an oil well in the Drinkard Field. It is our plan to dually complete this well by perforating the Blinebry gas pay and completing as a dual oil and gas well.
2. The acreage to be assigned to the Blinebry gas zone will be 160 acres standard gas unit described as being the SW/4 of Section 10, T-21-S, R-37-E, Lea County, New Mexico.
3. The Gas Unit will consist of continuous quarter, quarter sections.
4. The Gas Unit would be wholly within a single governmental section.
5. The entire Gas Unit may reasonably be presumed to be productive of gas from the Blinebry Zone.
6. The length or width of the Gas Proration Unit does not exceed 2640'.

We are attaching a Schematic Diagram of the proposed dual completion, a Certified Gas Unit Plat, and a copy of our letter advising all offset operators of this application.

We trust the above information is sufficient for you to issue the necessary DC Order.

Yours very truly,

HUMBLE OIL & REFINING COMPANY

R. R. MCCARTY

Division Superintendent

By *COPY* *ORIGINAL SIGNED: L. H. BYRD*
Assistant Division Superintendent

JEP/fl
Attachments

The diagram illustrates the experimental setup. A participant is seated at a table, looking at a video screen. A video camera is positioned above the screen. A light source is positioned to the left of the screen. A target is positioned on the screen. A ruler is placed on the table. A scale bar is shown at the bottom right.

NEW MEXICO OIL CONSERVATION COMMISSION
Santa Fe, New Mexico

Form G-101
Revised (12/1/55)

NOTICE OF INTENTION TO DRILL

Notice must be given to the District Office of the Oil Conservation Commission and approval obtained before drilling or recompletion begins. If changes in the proposed plan are considered advisable, a copy of this notice showing such changes will be returned to the sender. Submit this notice in QUINTUPPLICATE. One copy will be returned following approval. See additional instructions in Rules and Regulations of the Commission. If State Land submit 6 Copies Attach Form G-128 in triplicate to first 3 copies of form G-101

Midland, Texas
(Place)

May 8, 1957
(Date)

OIL CONSERVATION COMMISSION
SANTA FE, NEW MEXICO

Gentlemen:

Dual Completion

You are hereby notified that it is our intention to commence the ~~drilling~~ of a well to be known as
Humble Oil & Refining Company Co. Lease No. 37722
(Company or Operator)

New Mexico State "V" Well No. **1**, in **"M"** The well is
(Lease) (Unit)
located **660** feet from the **South** line and **660** feet from the
West line of Section **10**, T. **21-S**, R. **37-E**, NMPM.
(GIVE LOCATION FROM SECTION LINE) **Drinkard** Pool, **Lea** County

If State Land the Oil and Gas Lease is No. **-**

If patented land the owner is **-**

Address **-**

We propose to drill well with drilling equipment as follows: **Workover rig**

The status of plugging bond is **on file with commission office**

Drilling Contractor **-**

We intend to complete this well in the **Blinberry gas pool - Drinkard oil pool**
formation at an approximate depth of **See Schematic Drawing attached** feet.

See Attached Plats

CASING PROGRAM

We propose to use the following strings of Casing and to cement them as indicated:

Size of Hole	Size of Casing	Weight per Foot	New or Second Hand	Depth	Sacks Cement
See Records on file and attached drawing.					
Note: This is to request permission to dually complete our New Mexico State "V" Well 1. Well					
now produces oil from the Drinkard. We propose to produce the Drinkard oil thru 2" tubing					
string and to produce the Blinberry gas thru the casing. Permission requested under provisions					

If changes in the above plans become advisable we will notify you immediately.

ADDITIONAL INFORMATION (If recompletion give full details of proposed plan of work.)

of Rule 112-A, Paragraph C, Attached are copies of letter advising offset operator of this application, Schematic drawing, location plats & gas unit plats.

Approved _____, 19_____
Except as follows:

OIL CONSERVATION COMMISSION

By _____

Sincerely yours,

Humble Oil & Refining Company

By *[Signature]*
(Company or Operator)

Position **Div. Chief Clerk**
Send Communications regarding well to

Name **R. R. McCarty**

Address **Box 1600 Midland, Texas**

SCHEMATIC DIAGRAM OF PROPOSED DUAL COMPLETION

HUMBLE NEW MEXICO STATE V-1

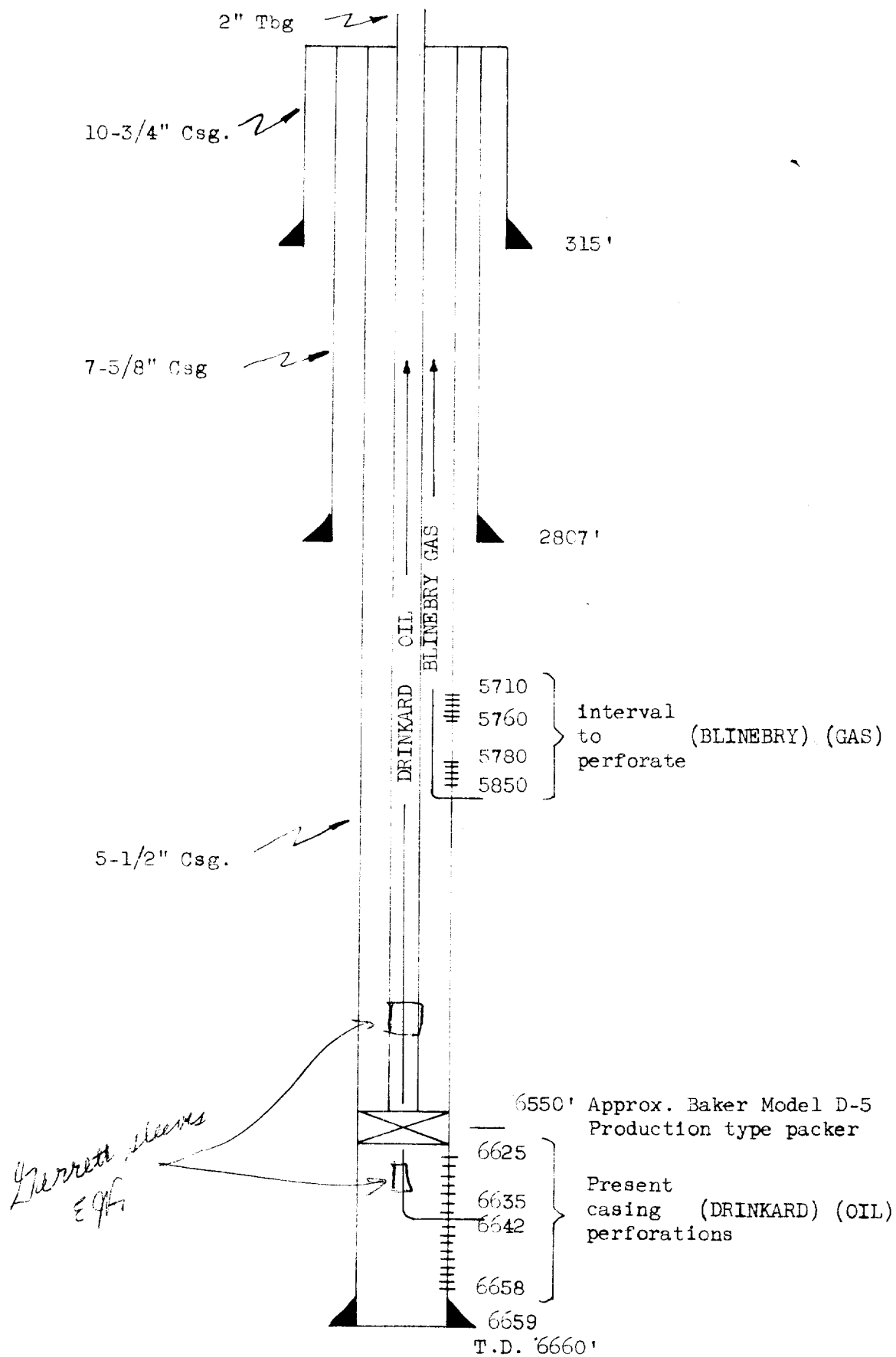

NEW MEXICO
OIL CONSERVATION COMMISSION

Form C-128

Well Location and/or Gas Proration Plat

Date May 8, 1957

Operator Humble Oil & Refining Co Lease New Mexico State "V"

Well No. 1 Section 10 Township 21-South Range 37 East NMPM

Located 660 Feet From South Line, 660 Feet From West Line,

Lea County, New Mexico. G. L. Elevation _____

Name of Producing Formation Drinkard Oil Pool Drinkard Oil
Blinbry Gas Dedicated Acreage 160

(Note: All distances must be from outer boundaries of Section)

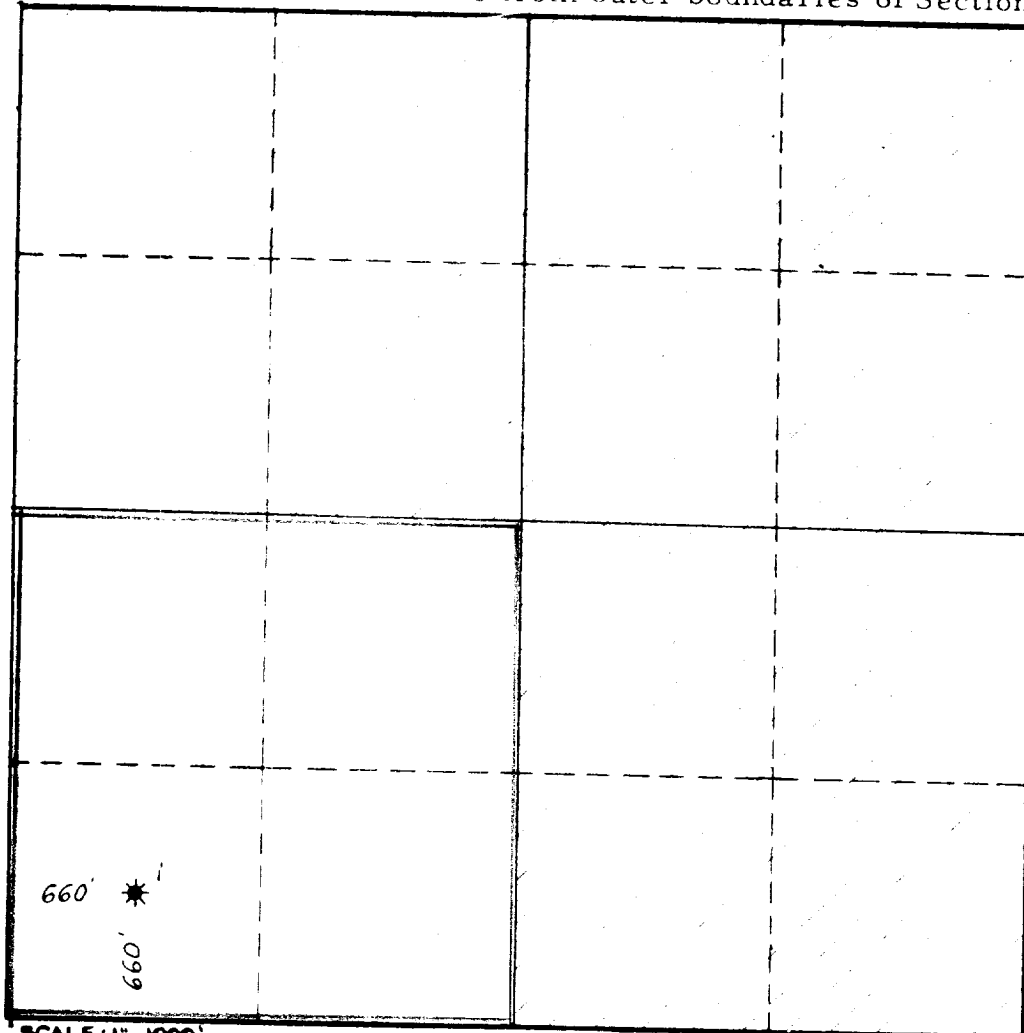

SCALE: 1" = 1000'

1. Is this Well a Dual Comp. ? Yes No
2. If the answer to Question 1 is yes, are there any other dually completed wells within the dedicated acreage ? Yes No _____

This is to certify that the above plat was prepared from field notes of actual surveys made by me or under my supervision and that the same are true and correct to the best of my knowledge and belief.

Name E. T. Shahan
Position ASSISTANT DIVISION SUPERINTENDENT
Representing HUMBLE OIL & REFINING CO.
Address BOX 1600 MIDLAND, TEXAS

Date Surveyed 9-8-48
E. T. Shahan
Registered Professional Engineer and/or
Land Surveyor

File No. W-A 2321

T-21-S

R-37-E

Stanolind

Cont. et. al.

Continental et. al.

6

Southland Roy.

State

2

5-E

2-E

3-S

U. S.

1-S

3-E

Cont.

3-E

1-B Ross Sears
Will N. Terry

9

10

11

Cont. et. al.
"B-9"

Humble 37722

Aztec

"V"

2080

1980

1980

760'

9

11

1580'

280 Ac.

Blinberry-Tubb
Gas Unit No. 1

Gutman

Tide Water

Stanolind

7

W.C. Hawk

660'

660'

100'

150'

5

1

1170'

2

1220'

7

200'

4

500'

660'

500'

State

6

1320'

3

1980'

1980'

State

990'

660'

2100'

C. D. Ham

Gulf

"E"

4

Tide Water

"S"

7

15

2

4

6

3

Moran Inc.

2-B

H. Leonard

State

D. C. Ham

15

14

I hereby certify that I am a registered professional engineer and/or land surveyor in the State of New Mexico; that I am familiar with the conditions upon which this land and the minerals thereon that this plat represents was deposited; to the best of my knowledge, the area, location and distances of the land and minerals shown on this plat are correct and accurate.

Surveyed by *W. C. Hawk* to *W. C. Hawk*

W. C. Hawk
Registered Professional Engineer & Land Surveyor
in the State of New Mexico. (Seal)

NOTE: Area shown hereon is a portion of Lse. No. 37722 which covers 3,960 Ac. lying in Lea County.

SCALE

1000

0

1000

2000 FEET

NEW MEXICO STATE "V" NO. 37722

SEC. 10 T-21S R-37-E LEA CO. N.M.

HUMBLE OIL & REFINING COMPANY
CIVIL ENGINEERING DIVISION
MIDLAND, TEXAS

DRAWN D.L. MCKIBBIN

CHECKED *W. C. Hawk*

APPR.

SCALE 1" = 1000

DATE 9-8-48

REVISE 3-4-56 D.L.M.

FILE NO.

WT-A 759

COPY

HUMBLE OIL & REFINING COMPANY

May 8, 1957

Continental Oil Company
P. O. Box 431
Midland, Texas

Gulf Oil Corporation
Drawer 4232
Odessa, Texas

Tidewater Oil Company
P. O. Box 1231
Midland, Texas

Tex American Oil Company
P. O. Box 1540
Midland, Texas

Artec Oil & Gas Company
P. O. Box 847
Hobbs, New Mexico

Gentlemen:

Please find attached a copy of application to Dual Complete our New Mexico State "V" Well No. 1. This well is located 660' from the South and West lines of Section 10, T-31-S, R-37-E, Lea County, New Mexico.

Well presently produces as an oil well in the Drinkard Field and we plan to dually complete by producing gas through the casing from the Blinbry. Please refer to attached Schematic Drawing. A Certified Unit Plat is also attached for your information.

This notice is given in accordance with Order No. B-316, Rule 112-A Paragraph e, of the New Mexico Conservation Commission Rules and Regulations.

Yours very truly,

HUMBLE OIL & REFINING COMPANY

R. E. MCCARTY
Division Superintendent

JEP/FL
Attachments

By COPY ORIGINAL SIGNED: L. H. BYRD
Assistant Division Superintendent

COPY

THE 2nd BATTLE OF GERMANY

1944

THE 2nd BATTLE OF GERMANY
1944

THE 2nd BATTLE OF GERMANY
1944

THE 2nd BATTLE OF GERMANY
1944

THE 2nd BATTLE OF GERMANY
1944

THE 2nd BATTLE OF GERMANY
1944

1944

THE 2nd BATTLE OF GERMANY
1944

THE 2nd BATTLE OF GERMANY
1944

THE 2nd BATTLE OF GERMANY
1944

THE 2nd BATTLE OF GERMANY
1944

THE 2nd BATTLE OF GERMANY
1944

THE 2nd BATTLE OF GERMANY
1944

THE 2nd BATTLE OF GERMANY
1944

COPY
L. H. BYRD

THE 2nd BATTLE OF GERMANY
1944