

MEXICO OIL CONSERVATION COMMISSION

Well Location and Acreage Dedication Plat

Section A.

Date 2-20-59

Operator HUMBLE OIL & REFG. CO Lease 127453 New Mexico State "V"
Well No. 5* Unit Letter "M" Section 10 Township 21 S Range 37 E NMPM
Located 660' Feet From South Line, 810' Feet From West Line
County Lea G. L. Elevation _____ Dedicated Acreage 40 Acres
Name of Producing Formation Simpson Pool Hare

1. Is the Operator the only owner* in the dedicated acreage outlined on the plat below?
Yes ✓ No _____.
2. If the answer to question one is "no," have the interests of all the owners been consolidated by communitization agreement or otherwise? Yes _____ No _____. If answer is "yes," Type of Consolidation _____.
3. If the answer to question two is "no," list all the owners and their respective interests below:

* Wells 5 & 10 are in the same Unit and Pool
Owner Land Description

Section B

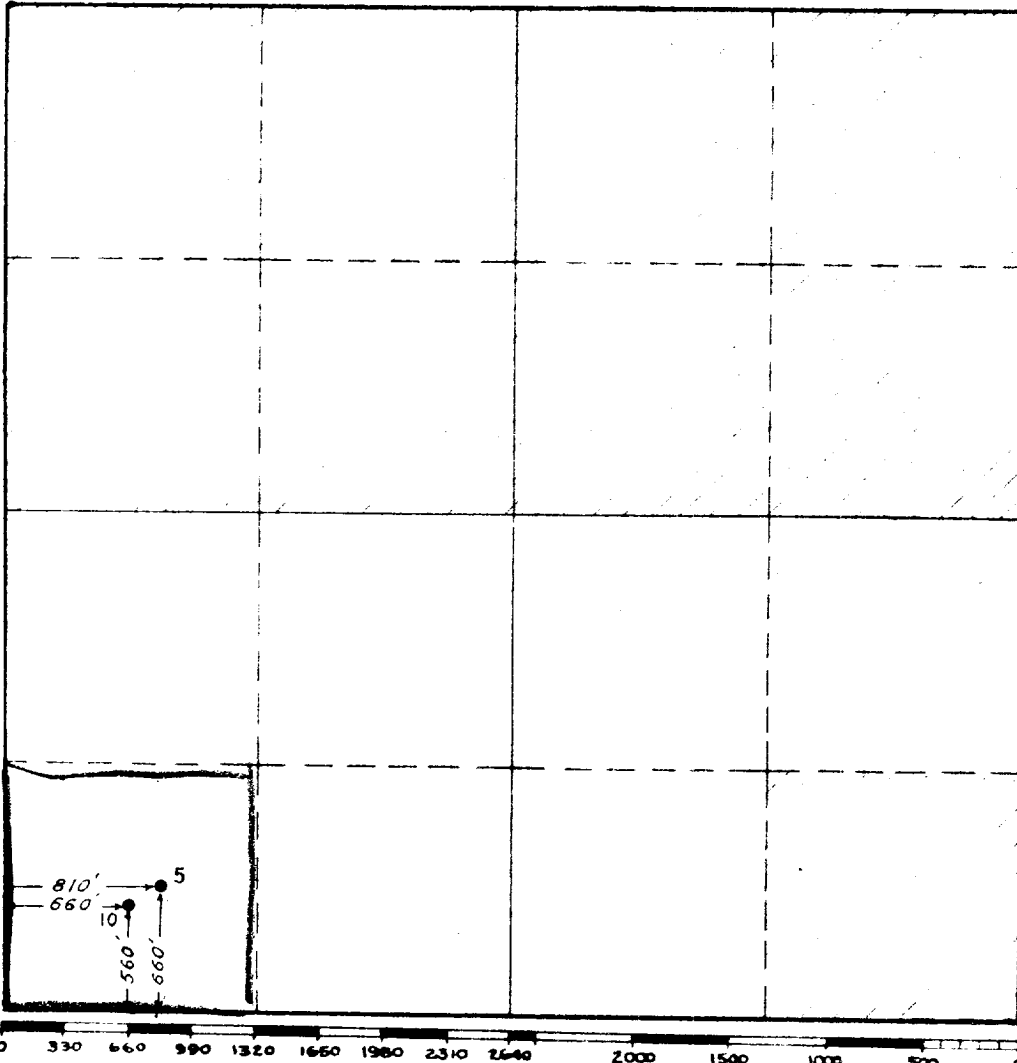

This is to certify that the information in Section A above is true and complete to the best of my knowledge and belief.

HUMBLE OIL & REFG. CO
(Operator)

H. P. Hensley
(Representative)
Assistant Division Supt.
Box 1600 Midland, Texas
Address

This is to certify that the well location shown on the plat in Section B was plotted from field notes of actual surveys made by me or under my supervision and that the same is true and correct to the best of my knowledge and belief.

Date Surveyed 2-20-59

H. S. Hesterfield
Registered Professional
Engineer and/or Land Surveyor.

Certificate No. 1382

LEASE NO. 37722

W-A - 759