

000
Holler

HUMBLE OIL & REFINING COMPANY

MAIN OFFICE OCC
1935 MAR 11 1:12

COPY
DC-288
See 7/24/56

March 7, 1956

Re: Dual Completion
New Mexico State "V" Well No. 7
Section 10, T-21-S, R-37E
Lea County, New Mexico, from
Elinebry and Tubb Gas Pools

New Mexico Oil Conservation Commission
Box 871
Santa Fe, New Mexico

Gentlemen:

Humble Oil & Refining Company respectfully requests that we be granted a permit to dual complete our New Mexico State "V" Well No. 7 as a gas well from the Elinebry Gas Pool and as a gas well from the Tubb Gas Pool. In support of this application we submit the following information:

1. New Mexico State "V" Well No. 7 is located 500 feet from the south line and 1880 feet from the west line of Section 10, T-21-S, R-37-E, Lea County, New Mexico.
2. New Mexico State "V" Well No. 7 now produces as an oil well from the McKee sand in the Hare Pool.
3. We plan to set a bridge plug at approximately 6400 feet, thereby, sealing off the McKee pay.
4. We plan to perforate the Tubb gas pay between the intervals 6035-6360 feet and produce this section through the tubing.
5. A production packer will be set at approximately 6000 feet and the Elinebry gas pay will be perforated between the intervals 5640-5940 feet and produced through the casing.
6. The Elinebry and Tubb gas sections to be perforated lie within the vertical and horizontal limits of Elinebry and Tubb Gas Pools.
7. The dual completion of this well will be in the interest of conservation and the mechanics of the dual completion are feasible and practicable.
8. All offset operators have been furnished a copy of this application by certified mail.
9. The acreage to be dedicated to the well will be 160 acres described as the SW/4 of Section 10, T-21-S, R-37E, Lea County, New Mexico.

COPY

HUMBLE OIL & REFINING COMPANY

New Mexico Oil Conservation Commission
March 7, 1956
Page 2

This request for dual completion permit is requested in accordance with Rule 112(e). It is our understanding that such a permit can be granted by the Secretary of the Commission without a hearing if no objections are made by offset operators.

I hereby certify that the information given above is true and complete to the best of my knowledge.

Yours very truly,

HUMBLE OIL & REFINING COMPANY

J. W. HOUSE
Division Superintendent

By H. L. Hensley
H. L. Hensley
Assistant Division Superintendent

Sworn to and subscribed before me this the 8th day of March 1956.

Shirley J. Elmer SHIRLEY J. ELMER
Notary Public in and for
Midland County, Texas

COPY

HUMBLE OIL & REFINING COMPANY

March 7, 1956

Continental Oil Company
Box 427
Hobbs, New Mexico

Shell Oil Company
Box 1957
Hobbs, New Mexico

Cities Service Oil Company
Box 97
Hobbs, New Mexico

Astec Oil & Gas Company
Box 847
Hobbs, New Mexico

Stanolind Oil & Gas Company
Box 899
Roswell, New Mexico

E. F. Moran
Box 1718
Hobbs, New Mexico

Gulf Oil Corporation
Box 2167
Hobbs, New Mexico

Tide Water Associated Oil Company
Attn: J. B. Holloway
Box 1404
Houston, Texas

Gentlemen:

Please find attached Humble Oil & Refining Company's Application for Dual Completion permit for New Mexico State "V" Well No. 7, to be completed as a dual gas-gas well from the Blinbry and Tubb Gas Fields.

We have also attached diagrammatic drawing, well location plat and lease plat.

This notice is given in accordance with Rule 112 (c) of the New Mexico Oil Conservation Commission Rules and Regulations.

Yours very truly,

HUMBLE OIL & REFINING COMPANY

J. W. HOUSE,
Division Superintendent

By: *WILLIAM L. MANLEY*

Asst. Div. Superintendent

AJT:
Attachment

SCHEMATIC DIAGRAM OF PROPOSED DUAL COMPLETION HUMBLE - N.M. STATE V-7

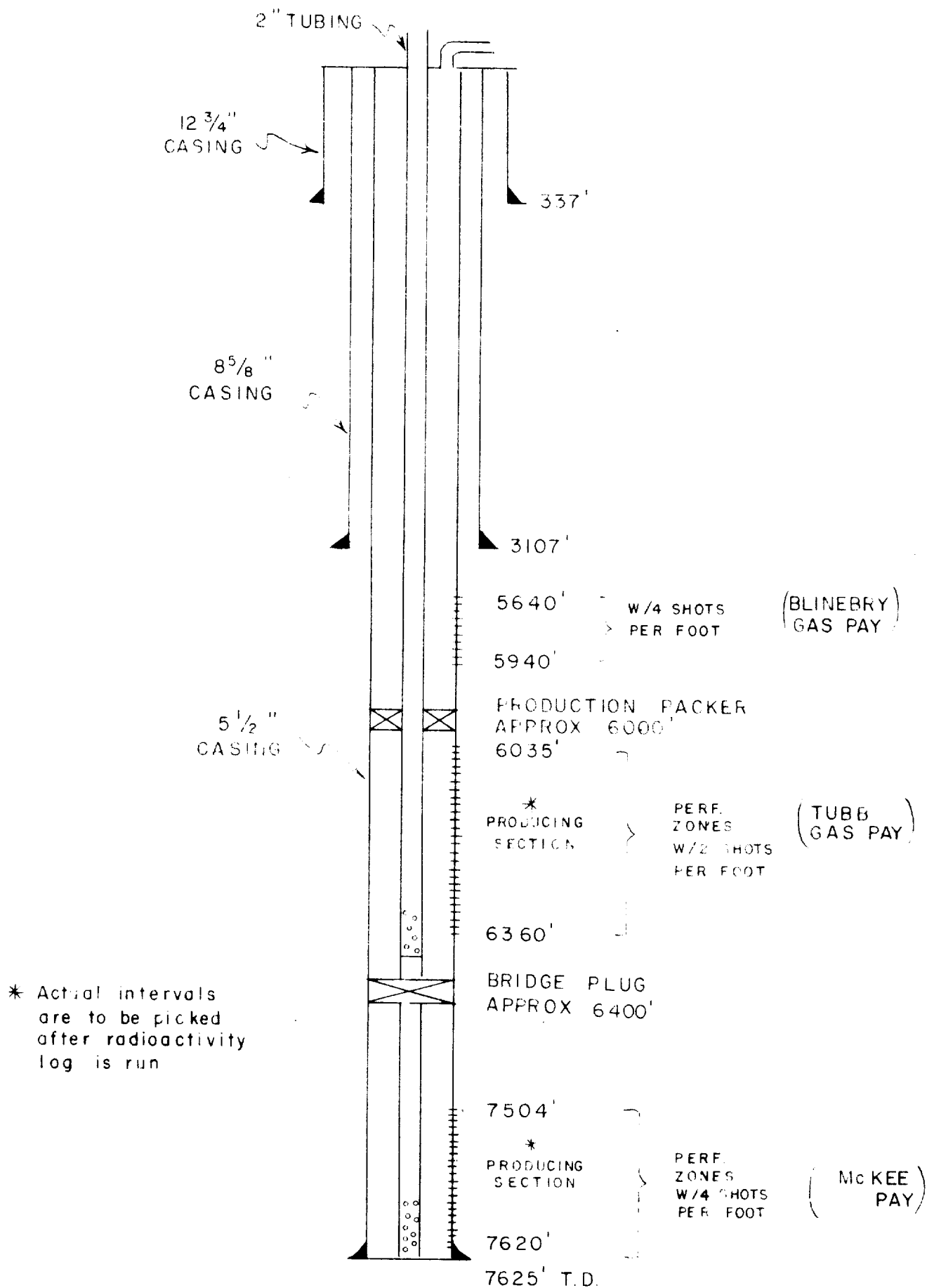

T-21-S

R-37-E

Stanolind

Cont. et. al.

Continental et. al.

Cont.

3-E

1-B Ross Sears

Will N. Terry

Southland Roy.

State

U. S.

9

10

11

Cont. et. al.
"B-9"

Humble 37722

Aztec

Gutman

Stanolind

C. D. Ham

Moran Inc.

D. C. Ham

14

W.C. Hawk

Gulf
"E"

H. Leonard

16

State

15

SCALE

1000

0

1000

2000 FEET

NOTE: Area shown hereon is a portion of Lse. No. 37722 which covers 3,960 Ac. lying in Lea County.

NEW MEXICO STATE "V" NO. 37722
SEC. 10 T-21S R-37-E LEA CO. N.M.

HUMBLE OIL & REFINING COMPANY
CIVIL ENGINEERING DIVISION
MIDLAND, TEXAS

DRAWN D.L. MCKIBBIN

CHECKED

APPR.

SCALE 1" = 1000

DATE 9-8-48

REVISE 3-4-56 D.L.M.

FILE NO.

WT-A 759

NEW MEXICO
OIL CONSERVATION COMMISSION

Form C-128

Well Location and/or Gas Proration Plat

Date 3-7-56

Operator Humble Oil & Refining Co. Lease New Mexico State "V"

Well No. 7 Section 10 Township 21-S Range 37-E NMPM

Located 500 Feet From South Line, 1880 Feet From West Line,

Leo County, New Mexico. G. L. Elevation _____

Name of Producing Formation Tubb Gas Blinebry Gas Pool Tubb Gas Blinebry Gas Dedicated Acreage 160

(Note: All distances must be from outer boundaries of Section)

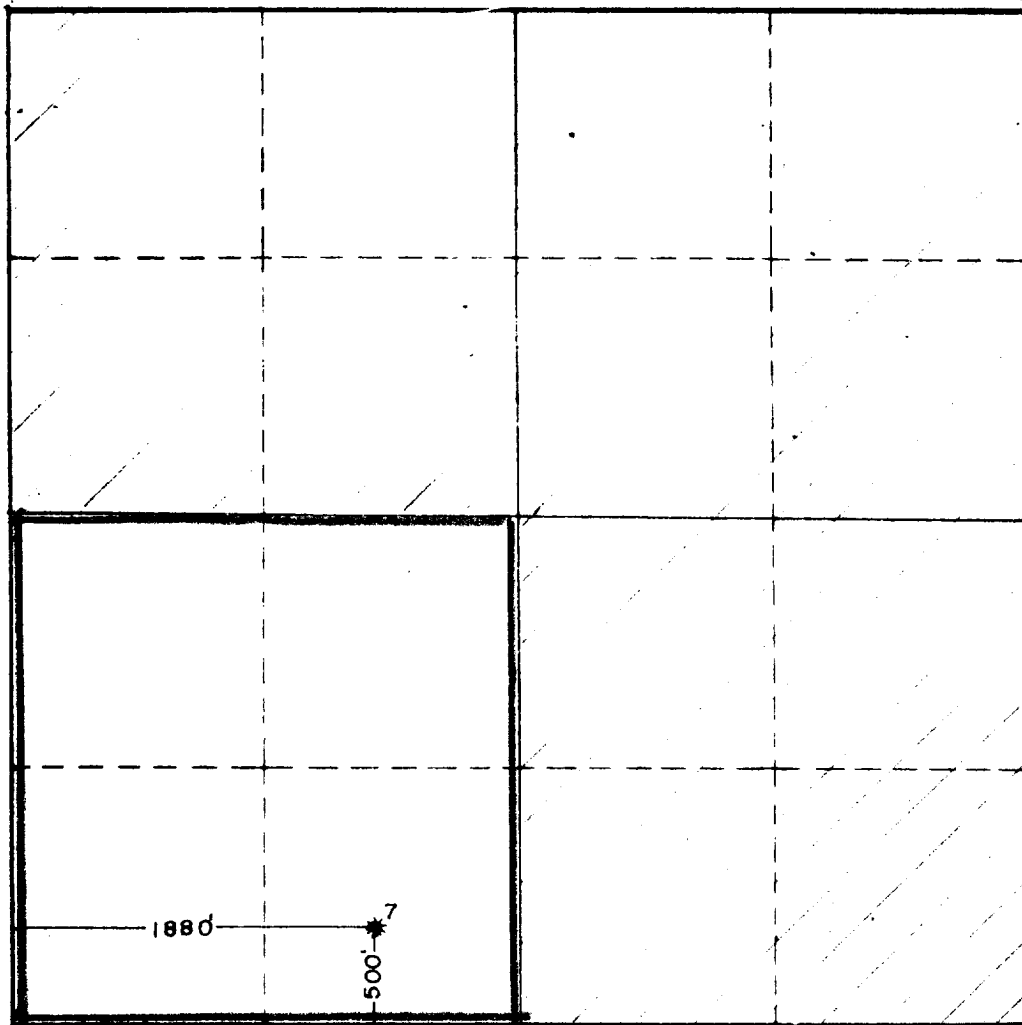

SCALE: 1" = 1000'

1. Is this Well a Dual Comp.? Yes No
2. If the answer to Question 1 is yes, are there any other dually completed wells within the dedicated acreage? Yes No _____

This is to certify that the above plat was prepared from field notes of actual surveys made by me or under my supervision and that the same are true and correct to the best of my knowledge and belief.

Name H. P. Hensley
Position ASST. DIVISION SUPERINTENDENT
Representing HUMBLE OIL & REFINING CO.
Address BOX 1600, MIDLAND, TEXAS

Date Surveyed 8-29-51
E. T. Hensley
Registered Professional Engineer and/or
Land Surveyor

W-A - 759