

NEW MEXICO OIL CONSERVATION COMMISSION
Santa Fe, New Mexico

Form O-101
Revised (12/1/55)

NOTICE OF INTENTION TO DRILL

Notice must be given to the District Office of the Oil Conservation Commission and approval obtained before drilling or recompletion begins. If changes in the proposed plan are considered advisable, a copy of this notice showing such changes will be returned to the sender. Submit this notice in QUINTUPLICATE. One copy will be returned following approval. See additional instructions in Rules and Regulations of the Commission. If State Land submit 6 Copies Attach Form G- 128 in triplicate to first 3 copies of form O-101

Midland, Texas
(Place)

3-29-62
(Date)

OIL CONSERVATION COMMISSION
SANTA FE, NEW MEXICO

Gentlemen:

You are hereby notified that it is our intention to commence the Drilling of a well to be known as
Humble Oil & Refining Co. #37722

(Company or Operator)

New Mexico State "V"
(Lease)

Well No. 12

"L"

The well is

(Unit)

located 1980 feet from the South line and 330 feet from the West line of Section 10, T. 21-S, R. 37-E, NMPM.

(GIVE LOCATION FROM SECTION LINE) Blinbry - Oil Pool, Lea County

If State Land the Oil and Gas Lease is No. B-935

If patented land the owner is

Address

We propose to drill well with drilling equipment as follows: rotary

The status of plugging bond is on file

Drilling Contractor unknown

We intend to complete this well in the Blinbry Oil formation at an approximate depth of 6000 feet.

CASING PROGRAM

We propose to use the following strings of Casing and to cement them as indicated:

Size of Hole	Size of Casing	Weight per Foot	New or Second Hand	Depth	Sacks Cement
13-3/4	10-3/4	32.75	New	300	250*
9-7/8	7-5/8	24	"	3000	200**
6-3/4	2-7/8	6.4	"	6000	200***

If changes in the above plans become advisable we will notify you immediately.

ADDITIONAL INFORMATION (If recompletion give full details of proposed plan of work.)

*Circulate back to surface.

**Circ. back to base of salt.

***Circ. to at least 600' above top of uppermost pay.

HOWCO Method of cementing to be used.

CORES
1 - Queen 3700'
2 - San Andres 4050'
1 - Glorieta 5150'

Sincerely yours,

HUMBLE OIL & REFINING COMPANY

By: J. E. Robertson
(Company or Operator)

Position Adm. Supervisor

Send Communications regarding well to

Name R. R. McCarty

Address Box 1600, Midland, Texas

Approved: 19.....
Except as follows:

OIL CONSERVATION COMMISSION

By: 778

Section A.

Date March 29, 1962

Operator Humble Oil & Refining Co. Lease New Mexico State "V"
 Well No. 12 Unit Letter "L" Section 10 Township 21 South Range 37 East NMPM
 Located 1980 Feet From South Line, 330 Feet From West Line
 County Lea G. L. Elevation Later Dedicated Acreage 40 Acres
 Name of Producing Formation Blinberry Oil Pool Blinberry

1. Is the Operator the only owner* in the dedicated acreage outlined on the plat below?

Yes ☒ No ☐2. If the answer to question one is "no", have the interests of all the owners been consolidated by communitization agreement or otherwise? Yes ☐ No ☐ If answer is

"yes," Type of Consolidation _____

3. If the answer to question two is "no," list all the owners and their respective interests below:

OwnerLand Description

Section B

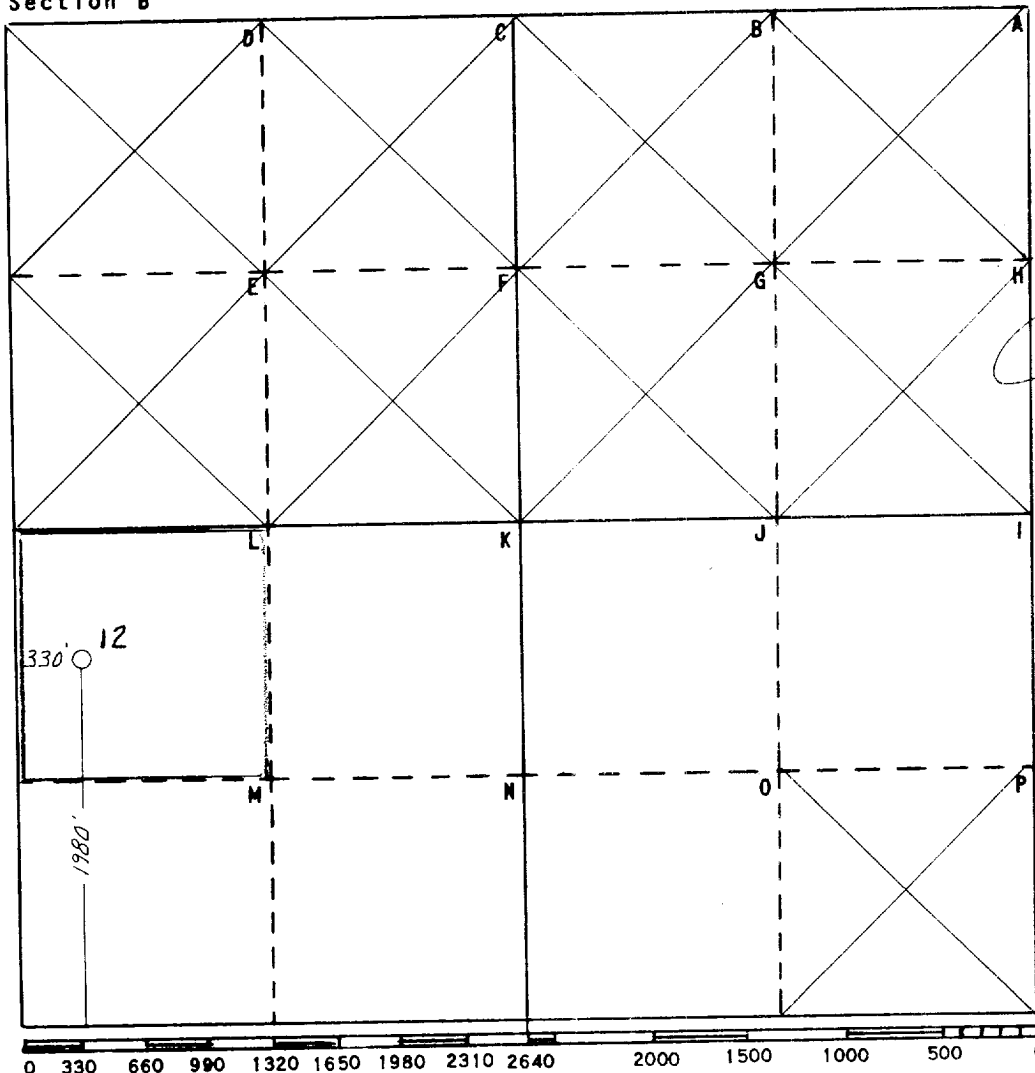

This is to certify that the information in Section A above is true and complete to the best of my knowledge and belief

HUMBLE OIL & REFG. CO.

(Operator)

(Representative)

Box 1600 Midland, Texas
Address

This is to certify that the well location shown on the plat in Section B was plotted from field notes of actual surveys made by me or under my supervision and that the same is true and correct to the best of my knowledge and belief.

Date Surveyed March 21, 1962

H. S. Westerfield
 Registered Professional
 Engineer and/or Land Surveyor

Certificate No. 1382

FILE NO. W-A-2321