

District I  
1625 N. French Dr., Hobbs, NM 88240

State of New Mexico  
Energy, Minerals & Natural Resources Department

Form C-101  
Revised March 17, 1999

District II  
811 South First, Artesia, NM 88210

**OIL CONSERVATION DIVISION**  
2040 South Pacheco  
Santa Fe, NM 87505

Submit to appropriate District Office  
State Lease - 6 Copies  
Fee Lease - 5 Copies

District III  
1000 Rio Brazos Rd., Aztec, NM 87410

District IV  
2040 South Pacheco, Santa Fe, NM 87505

☐ AMENDED REPORT

**APPLICATION FOR PERMIT TO DRILL, RE-ENTER, DEEPEN, PLUGBACK, OR ADD A ZONE**

1 Operator Name and Address Apache Corporation / Attn: Debra J. Anderson 2000 Post Oak Blvd. Ste. 100 Houston, Texas 77056-4400		2 OGRID Number 000873
4 Property Code 23108		3 API Number 30-025-06517
5 Property Name Livingston		6 Well No. 6

**7 Surface Location**

UL or lot no.	Section	Township	Range	Lot Idn	Feet from the	North/South Line	Feet from the	East/West Line	County
S	3	21S	37E		1980	South	2308	West	Lea

**8 Proposed Bottom Hole Location If Different From Surface**

UL or lot no.	Section	Township	Range	Lot Idn	Feet from the	North/South Line	Feet from the	East/West Line	County
9 Proposed Pool 1 Hare; San Andres, East					10 Proposed Pool 2				

11 Work Type Code P	12 Well Type Code O	13 Cable/Rotary	14 Lease Type Code P	15 Ground Level Elevation 3439
16 Multiple	17 Proposed Depth 8230 (TD)	18 Formation San Andres	19 Contractor	20 Spud Date ASAP

**21 Proposed Casing and Cement Program**

Hole Size	Casing Size	Casing weight/foot	Setting Depth	Sacks of Cement	Estimated TOC
17-1/4	13-3/8	32#	222	250	Surface
11	8-5/8	28# & 32#	3147	2200	Surface
7-7/8	5-1/2 Liner	15.5# & 17#	2944 - 8228	895	TOC @ 2944

22 Describe the proposed program. If this application is to DEEPEN or PLUG BACK give the data on the present productive zone and proposed new productive zone. Describe the blowout prevention program, if any. Use additional sheets if necessary.

Apache proposes to abandon the Abo formation by setting a CIBP @ 6900' w/ 10' of cement on top and recomplete to the San Andres formation by perforating from 3865 - 3970.

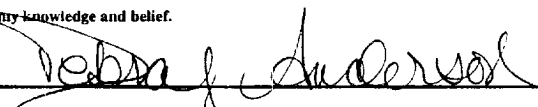
23 I hereby certify that the information given above is true and complete to the best of my knowledge and belief.		<b>OIL CONSERVATION DIVISION</b>	
Signature: 		Approved by:	
Printed Name: Debra J. Anderson		Title:	
Title: Sr. Engineering Technician		Approval Date: 8/7/00 Expiration Date:	
Date: 8/7/00	Phone: 713-296-6338	Conditions of Approval: Attached <input type="checkbox"/>	

✓

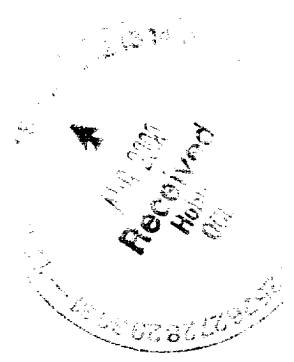

District I  
1625 N. French Drive, Hobbs, NM 88240

District II  
P O Drawer DD, Artesia, NM 88210

District III  
1000 Rio Brazos Rd., Aztec, NM 87410

District IV  
2040 South Pacheco, Santa Fe, NM 87505

State of New Mexico  
Energy, Minerals and Natural Resources Department

**OIL CONSERVATION DIVISION**

2040 S. Pacheco  
Santa Fe, New Mexico 87505

Form C-102

Revised October 18, 1994

Instruction on Back

Submit to Appropriate District Office

State Lease - 4 Copies

Fee Lease - 3 Copies

☐ AMENDED REPORT

**WELL LOCATION AND ACREAGE DEDICATION PLAT**

<sup>1</sup> API Number 30-025-06517		<sup>2</sup> Pool Code 96601		<sup>3</sup> Pool Name Hare; San Andres, East	
<sup>4</sup> Property Code 23108		<sup>5</sup> Property Name Livingston			<sup>6</sup> Well Number 6
<sup>7</sup> OGRID No. 000873		<sup>8</sup> Operator Name Apache Corporation			<sup>9</sup> Elevation 3439

<sup>10</sup> Surface Location

UL or Lot No. S	Section 3	Township 21S	Range 37E	Lot Idn	Feet from the 1980	North/South line South	Feet from the 2308	East/West line West	County Lea
--------------------	--------------	-----------------	--------------	---------	-----------------------	---------------------------	-----------------------	------------------------	---------------

<sup>11</sup> Bottom Hole Location If Different From Surface

UL or Lot No.	Section	Township	Range	Lot Idn	Feet from the	North/South line	Feet from the	East/West line	County
---------------	---------	----------	-------	---------	---------------	------------------	---------------	----------------	--------

<sup>12</sup> Dedicated Acres 40	<sup>13</sup> Joint or Infill	<sup>14</sup> Consolidation Code	<sup>14</sup> Order No.
-------------------------------------	-------------------------------	----------------------------------	-------------------------

NO ALLOWABLE WILL BE ASSIGNED TO THIS COMPLETION UNTIL ALL INTERESTS HAVE BEEN CONSOLIDATED  
OR A NON-STANDARD UNIT HAS BEEN APPROVED BY THE DIVISION

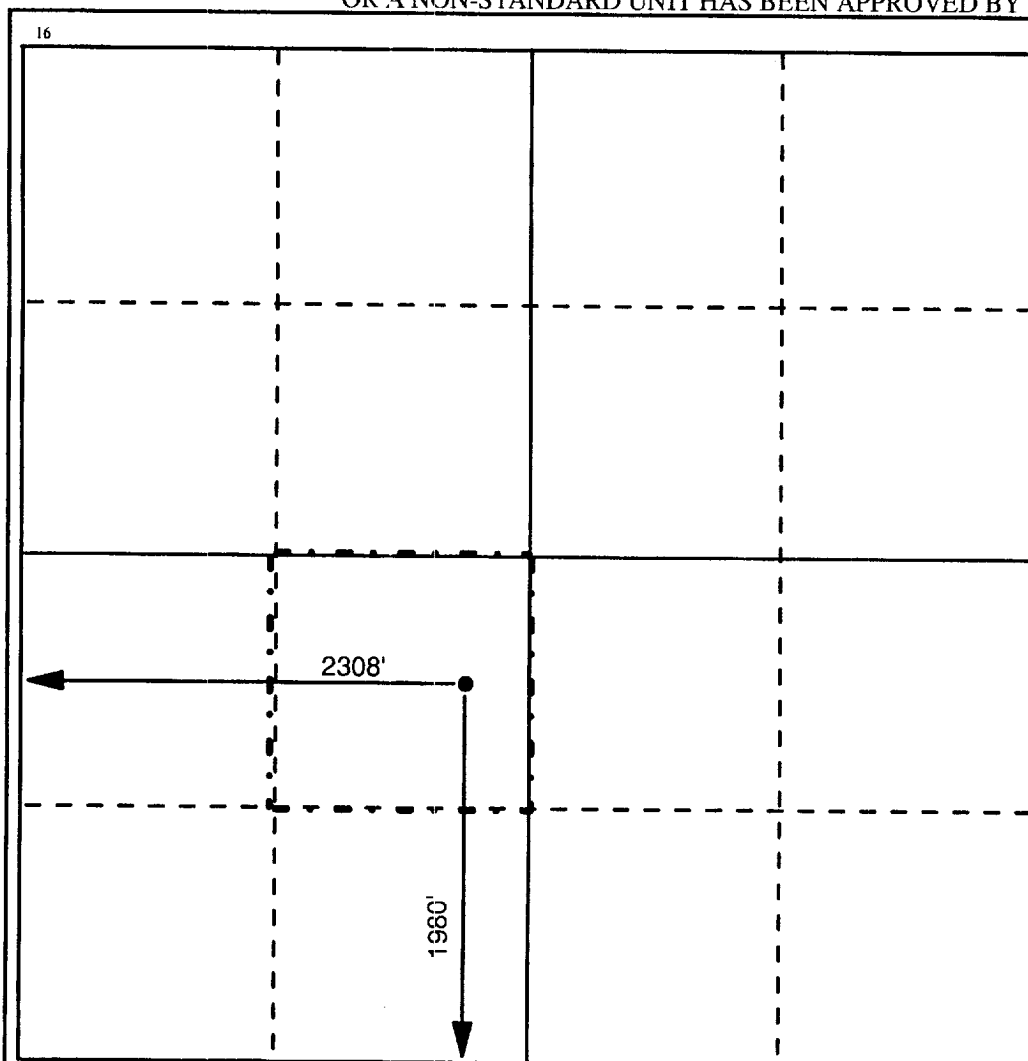

**17 OPERATOR CERTIFICATION**

*I hereby certify that the information contained herein is true and complete to the best of my knowledge and belief.*

Signature  
*Debra J. Anderson*  
Printed Name  
Debra J. Anderson  
Title  
Sr. Engineering Technician  
Date  
08/07/00

**18 SURVEYOR CERTIFICATION**

*I hereby certify that the well location shown on this plat was plotted from field notes of actual surveys made by me or under my supervision, and that the same is true and correct to the best of my belief.*

Date Surveyed  
Signature and Seal of Professional Surveyor

Certificate Number

1121841616  
A  
JUL 16 2009  
RECEIVED  
HOLLY  
2009

APACHE CORPORATION  
LIVINGSTON # 6  
SECTION 3 (Government Long),  
TOWNSHIP 21S, RANGE 37E  
LEA COUNTY, NEW MEXICO

