

NEW MEXICO OIL CONSERVATION COMMISSION  
Santa Fe, New Mexico

NOTICE OF INTENTION TO DRILL OR RECOMPLETE

Notice must be given to the District Office of the Oil Conservation Commission and approval obtained before drilling or recompletion begins. If changes in the proposed plan are considered advisable, a copy of this notice showing such changes will be returned to the sender. Submit this notice in QUINTUPPLICATE. One copy will be returned following approval. See additional instructions in Rules and Regulations of the Commission.

Hobbs, New Mexico  
(Place)

March 6, 1956  
(Date)

OIL CONSERVATION COMMISSION  
SANTA FE, NEW MEXICO

Gentlemen:

You are hereby notified that it is our intention to commence the (Drilling) (Recompletion) of a well to be known as

Hall Oil Company  
(Company or Operator)

Fields

(Lease)

Well No. 1, in 0 The well is

located 660 feet from the South line and 2310 feet from the

East

line of Section 12, T. 31, R. 37, NMPM.

(GIVE LOCATION FROM SECTION LINE)

Ferry-Elmhurst

Pool, Lea County

Section 12

D	C	B	A
E	F	G	H
L	K	J	I
M	N	O	P

Section 12

If State Land the Oil and Gas Lease is No.

If patented land the owner is Jimmie Fields

Address unknown

We propose to drill well with drilling equipment as follows: Rotary Tools

The status of plugging bond is Lien on Bond

Drilling Contractor Moran Drilling Corporation

We intend to complete this well in the Elmhurst formation at an approximate depth of 5935 feet.

CASING PROGRAM

We propose to use the following strings of Casing and to cement them as indicated:

Size of Hole	Size of Casing	Weight per Foot	New or Second Hand	Depth	Sacks Cement
17"	13 3/8"	48	New	370'	300
11"	8 5/8"	32	New	3750'	1500
7 7/8"	5 1/2"	15.5	New	5935'	100

If changes in the above plans become advisable we will notify you immediately.

ADDITIONAL INFORMATION (If recompletion give full details of proposed plan of work.)

Approved  
Except as follows:

MAR 8 1956, 19

OIL CONSERVATION COMMISSION

By

Engineer District

Title

Sincerely yours

Hall Oil Company  
(Company or Operator)

By E. Revill

Position Division Exploitation Engineer  
Send Communications regarding well to

Name Hall Oil Company

Address Hobbs, New Mexico

Hobbs, New Mexico

NEW MEXICO  
OIL CONSERVATION COMMISSION

Form C-128

Well Location and/or Gas Proration Plat

Date March 4, 1956

Operator Shell Oil Company Lease Fields  
Well No. 1 Section 12 Township 1- Range 37- NMPM  
Located 660 Feet From South Line, 2310 Feet From East Line,  
Lea County, New Mexico. G. L. Elevation not available  
Name of Producing Formation Minebry Pool Terry-Minebry Dedicated Acreage 40

(Note: All distances must be from outer boundaries of Section)

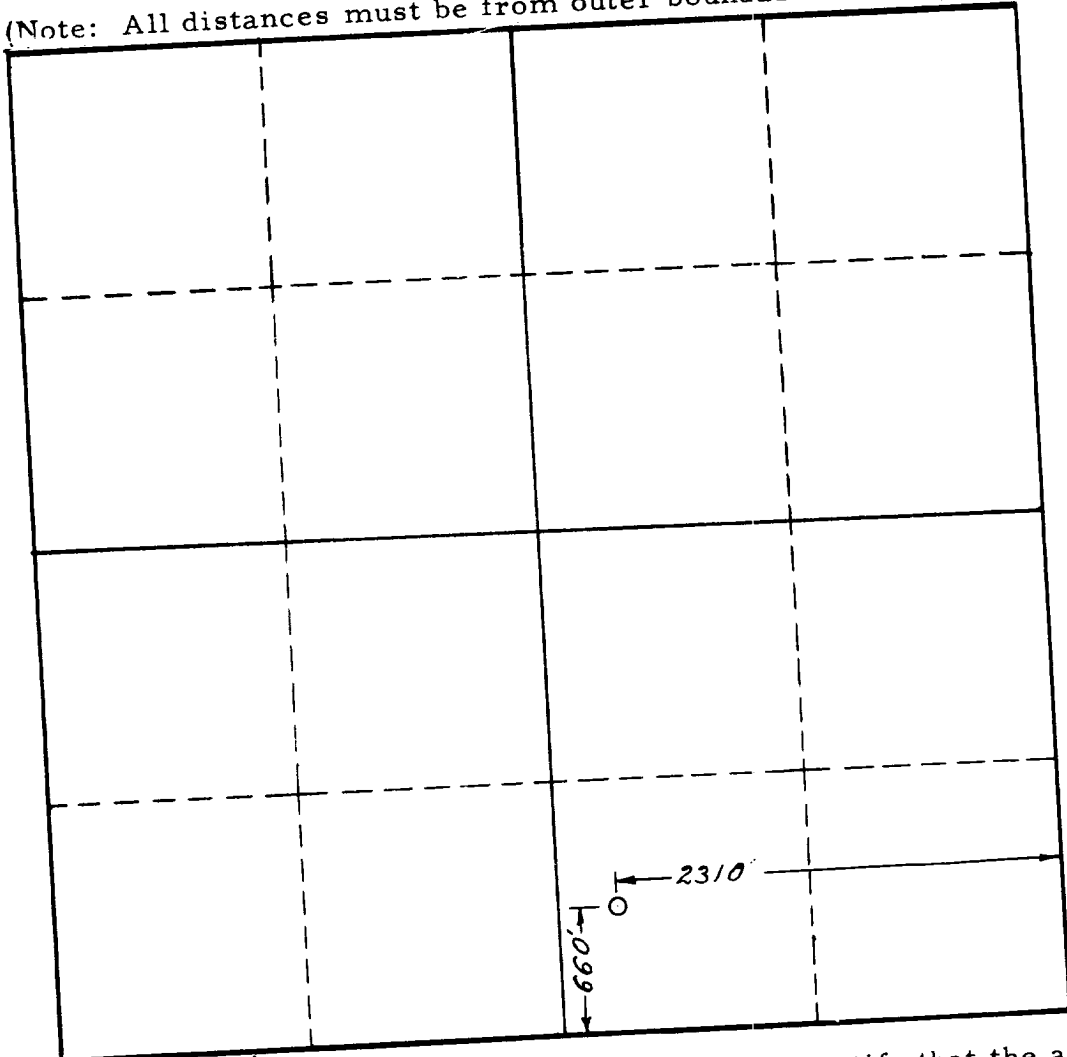

SCALE: 1"=1000'

1. Is this Well a Dual Comp. ? Yes    No X
2. If the answer to Question 1 is yes, are there any other dually completed wells within the dedicated acreage? Yes    No

Name B. Nevill  
Position Division Exploitation Engineer  
Representing Shell Oil Company  
Address Box 1957, Hobbs, New Mexico

This is to certify that the above plat was prepared from field notes of actual survey made by me or under my supervision and that the same are true and correct to the best of my knowledge and belief.

Date Surveyed Feb. 23, 1956  
Heald Shepard Cert. No. 1467  
Registered Professional Engineer and/or  
Land Surveyor

OWWO

COUNTY	LEA	FIELD	Terry	STATE	NM	MN	06553
OPR	SHELL OIL CO.			MAP			
	1 Fields						
	Sec 12, T-21-S, R-37-E			CO-ORD			
	660' FSL, 2310' FEL of Sec						
	Re-Spd 9-30-71			CLASS	OWWO EL 3463E		
	Re-Cmp 10-12-71			FORMATION	DATUM	FORMATION	DATUM
CSG & SX - TUBING							
13 3/8" at 314' w/300 sx							
8 5/8" at 3249' w/1450 sx							
5 1/2" at 5937' w/100 sx.							
LOGS EL GR RA IND HC A							
				TD 5938'; PBD 5930'			

(Blinebry) Perfs 5759-5882' NO NEW POTENTIAL.

Distribution limited and publication prohibited by subscribers' agreement.  
 Reproduction rights reserved by Williams & Lee Scouting Service, Inc.

CONT. PROP DEPTH 5380' TYPE W  
 DATE

11-30-71 F.R.C. 12-2-71; Opr's Elev. 3463' DF  
 PD 5380' WC (Glorieta)  
 (Orig. comp 4-21-56 thru (Blinebry) Perfs 5853-86'  
 OTD 5938', OPE 5935'; OWWO & Re-Cmp 4-25-62 thru  
 Perfs 5759-5882', OPE 5935')  
 TD 5938'; PBD 5930'; COMPLETE  
 Perf (Glorieta) 5360-80' w/1 SF  
 Acid (5360-80') 3000 gals  
 Sgd (5360-80') w/100 sx  
 Drilled Out to 5930'  
 Acid (5759-5882') 3000 gals  
 2-2-71 COMPLETION REPORT