

NEW MEXICO OIL CONSERVATION COMMISSION
Santa Fe, New Mexico

NOTICE OF INTENTION TO DRILL OR RECOMPLETE

Notice must be given to the District Office of the Oil Conservation Commission and approval obtained before drilling or recompletion begins. If changes in the proposed plan are considered advisable, a copy of this notice showing such changes will be returned to the sender. Submit this notice in QUINTUPPLICATE. One copy will be returned following approval. See additional instructions in Rules and Regulations of the Commission. If State Land submit 6 Copies

Hobbs, New Mexico
(Place)

October 27, 1959
(Date)

OIL CONSERVATION COMMISSION
SANTA FE, NEW MEXICO

Gentlemen:

You are hereby notified that it is our intention to commence the (Drilling) ~~Recompletion~~ of a well to be known as

Marlham, Cone & Redfern
(Company or Operator)

Rubanks
(Lease)

Well No. **4**, in **N** (Unit) The well is

located **660** feet from the **South** line and **1800** feet from the

West line of Section **14**, T. **-21-S**, R. **-37-E**, NMPM.

(GIVE LOCATION FROM SECTION LINE) **Terry Blinkey** Pool, **Lee** County

R - 37 - E

D	C	B	A
E	Section 14 F	G	H
L	K	J	I
M	X	O	P

**T
21
S**

If State Land the Oil and Gas Lease is No.

If patented land the owner is **O. R. Rubanks**

Address **Hobbs, New Mexico**

We propose to drill well with drilling equipment as follows: **Rotary tools - surface to total depth**

The status of plugging bond is **\$10,000.00 blanket bond**

Drilling Contractor **Sitten & Norton Drilling Co.**
Lubbock National Bank Building
Lubbock, Texas

We intend to complete this well in the **Terry Blinkey Oil Pool *** formation at an approximate depth of **5000** feet.

CASING PROGRAM

We propose to use the following strings of Casing and to cement them as indicated:

Size of Hole	Size of Casing	Weight per Foot	New or Second Hand	Depth	Sacks Cement
13-3/8"	9-5/8"	36 lb.	New	1370'	
(2-stage cementing on 9-5/8; 100 sz around shoe; 150 sz at approximately 300').					
8-3/4"	7"	23 lb.	New	6850'	
(2-stage cementing on 7" ; 400 sz around shoe; 265 sz at approximately 3600').					

If changes in the above plans become advisable we will notify you immediately.

ADDITIONAL INFORMATION (If recompletion give full details of proposed plan of work.)

- It is proposed to drill this well to a total depth of 7350 feet in order to permit eventual dual completion in either the Drinkard or the Wants Abe Oil Pools.

Approved **OCT 29 1959**, 19.....
Except as follows:

OIL CONSERVATION COMMISSION

Sincerely yours,

Marlham, Cone & Redfern
(Company or Operator)

By **L. O. Stearn**

Position **Professional Engineer**

Send Communications regarding well to

Name **Marlham, Cone & Redfern**
1708 Great Plains Life Building
Address **Lubbock, Texas**

NEW MEXICO OIL CONSERVATION COMMISSION
WELL LOCATION AND ACREAGE DEDICATION PLAT

FORM C-128
 Revised 5/1/57

SEE INSTRUCTIONS FOR COMPLETING THIS FORM ON THE REVERSE SIDE

SECTION A

Operator Markham Come & Redfern		Lease Hubanks		Well No. 249
Unit Letter S	Section 10	Township 21 South	Range 37 East	County Dea County
Actual Footage Location of Well: 660' feet from the South line and 1980' feet from the East line				
Ground Level Elev. 3412	Producing Formation Blinsbury (Clear Fork)	Pool Berry Blinsbury	Dedicated Acreage: 40 Acres	

1. Is the Operator the only owner in the dedicated acreage outlined on the plat below? YES ☒ NO ____ ("Owner" means the person who has the right to drill into and to produce from any pool and to appropriate the production either for himself or for himself and another. (65-3-29 (e) NMSA 1935 Comp.)
2. If the answer to question one is "no," have the interests of all the owners been consolidated by communitization agreement or otherwise? YES ____ NO ____ . If answer is "yes," Type of Consolidation ____
3. If the answer to question two is "no," list all the owners and their respective interests below:

Owner	Land Description

SECTION B

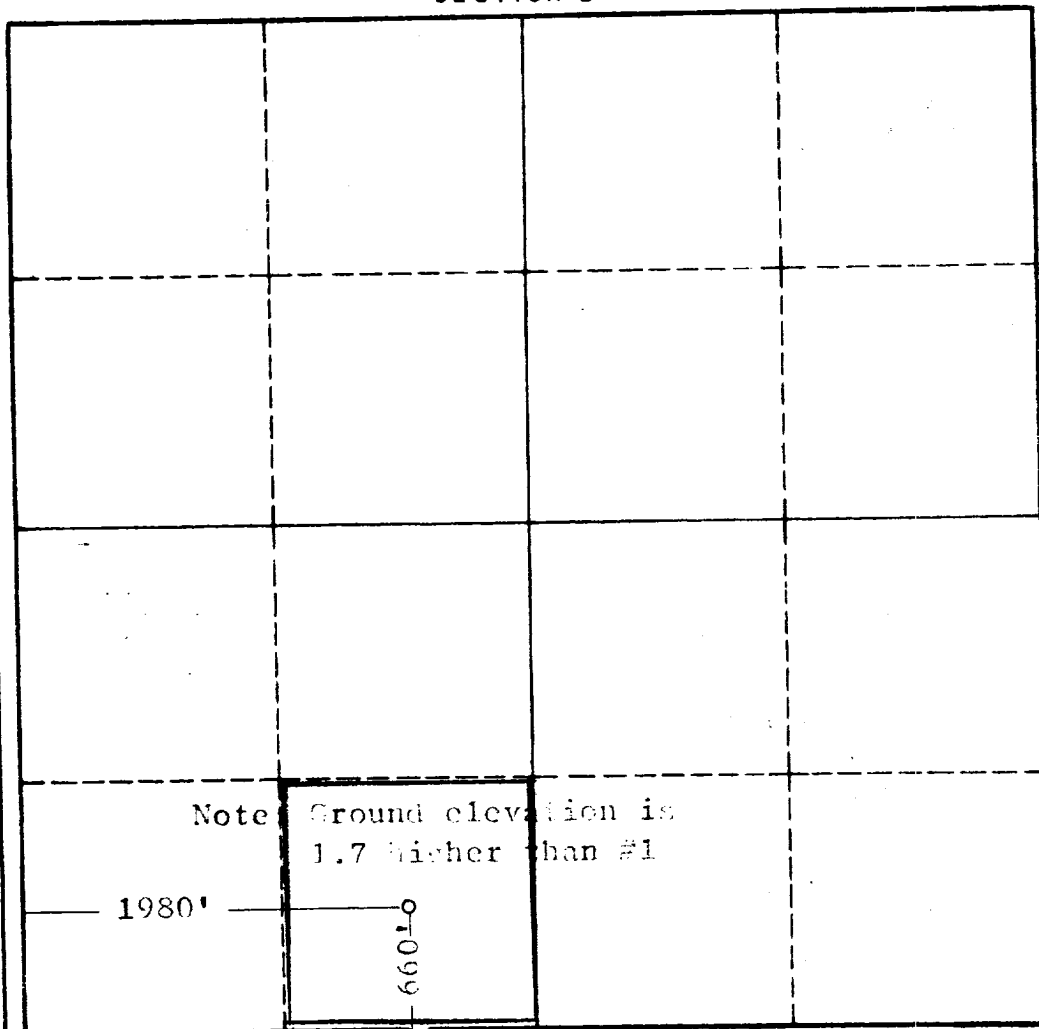

CERTIFICATION

I hereby certify that the information in SECTION A above is true and complete to the best of my knowledge and belief.

Name **Lo Storm**
 Position **Professional Engineer**
 Company **Markham, Come & Redfern**
 Date **October 27, 1959**

I hereby certify that the well location shown on the plat in SECTION B was plotted from field notes of actual surveys made by me or under my supervision, and that the same is true and correct to the best of my knowledge and belief.

Date Surveyed **10-21-59**
 Registered Professional Engineer and/or Land Surveyor, **JORN W. WEST**
 Certificate No. **N.M. - P.E. & L.S. NO. 676**

0 330 660 990 1320 1650 1980 2310 2640 2000 1500 1000 500 0