

NEW MEXICO OIL CONSERVATION COMMISSION  
SANTA FE, NEW MEXICO

Form C-110  
Revised 7/1/55

(File the original and 4 copies with the appropriate district office)

CERTIFICATE OF COMPLIANCE AND AUTHORIZATION  
TO TRANSPORT OIL AND NATURAL GAS

Company or Operator Gulf Oil Corporation Lease Naomi Keenan  
Well No. 2 Unit Letter 0 S 14 T 21S R 37E Pool Terry Elinsbury  
County Lea Kind of Lease (State, Fed. or Patented) Patented  
If well produces oil or condensate, give location of tanks: Unit 0 S 14 T 21S R 37E  
Authorized Transporter of Oil or Condensate Texas-New Mexico Pipeline Co.

Address Box 1510 - Midland, Texas  
(Give address to which approved copy of this form is to be sent)  
Authorized Transporter of Gas ~~Lea Pipeline Co.~~ *Harriet Pitt Corp.*  
Address ~~Box 2376 - Hobbs, New Mexico~~  
(Give address to which approved copy of this form is to be sent)  
If Gas is not being sold, give reasons and also explain its present disposition:

Reasons for Filing: (Please check proper box) New Well ( )  
Change in Transporter of (Check One): Oil ( ) Dry Gas ( ) C'head ( ) Condensate ( )  
Change in Ownership ( ) Other Dual Completion (X)  
Remarks: (Give explanation below)

**Abandoned Drinkard and Dually completed in Terry Elinsbury Oil - Tubbs Gas pays.**

The undersigned certifies that the Rules and Regulations of the Oil Conservation Commission have been complied with.

Executed this the 21 day of April 19 58

Approved \_\_\_\_\_ 19 \_\_\_\_\_

OIL CONSERVATION COMMISSION

By *[Signature]*

Title \_\_\_\_\_

By *[Signature]*

Title Area Production Superintendent

Company Gulf Oil Corporation

Address Box 2167 - Hobbs, New Mexico

NEW MEXICO OIL CONSERVATION COMMISSION  
Well Location and Acreage Dedication Plat

Section A.

HOBBS OFFICE 000  
Date 1958 April 21, 1958  
PM 3:49

Operator Gulf Oil Corporation Lease Naomi Keenum  
Well No. 2 Unit Letter 0 Section 14 Township 21S Range 37E NMPM  
Located 1980 Feet From East Line, 660 Feet From South Line  
County Lea G. L. Elevation 3419' Dedicated Acreage 40 Acres  
Name of Producing Formation Blinebry Pool Terry Blinebry

1. Is the Operator the only owner\* in the dedicated acreage outlined on the plat below?  
Yes X No \_\_\_\_\_.
2. If the answer to question one is "no," have the interests of all the owners been consolidated by communitization agreement or otherwise? Yes \_\_\_\_\_ No \_\_\_\_\_. If answer is "yes," Type of Consolidation \_\_\_\_\_
3. If the answer to question two is "no," list all the owners and their respective interests below:

<u>Owner</u>	<u>Land Description</u>

Section B

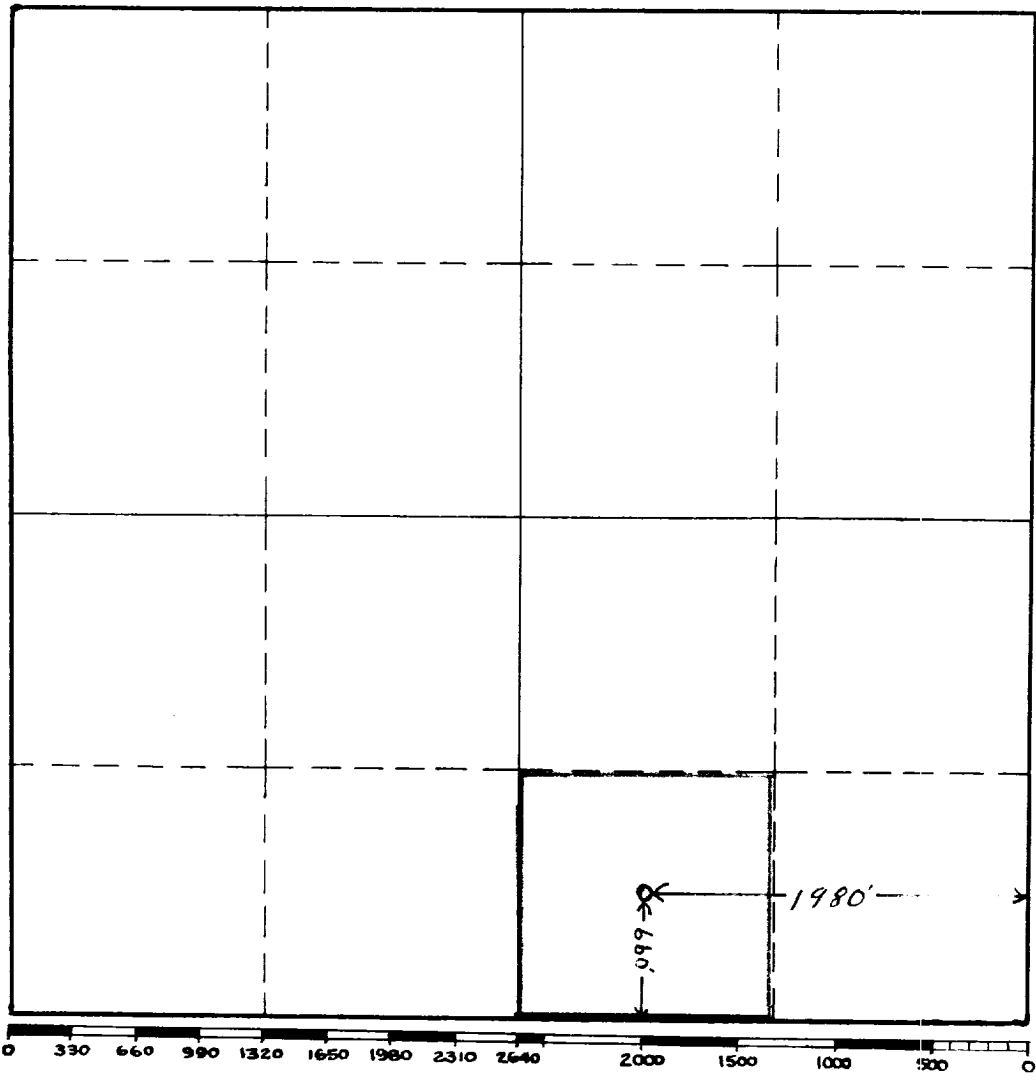

This is to certify that the information in Section A above is true and complete to the best of my knowledge and belief.

Gulf Oil Corporation  
(Operator)  
C. F. Taylor  
(Representative)  
Area Production Superintendent  
Box 2167 - Hobbs, New Mexico  
Address

This is to certify that the well location shown on the plat in Section B was plotted from field notes of actual surveys made by me or under my supervision and that the same is true and correct to the best of my knowledge and belief.

Date Surveyed \_\_\_\_\_  
\_\_\_\_\_  
Registered Professional  
Engineer and/or Land Surveyor.

Certificate No. \_\_\_\_\_

INSTRUCTIONS FOR COMPLETION:

1. Operator shall furnish and certify to the information called for in Section A.
2. Operator shall outline the dedicated acreage for both oil and gas wells on the plat in Section B.
3. A registered professional engineer or land surveyor registered in the State of New Mexico or approved by the Commission shall show on the plat the location of the well and certify this information in the space provided.
4. All distances shown on the plat must be from the outer boundaries of Section.
5. If additional space is needed for listing owners and their respective interests as required in question 3, Section A, please use space below

\* "Owner" means the person who has the right to drill into and to produce from any pool and to appropriate the production either for himself or for himself and another. (65-3-29 (e) NMSA 1953 Comp.)