

Submit to Appropriate
District Office
State Lease - 6 copies
Fee Lease - 5 copies

State of New Mexico
Energy, Minerals and Natural Resources Department

Form C-101
Revised 1-1-89

OIL CONSERVATION DIVISION

P.O. Box 2088
Santa Fe, New Mexico 87504-2088

DISTRICT I
P.O. Box 1980, Hobbs, NM 88240

DISTRICT II
P.O. Drawer DD, Artesia, NM 88210

DISTRICT III
1000 Rio Brazos Rd., Aztec, NM 87410

API NO. (assigned by OCD on New Wells)
N/A 30-025-00599
5. Indicate Type of Lease STATE <input type="checkbox"/> FEE <input checked="" type="checkbox"/>
6. State Oil & Gas Lease No.

APPLICATION FOR PERMIT TO DRILL, DEEPEN, OR PLUG BACK					
1a. Type of Work: DRILL <input type="checkbox"/> RE-ENTER <input type="checkbox"/> DEEPEN <input type="checkbox"/> PLUG BACK <input checked="" type="checkbox"/>				7. Lease Name or Unit Agreement Name	
b. Type of Well: OIL WELL <input checked="" type="checkbox"/> GAS WELL <input type="checkbox"/> OTHER <input type="checkbox"/> SINGLE ZONE <input checked="" type="checkbox"/> MULTIPLE ZONE <input type="checkbox"/>				L. G. Warlick "C"	
2. Name of Operator Marathon Oil Company				8. Well No. 8	
3. Address of Operator P. O. Box 552; Midland, Texas 79702				9. Pool name or Wildcat Hare (Simpson)	
4. Well Location Unit Letter <u>I</u> : <u>1650</u> Feet From The <u>South</u> Line and <u>990</u> Feet From The <u>East</u> Line Section <u>15</u> Township <u>21-S</u> Range <u>37-E</u> NMPM <u>Lea</u> County					
10. Proposed Depth 7365'-7474'		11. Formation Simpson		12. Rotary or C.T. N/A	
13. Elevations (Show whether DF, RT, GR, etc.) DF 3426'; GL 3416'		14. Kind & Status Plug. Bond N/A		15. Drilling Contractor N/A	
16. Approx. Date Work will start Upon approval					
17. PROPOSED CASING AND CEMENT PROGRAM					
SIZE OF HOLE	SIZE OF CASING	WEIGHT PER FOOT	SETTING DEPTH	SACKS OF CEMENT	EST. TOP
17"	13 3/8"	48#	308'	300 sx.	surface
11"	8 5/8"	32#	2,803'	1,300 sx.	
8"	5 1/2"	17#	7,570'	800 sx.	

Marathon Oil Company proposes to recompleate the above referenced well to the Simpson formation upon approval of Form C-101. Following is the recompletion procedure:

1. Test safety anchors.
2. MIRU pulling unit with 7500' 2 7/8" workstring.
3. Lock out pumping unit and unbeam. Load well with fresh water.
4. Remove stuffing box and install rod stripper.
5. POOH w/3/4" rods and 2" x 1 1/4" x 12' pump.
(See Attachment I)

IN ABOVE SPACE DESCRIBE PROPOSED PROGRAM: IF PROPOSAL IS TO DEEPEN OR PLUG BACK, GIVE DATA ON PRESENT PRODUCTIVE ZONE AND PROPOSED NEW PRODUCTIVE ZONE. GIVE BLOWOUT PREVENTER PROGRAM, IF ANY.

I hereby certify that the information above is true and complete to the best of my knowledge and belief.

SIGNATURE [Signature] TITLE Hobbs Prod. Superintendent DATE July 27, 1989
(915)
TYPE OR PRINT NAME J. R. Jenkins TELEPHONE NO. 682-1626

(This space for State Use)

ORIGINAL SIGNED BY JERRY SEXTON
DISTRICT I SUPERVISOR

APPROVED BY _____ TITLE _____ DATE AUG 7 1989

CONDITIONS OF APPROVAL, IF ANY:

Permit Expires 6 Months From Approval.
Date Unless Drilling Underway.

Completion Procedure:

6. Install 3" Series 900 hydraulic BOP's w/2 3/8" pipe rams top and blind rams on bottom.
7. Release Baker tubing anchor set w/12,000# tension @ 5478'. POOH w/2 3/8" 4.7#/ft. tubing, 2 3/8" seating nipple and mud anchor laying down.
8. Switch BOP pipe rams to 2 7/8" and test to 500 psi.
9. RIH w/5 1/2" cement retainer on 2 7/8" workstring. Set retainer @ 5490' and pressure test annulus to 500 psi.
10. MIRU cementers.
11. Establish rate and pressure into perms from 5546' to 5798' w/fresh water. Squeeze perms.
12. Pull out of retaininer and reverse circulate to bit. Pull up leaving kill string in hole and WOC for at least 18 hrs.
13. RIH w/4 3/4" bit and workstring. Drill out retainer and cement and test squeeze to 500 psi.
14. If test is obtained POOH. If not resqueze.
15. RIH and retrieve bridge plug. POOH.
16. RIH w/4 3/4" bit and workstring to PBTD @ 7492', drill cement and CIBP out. Circulate well clean w/2% KCl water to T.D. @ 7626'.
17. POOH w/bit and tubing.
18. MIRU loggers w/full lubricator. Test lubricator to 1000 psi.
19. Run CBL, Gamma Ray, CNL, Array Sonic, and CCL from 7570 (bottom of casing) to 6600'.
20. If cement bond is good. Run CNL, Array Sonic and CCL over same intervals.
21. If cement bond is poor. Run retrievable BP to 7530' and pressure to 1000 psi.
22. Then rerun CBL, Gamma Ray, and CCL from 7530' to 6600'. If cement bond is good. Run CNL, Array Sonic, and CCL over same interval.
23. POOH w/loqqing tools.
24. RD pulling unit.
25. Submit logs to Midland District Engineering for evaluation.
26. MIRU pulling unit.
27. MIRU perforators w/full lubricator. Test lubricator to 1000 psi. Set CIBP at specified depth (determined from log analysis). Dump 1 sx cement on plug.
28. RIH w/casing gun and perforate w/1 shot a foot at recommended depths (to be determined from log analysis).
29. POOH w/wireline.
30. RIH w/2 7/8" workstring and treating packer. Set packer 50' above top perforation. Spot acid to the packer then acidize w/3000 gals 15% HCl using balls for divert.
31. Release pkr. Run downhole to knock balls off perms.
32. Reset pkr in original spot and swab on well to establish fluid productivity.
33. Fracture stimulation will be designed based on swab test results.
34. After stimulation, swab back well to clean up formation.
35. Kill well w/2% KCl water.
36. POOH w/workstring and pkr laying down.
37. Switch BOP pipe rams to 2 3/8" and test to 1000 psi.
38. RIH w/2 3/8" production string, seating nipple and tubing anchor w/BOT @ 7480'. Remove BOP. Install WH. Install rod stripper. RIH w/rods and pump. Final rod design will be made after swab results are obtained.
39. Hang well on and start pumping to production facilities.
40. RDMOL.

NEW MEXICO OIL CONSERVATION COMMISSION
Well Location and Acreage Dedication Plat

Form O-128
Revised 5/1/57

Section A.

Date July 27, 1989

Operator Marathon Oil Company Lease L. O. Warlick "C"
Well No. 8 Unit Letter I Section 15 Township 21 N Range 37 E NMPM
Located 1650 Feet From South Line, 990 Feet From East Line
County Lee G. L. Elevation 3416 Dedicated Acreage 40 Acres
Name of Producing Formation Simpson Pool Hare

1. Is the Operator the only owner* in the dedicated acreage outlined on the plat below?
Yes _____ No X
2. If the answer to question one is "no," have the interests of all the owners been consolidated by communitization agreement or otherwise? Yes X No _____. If answer is "yes," Type of Consolidation Operating Agreement
3. If the answer to question two is "no," list all the owners and their respective interests below:

Owner

Land Description

Section B

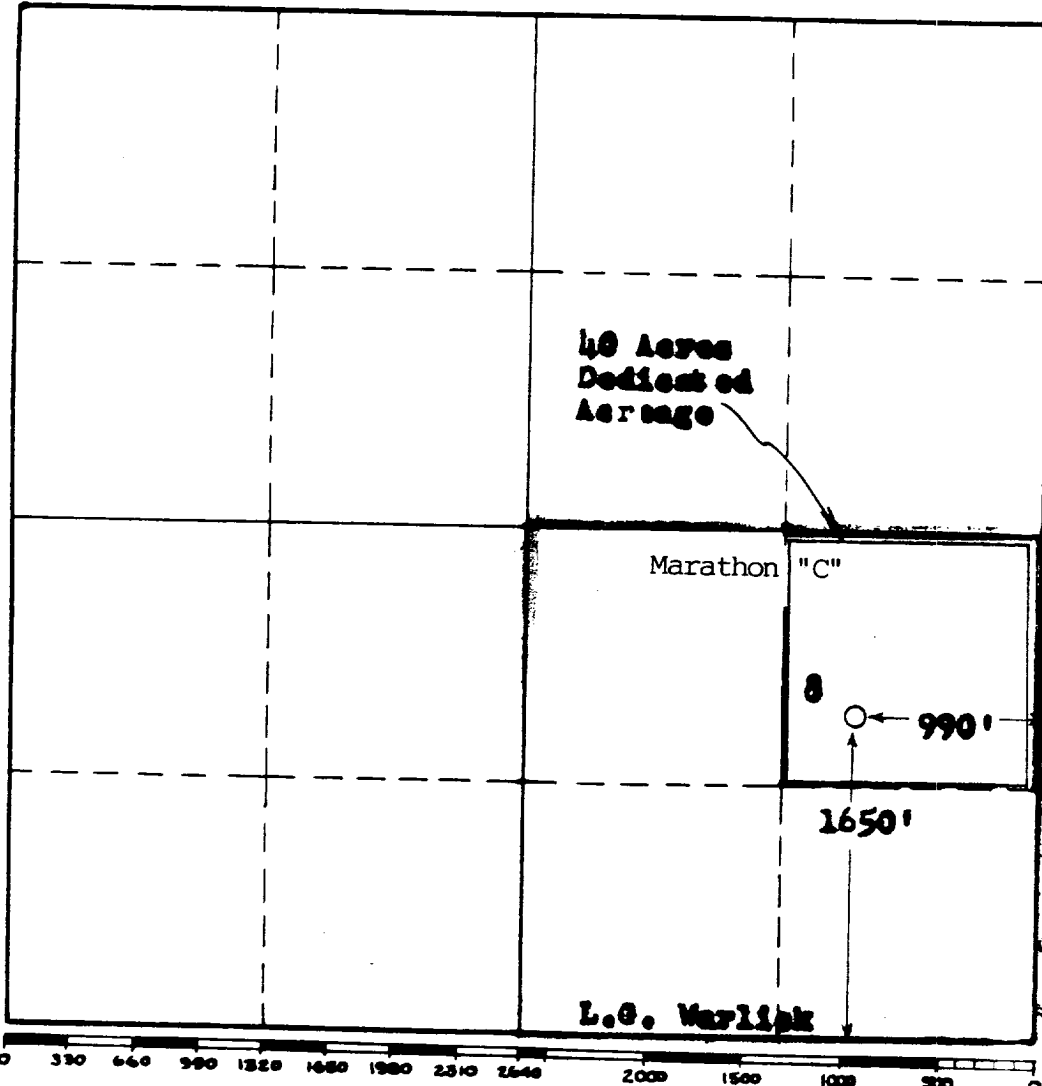

This is to certify that the information in Section A above is true and complete to the best of my knowledge and belief.

Marathon Oil Company
(Operator)

7/27/89
J.R. Jenkins
(Representative)

P. O. Box 552; Midland, TX
Address 79702

This is to certify that the well location shown on the plat in Section B was plotted from field notes of actual surveys made by me or under my supervision and that the same is true and correct to the best of my knowledge and belief.

Date Surveyed _____

Registered Professional
Engineer and/or Land Surveyor.

Certificate No. _____
the reverse side)

(See instructions for completing this form on