

NO. OF COPIES RECEIVED		
DISTRIBUTION		
SANTA FE		
FILE		
U.S.G.S.		
LAND OFFICE		
OPERATOR		

# NEW MEXICO OIL CONSERVATION COMMISSION

Form C-101  
Revised 1-1-65

5A. Indicate Type of Lease	
STATE <input type="checkbox"/>	FEE <input checked="" type="checkbox"/>
5. State Oil & Gas Lease No.	

## APPLICATION FOR PERMIT TO DRILL, DEEPEN, OR PLUG BACK

1a. Type of Work		7. Unit Agreement Name	
b. Type of Well OIL WELL <input type="checkbox"/> GAS WELL <input checked="" type="checkbox"/> OTHER <input type="checkbox"/>		8. Farm or Lease Name <b>Argo</b>	
2. Name of Operator <b>Shell Oil Company</b>		9. Well No. <b>12</b>	
3. Address of Operator <b>P. O. Box 1509, Midland, Texas 79701</b>		10. Field and Pool, or Wildcat <b>Wildcat</b>	
4. Location of Well UNIT LETTER <b>M</b> LOCATED <b>440</b> FEET FROM THE <b>South</b> LINE AND <b>550</b> FEET FROM THE <b>West</b> LINE OF SEC. <b>15</b> TWP. <b>21S</b> RGE. <b>37E</b> NMPM		12. County <b>Lea</b>	
19. Proposed Depth <b>4165 PB</b>		19A. Formation <b>San Andres</b>	
21A. Kind & Status Plug. Bond <b>Blanket</b>		20. Rotary or C.T.	
21. Elevations (Show whether DF, RT, etc.) <b>3444 DF</b>		22. Approx. Date Work will start <b>Immediately</b>	

23.

### PROPOSED CASING AND CEMENT PROGRAM

SIZE OF HOLE	SIZE OF CASING	WEIGHT PER FOOT	SETTING DEPTH	SACKS OF CEMENT	EST. TOP
17 1/2"	13 3/8"	48#	227'	250	Surface
11"	8 5/8"	28#, 32#	2882'	1900	Surface
7 7/8"	5 1/2"	15.5#, 17#	2647-8033'	983	

1. Set CIBP at 4200' and cap with 35' cement.
2. Perforate 5 1/2" liner at 3972, 3978 and 3985.
3. Acid treat and test zone.

EXPIRES 11-11-72

IN ABOVE SPACE DESCRIBE PROPOSED PROGRAM: IF PROPOSAL IS TO DEEPEN OR PLUG BACK, GIVE DATA ON PRESENT PRODUCTIVE ZONE AND PROPOSED NEW PRODUCTIVE ZONE. GIVE BLOWOUT PREVENTER PROGRAM, IF ANY.

I hereby certify that the information above is true and complete to the best of my knowledge and belief.

Signed J. R. Farina J. R. Farina Title Senior Production Engineer Date 8-8-72

(This space for State Use)

APPROVED BY [Signature] TITLE SUPERVISOR DISTRICT I DATE AUG 11 1972

CONDITIONS OF APPROVAL, IF ANY:

If this well is completed as a gas well in the San Andres, it will not be approved until the non-standard location has been approved.

STG 11 200

1 12/11/72

RECEIVED

AUG 10 1972

OIL CONSERVATION COMM.  
HOBBS, N. M.

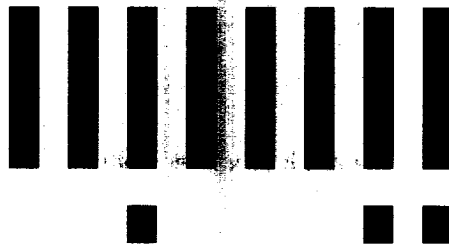

**LTR**

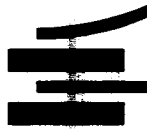

**Job separation sheet**

**NEW MEXICO OIL CONSERVATION COMMISSION  
WELL LOCATION AND ACREAGE DEDICATION PLAT**

Form C-102  
Supersedes C-128  
Effective 1-1-65

All distances must be from the outer boundaries of the Section.

Operator <b>Shell Oil Company</b>			Lease <b>Argo</b>		Well No. <b>12</b>
Unit Letter <b>M</b>	Section <b>15</b>	Township <b>21S</b>	Range <b>37E</b>	County <b>Lea</b>	
Actual Footage Location of Well: <b>440</b> feet from the <b>South</b> line and <b>550</b> feet from the <b>West</b> line					
Ground Level Elev. <b>3444 DF</b>	Producing Formation <b>San Andres</b>		Pool <b>Wildcat</b>		Dedicated Acreage: <b>160</b> Acres

1. Outline the acreage dedicated to the subject well by colored pencil or hachure marks on the plat below.
2. If more than one lease is dedicated to the well, outline each and identify the ownership thereof (both as to working interest and royalty).
3. If more than one lease of different ownership is dedicated to the well, have the interests of all owners been consolidated by communitization, unitization, force-pooling, etc?

☐ Yes    ☐ No    If answer is "yes," type of consolidation \_\_\_\_\_

If answer is "no," list the owners and tract descriptions which have actually been consolidated. (Use reverse side of this form if necessary.) \_\_\_\_\_

No allowable will be assigned to the well until all interests have been consolidated (by communitization, unitization, forced-pooling, or otherwise) or until a non-standard unit, eliminating such interests, has been approved by the Commission.

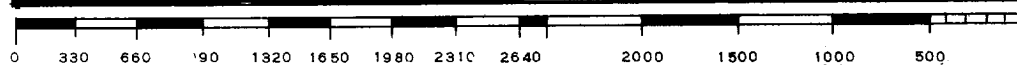
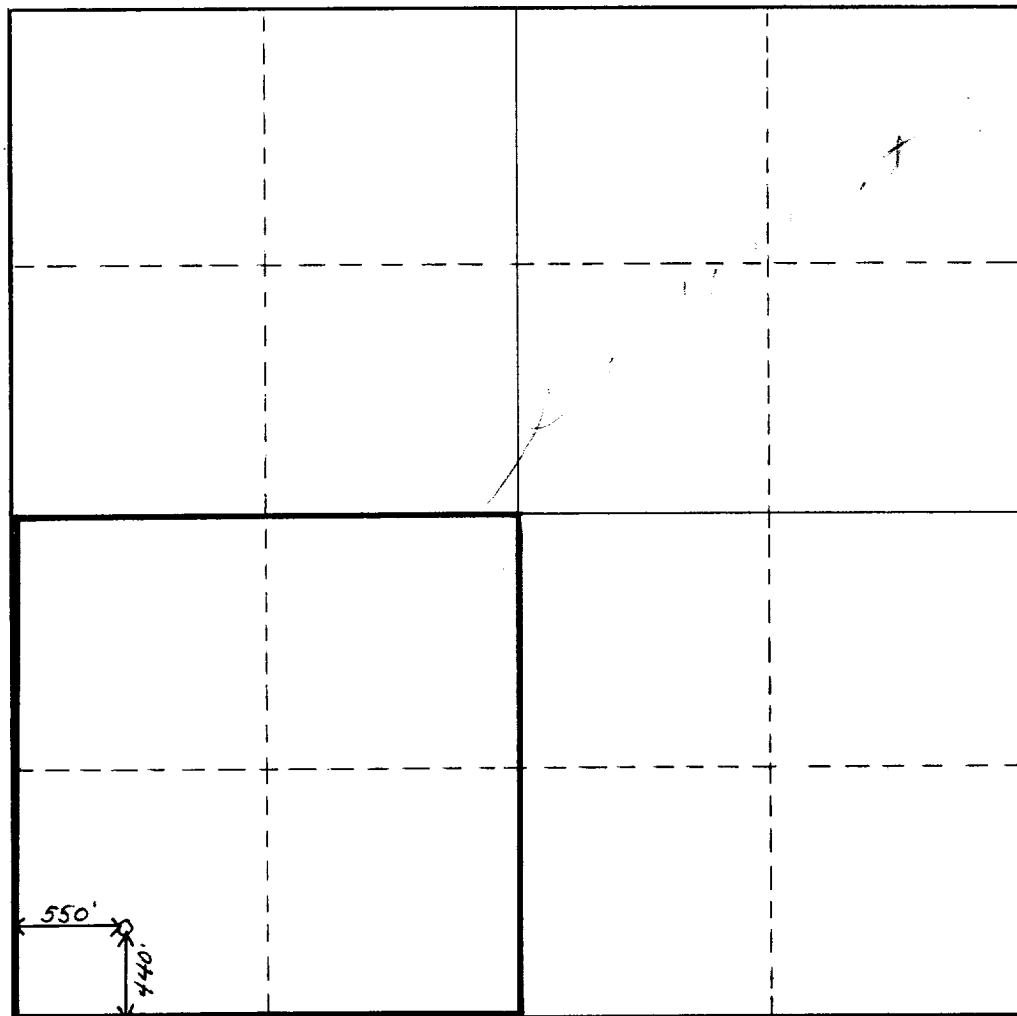

**CERTIFICATION**

*I hereby certify that the information contained herein is true and complete to the best of my knowledge and belief.*

Original signed by

**J. R. Farina**

Name

**J. R. Farina**

Position

**Senior Production Engineer**

Company

**Shell Oil Company**

Date

**8-8-72**

*I hereby certify that the well location shown on this plat was plotted from field notes of actual surveys made by me or under my supervision, and that the same is true and correct to the best of my knowledge and belief.*

Date Surveyed

Registered Professional Engineer  
and/or Land Surveyor

Certificate No.

RECEIVED

AUG 11 1972

OIL CONSERVATION COMM.  
HALL, N. M.