

DISTRICT I

P.O. Box 1980, Hobbs, NM 88240

DISTRICT II

P.O. Box Drawer DD, Artesia, NM 88210

DISTRICT III

1000 Rio Brazos Rd., Aztec, NM 87410

OIL CONSERVATION DIVISION

P.O. Box 2088

Santa Fe, New Mexico 87504-2088

WELL API NO.

30 025 06611

5. Indicate Type of Lease

STATE ☒

FEE

6. State Oil / Gas Lease No.

781470

7. Lease Name or Unit Agreement Name

STATE -S-

8. Well No.

4

9. Pool Name or Wildcat

PENROSE SKELLY GRAYBURG

SUNDRY NOTICES AND REPORTS ON WELLS  
(DO NOT USE THIS FORM FOR PROPOSALS TO DRILL OR TO DEEPEN OR PLUG BACK TO  
DIFFERENT RESERVOIR. USE "APPLICATION FOR PERMIT  
(FORM C-101) FOR SUCH PROPOSALS.

1. Type of Well:

OIL

WELL ☒

GAS

WELL

OTHER

2. Name of Operator

TEXACO EXPLORATION & PRODUCTION INC.

3. Address of Operator

205 E. Bender, HOBBS, NM 88240

4. Well Location

BHL: A, 15, 21S, 37E, 975' FNL, 1059' FEL

Unit Letter C

660

Feet From The NORTH Line and 2080

Feet From The WEST Line

Section 15

Township 21S

Range 37E

NMPM

LEA COUNTY

10. Elevation (Show whether DF, RKB, RT, GR, etc.)

3459'

11. Check Appropriate Box to Indicate Nature of Notice, Report, or Other Data

NOTICE OF INTENTION TO:

PERFORM REMEDIAL WORK

PLUG AND ABANDON

REMEDIAL WORK

ALTERING CASING

TEMPORARILY ABANDON

CHANGE PLANS

COMMENCE DRILLING OPERATION

PLUG AND ABANDONMENT

PULL OR ALTER CASING

CASING TEST AND CEMENT JOB

OTHER:

OTHER:

HORIZONTAL COMPLETION

12. Describe Proposed or Completed Operations (Clearly state all pertinent details, and give pertinent dates, including estimated date of starting any proposed work) SEE RULE 1103.

2-08-01: MIRU. TIH & RUN ULTRA SONIC CEMENT IMAGER FR 5750-2850. TIH W/BAILER. DUMP BAIL 20' CMT ON TOP OF CIBP @ 7650'. TOP OF CMT @ 7630. TIH & SET CIBP @ 5750. DUMP BAIL 20' CMT ON TOP OF CIBP @ 5750. TOP OF CMT @ 5730. 2-10-01: TIH W/242 JTS 2 7/8" WS. NDBOP. NUWH. RD PU. 2-15-01: TIH W/GR. SET CIBP W/TOP OF PLUG @ 3885. (COLLARS @ 3889 & 3856) DESIRED WINDOW TO BE FR 3873-3879.

2-20-01: MIRU KEY. NUBOP. UNLOAD-RACK-COLLAR & STRAP 108 JTS OF SPIRAL WEIGHT DP W/2 7/8" CONNECTIONS & 110 JTS 2 7/8". TIH W/DP & TAG CIBP @ 3878 SLM (7" CORRECTION). TAG W/126 JTS IN HLE. TIH W/5 1/2" CSG WHIPSTOCK TO ABOVE CIBP. RUN GYRO SURVEY FR SURF TO TOP OF WHIPSTOCK & ORIENT WHIPSTOCK TO 98.5 DEG AZIMUTH. 2-21-01: ORIENT & SET WHIPSTOCK @ 97.5 DEG AZIMUTH. MILL FR 3873-3874, 3882. DRILL TO TD OF 3882. 2-22-01: SLIDE FR 3882-

3902, 3933, 4028, 4079, 4096, 4100, 4109, 4130, 4140, 4162, 4177, 4180, 4187, 4204, 4257, 4267, 4320, 4328, 4415, 4421, 4604, 4624, 4707, 4712, 4731, 4736, 4920, 4983, 4986, 5047, 5063, 5070, 5174, 5179, 5238, 5248, 5270, 5374, 5379, 5553, 5571, 5577, 5581, 5665, 5673, 5728, 5733, 5900, 5918, 5949, 5981, 6085. FINAL TD CALLED @ 0330 HRS 3-01-01.

3-02-01: RUN TDT LOG FR 6050-WINDOW. TIH W/RBP TO 3750. SET RBP. NDBOP. 3-03-01: NUBOP & TEST TO 500 PSI. RIG DOWN KEY RIG #118. RIG RELEASED @ 9:00 AM. 3-04-01: LOAD OUT 109 JTS OF 2 7/8" DP. 3-07-01: MOVE OUT HORIZONTAL RIG. PREPARE FOR COMPLETION RIG. MIRU KEY #319. 3-08-01: TIH W/3 1/2" TBG & RETR HEAD. LATCH ON & REL RBP @ 3750'. PU & RUN 2 7/8" TBG W/JET SUBS. 3-09-01: TIH W/3 1/2" TBG PKR & JET SUBS. RUN PORTED SUBS INTO LATERAL. SET PKR @ 3740 & TEST TO 800 PSI. NU FRAC TREE. 3-14-01: ACIDIZE W/4000 GALS 20% HCL. FLUSH W/5000 GALS WF110/SLICK. 3-16-01: RU SWAB. FL @ 1200. 3-17-01: FL @ 800 - 1200 & FLOWING. 3-18-01: FLOWING. 3-20-01: PUMP 35 BBLS 2% KCL DN TBG. ND TREE. REL PKR. LD WS, SN, PKR, X-OVER, & TBG. 3-21-01: PUMP 50 BBLS 2% KCL. KILL WELL. KNOCK OUT CIBP @ 3885 & PUSH TO 5730. PU 1 JT OPEN ENDED 2 7/8" J55 TBG, SN, TAC. TBG @ 4094. SN @ 4063. TAC @ 3690. 3-22-01: KILL W/35 BBLS 2% KCL. NDBOP. SET TAC @ 3690 IN 15,000 TENSION. NUWH. PU PMP & RDS. RIG DOWN.

3-31-01: ON 24 HR OPT. PUMPING 105 BO, 42 BW, & 100 MCF. FINAL REPORT (PBSD @ 5730. CIBP @ 5750, & 3885. TOP OF WINDOW-3873, BOTTOM OF WINDOW @ 3879.

I hereby certify that the information above is true and complete to the best of my knowledge and belief.

SIGNATURE

J. Denise Leake

TITLE

Engineering Assistant

DATE 6/5/01

TYPE OR PRINT NAME

J. Denise Leake

Telephone No. 397-0405

(This space for State Use)

APPROVED

CONDITIONS OF APPROVAL IF ANY:

TITLE

DATE

## DISTRICT I

P.O. Box 1980, Hobbs, NM 88241-1980

## DISTRICT II

P.O. Box Drawer DD, Artesia, NM 88211-0719

## DISTRICT III

1000 Rio Brazos Rd., Aztec, NM 87410

## DISTRICT IV

P.O. Box 2088, Santa Fe, NM 87504-2088

State of New Mexico

Energy, Minerals and Natural Resources Department

Form C-10 2

Revised February 10, 1999

Instructions on back

Submit to Appropriate District Office

State Lease - 4 Copies

Fee Lease - 3 Copies

✓ AMENDED REPORT

## OIL CONSERVATION DIVISION

P.O. Box 2088

Santa Fe, New Mexico 87504-2088

## WELL LOCATION AND ACREAGE DEDICATION PLAT

<sup>1</sup> API Number 30 025 06611	<sup>2</sup> Pool Code 50350	<sup>3</sup> Pool Name PENROSE SKELLY GRAYBURG
<sup>4</sup> Property Code 11110	<sup>5</sup> Property Name STATE -S-	<sup>6</sup> Well No. 4
<sup>7</sup> OGRID Number 022351	<sup>8</sup> Operator Name TEXACO EXPLORATION & PRODUCTION INC.	<sup>9</sup> Elevation 3459'

<sup>10</sup> Surface Location

UI or lot no	Section	Township	Range	Lot.Idn	Feet From The	North/South Line	Feet From The	East/West Line	County
C	15	21S	37E		660	NORTH	2080	WEST	LEA

<sup>11</sup> Bottom Hole Location If Different From Surface

UI or lot no	Section	Township	Range	Lot.Idn	Feet From The	North/South Line	Feet From The	East/West Line	County
A	15	21S	37E		995'	NORTH	1059'	EAST	LEA

<sup>12</sup> Dedicated Acre 120	<sup>13</sup> Joint or Infill No	<sup>14</sup> Consolidation Code	<sup>15</sup> Order No.
-------------------------------------	-------------------------------------	----------------------------------	-------------------------

NO ALLOWABLE WILL BE ASSIGNED TO THIS COMPLETION UNTIL ALL INTERESTS HAVE BEEN CONSOLIDATED  
OR A NON-STANDARD UNIT HAS BEEN APPROVED BY THE DIVISION

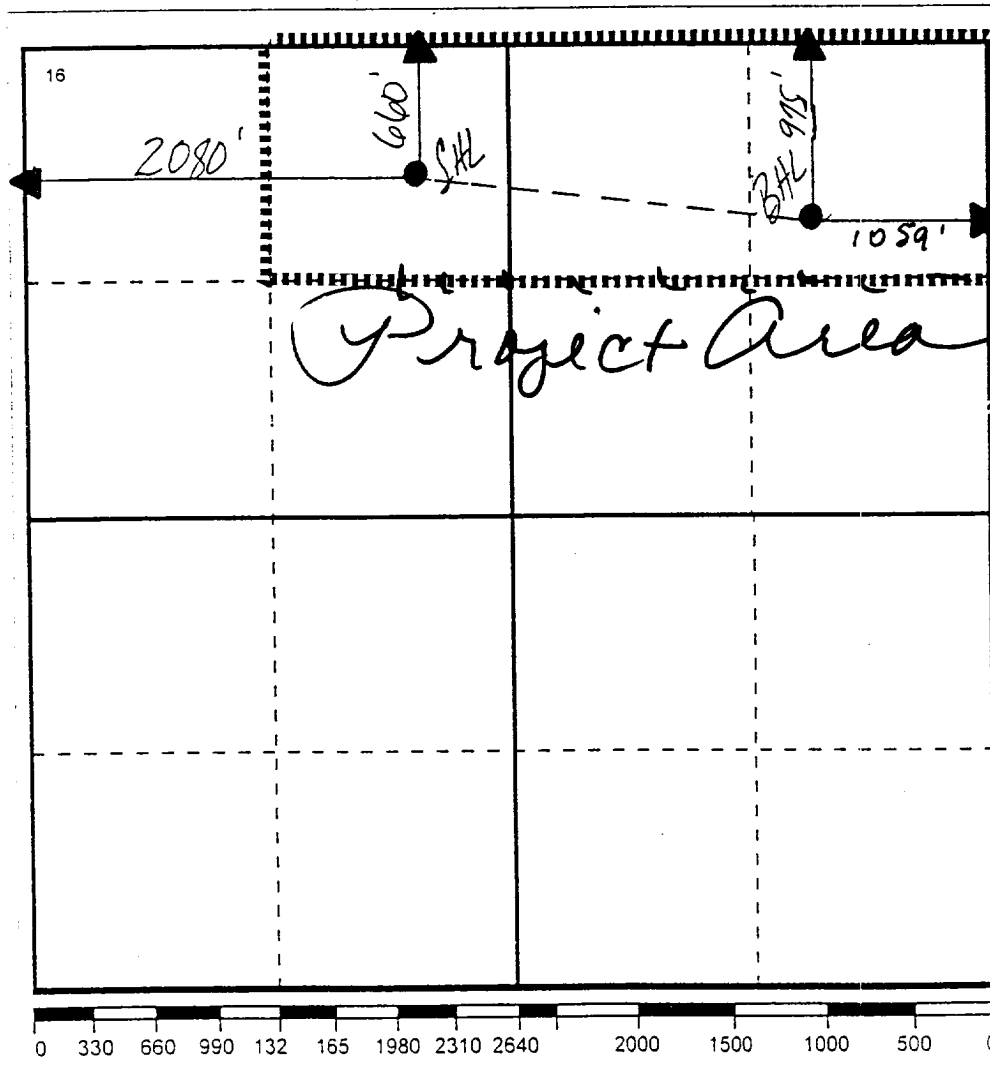

## 17 OPERATOR CERTIFICATION

I hereby certify that the information  
contained herein is true and complete to the  
best of my knowledge and belief

Signature

Printed Name

J. Denise Leake

Position

Engineering Assistant

Date

6-5-01

## 18 SURVEYOR CERTIFICATION

I hereby certify that the well location shown  
on this plat was plotted from field notes of  
actual surveys made by me or under my  
supervision, and that the same is true and  
correct to the best of my knowledge and  
belief.

Date Surveyed

Signature &amp; Seal of

Professional Surveyor

Certificate No.