

DISTRICT I
P.O. Box 1980, Hobbs, NM 88241-1980
DISTRICT II
P.O. Box Drawer DD, Artesia, NM 88211-0719
DISTRICT III
1000 Rio Brazos Rd., Aztec, NM 87410
DISTRICT IV
P.O. Box 2088, Santa Fe, NM 87504-2088

State of New Mexico
Energy, Minerals and Natural Resources Department

Form C-10
Revised February 10, 1999
Instructions on back
Submit to Appropriate District Office
State Lease - 6 Copies
Fee Lease - 5 Copies
AMENDED REPORT

OIL CONSERVATION DIVISION

P.O. Box 2088
Santa Fe, New Mexico 87504-2088

APPLICATION FOR PERMIT TO DRILL, RE-ENTER, DEEPEN, PLUGBACK, OR ADD A ZONE

1 Operator Name and Address		2 OGRID Number
TEXACO EXPLORATION & PRODUCTION INC.		022351
205 E. Bender, HOBBS, NM 88240		3 API Number
		30 025 06611
4 Property Code	5 Property Name	6 Well No.
11110	STATE -S-	4

7 Surface Location									
UI or lot no	Section	Township	Range	Lot.Idn	Feet From The	North/South Line	Feet From The	East/West Line	County
C	15	21S	37E		660	NORTH	2080	WEST	LEA

8 Proposed Bottom Hole Location If Different From Surface									
UI or lot no	Section	Township	Range	Lot.Idn	Feet From The	North/South Line	Feet From The	East/West Line	County
A	15	21S	37E		990	NORTH	990	EAST	LEA
9 Proposed Pool 1					10 Proposed Pool 2				
PENROSE SKELLY GRAYBURG									

11 Work Type Code	12 WellType Code	13 Rotary or C.T.	14 Lease Type Code	15 Ground Level Elevation
P	O	ROTARY	S	3459'
16 Multiple	17 Proposed Depth	18 Formation	19 Contractor	20 Spud Date
No	6065'	GRAYBURG		1/03/01

21 Proposed Casing and Cement Program

SIZE OF HOLE	SIZE OF CASING	WEIGHT PER FOOT	SETTING DEPTH	SACKS OF CEMENT	EST. TOP
NO CHANGE					

22 Describe the proposed program. If this application is to DEEPEN or PLUG BACK give the data on the present productive zone and proposed new productive zone.
Describe the blowout prevention program, if any. Use additional sheets if necessary.

TEXACO INTENDS TO DRILL A HORIZONTAL LATERAL IN THE SUBJECT WELL TO TEST THE GRAYBURG.

KICK OFF POINT: 3830'
1200' FROM SURFACE LOCATION
TVD OF 3970'
BHL: TVD=3835'

Permit Expires 1 Year From Approval
Date of Approval: 12/26/00
Horizontal

23 I hereby certify that the rules and regulations of the Oil Conservation Division have been complied with and that the information given above is true and complete to the best of my knowledge and belief.

Signature

Printed Name

J. Denise Leake

Title

Engineering Assistant

Date

12/12/00

Telephone

397-0405

OIL CONSERVATION DIVISION

Approved By:

Title:

Approval Date:

DEC 26 2000

Expiration Date:

Conditions of Approval:

Attached

DISTRICT I

P.O. Box 1980, Hobbs, NM 88241-1980

DISTRICT II

P.O. Box Drawer DD, Artesia, NM 88211-0719

DISTRICT III

1000 Rio Brazos Rd., Aztec, NM 87410

DISTRICT IV

P.O. Box 2088, Santa Fe, NM 87504-2088

State of New Mexico

Energy, Minerals and Natural Resources Department

Form C-10

Revised February 10, 1999

Instructions on back

Submit to Appropriate District Office

State Lease - 4 Copies

Fee Lease - 3 Copies

AMENDED REPORT

OIL CONSERVATION DIVISION

P.O. Box 2088

Santa Fe, New Mexico 87504-2088

WELL LOCATION AND ACREAGE DEDICATION PLAT

1 API Number 30 025 06611	2 Pool Code 50350	3 Pool Name PENROSE SKELLY GRAYBURG
4 Property Code 11110	5 Property Name STATE -S-	6 Well No. 4
7 OGRID Number 022351	8 Operator Name TEXACO EXPLORATION & PRODUCTION INC.	9 Elevation 3459'

10 Surface Location

UI or lot no	Section	Township	Range	Lot.Idn	Feet From The	North/South Line	Feet From The	East/West Line	County
C	15	21S	37E		660	NORTH	2080	WEST	LEA

11 Bottom Hole Location If Different From Surface

UI or lot no	Section	Township	Range	Lot.Idn	Feet From The	North/South Line	Feet From The	East/West Line	County
A	15	21S	37E		990	NORTH	990	EAST	LEA

12 Dedicated Acre 120	13 Joint or Infill No	14 Consolidation Code	15 Order No.
--------------------------	--------------------------	-----------------------	--------------

NO ALLOWABLE WILL BE ASSIGNED TO THIS COMPLETION UNTIL ALL INTERESTS HAVE BEEN CONSOLIDATED
OR A NON-STANDARD UNIT HAS BEEN APPROVED BY THE DIVISION

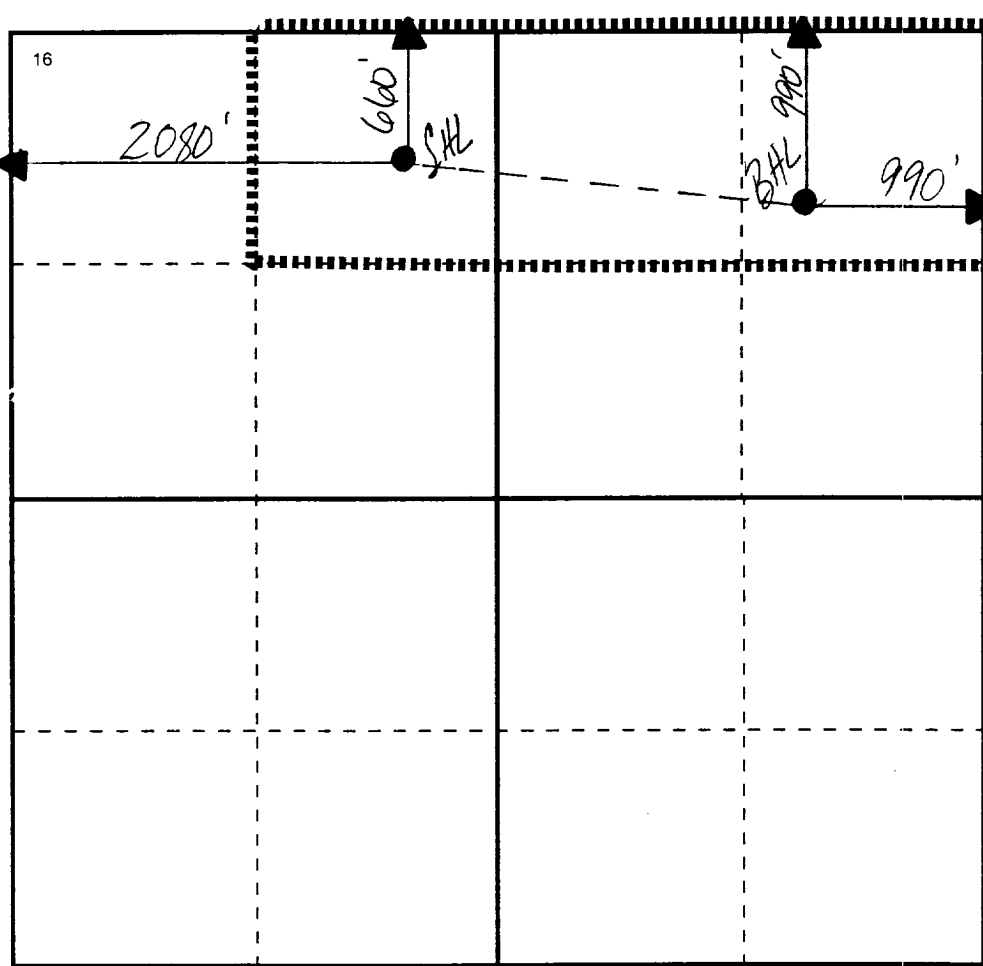

17 OPERATOR CERTIFICATION	
I hereby certify that the information contained herein is true and complete to the best of my knowledge and belief	
Signature	<i>J. Denise Leake</i>
Printed Name	J. Denise Leake
Position	Engineering Assistant
Date	12/12/00
18 SURVEYOR CERTIFICATION	
I hereby certify that the well location shown on this plat was plotted from field notes of actual surveys made by me or under my supervision, and that the same is true and correct to the best of my knowledge and belief.	
Date Surveyed	
Signature & Seal of Professional Surveyor	
Certificate No.	