

AMERADA HESS CORPORATION

February 11, 1972

P. O. DRAWER "D"
MONUMENT, NEW MEXICO 88265

New Mexico Oil Conservation Commission
P. O. Box 2088
Santa Fe, New Mexico 87501

Re: Application of Amerada Hess Corporation for administrative approval of a 160 acre non-standard gas proration unit in the Blinebry completion of its State D "A" well No.4, located in Unit I, Sec.16, T-21-S, R-37-E, Lea County, New Mexico.

Gentlemen:

Amerada Hess Corporation requests that a 160 acre non-standard gas proration unit consisting of the N/2-S/2, Sec.16, T-21-S, R-37-E, Lea County, New Mexico be re-assigned to the State D "A" well No.4.

The subject well was completed in the Blinebry zone and a 160 acre non-standard gas proration unit consisting of the N/2-S/2, Sec.16, T-21-S, R-37-E, was assigned effective January 1, 1954. Application was made and approved by Commission Order NSP-609 for the establishment of an 80 acre non-standard gas proration unit, consisting of the N/2-SE/4, Sec.16, T-21-S, R-37-E, for the subject well effective August 6, 1962. This well was temporarily abandoned January 1, 1965; at which time well No. 5 was completed a Blinebry oil well. Well No. 5 has been temporarily abandoned.

The following operators within Section 16, and with properties closer than 1500' from subject well have been furnished a copy of this application.

Cities Service	Box 69	Hobbs, New Mexico
Continental Oil Co.	Box 460	Hobbs, New Mexico
Sun Oil Company	Box 1861	Midland, Texas
AMOCO Production Co.	Box 68	Hobbs, New Mexico
Gulf Oil Corporation	Box 670	Hobbs, New Mexico
Shell Oil Company	Box 1509	Midland, Texas
Getty Oil Company	Box 249	Hobbs, New Mexico

Form C-102 and a plat of all wells in the area is attached.

Yours very truly,

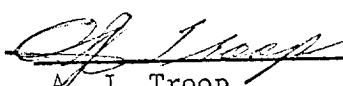
A. J. Troop
Area Superintendent

RECEIVED

FEB 14 1972

AJT:jm

CC: J.I. Johnson

OIL CONSERVATION COMM.
HOBBES, N. M.

**NEW M CO OIL CONSERVATION COMMISSION
WELL LOCATION AND ACREAGE DEDICATION PLAT**

Form C-102
Supersedes C-128
Effective 1-1-65

All distances must be from the outer boundaries of the Section.

Operator Amerada Hess Corporation			Lease State D "A"		Well No. 4
Unit Letter I	Section 16	Township 21-S	Range 37-E	County Lea	
Actual Footage Location of Well: 1980 feet from the South line and 660 feet from the East line					
Ground Level Elev: 3474' DF	Producing Formation Blinebry		Pool Blinebry Gas		Dedicated Acreage: 160 Acres

1. Outline the acreage dedicated to the subject well by colored pencil or hachure marks on the plat below.
2. If more than one lease is dedicated to the well, outline each and identify the ownership thereof (both as to working interest and royalty).
3. If more than one lease of different ownership is dedicated to the well, have the interests of all owners been consolidated by communitization, unitization, force-pooling, etc?

☐ Yes ☐ No If answer is "yes," type of consolidation _____

If answer is "no," list the owners and tract descriptions which have actually been consolidated. (Use reverse side of this form if necessary.) _____

No allowable will be assigned to the well until all interests have been consolidated (by communitization, unitization, forced-pooling, or otherwise) or until a non-standard unit, eliminating such interests, has been approved by the Commission.

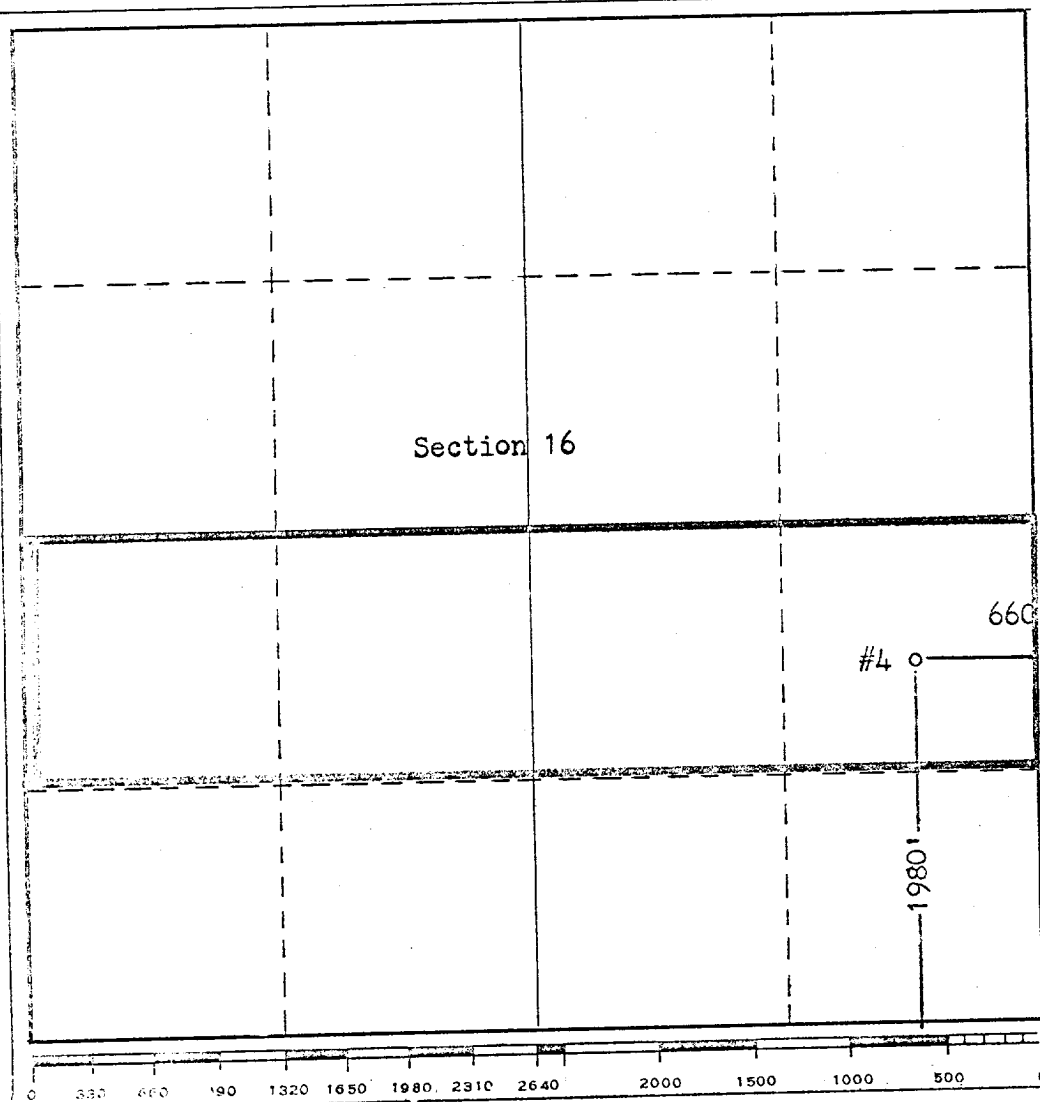

CERTIFICATION

I hereby certify that the information contained herein is true and complete to the best of my knowledge and belief.

Name _____
 Position
Area Superintendent
 Company
Amerada Hess Corporation
 Date
February 11, 1972

I hereby certify that the well location shown on this plat was plotted from field notes of actual surveys made by me or under my supervision, and that the same is true and correct to the best of my knowledge and belief.

Date Surveyed _____
 Registered Professional Engineer and/or Land Surveyor _____
 Certificate No. _____

T
21
S

EUNICE FIELD
Lea Co., New Mexico
Scale: 1" = 2000'

Scale: 1" = 2000'