

NEW MEXICO OIL CONSERVATION COMMISSION
WELL LOCATION AND ACREAGE DEDICATION PLAT

FORM C-128
 Revised 5/1/57

SEE INSTRUCTIONS FOR COMPLETING THIS FORM ON THE REVERSE SIDE

SECTION A

Operator Continental Oil Company			Lease Lockhart A-17 1961 JUN 21		Well No. 2M 12 42
Unit Letter I	Section 17	Township 21-S	Range 37-E	County Lea	
Actual Footage Location of Well: 1980 feet from the South line and 660 feet from the East line					
Ground Level Elev. 3460' GL	Producing Formation Queen		Pool Eumont Gas	Dedicated Acreage: 240 Acres	

1. Is the Operator the only owner in the dedicated acreage outlined on the plat below? YES ☒ NO ____ ("Owner" means the person who has the right to drill into and to produce from any pool and to appropriate the production either for himself or for himself and another. (65-3-29 (e) NMSA 1935 Comp.)
2. If the answer to question one is "no," have the interests of all the owners been consolidated by communization agreement or otherwise? YES ____ NO ____ . If answer is "yes," Type of Consolidation _____
3. If the answer to question two is "no," list all the owners and their respective interests below:

Owner	Land Description

SECTION B

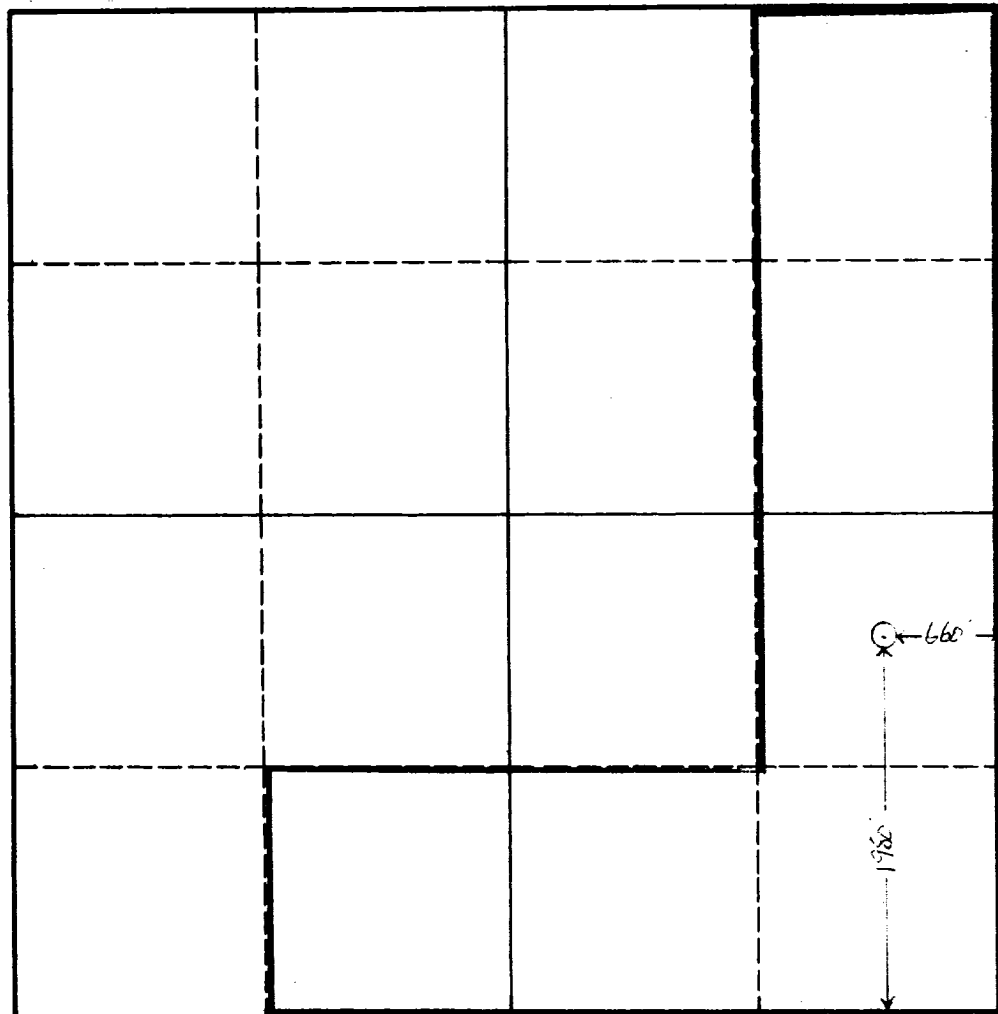

CERTIFICATION

I hereby certify that the information in SECTION A above is true and complete to the best of my knowledge and belief.

Name
J. R. Parker
 Position
District Superintendent
 Company
Continental Oil Company
 Date
June 19, 1961

I hereby certify that the well location shown on the plat in SECTION B was plotted from field notes of actual surveys made by me or under my supervision, and that the same is true and correct to the best of my knowledge and belief.

Date Surveyed
Unknown
 Registered Professional Engineer and/or Land Surveyor

Certificate No.

0 330 660 990 1320 1650 1980 2310 2640 2000 1500 1000 500 0

INSTRUCTIONS FOR COMPLETION OF FORM C-128

1. Operator shall furnish and certify to the information called for in Section A.
 2. Operator shall outline the dedicated acreage for *both* oil and gas wells on the plat in Section B.
 3. A registered professional engineer or land surveyor registered in the State of New Mexico or approved by the Commission shall show on the plat the location of the well and certify this information in the space provided.
 4. All distances shown on the plat must be from the outer boundaries of the Section.
 5. If additional space is needed for listing owners and their respective interests as required in question 3 of Section A, please use space below.
- [Handwritten signature/initials]*

NEW MEXICO OIL CONSERVATION COMMISSION

FORM C-128
Revised 5/1/57

WELL LOCATION AND ACREAGE DEDICATION PLAT

SEE INSTRUCTIONS FOR COMPLETING THIS FORM ON THE REVERSE SIDE

SECTION A

Operator Continental Oil Company		Lease Lockhart A-17		Well No. 2
Unit Letter I	Section 17	Township 21-S	Range 37-E	County Lea
Actual Footage Location of Well: 1980 feet from the South line and 660 feet from the East line				
Ground Level Elev. 3460' OL	Producing Formation Queen	Pool Eumont Gas	Dedicated Acreage: 240 Acres	

1. Is the Operator the only owner in the dedicated acreage outlined on the plat below? YES ☒ NO ☐ ("Owner" means the person who has the right to drill into and to produce from any pool and to appropriate the production either for himself or for himself and another. (65-3-29 (e) NMSA 1935 Comp.)
2. If the answer to question one is "no," have the interests of all the owners been consolidated by communization agreement or otherwise? YES ☐ NO ☐ If answer is "yes," Type of Consolidation _____
3. If the answer to question two is "no," list all the owners and their respective interests below:

Owner	Land Description

SECTION B

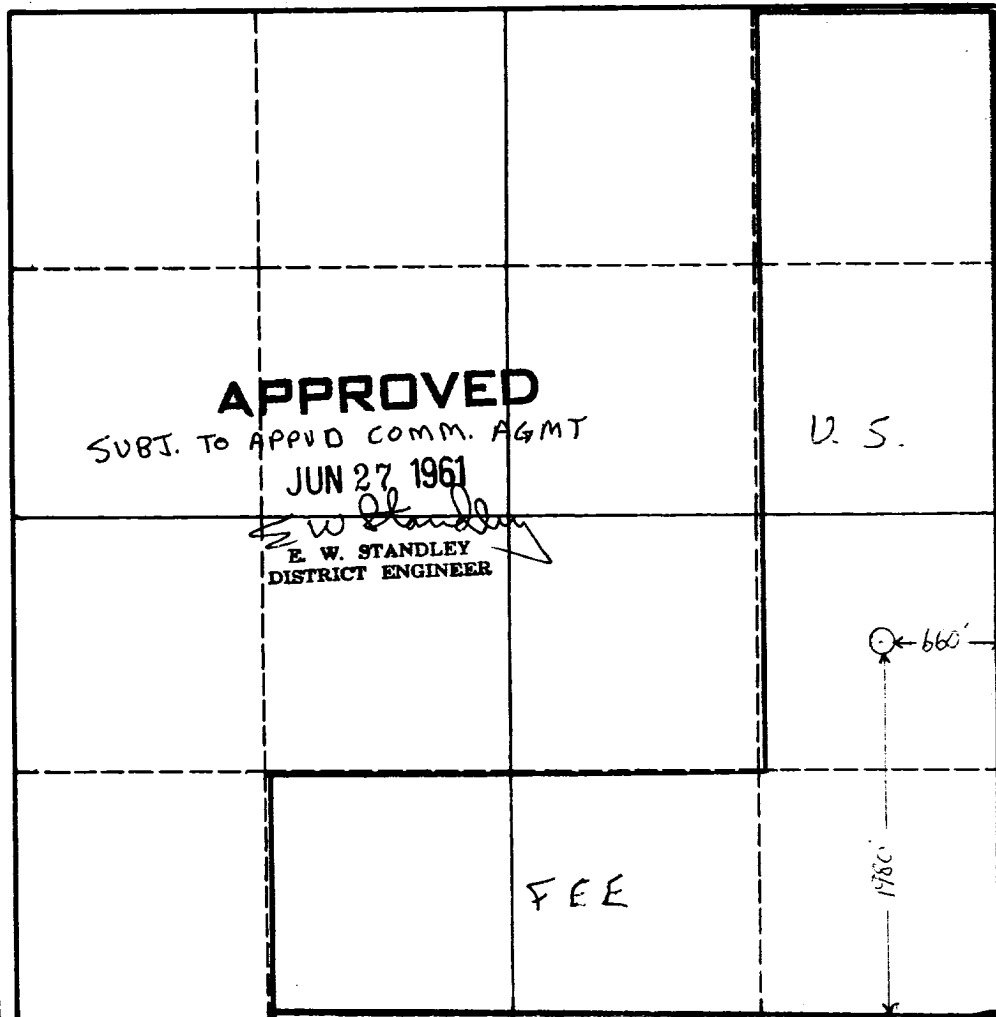

CERTIFICATION

I hereby certify that the information in SECTION A above is true and complete to the best of my knowledge and belief.

Name
J. R. Parker
Position
District Superintendent
Company
Continental Oil Company
Date
June 19, 1961

I hereby certify that the well location shown on the plat in SECTION B was plotted from field notes of actual surveys made by me or under my supervision, and that the same is true and correct to the best of my knowledge and belief.

Date Surveyed
Unknown
Registered Professional Engineer and/or Land Surveyor

Certificate No.

0 330 660 990 1320 1650 1980 2310 2640 2000 1500 1000 500 0

INSTRUCTIONS FOR COMPLETION OF FORM C-128

1. Operator shall furnish and certify to the information called for in Section A.
2. Operator shall outline the dedicated acreage for *both* oil and gas wells on the plat in Section B.
3. A registered professional engineer or land surveyor registered in the State of New Mexico or approved by the Commission shall show on the plat the location of the well and certify this information in the space provided.
4. All distances shown on the plat must be from the outer boundaries of the Section.
5. If additional space is needed for listing owners and their respective interests as required in question 3 of Section A, please use space below.

NEW MEXICO OIL CONSERVATION COMMISSION
WELL LOCATION AND ACREAGE DEDICATION PLAT

FORM C-128
Revised 5/1/57

SEE INSTRUCTIONS FOR COMPLETING THIS FORM ON THE REVERSE SIDE

SECTION A

Operator Continental Oil Company		Lease Lockhart A-17		Well No. 2
Unit Letter I	Section 17	Township 21	Range 37	County Lea
Actual Footage Location of Well: 1980 feet from the South line and 660 feet from the East line				
Ground Level Elev. 3460	Producing Formation Burnt Green	Pool Bumont	Dedicated Acreage: 160 Acres	

1. Is the Operator the only owner in the dedicated acreage outlined on the plat below? YES **II** NO ____ . ("Owner" means the person who has the right to drill into and to produce from any pool and to appropriate the production either for himself or for himself and another. (65-3-29 (e) NMSA 1935 Comp.)
2. If the answer to question one is "no," have the interests of all the owners been consolidated by communitization agreement or otherwise? YES ____ NO ____ . If answer is "yes," Type of Consolidation ____
3. If the answer to question two is "no," list all the owners and their respective interests below:

Owner	Land Description

SECTION B

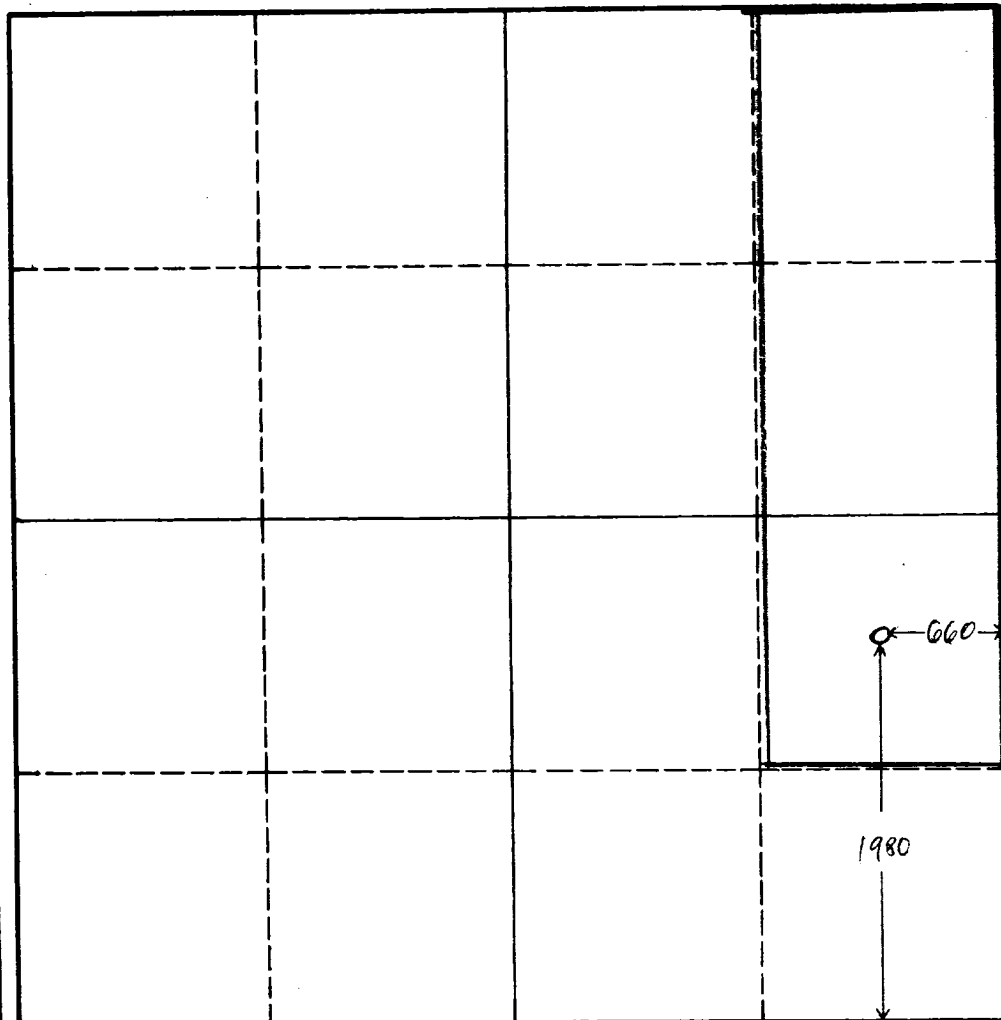

CERTIFICATION

I hereby certify that the information in SECTION A above is true and complete to the best of my knowledge and belief.

Name
J. R. Parker

Position
District Superintendent

Company
Continental Oil Co

Date
4-24-59

I hereby certify that the well location shown on the plat in SECTION B was plotted from field notes of actual surveys made by me or under my supervision, and that the same is true and correct to the best of my knowledge and belief.

Date Surveyed

Registered Professional Engineer and/or Land Surveyor

Certificate No.

INSTRUCTIONS FOR COMPLETION OF FORM C-128

1. Operator shall furnish and certify to the information called for in Section A.
2. Operator shall outline the dedicated acreage for *both* oil and gas wells on the plat in Section B.
3. A registered professional engineer or land surveyor registered in the State of New Mexico or approved by the Commission shall show on the plat the location of the well and certify this information in the space provided.
4. All distances shown on the plat must be from the outer boundaries of the Section.
5. If additional space is needed for listing owners and their respective interests as required in question 3 of Section A, please use space below.

COUNTY LEA FIELD Penrose-Skelly STATE NM
 OPR CONOCO, INC. API 30-025-06637
 NO 2 LEASE Lockhart "A-17" MAP
 Sec 17, T21S, R37E COORD
 1980 FSL, 660 FEL of Sec 7-3-41 NM
 2 mi N/Eunice RE-SPD 4-17-83 RE-CMP 5-3-83

CSC	WELL CLASS INIT DX FIN DO LSE CODE			
	FORMATION	DATUM	FORMATION	DATUM
13 3/8-195-200 sx				
9 5/8-2538-450 sx				
5 1/2-6620-500 sx				
2 3/8-3784				
	TD 6630 (QUEN)		PBD 5500	

IP (Grayburg) Perfs 3688-3765 P 9 BOPD + 14 BW. Pot
 based on 24 hr test. GOR 9444; gty (NR)

CONTR OPRSELEV 3470 DF sub-s

F.R.C. 7-16-83 OWWO
 PD 6300 WO
 (Orig. Continental Oil Co., Cmp. 6-12-47 thru
 (Drinkard) Perfs 6565-6603, OTD 6630, OPB 6620;
 OWWO & Re-Cmp. 5-14-79 thru (Seven Rivers-Queen)
 Perfs 3525-60, OTD 6630, OPB 6300; OWWO & Re-
 Cmp. 8-1-79 thru (Blaine) Perfs 5556-5948, OTD
 6630, OPB 6300; OWWO & Re-Cmp. 8-1-79 thru (Seven
 Rivers-Queen) Perfs 3525-65, OTD 6630, OPB 6300;
 OWWO & Re-Cmp. 4-15-81 thru (Blaine) Perfs
 5556-5948, OTD 6630, OPB 6300)
 7-11-83 TD 6630; PBD 5500; Complete
 CIBP @ 5500
 Perf (Grayburg) 3688-3765
 Acid (3688-3765) 1175 gals
 Frac (3688-3765) 31,500 gals + 58,212# sd
 7-16-83 COMPLETION ISSUED 7-3-41 NM
 IC 30-025-70423-83



[illegible]

1-4-30 NM
10 30-025-70059-82
