

NEW MEXICO OIL CONSERVATION COMMISSION  
WELL LOCATION AND ACREAGE DEDICATION PLAT

Form O-107  
Supersedes O-128  
Effective 1-1-61

All distances must be from the outer boundaries of the Section.

|  |   |                         |                              |                                       |                       |
|--|---|-------------------------|------------------------------|---------------------------------------|-----------------------|
| Operator:<br><b>Petro-Lewis Corporation</b>  |   |                         | Lease:<br><b>Warlick "A"</b> |                                       | Well No.:<br><b>1</b> |
| Unit Letter:<br><b>I</b>   | Section:<br><b>19</b>                   | Township:<br><b>21S</b> | Range:<br><b>37E</b>         | County:<br><b>Lea</b>                 |                       |
| Actual Footage Location of Well:<br><b>1980</b> feet from the <b>S</b> line and <b>660</b> feet from the <b>E</b> line |   |                         |                              |                                       |                       |
| Ground Level Elev.:<br><b>1980</b>   | Producing Formation:<br><b>Blinebry</b> |                         | Pool:<br><b>Drinkard</b>     | Dedicated Acreage:<br><b>40</b> Acres |                       |

1. Outline the acreage dedicated to the subject well by colored pencil or hachure marks on the plat below.
2. If more than one lease is dedicated to the well, outline each and identify the ownership thereof (both as to working interest and royalty).
3. If more than one lease of different ownership is dedicated to the well, have the interests of all owners been consolidated by communitization, unitization, force-pooling, etc?

☐ Yes ☐ No If answer is "yes," type of consolidation \_\_\_\_\_

If answer is "no," list the owners and tract descriptions which have actually been consolidated. (Use reverse side of this form if necessary.) \_\_\_\_\_

No allowable will be assigned to the well until all interests have been consolidated (by communitization, unitization, forced-pooling, or otherwise) or until a non-standard unit, eliminating such interests, has been approved by the Commission.

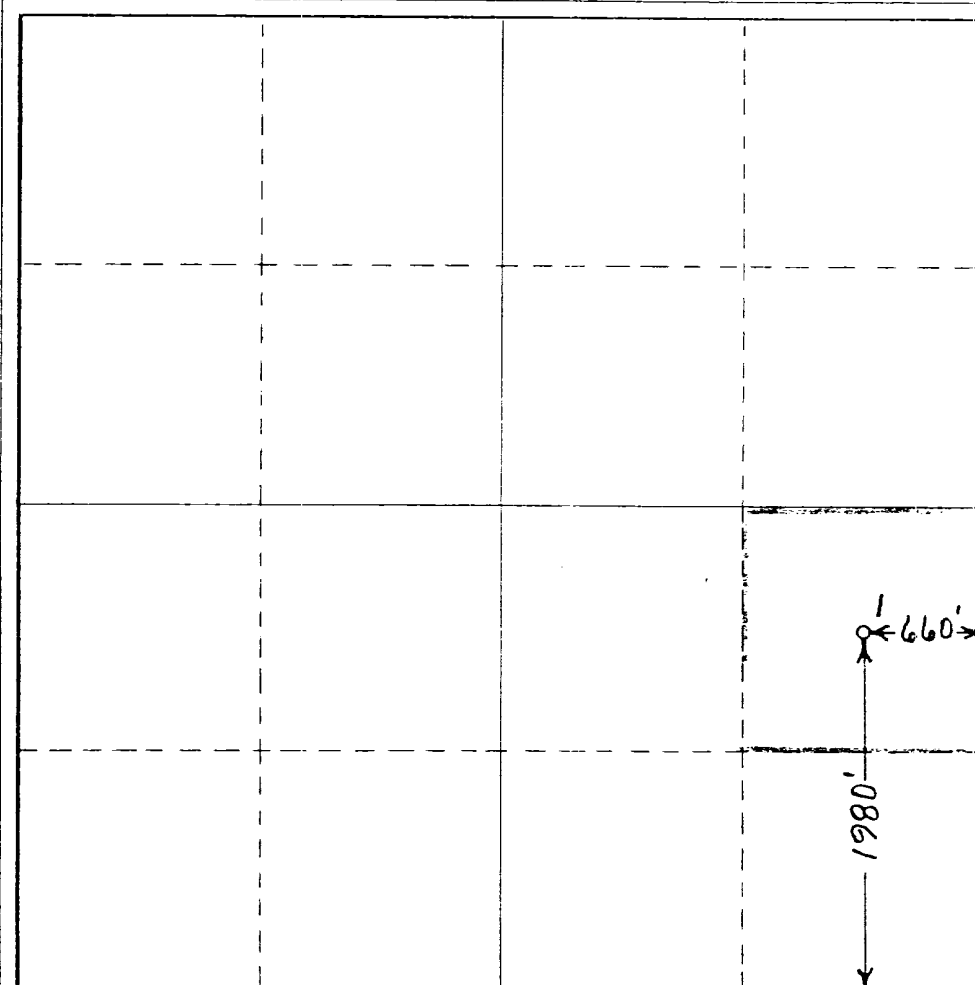

CERTIFICATION

I hereby certify that the information contained herein is true and complete to the best of my knowledge and belief.

Name  
**Mike Handren**

Position  
**Staff Operations Engineer**

Company  
**Petro-Lewis Corporation**

Date  
**June 9, 1980**

I hereby certify that the well location shown on this plat was plotted from field notes of actual surveys made by me or under my supervision, and that the same is true and correct to the best of my knowledge and belief.

Date Surveyed

Registered Professional Engineer  
and/or Land Surveyor

Certificate No.

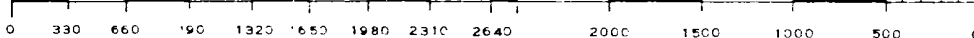

NEW MEXICO OIL CONSERVATION COMMISSION  
WELL LOCATION AND ACREAGE DEDICATION PLAT

Form O-1  
Supersedes O-127  
Effective 1-1-81

All distances must be from the outer boundaries of the Section

|   |                                      |                        |  |                      |                      |
|---|--------------------------------------|------------------------|--|----------------------|----------------------|
| Owner<br><b>Petro-Lewis Corporation</b>   |                                      |                        | Lease<br><b>Warlick "A"</b>            |                      | Well No.<br><b>1</b> |
| Section<br><b>I</b>   | Range<br><b>19</b>                   | Township<br><b>21S</b> | Range<br><b>37E</b>                    | County<br><b>Lea</b> |                      |
| Actual Footage Location of Well:<br><b>1980</b> feet from the <b>South</b> line and <b>660</b> feet from the <b>East</b> line |                                      |                        |  |                      |                      |
| Ground Level Elev.<br><b>1980</b>   | Producing Formation<br><b>Eumont</b> |                        | Dedicated Acreage:<br><b>160</b> Acres |                      |                      |

1. Outline the acreage dedicated to the subject well by colored pencil or hachure marks on the plat below.
2. If more than one lease is dedicated to the well, outline each and identify the ownership thereof (both as to working interest and royalty).
3. If more than one lease of different ownership is dedicated to the well, have the interests of all owners been consolidated by communitization, unitization, force-pooling, etc?

☐ Yes ☐ No If answer is "yes," type of consolidation \_\_\_\_\_

If answer is "no," list the owners and tract descriptions which have actually been consolidated. (Use reverse side of this form if necessary.) \_\_\_\_\_

No allowable will be assigned to the well until all interests have been consolidated (by communitization, unitization, forced-pooling, or otherwise) or until a non-standard unit, eliminating such interests, has been approved by the Commission.

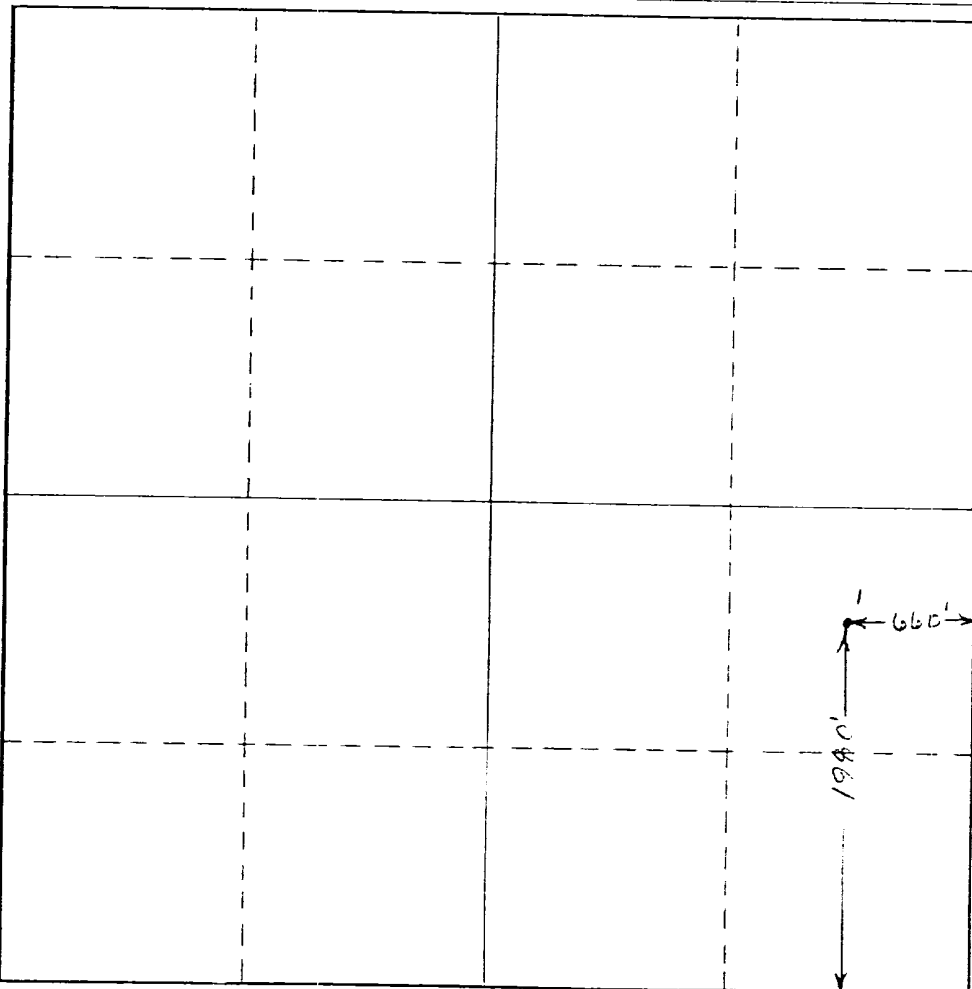

CERTIFICATION

I hereby certify that the information contained herein is true and complete to the best of my knowledge and belief.

*Michael G. Henderson*

Name  
Staff Operations Engineer

Position  
Petro-Lewis Corporation

Company  
April 17, 1980

Date

I hereby certify that the well location shown on this plat was plotted from field notes of actual surveys made by me or under my supervision, and that the same is true and correct to the best of my knowledge and belief.

Date Surveyed

Registered Professional Engineer  
and/or Land Surveyor

Certificate No.

|                           |            |
|---------------------------|------------|
| NUMBER OF COPIES RECEIVED |            |
| DISTRIBUTION              |            |
| U.S.G.                    |            |
| LAND OFFICE               |            |
| TRANSPORTER               | OIL<br>GAS |
| PRODUCTION OFFICE         |            |
| OPERATOR                  |            |

**NEW MEXICO OIL CONSERVATION COMMISSION**  
**WELL LOCATION AND ACREAGE DEDICATION PLAT**  
 SEE INSTRUCTIONS FOR COMPLETING THIS FORM ON THE REVERSE SIDE

FORM C-128  
 Revised 5/1/57

|   |                      |                                     |                     |   |  |  |  |
|---|----------------------|-------------------------------------|---------------------|---|--|--|--|
| Operator<br><b>Amerada Petroleum Corporation</b>  |                      |                                     |                     | SECTION A<br>Lease<br><b>L.G. Warlick "A"</b> |  | Well No.<br><b>1</b>                   |  |
| Unit Letter<br><b>I</b>   | Section<br><b>19</b> | Township<br><b>21S</b>              | Range<br><b>37E</b> | County<br><b>Lea</b>                          |  |  |  |
| Actual Footage Location of Well:<br><b>1960</b> feet from the <b>South</b> line and <b>560</b> feet from the <b>East</b> line |                      |                                     |                     |   |  |  |  |
| Ground Level Elev.<br><b>3509' DF</b>   |                      | Producing Formation<br><b>Queen</b> |                     | Pool<br><b>Eunost Gas</b>                     |  | Dedicated Acreage:<br><b>160</b> Acres |  |

1. Is the Operator the only owner in the dedicated acreage outlined on the plat below? YES ☒ NO \_\_\_\_ . ("Owner" means the person who has the right to drill into and to produce from any pool and to appropriate the production either for himself or for himself and another. (65-3-29 (e) NMSA 1935 Comp.)
2. If the answer to question one is "no," have the interests of all the owners been consolidated by communitization agreement or otherwise? YES \_\_\_\_ NO \_\_\_\_ . If answer is "yes," Type of Consolidation \_\_\_\_\_
3. If the answer to question two is "no," list all the owners and their respective interests below:

| Owner | Land Description |
|-------|------------------|
|       |                  |
|       |                  |

**SECTION B**

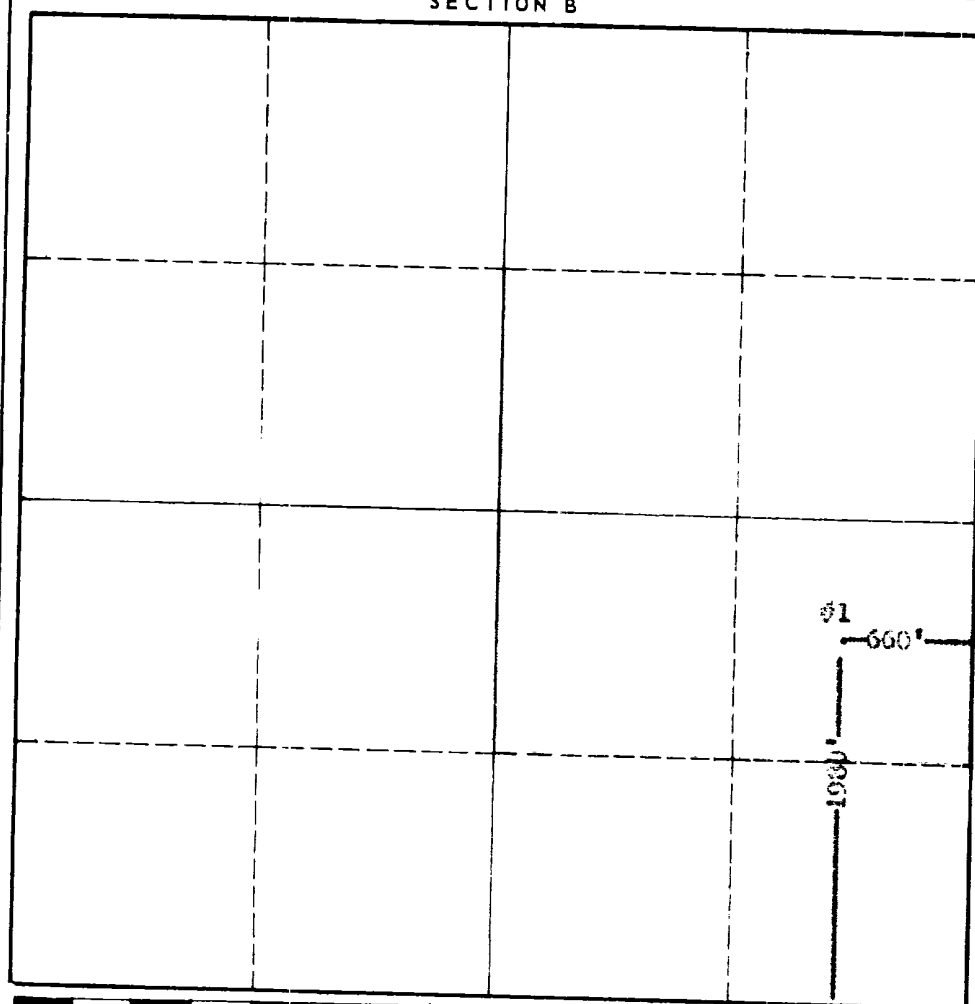

**CERTIFICATION**

I hereby certify that the information in SECTION A above is true and complete to the best of my knowledge and belief.

|  |
|--|
| Name<br><i>W. C. J. J. J.</i>              |
| Position<br><b>District Superintendent</b> |
| Company<br><b>Amerada Petroleum Corp.</b>  |
| Date<br><b>May 3, 1963</b>                 |

I hereby certify that the well location shown on the plat in SECTION B was plotted from field notes of actual surveys made by me or under my supervision, and that the same is true and correct to the best of my knowledge and belief.

|   |
|---|
| Date Surveyed   |
| Registered Professional Engineer and/or Land Surveyor |
| Certificate No.                                       |

## INSTRUCTIONS FOR COMPLETION OF FORM C-128

1. Operator shall furnish and certify to the information called for in Section A.
2. Operator shall outline the dedicated acreage for *both* oil and gas wells on the plat in Section B.
3. A registered professional engineer or land surveyor registered in the State of New Mexico or approved by the Commission shall show on the plat the location of the well and certify this information in the space provided.
4. All distances shown on the plat must be from the outer boundaries of the Section.
5. If additional space is needed for listing owners and their respective interests as required in question 3 of Section A, please use space below.

## WELL LOCATION AND ACREAGE DEDICATION PLAT

SEE INSTRUCTIONS FOR COMPLETING THIS FORM ON THE REVERSE SIDE

|   |  |                                  |                                       |
|---|--|----------------------------------|---------------------------------------|
| SECTION A   |  |                                  |                                       |
| Operator<br><b>Amerada Petroleum Corporation</b>  |  | Lease<br><b>L.G. Warlick "A"</b> | Well No.<br><b>1</b>                  |
| Unit Letter<br><b>1</b>   | Section<br><b>19</b>                   | Township<br><b>21 South</b>      | Range<br><b>37 East</b>               |
| Actual Footage Location of Well:<br><b>1980'</b> feet from the <b>South</b> line and <b>660'</b> feet from the <b>East</b> line |  | County<br><b>Lea</b>             |                                       |
| Ground Level Elev.<br><b>3498'</b>  | Producing Formation<br><b>Grayburg</b> | Pool<br><b>Penrose-Skelley</b>   | Dedicated Acreage:<br><b>40</b> Acres |

1. Is the Operator the only owner in the dedicated acreage outlined on the plat below? YES ☒ NO ☐ ("Owner" means the person who has the right to drill into and to produce from any pool and to appropriate the production either for himself or for himself and another. (65-3-29 NMSA 1935 Conn.))
2. If the answer to question one is "no," have the interests of all the owners been consolidated by communitization agreement or otherwise? YES ☐ NO ☐ If answer is "yes," Type of Consolidation \_\_\_\_\_
3. If the answer to question two is "no," list all the owners and their respective interests below:

| Owner | Land Description |
|-------|------------------|
|       |                  |
|       |                  |
|       |                  |

## SECTION B

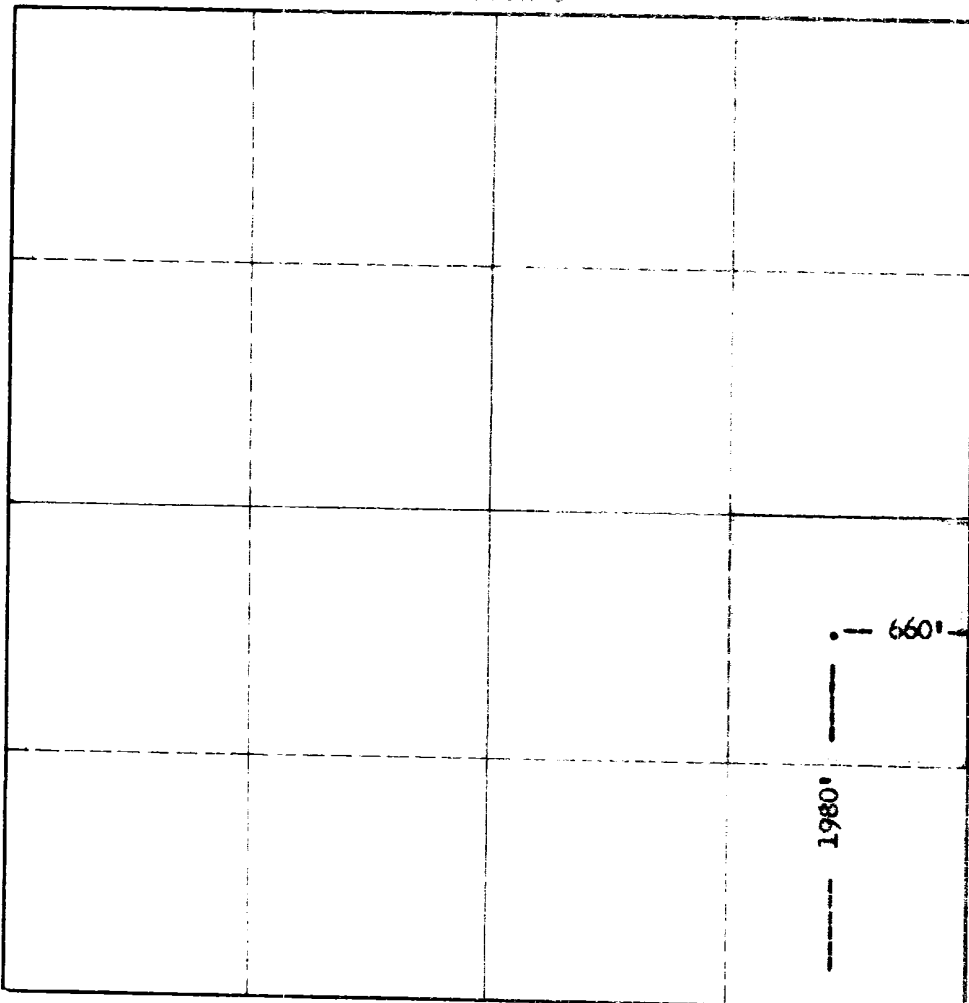

## CERTIFICATION

I hereby certify that the information in SECTION A above is true and complete to the best of my knowledge and belief.

*B. A. Mac*  
Name

**Asst. Dist. Supt.**

Position

**Amerada Petr. Corp.**

Company

**May 16, 1962**

Date

I hereby certify that the well location shown on the plat in SECTION B was plotted from field notes of actual surveys made by me or under my supervision, and that the same is true and correct to the best of my knowledge and belief.

Date Surveyed

Registered Professional Engineer  
and/or Land Surveyor

Certificate No.

0 330 660 990 1320 1650 1980 2310 2640 2000 1500 1000 500 0

## INSTRUCTIONS FOR COMPLETION OF FORM C-128

1. Operator shall furnish and certify to the information called for in Section A.
2. Operator shall outline the dedicated acreage for *both* oil and gas wells on the plat in Section B.
3. A registered professional engineer or land surveyor registered in the State of New Mexico or approved by the Commission shall show on the plat the location of the well and certify this information in the space provided.
4. All distances shown on the plat must be from the outer boundaries of the Section.
5. If additional space is needed for listing owners and their respective interests as required in question 3 of Section A, please use space below.