

Submit to Appropriate
District Office
State Lease - 6 copies
Fee Lease - 5 copies

State of New Mexico
Energy, Minerals and Natural Resources Department

Form C-101
Revised 1-1-89

OIL CONSERVATION DIVISION

DISTRICT I
P.O. Box 1980, Hobbs, NM 88240

P.O. Box 2088
Santa Fe, New Mexico 87504-2088

DISTRICT II
P.O. Drawer DD, Artesia, NM 88210

DISTRICT III
1000 Rio Brazos Rd., Aztec, NM 87410

API NO. (assigned by OCD on New Wells)

3002506688

5. Indicate Type of Lease

STATE ☐

FEE ☒

6. State Oil & Gas Lease No.

299180

APPLICATION FOR PERMIT TO DRILL, DEEPEN, OR PLUG BACK

1a. Type of Work:

DRILL ☐

RE-ENTER ☐

DEEPEN ☐

PLUG BACK ☒

b. Type of Well:

OIL
WELL ☒

GAS
WELL ☐

OTHER ☐

SINGLE
ZONE ☐

MULTIPLE
ZONE ☒

7. Lease Name or Unit Agreement Name

Dayton Hardy

2. Name of Operator

Marathon Oil Company

8. Well No.

2

3. Address of Operator

P. O. Box 552, Midland, TX 79702

9. Pool name or Wildcat

Drinkard Tubb & Blinebry

4. Well Location

Unit Letter I : 1980 Feet From The South Line and 660 Feet From The East Line

Section 20 Township 21-S Range 37-E NMPM Lea County

10. Proposed Depth

N/A

11. Formation

N/A

12. Rotary or C.T.

N/A

13. Elevations (Show whether DF, RT, GR, etc.)

GL 3488' KB 3497'

14. Kind & Status Plug Bond

N/A

15. Drilling Contractor

N/A

16. Approx. Date Work will start

5/22/92

17. PROPOSED CASING AND CEMENT PROGRAM

SIZE OF HOLE	SIZE OF CASING	WEIGHT PER FOOT	SETTING DEPTH	SACKS OF CEMENT	EST. TOP
17"	13 3/8"	45#	300'	200	Surf. (calc)
11"	8 5/8"	32#	2800'	1500	Surf. (calc)
8"	5 1/2"	15.5#	6605'	650	Surf. (calc)

Recomplete to Tubb & Blinebry

MIRU. Test BOP. POOH w/prod string. Sqz Paddock perfs (5148-5157') & (5197-5200'). Test sqz. Set CIBP 6405' w/2 sx cmt cap. Perf Tubb 6189', 92-95', 97', 6202-17'. 21-36', 46-50', 54-56' (total 102 holes). Stim w/acid & sand fracture. Blow back. Perf Tubb 6020-25', 30', 34-38', 42-44', 46-50'. Total 34 holes. Stim w/acid sand frac. Blow back. Swab test for commingle report. Set RBP @ 5900'. Perf Blinebry @ 5512', 18-24', 62', 74', 79', 88-92', 95-5600', 5624', 32', 36-40', 5748', 58-60', 97-5800', 5806', 5829'. 64 holes total. Stim w/acid & sand frac. Put on pump. Test Blinebry for commingling report. RDMO.

IN ABOVE SPACE DESCRIBE PROPOSED PROGRAM: IF PROPOSAL IS TO DEEPEN OR PLUG BACK, GIVE DATA ON PRESENT PRODUCTIVE ZONE AND PROPOSED NEW PRODUCTIVE ZONE. GIVE BLOWOUT PREVENTER PROGRAM, IF ANY.

I hereby certify that the information above is true and complete to the best of my knowledge and belief.

SIGNATURE Thomas M. Price TITLE Advanced Engineering Tech. DATE 5/15/92

TYPE OR PRINT NAME Thomas M. Price TELEPHONE NO. (915) 632-1626

(This space for State Use)

APPROVED BY _____ TITLE _____ DATE MAY 19 '92

CONDITIONS OF APPROVAL, IF ANY:

see attached letter

RECEIVED

MAY 18 1992

OCD HGBBS OFFICE

OIL CONSERVATION DIVISION

P.O. Box 2088
Santa Fe, New Mexico 87504-2088

DISTRICT I
P.O. Box 1980, Hobbs, NM 88240

DISTRICT II
P.O. Drawer DD, Artesia, NM 88210

DISTRICT III
1000 Rio Brazos Rd., Aztec, NM 87410

WELL LOCATION AND ACREAGE DEDICATION PLAT

All Distances must be from the outer boundaries of the section

Operator Marathon Oil Company			Lease Dayton Hardy		Well No. 2
Unit Letter I	Section 20	Township 21-S	Range 37E	County Lea	
Actual Footage Location of Well: 1980 feet from the South line and 660 feet from the East line					
Ground level Elev. 3488'	Producing Formation Tubb/Blinbry		Pool Tubb & Blinbry oil & gas pools		Dedicated Acreage: 80 Acres

1. Outline the acreage dedicated to the subject well by colored pencil or hatchure marks on the plat below.
2. If more than one lease is dedicated to the well, outline each and identify the ownership thereof (both as to working interest and royalty).
3. If more than one lease of different ownership is dedicated to the well, have the interest of all owners been consolidated by communitization, unitization, force-pooling, etc.?
☐ Yes ☒ No If answer is "yes" type of consolidation _____

If answer is "no" list the owners and tract descriptions which have actually been consolidated. (Use reverse side of this form if necessary.) _____

No allowable will be assigned to the well until all interests have been consolidated (by communitization, unitization, forced-pooling, or otherwise) or until a non-standard unit, eliminating such interest, has been approved by the Division.

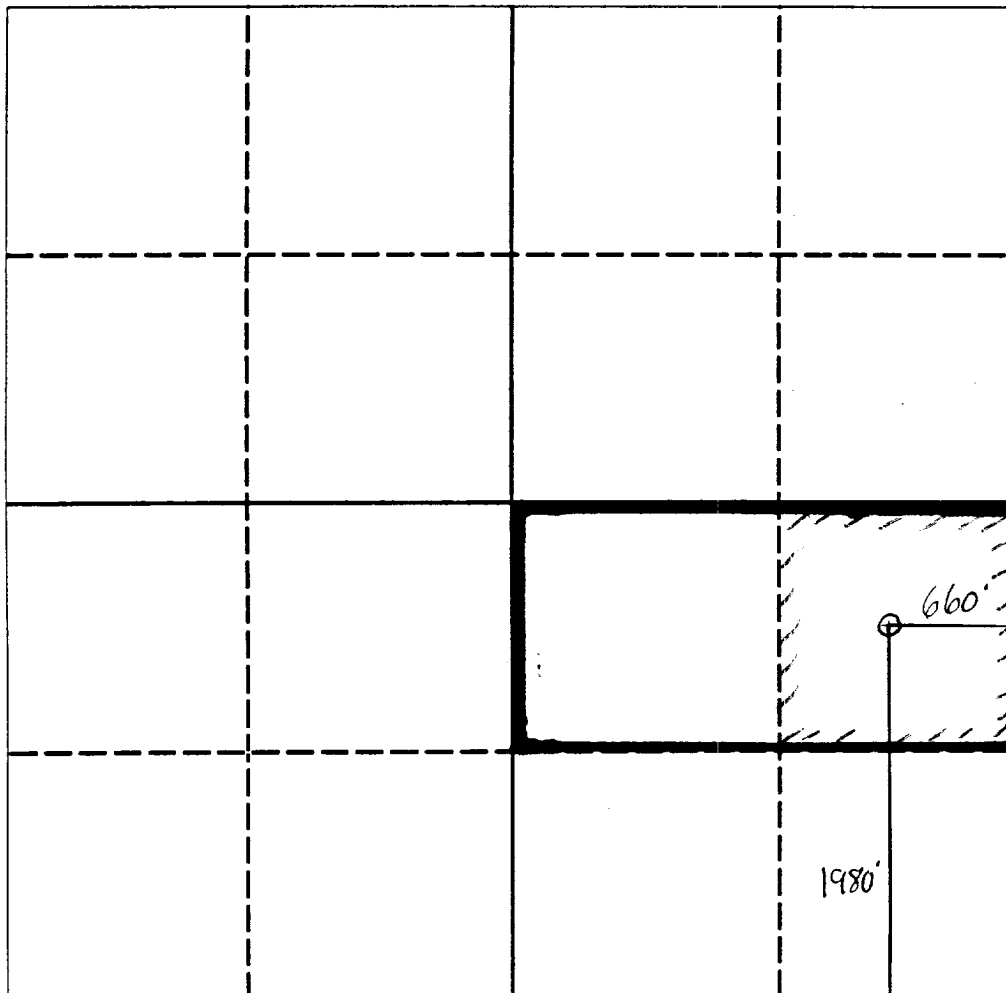

OPERATOR CERTIFICATION

I hereby certify that the information contained herein is true and complete to the best of my knowledge and belief.

Signature

Thomas M. Price

Printed Name

Thomas M. Price

Position

Advanced Engineering Tech.
Company

Marathon Oil Company

Date

5/15/92

SURVEYOR CERTIFICATION

I hereby certify that the well location shown on this plat was plotted from field notes of actual surveys made by me or under my supervision, and that the same is true and correct to the best of my knowledge and belief.

Date Surveyed

Signature & Seal of
Professional Surveyor

Certificate No.

0 330 660 990 1320 1650 1980 2310 2640 2000 1500 1000 500 0

RECEIVED

MAY 18 1992

OCD HQSBS OFFICE