

NEW MEXICO OIL CONSERVATION COMMISSION

SANTA FE, NEW MEXICO

7-3-58

APPLICATION FOR DUAL COMPLETION

Field Name		County Lee		Date October 5, 1964
Operator Gulf Oil Corporation		Lease C. L. Hardy		Well No. 4
Location of Well	Unit N	Section 20	Township 21-S	Range 37-E

1. Has the New Mexico Oil Conservation Commission heretofore authorized the dual completion of a well in these same pools or in the same zones within one mile of the subject well? YES XX NO

2. If answer is yes, identify one such instance: Order No. **MC-1156**; Operator, Lease, and Well No.:

Gulf Oil Corporation, C. L. Hardy No. 2

3. The following facts are submitted:	Upper Zone	Lower Zone
a. Name of reservoir	Paddock	Blinbury
b. Top and Bottom of Pay Section (Perforations)	5162-5171	5743-5857
c. Type of production (Oil or Gas)	OIL	OIL
d. Method of Production (Flowing or Artificial Lift)	Pump	Flow

4. The following are attached. (Please mark YES or NO)

Yes a. Diagrammatic Sketch of the Dual Completion, showing all casing strings, including size and setting, top of cement, perforated intervals, tubing strings, including diameters and setting depth, location and type of packers and side door chokes, and such other information as may be pertinent.

Yes b. Plat showing the location of all wells on applicant's lease, all offset wells on offset leases, and the names and addresses of operators of all leases offsetting applicant's lease.

Yes c. Waivers consenting to such dual completion from each offset operator, or in lieu thereof, evidence that said offset operators have been furnished copies of the application.*

No d. Electrical log of the well or other acceptable log with tops and bottoms of producing zones and intervals of perforation indicated thereon. (If such log is not available at the time application is filed, it shall be submitted as provided by Rule 112-A.)

5. List all offset operators to the lease on which this well is located together with their correct mailing address.

J. W. Peery, Box 655, Odessa, Texas

Amerada Petroleum Corporation, Drawer D, Monument, New Mexico

Turaco, Inc., Box 1270, Midland, Texas

Sunray Mid-Continent Oil Co., Box 522, Midland, Texas

Ohio Oil Co., Box 2107, Hobbs, New Mexico

Mobil Oil Corp., Box 2406, Hobbs, New Mexico **Tidewater Oil Co., Box 517, Hobbs, N. M.**

6. Were all operators listed in Item 5 above notified and furnished a copy of this application? YES XX NO . If answer is yes, give date of such notification **October 5, 1964**.

CERTIFICATE: I, the undersigned, state that I am the **Area Petroleum Engineer** of the **Gulf Oil Corporation** (company), and that I am authorized by said company to make this report; and that this report was prepared under my supervision and direction and that the facts stated therein are true, correct and complete to the best of my knowledge.

ORIGINAL FILED
L. A. MURPHY

Signature

* Should waivers from all offset operators not accompany an application for administrative approval, the New Mexico Oil Conservation Commission will hold the application for a period of twenty (20) days from date of receipt by the Commission's Santa Fe office. If, after said twenty-day period, no protest nor request for hearing is received by the Santa Fe office, the application will then be processed.

NOTE: If the proposed dual completion will result in an unorthodox well location and/or a non-standard perforation unit in either or both of the producing zones, then separate application for approval of the same should be filed simultaneously with this application.

. L. HARDY NO. 4
SCHEMATIC DIAGRAM OF PROPOSED DUAL COMPLETION - PADDOCK & BLINEBRY OILS

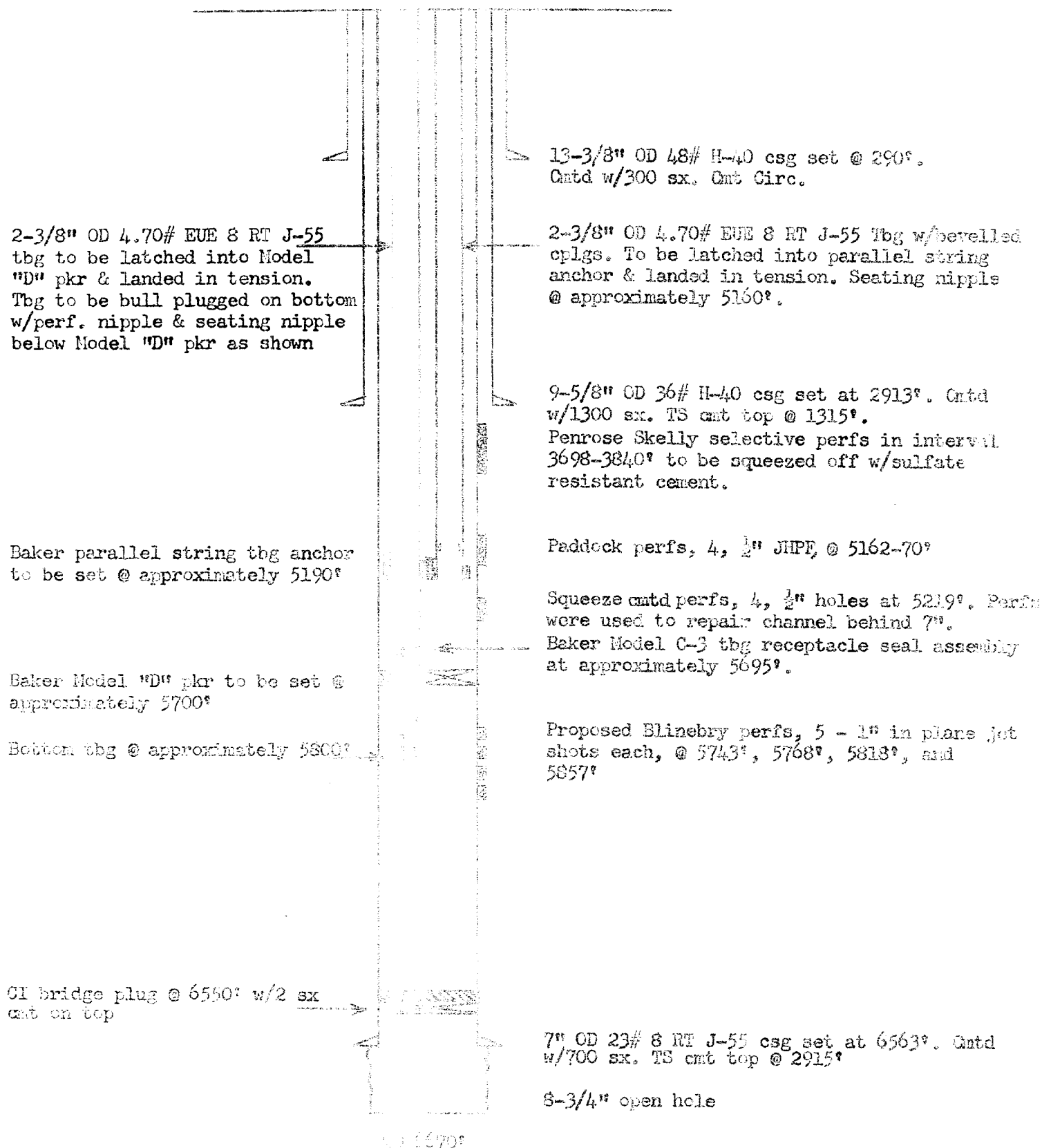

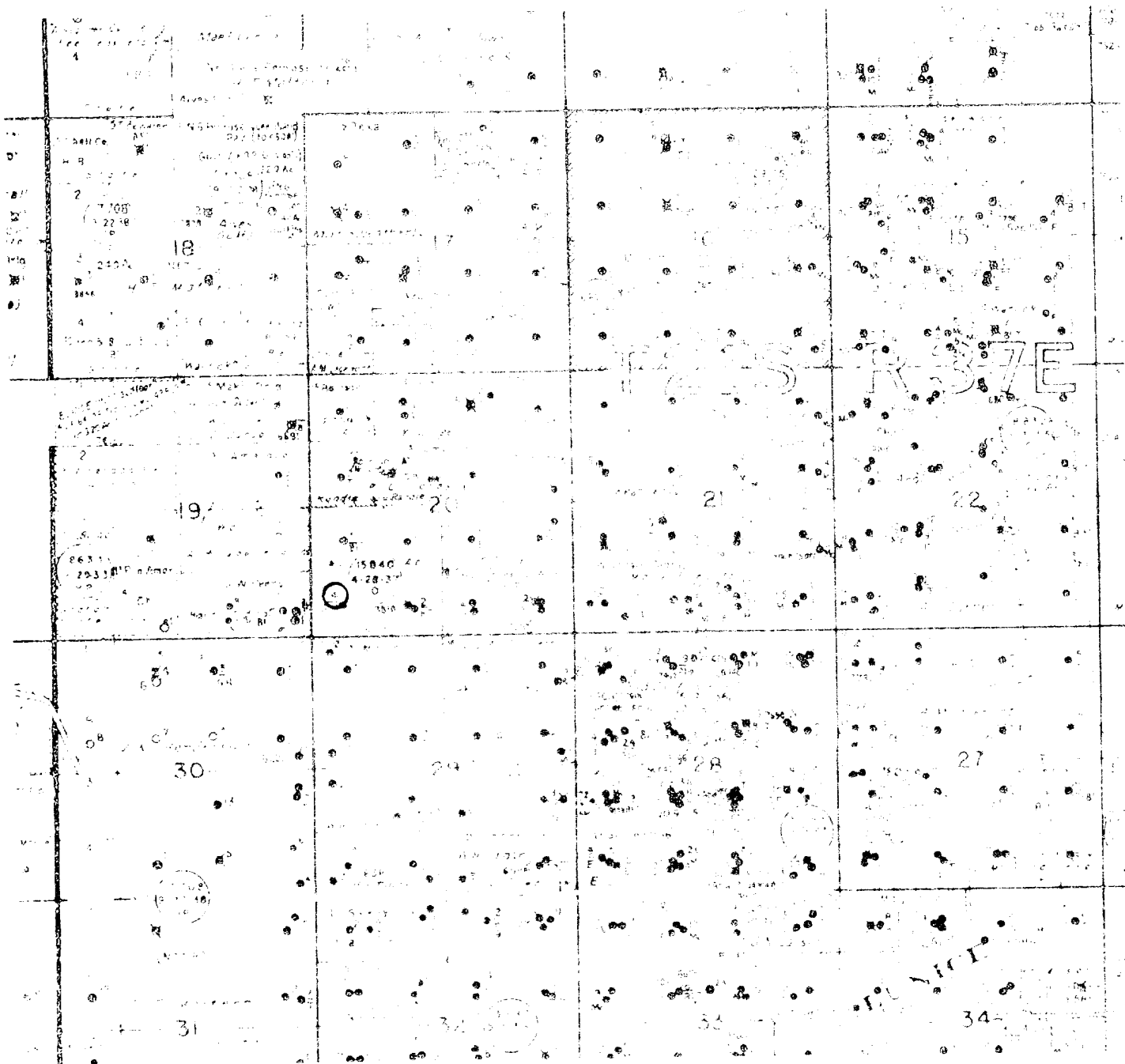

LEASE PLAT

C. L. HARTY LEASE
BLINDBURY OIL - RADLOCK OIL POOLS

Lea County, New Mexico

- LEGEND -

Pertinent Lease

Pertinent Well

Gulf Oil Corporation