

NEW MEXICO  
OIL CONSERVATION COMMISSION

Form C-128

Well Location and/or Gas Proration Plat

Date March 6, 1956

Operator N. B. Hunt

Lease Mary E. Wantz

Well No. 1 Section 21 Township 21 S Range 37 E NMPM

Located 660 Feet From West Line, 660 Feet From South Line,

Lea County, New Mexico. G. L. Elevation 3400

Name of Producing Formation Penrose-Shelly Pool Eumont Dedicated Acreage 160

(Note: All distances must be from outer boundaries of Section)

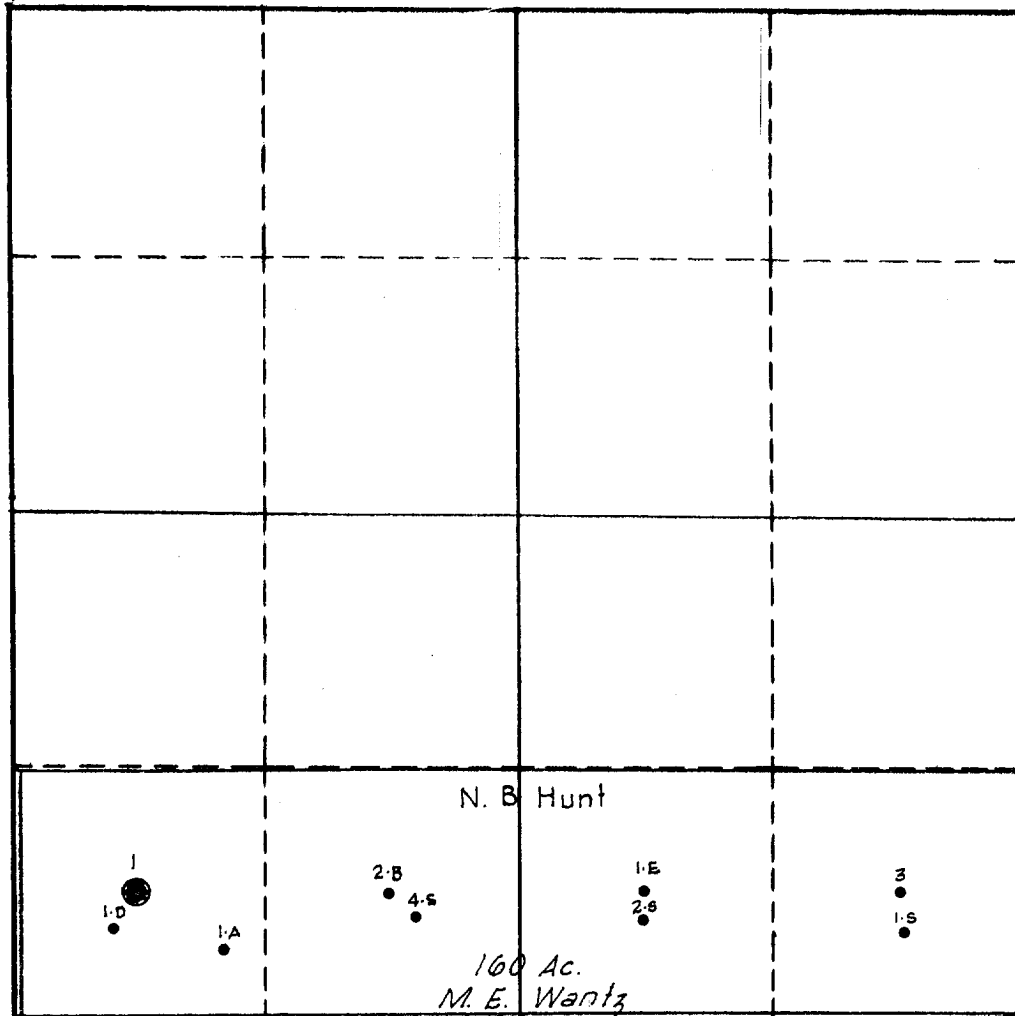

NOTE

This section of  
form is to be  
used for gas  
wells only.



1. Is this Well a Dual Comp. ? Yes \_\_\_ No X
2. If the answer to Question 1 is yes, are there any other dually completed wells within the dedicated acreage ? Yes \_\_\_ No \_\_\_

Name B. N. Collis  
Position Draftsman  
Representing N. B. Hunt  
Address 700 Mercantile Bank Bldg., Dallas, Texas

This is to certify that the above plat was prepared from field notes of actual surveys made by me or under my supervision and that the same are true and correct to the best of my knowledge and belief.

Date Surveyed \_\_\_\_\_

Registered Professional Engineer and/or  
Land Surveyor

NEW MEXICO  
OIL CONSERVATION COMMISSION  
Gas Well Plat  
OFFICE OCC

FILED March 23, 1955

N.B. Hunt Mary E. Wantz 1  
Operator Lease Well No.  
Name of Producing Formation Queens Pool Eumont

No. Acres Dedicated to the Well 160

SECTION 21 TOWNSHIP 21-S RANGE 37-E

	<u>160</u>	<u>Acre</u>	<u>Unit</u>
N.B. HUNT			
Mary E. Wantz			

I hereby certify that the information given above is true and complete to the best of my knowledge.

Name William S. Richardson  
Position William S. Richardson-Attorney  
Representing N.B. HUNT  
Address 700 Mercantile Bank Building  
Dallas 1, Texas