

Submit to Appropriate
District Office
State Lease - 6 copies
Fee Lease - 5 copies

State of New Mexico
Energy, Minerals and Natural Resources Department

Form C-101
Revised 1-1-89

OIL CONSERVATION DIVISION

P.O. Box 2088
Santa Fe, New Mexico 87504-2088

DISTRICT I
P.O. Box 1980, Hobbs, NM 88240

DISTRICT II
P.O. Drawer DD, Artesia, NM 88210

DISTRICT III
1000 Rio Brazos Rd., Aztec, NM 87410

API NO. (assigned by OCD on New Wells)

5. Indicate Type of Lease
STATE ☐ FEE ☒

6. State Oil & Gas Lease No.

APPLICATION FOR PERMIT TO DRILL, DEEPEN, OR PLUG BACK

1a. Type of Work:
DRILL ☐ RE-ENTER ☐ DEEPEN ☐ PLUG BACK ☒

b. Type of Well:
OIL WELL ☐ GAS WELL ☒ & OTHER WATER SOURCE WELL ☒ SINGLE ZONE ☒ MULTIPLE ZONE ☐

7. Lease Name or Unit Agreement Name

ARGO "A"

2. Name of Operator

SHELL WESTERN E&P INC.

8. Well No.

5

3. Address of Operator

P.O. BOX 576, HOUSTON, TX 77001 (WCK 4435)

9. Pool name or Wildcat

HARE-SAN ANDRES

4. Well Location

Unit Letter F : 1980 Feet From The NORTH Line and 2130 Feet From The WEST Line

Section

22

Township

21S

Range

37E

NMPM

LEA

County

10. Proposed Depth

5395' (PBDT)

11. Formation

SAN ANDRES

12. Rotary or C.T.

13. Elevations (Show whether DF, RT, GR, etc.)

3427' KB

14. Kind & Status Plug Bond

BLANKET

15. Drilling Contractor

WORKOVER RIG

16. Approx. Date Work will start

8-14-90

17. PROPOSED CASING AND CEMENT PROGRAM

SIZE OF HOLE	SIZE OF CASING	WEIGHT PER FOOT	SETTING DEPTH	SACKS OF CEMENT	EST. TOP
17-1/2"	13-3/8"	32.4#	230'	250	SURF
11"	8-5/8"	32#	2920'	2200	SURF
7-7/8"	5-1/2"	15.5#	6535'	500	4000'

NOTE: ORIGINAL PERMIT TO PLUG BACK & RECOMPLETE EXPIRED 5-28-90.

WE PROPOSE TO PLUG BACK THE BLINEBRY & RECOMPLETE IN THE SAN ANDRES AS A GAS/WATER SOURCE WELL AS FOLLOWS:

- TOH w/tbg.
- CO to CIBP @ 6440'.
- Set CIBP @ 5430' & cap w/35' cmt.
- Run csg insp log from 5395' to 2400'.
- Run GR/CBL/CCL from 5395' to 3700'. Run 100' repeat pass across TOC.
- Run GR/CNL/CCL from 5100' to 3700'.
- Perf 4-way shot @ depth based on CBL eval.
- Tag 10 bbls c/n 9.2#/gal brine w/dye.

(CONT'D ON REVERSE SIDE)

IN ABOVE SPACE DESCRIBE PROPOSED PROGRAM: IF PROPOSAL IS TO DEEPEN OR PLUG BACK, GIVE DATA ON PRESENT PRODUCTIVE ZONE AND PROPOSED NEW PRODUCTIVE ZONE. GIVE BLOWOUT PREVENTER PROGRAM, IF ANY.

I hereby certify that the information above is true and complete to the best of my knowledge and belief.

SIGNATURE

J. H. Smitherman

TITLE REGULATORY SUPV.

DATE 8-07-90

TYPE OR PRINT NAME

J. H. SMITHERMAN

(713) 870-3797

TELEPHONE NO.

(This space for State Use)

APPROVED BY

TITLE

DATE 8-11-1990

CONDITIONS OF APPROVAL, IF ANY:

9. Set pkr 50' above 4-way shot. Attmp to estab circ using cln 9.2#/gal brine. Once circ to surf is estab, pmp 10 bbl slug of tagged fl, displ w/cln 9.2#/gal brine, and record displ vol pmpd.
10. RIH w/string shot & back off 5-1/2" csg @ 2700'. (NOTE: The 5-1/2" csg is to be cut above the 8-5/8" shoe in order to allow subsequent instl of a lrg dia submersible pmp.)
11. Dress top of 5-1/2" csg w/colr & centralize.
12. Cmt 5-1/2" X 8-5/8" csg ann from TOC to top of 5-1/2" as follows:
 - a. Set cmt ret @ 2800' (top of 5-1/2" @ 2700').
 - b. Estab circ & pmp 30-60 sx (to be designed from above displ tst) Cls "C" cmt.
 - c. Pull out of ret & circ cln. Pres tst csg to 500#.
 - d. WOC ±12 hrs.
 - e. DO cmt & cmt ret. CO to btm @ 5395'.
 - f. Run GR/CBL from 5000' to TOC. Run 100' repeat pass across TOC.
13. Perf San Andres @ depths based on log eval.
14. Acdz San Andres w/treatment sch determined after log eval.
15. Inst prod equip, setting submersible pmp on 4-1/2" tbg. Set pmp intake 2600' from surf. Place well on prod.

Submit to Appropriate
District Office
State Lease - 4 copies
Fee Lease - 3 copies

State of New Mexico
Energy, Minerals and Natural Resources Department

Form C-102
Revised 1-1-89

OIL CONSERVATION DIVISION

P.O. Box 2088
Santa Fe, New Mexico 87504-2088

DISTRICT I
P.O. Box 1980, Hobbs, NM 88240

DISTRICT II
P.O. Drawer DD, Artesia, NM 88210

DISTRICT III
1000 Rio Brazos Rd., Aztec, NM 87410

WELL LOCATION AND ACREAGE DEDICATION PLAT

All Distances must be from the outer boundaries of the section

Operator SHELL WESTERN E&P INC.			Lease ARGO "A"		Well No. 5
Unit Letter F	Section 22	Township 21S	Range 37E	County NMPM	LEA
Actual Footage Location of Well: 1980 feet from the NORTH line and 2130 feet from the WEST line					
Ground level Elev. 3427' KB		Producing Formation SAN ANDRES		Pool HARE-SAN ANDRES	
					Dedicated Acreage: 160 Acres

1. Outline the acreage dedicated to the subject well by colored pencil or hachure marks on the plat below.

2. If more than one lease is dedicated to the well, outline each and identify the ownership thereof (both as to working interest and royalty).

3. If more than one lease of different ownership is dedicated to the well, have the interest of all owners been consolidated by communitization, unitization, force-pooling, etc.?

☐ Yes ☐ No If answer is "yes" type of consolidation _____
If answer is "no" list the owners and tract descriptions which have actually been consolidated. (Use reverse side of this form if necessary.)

No allowable will be assigned to the well until all interests have been consolidated (by communitization, unitization, forced-pooling, or otherwise) or until a non-standard unit, eliminating such interest, has been approved by the Division.

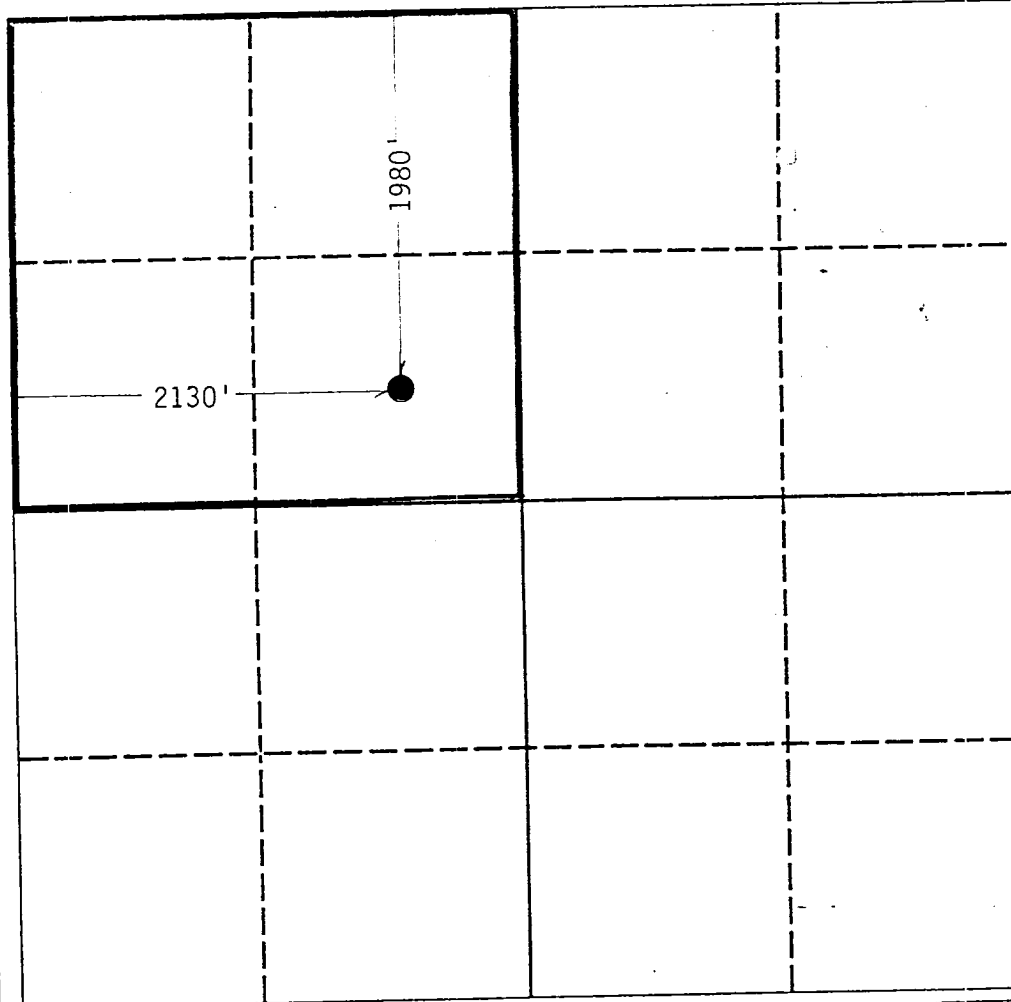

OPERATOR CERTIFICATION

I hereby certify that the information contained herein is true and complete to the best of my knowledge and belief.

Signature

J. H. Smitherman

Printed Name

J. H. SMITHERMAN

Position

REGULATORY SUPV.

Company

SHELL WESTERN E&P INC.

Date

8-07-90

SURVEYOR CERTIFICATION

I hereby certify that the well location shown on this plat was plotted from field notes of actual surveys made by me or under my supervision, and that the same is true and correct to the best of my knowledge and belief.

Date Surveyed

Signature & Seal of
Professional Surveyor

Certificate No.

