

NO. OF COPIES RECEIVED	
DISTRIBUTION	
SANTA FE	
FILE	
U.S.G.S.	
LAND OFFICE	
OPERATOR	

NEW MEXICO OIL CONSERVATION COMMISSION

Form C-101
Revised 1-4-65

5A. Indicate Type of Lease
STATE ☐ FEE ☒

5. State Oil & Gas Lease No.

APPLICATION FOR PERMIT TO DRILL, DEEPEN, OR PLUG BACK

1a. Type of Work DRILL <input type="checkbox"/> DEEPEN <input type="checkbox"/> PLUG BACK <input checked="" type="checkbox"/>		7. Unit Agreement Name
b. Type of Well OIL WELL <input checked="" type="checkbox"/> GAS WELL <input type="checkbox"/> OTHER <input type="checkbox"/> SINGLE ZONE <input checked="" type="checkbox"/> MULTIPLE ZONE <input type="checkbox"/>		8. Farm or Lease Name Turner
2. Name of Operator Shell Oil Company		9. Well No. 14
3. Address of Operator P. O. Box 1509, Midland, Texas 79701		10. Field and Pool, or Wildcat Hare Simpson
4. Location of Well UNIT LETTER <u>J</u> LOCATED <u>2310</u> FEET FROM THE <u>South</u> LINE AND <u>2310</u> FEET FROM THE <u>East</u> LINE OF SEC. <u>22</u> TWP. <u>21S</u> RGE. <u>37E</u> NMPM		12. County Lea
19. Proposed Depth PB 7515		19A. Formation Simpson
20. Rotary or C.T.		
21. Elevations (Show whether DF, RT, etc.) 3423 DF	21A. Kind & Status Plug. Bond Blanket	22. Approx. Date Work will start Upon approval

23. PROPOSED CASING AND CEMENT PROGRAM

SIZE OF HOLE	SIZE OF CASING	WEIGHT PER FOOT	SETTING DEPTH	SACKS OF CEMENT	EST. TOP
	8 5/8"	32#	2906'	2000	Surface
	5 1/2"	15.5#, 17#	7555'	500	5200'

1. Set CIBP at 7550' and cap with 35' of cement to abandon Brunson Ellenburger.
2. Perforate w/4 JSPF at 7412-7415, 7418-7426, 7446-7448, 7451-7459, 7462-7470, 7473-7475, 7498-7506.
3. Complete as warranted.

IN ABOVE SPACE DESCRIBE PROPOSED PROGRAM: IF PROPOSAL IS TO DEEPEN OR PLUG BACK, GIVE DATA ON PRESENT PRODUCTIVE ZONE AND PROPOSED NEW PRODUCTIVE ZONE. GIVE BLOWOUT PREVENTER PROGRAM, IF ANY.

I hereby certify that the information above is true and complete to the best of my knowledge and belief.

Signed N. W. Harrison Title Staff Production Engineer Date 12-2-74

(This space for State Use)

APPROVED BY

TITLE

SUPERVISOR

DATE

CONDITIONS OF APPROVAL, IF ANY:

RECEIVED

DEC 4 1974

**OIL CONSERVATION COMM.
HOBBS, H. M.**

**NEW MEXICO OIL CONSERVATION COMMISSION
WELL LOCATION AND ACREAGE DEDICATION PLAT**

Form C-102
Supersedes C-128
Effective 1-1-65

All distances must be from the outer boundaries of the Section.

Operator Shell Oil Company			Lease Turner		Well No. 14
Unit Letter J	Section 22	Township 21S	Range 37E	County Lea	
Actual Footage Location of Well: 2310 feet from the South line and 2310 feet from the East line					
Ground Level Elev. 3423 DF	Producing Formation Simpson		Pool Hare Simpson		Dedicated Acreage: 40 Acres

1. Outline the acreage dedicated to the subject well by colored pencil or hachure marks on the plat below.
2. If more than one lease is dedicated to the well, outline each and identify the ownership thereof (both as to working interest and royalty).
3. If more than one lease of different ownership is dedicated to the well, have the interests of all owners been consolidated by communitization, unitization, force-pooling, etc?

☐ Yes ☐ No If answer is "yes," type of consolidation _____

If answer is "no," list the owners and tract descriptions which have actually been consolidated. (Use reverse side of this form if necessary.) _____

No allowable will be assigned to the well until all interests have been consolidated (by communitization, unitization, forced-pooling, or otherwise) or until a non-standard unit, eliminating such interests, has been approved by the Commission.

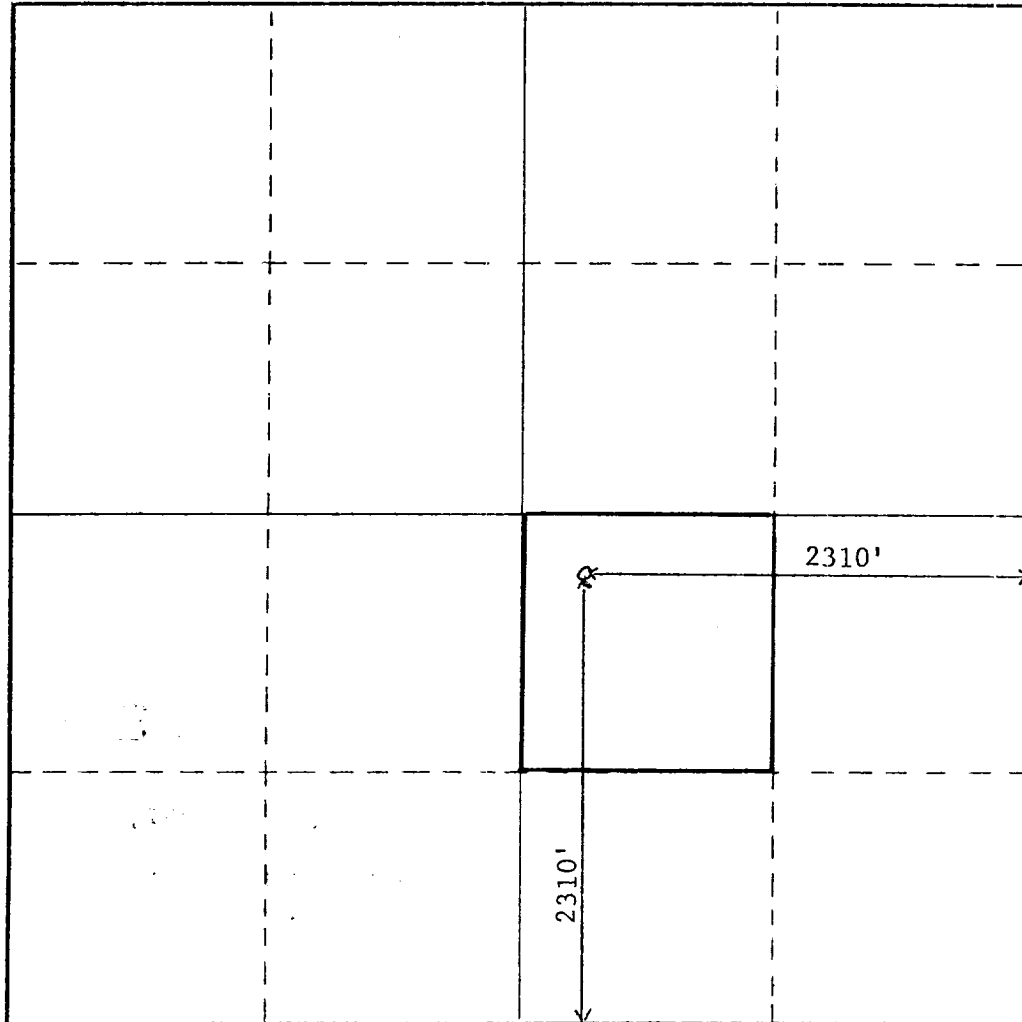

CERTIFICATION

I hereby certify that the information contained herein is true and complete to the best of my knowledge and belief.

[Signature]
Name
N. W. Harrison
Position
Staff Production Engineer
Company
Shell Oil Company
Date
12-2-74

I hereby certify that the well location shown on this plat was plotted from field notes of actual surveys made by me or under my supervision, and that the same is true and correct to the best of my knowledge and belief.

Date Surveyed _____
Registered Professional Engineer
and/or Land Surveyor

Certificate No. _____

RECEIVED

DEC 4 1974

**OIL CONSERVATION COMM.
HOBBS, N. M.**