

NEW MEXICO OIL CONSERVATION COMMISSION
WELL LOCATION AND ACREAGE DEDICATION PLAT

Form C-102
Supersedes C-128
Effective 1-1-65

All distances must be from the outer boundaries of the Section.

LESSOR SHELL OIL COMPANY			LESSEE SARKEYS		Well No. 3
Tract Letter L	Section 23	Township 21S	Range 37E	County LEA	
Actual Location of Well: 1980 feet from the SOUTH line and 660 feet from the WEST line					
Ground Level Elev. 3411' DF	Producing Formation BLINEBRY		Pool BLINEBRY(GAS)		Dedicated Acreage: 80 Acres

1. Outline the acreage dedicated to the subject well by colored pencil or hachure marks on the plat below.
2. If more than one lease is dedicated to the well, outline each and identify the ownership thereof (both as to working interest and royalty).
3. If more than one lease of different ownership is dedicated to the well, have the interests of all owners been consolidated by communitization, unitization, force-pooling, etc?

☐ Yes ☐ No If answer is "yes," type of consolidation _____

If answer is "no," list the owners and tract descriptions which have actually been consolidated. (Use reverse side of this form if necessary.) _____

No allowable will be assigned to the well until all interests have been consolidated (by communitization, unitization, forced-pooling, or otherwise) or until a non-standard unit, eliminating such interests, has been approved by the Commission.

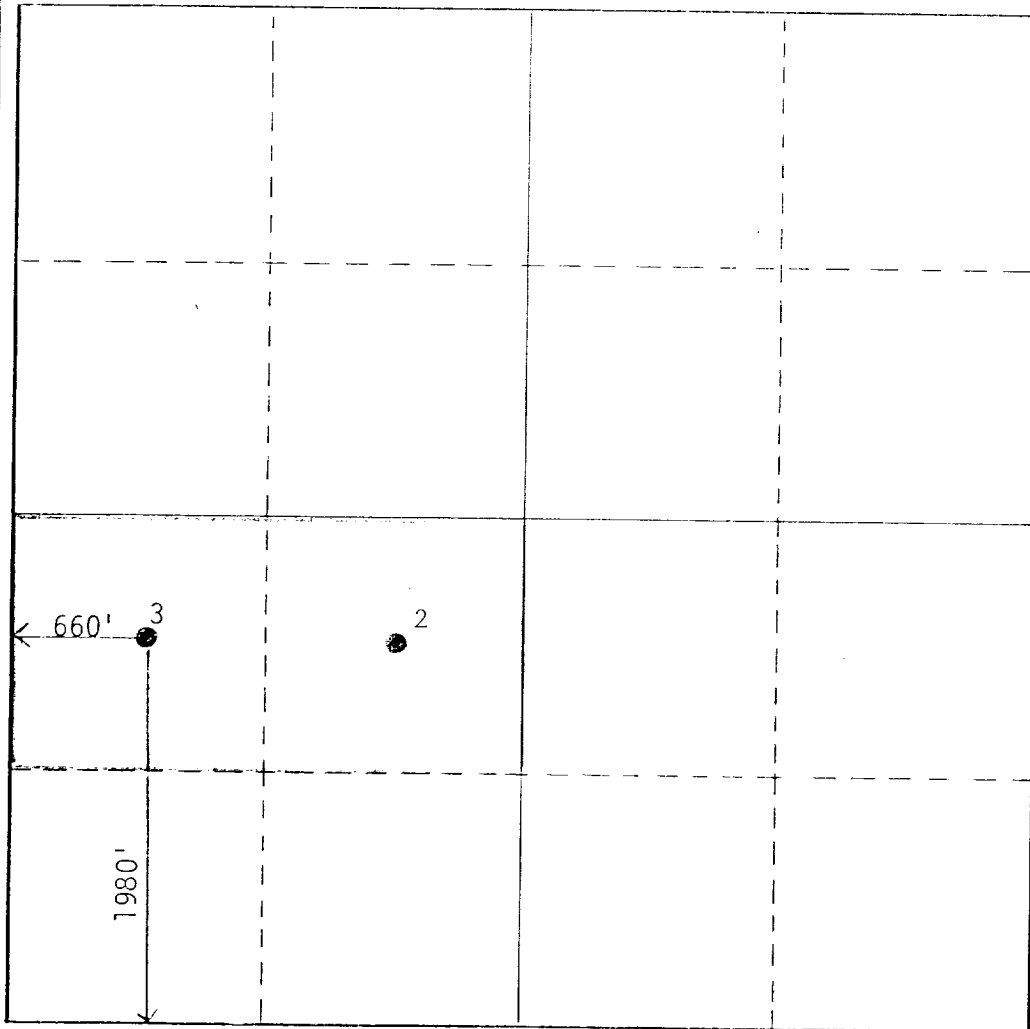

CERTIFICATION

I hereby certify that the information contained herein is true and complete to the best of my knowledge and belief.

A. J. Fore
Name

A. J. FORE
Position

SUPERVISOR REGULATORY & PERMITS

Company
SHELL OIL COMPANY

Date
REVISED 4/10/81

I hereby certify that the well location shown on this plat was plotted from field notes of actual surveys made by me or under my supervision, and that the same is true and correct to the best of my knowledge and belief.

Date Surveyed

Registered Professional Engineer and/or Land Surveyor

Certificate No.

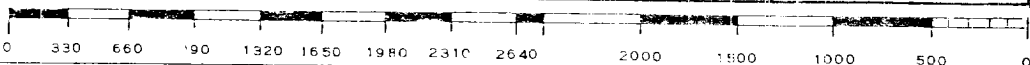

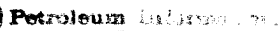

$\frac{d}{dt} \left(\frac{1}{\rho} \right) = - \frac{1}{\rho^2} \frac{d\rho}{dt}$

* Copyrights Reproduction Prohibited

COUNTY LEA

state NM

OPR CALL TO

API MN 06760

462

MAP

1980

COORD

104. 11. 1944

Re_{sup} 4-30-81 Re_{MP} 5-7-81 1-2-45 NM

$\frac{1}{2} \left(\frac{1}{2} \right) = \frac{1}{4}$

WELL CLASS. INIT DX FIN DO LSE CODE

857-297

[illegible][illegible]

1. Redox Potential, (Drinkard) OH

$$E_{\text{eff}} = \frac{1}{2} \left(E_0 + E_1 \right)$$

251 OF

sub-s

8-6510-6612,
 5 thru
 and from 25 to 60

1992-93 31
1993-94 31
1994-95 31
1995-96 31
1996-97 31
1997-98 31
1998-99 31
1999-00 31
2000-01 31
2001-02 31
2002-03 31
2003-04 31
2004-05 31
2005-06 31
2006-07 31
2007-08 31
2008-09 31
2009-10 31
2010-11 31
2011-12 31
2012-13 31
2013-14 31
2014-15 31
2015-16 31
2016-17 31
2017-18 31
2018-19 31
2019-20 31
2020-21 31
2021-22 31
2022-23 31
2023-24 31
2024-25 31
2025-26 31
2026-27 31
2027-28 31
2028-29 31
2029-30 31
2030-31 31
2031-32 31
2032-33 31
2033-34 31
2034-35 31
2035-36 31
2036-37 31
2037-38 31
2038-39 31
2039-40 31
2040-41 31
2041-42 31
2042-43 31
2043-44 31
2044-45 31
2045-46 31
2046-47 31
2047-48 31
2048-49 31
2049-50 31
2050-51 31
2051-52 31
2052-53 31
2053-54 31
2054-55 31
2055-56 31
2056-57 31
2057-58 31
2058-59 31
2059-60 31
2060-61 31
2061-62 31
2062-63 31
2063-64 31
2064-65 31
2065-66 31
2066-67 31
2067-68 31
2068-69 31
2069-70 31
2070-71 31
2071-72 31
2072-73 31
2073-74 31
2074-75 31
2075-76 31
2076-77 31
2077-78 31
2078-79 31
2079-80 31
2080-81 31
2081-82 31
2082-83 31
2083-84 31
2084-85 31
2085-86 31
2086-87 31
2087-88 31
2088-89 31
2089-90 31
2090-91 31
2091-92 31
2092-93 31
2093-94 31
2094-95 31
2095-96 31
2096-97 31
2097-98 31
2098-99 31
2099-00 31
2100-01 31
2101-02 31
2102-03 31
2103-04 31
2104-05 31
2105-06 31
2106-07 31
2107-08 31
2108-09 31
2109-10 31
2110-11 31
2111-12 31
2112-13 31
2113-14 31
2114-15 31
2115-16 31
2116-17 31
2117-18 31
2118-19 31
2119-20 31
2120-21 31
2121-22 31
2122-23 31
2123-24 31
2124-25 31
2125-26 31
2126-27 31
2127-28 31
2128-29 31
2129-30 31
2130-31 31
2131-32 31
2132-33 31
2133-34 31
2134-35 31
2135-36 31
2136-37 31
2137-38 31
2138-39 31
2139-40 31
2140-41 31
2141-42 31
2142-43 31
2143-44 31
2144-45 31
2145-46 31
2146-47 31
2147-48 31
2148-49 31
2149-50 31
2150-51 31
2151-52 31
2152-53 31
2153-54 31
2154-55 31
2155-56 31
2156-57 31
2157-58 31
2158-59 31
2159-60 31
2160-61 31
2161-62 31
2162-63 31
2163-64 31
2164-65 31
2165-66 31
2166-67 31
2167-68 31
2168-69 31
2169-70 31
2170-71 31
2171-72 31
2172-73 31
2173-74 31
2174-75 31
2175-76 31
2176-77 31
2177-78 31
2178-79 31
2179-80 31
2180-81 31
2181-82 31
2182-83 31
2183-84 31
2184-85 31
2185-86 31
2186-87 31
2187-88 31
2188-89 31
2189-90 31
2190-91 31
2191-92 31
2192-93 31
2193-94 31
2194-95 31
2195-96 31
2196-97 31
2197-98 31
2198-99 31
2199-00 31
2200-01 31
2201-02 31
2202-03 31
2203-04 31
2204-05 31
2205-06 31
2206-07 31
2207-08 31
2208-09 31
2209-10 31
2210-11 31
2211-12 31
2212-13 31
2213-14 31
2214-15 31
2215-16 31
2216-17 31
2217-18 31
2218-19 31
2219-20 31
2220-21 31
2221-22 31
2222-23 31
2223-24 31
2224-25 31
2225-26 31
2226-27 31
2227-28 31
2228-29 31
2229-30 31
2230-31 31
2231-32 31
2232-33 31
2233-34 31
2234-35 31
2235-36 31
2236-37 31
2237-38 31
2238-39 31
2239-40 31
2240-41 31
2241-42 31
2242-43 31
2243-44 31
2244-45 31
2245-46 31
2246-47 31
2247-48 31
2248-49 31
2249-50 31
2250-51 31
2251-52 31
2252-53 31
2253-54 31
2254-55 31
2255-56 31
2256-57 31
2257-58 31
2258-59 31
2259-60 31
2260-61 31
2261-62 31
2262-63 31
2263-64 31
2264-65 31
2265-66 31
2266-67 31
2267-68 31
2268-69 31
2269-70 31
2270-71 31
2271-72 31
2272-73 31
2273-74 31
2274-75 31
2275-76 31
2276-77 31
2277-78 31
2278-79 31
2279-80 31
2280-81 31
2281-82 31
2282-83 31
2283-84 31
2284-85 31
2285-86 31
2286-87 31
2287-88 31
2288-89 31
2289-90 31
2290-91 31
2291-92 31
2292-93 31
2293-94 31
2294-95 31
2295-96 31
2296-97 31
2297-98 31
2298-99 31
2299-00 31
2300-01 31
2301-02 31
2302-03 31
2303-04 31
2304-05 31
2305-06 31
2306-07 31
2307-08 31
2308-09 31
2309-10 31
2310-11 31
2311-12 31
2312-13 31
2313-14 31
2314-15 31
2315-16 31
2316-17 31
2317-18 31
2318-19 31
2319-20 31
2320-21 31
2321-22 31
2322-23 31
2323-24 31
2324-25 31
2325-26 31
2326-27 31
2327-28 31
2328-29 31
2329-30 31
2330-31 31
2331-32 31
2332-33 31
23

SHELL OIL COMPANY
 3 Sarkeys, S. J.
 Sec. 23, T-21-S, R-37-E
 1980' fr S Line & 660' fr W Line of Sec.
 Re-Spud 2-25-64
 Re-Comp 3-5-64

CO-ORD

OWO 934112

CSG & SX - TUBING	CLASS		FORMATION	
	FORMATION	DATUM	FORMATION	DATUM
13 3/8" 210' 300				
8 5/8" 2867' 2000				
5 1/2" 6510' 500				

LOGS EL GR RA IND HC A

TD 6612'

IP Blinebry Perfs 5726-5841' Flwd 162 BOPD + 3 BW. Pot. Based on 8 hr test of 54 BO + 1 BW, thru 16/64" chk., TP 460#, CP 780#, gravity 36.1.

NOW DUAL COMPLETE WITH DRINKARD OH 6510-6612'.

Distribution limited and publication prohibited by subscribers' agreement.
 Reproduction rights reserved by Williams & Lee Scouting Service, Inc.

CONT.	PROP DEPTH	TYPE
DATE		

3-23-64 F.R.C. 3-26-64; OWWO, OTD 6612'
 TD 6612', COMPLETED.
 Perf @ 5726', 5737', 5752', 5791', 5801', 5807',
 5821', 5823', 5838' & 5841' W/1 SPI
 Ac. 1650 gals.
 Frac 15,000 gals oil + 15,000# sd.