

NO. OF COPIES RECEIVED	
DISTRIBUTION	
SANTA FE	
FILE	
U.S.G.S.	
LAND OFFICE	
OPERATOR	

# NEW MEXICO OIL CONSERVATION COMMISSION

Form C-101  
Revised 1-1-65

5A. Indicate Type of Lease	
STATE <input type="checkbox"/>	FEE <input checked="" type="checkbox"/>

5. State Oil & Gas Lease No.

## APPLICATION FOR PERMIT TO DRILL, DEEPEN, OR PLUG BACK

1a. Type of Work		7. Unit Agreement Name	
b. Type of Well DRILL <input type="checkbox"/> DEEPEN <input type="checkbox"/> PLUG BACK <input type="checkbox"/> OIL WELL <input checked="" type="checkbox"/> GAS WELL <input type="checkbox"/> OTHER <input type="checkbox"/> *See Below SINGLE ZONE <input type="checkbox"/> MULTIPLE ZONE <input type="checkbox"/>		8. Farm or Lease Name Stephens Estate	
2. Name of Operator Mobil Oil Corporation		9. Well No. 1	
3. Address of Operator P. O. Box 633, Midland, Texas 79701		10. Field and Pool, or Wildcat Wantz Abo	
4. Location of Well UNIT LETTER <u>L</u> LOCATED <u>1980'</u> FEET FROM THE <u>South</u> LINE AND <u>660'</u> FEET FROM THE <u>West</u> LINE OF SEC. <u>24</u> TWP. <u>27-S</u> RGE. <u>37-E</u> NMPM		12. County Lea	
19. Proposed Depth 7250'		19A. Formation Abo	
20. Rotary or C.T. Rotary		21. Elevations (Show whether DE, RT, etc.) 3426' - Ground	
21A. Kind & Status Plug. Bond On File		21B. Drilling Contractor	
22. Approx. Date Work will start 11-16-73			

## PROPOSED CASING AND CEMENT PROGRAM

SIZE OF HOLE	SIZE OF CASING	WEIGHT PER FOOT	SETTING DEPTH	SACKS OF CEMENT	EST. TOP

\*This well was originally drilled to a total depth of 7481', it is presently dually completed as an oil well in the Blinebry and Drinkard Pools. Permission is requested to abandon the Blinebry, clean out to 7250' and test the Abo. Downhole commingling between the Drinkard and Abo may be requested after the Abo is tested.

APPROVAL VALID  
FOR 90 DAYS IN THE  
DRILLING COMMUNITY  
EXPIRES 2-16-74

IN ABOVE SPACE DESCRIBE PROPOSED PROGRAM: IF PROPOSAL IS TO DEEPEN OR PLUG BACK, GIVE DATA ON PRESENT PRODUCTIVE ZONE AND PROPOSED NEW PRODUCTIVE ZONE. GIVE BLOWOUT PREVENTER PROGRAM, IF ANY.

I hereby certify that the information above is true and complete to the best of my knowledge and belief.

Signed A. D. Boni A. D. Boni Title Proration Staff Assistant Date November 12, 1973

(This space for State Use)

APPROVED BY [Signature] TITLE  DATE

CONDITIONS OF APPROVAL, IF ANY:

NEW MEXICO OIL CONSERVATION COMMISSION  
WELL LOCATION AND ACREAGE DEDICATION PLAT

Form C-102  
Supersedes C-128  
Effective 1-1-65

All distances must be from the outer boundaries of the Section.

Operator <b>Mobil Oil Corporation</b>			Lease <b>Stephens Estate</b>		Well No. <b>1</b>
Unit Letter <b>L</b>	Section <b>24</b>	Township <b>21-S</b>	Range <b>37-E</b>	County <b>Lea</b>	
Actual Footage Location of Well: <b>660'</b> feet from the <b>West</b> line and <b>1980'</b> feet from the <b>South</b> line					
Ground Level Elev. <b>3426'</b>	Producing Formation <b>Abo</b>	Post <b>Wantz Abo</b>			Dedicated Acreage: <b>40</b> Acres

1. Outline the acreage dedicated to the subject well by colored pencil or hachure marks on the plat below.
2. If more than one lease is dedicated to the well, outline each and identify the ownership thereof (both as to working interest and royalty).
3. If more than one lease of different ownership is dedicated to the well, have the interests of all owners been consolidated by communitization, unitization, force-pooling, etc?

☐ Yes    ☐ No    If answer is "yes," type of consolidation \_\_\_\_\_

If answer is "no," list the owners and tract descriptions which have actually been consolidated. (Use reverse side of this form if necessary.) \_\_\_\_\_

No allowable will be assigned to the well until all interests have been consolidated (by communitization, unitization, forced-pooling, or otherwise) or until a non-standard unit, eliminating such interests, has been approved by the Commission.

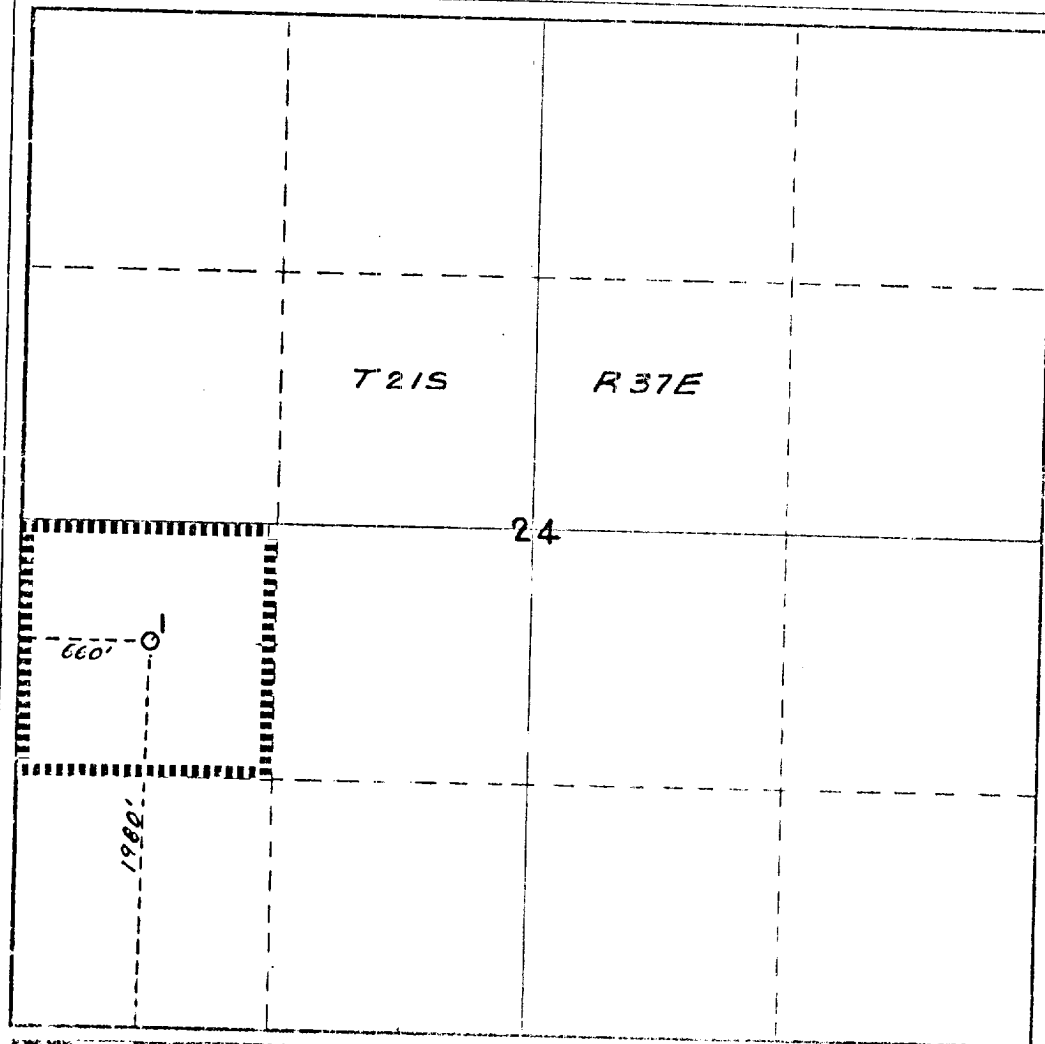

**CERTIFICATION**

*I hereby certify that the information contained herein is true and complete to the best of my knowledge and belief.*

*A. D. Bond*

Name \_\_\_\_\_

**A. D. Bond**

Position \_\_\_\_\_

**Proration Staff Assistant**

Company \_\_\_\_\_

**Mobil Oil Corporation**

Date \_\_\_\_\_

**November 12, 1973**

*I hereby certify that the well location shown on this plat was plotted from field notes of actual surveys made by me or under my supervision, and that the same is true and correct to the best of my knowledge and belief.*

Date Surveyed \_\_\_\_\_

By: \_\_\_\_\_  
Interim Professional Engineer  
or Civil Engineer

Continuation No. \_\_\_\_\_

