

NEW MEXICO
OIL CONSERVATION COMMISSION

Form C-128

Well Location and/or Gas Proration Plat

Date 9-6-56

Operator Gulf Oil Corporation Lease W. A. Ramsay "A"

Well No. 17 Section 27 Township 21-S Range 36-E NMPM

Located 1980 Feet From East Line, 1980 Feet From South Line,

Lea County, New Mexico. G. L. Elevation 3,548

Name of Producing Formation Queen Pool Eumont Gas Dedicated Acreage 640

(Note: All distances must be from outer boundaries of Section)

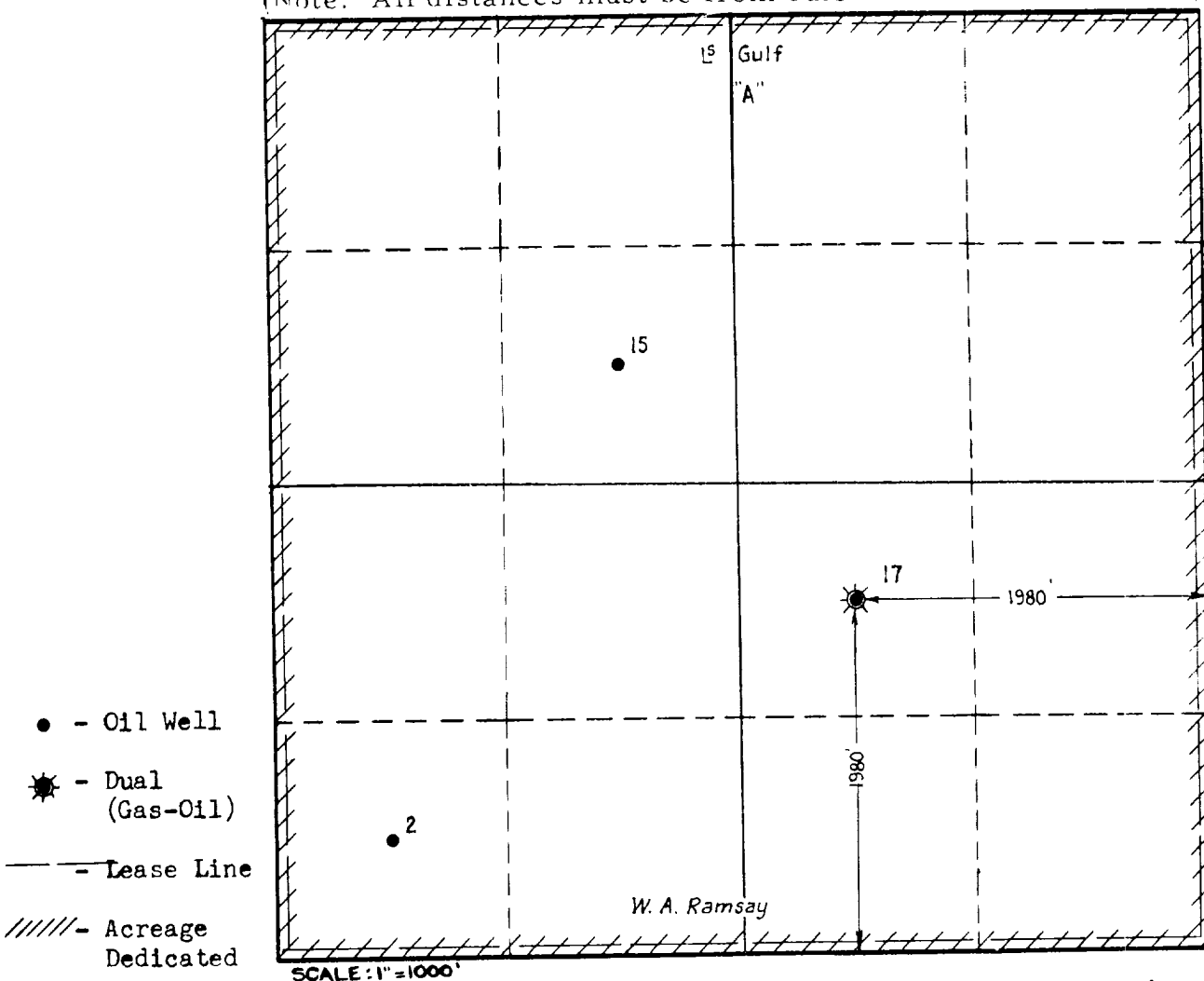

1. Is this Well a Dual Comp. ? Yes X No .
2. If the answer to Question 1 is yes, are there any other dually completed wells within the dedicated acreage? Yes No X.

This is to certify that the above plat was prepared from field notes of actual surveys made by me or under my supervision and that the same are true and correct to the best of my knowledge and belief.

Name J. R. Sherman
Position Division Gas Engineer
Representing Gulf Oil Corporation
Address P. O. Box 1290, Fort Worth 1, Texas

Date Surveyed
Registered Professional Engineer and/or
Land Surveyor