

OWDD

COUNTY	LEA	FIELD Wildcat	STATE NM MN 09907
OPR	CONTINENTAL OIL CO.		MAP
	6 Hawk "B-1"		
	Sec 9, T-21-S, R-37-E		CO-ORD
	660' FSL, 1980' FWL of Sec		
	Re-Spd 3-16-72		
	Re-Cmp 6-2-72		
	FORMATION	DATUM	FORMATION DATUM
CSG & SX - TUBING			
13 3/8" at 230' w/200 sx			
9 5/8" at 2779' w/550 sx			
7" at 6680' w/950 sx			
5" lnr 6406-7528' w/115 sx			
LOGS EL GR RA IND HC A			
	TD 7530'; PBD 7485'		

TEMPORARILY ABANDONED

Distribution limited and publication prohibited by subscribers' agreement.  
Reproduction rights reserved by Williams & Lee Scouting Service, Inc.

CONT.	PROP DEPTH	7530'	TYPE RT
DATE			

F.R. 11-16-71; Opr's Elev. 3512' DF  
 PD 7530' RT; (Fusselman)  
 (Orig. #6 Hawk "B-9", comp 8-17-48 thru  
 (Drinkard) Perfs & OH 6641-6730', OTD 6730'  
 OWWO & Re-Cmp dual. thru (Blindbry) Perfs 5600-  
 5840' & (Drinkard) Perfs & OH 6641-6730', OTD  
 6730')  
 3-23-72 Drlg. 6797'  
 Sqzd 5600-5840' w/100 sx  
 3-27-72 TD 7530'; WOC  
 DST 7279-7356', open 45 mins, rec 1149' O&HGCM  
 + 93' sul wtr, Pressures not available, HP 3422-  
 3377#, Ran 5" liner

**NEW MEXICO OIL CONSERVATION COMMISSION  
WELL LOCATION AND ACREAGE DEDICATION PLAT**

Form C-102  
Supersedes C-128  
Effective 1-1-65

All distances must be from the outer boundaries of the Section.

Operator <b>Continental Oil Company</b>			Lease <b>Hawk B-1</b>		Well No. <b>6</b>
Unit Letter <b>N</b>	Section <b>9</b>	Township <b>20S</b>	Range <b>37E</b>	County <b>Lea</b>	
Actual Footage Location of Well: <b>660</b> feet from the <b>South</b> line and <b>1980</b> feet from the <b>West</b> line					
Ground Level Elev. <b>3502'</b>	Producing Formation <b>Blinebry</b>		Pool <b>Blinebry Gas</b>		Dedicated Acreage: <b>120</b> Acres

1. Outline the acreage dedicated to the subject well by colored pencil or hachure marks on the plat below.
2. If more than one lease is dedicated to the well, outline each and identify the ownership thereof (both as to working interest and royalty).
3. If more than one lease of different ownership is dedicated to the well, have the interests of all owners been consolidated by communitization, unitization, force-pooling, etc?

☐ Yes    ☐ No    If answer is "yes," type of consolidation \_\_\_\_\_

If answer is "no," list the owners and tract descriptions which have actually been consolidated. (Use reverse side of this form if necessary.) \_\_\_\_\_

No allowable will be assigned to the well until all interests have been consolidated (by communitization, unitization, forced-pooling, or otherwise) or until a non-standard unit, eliminating such interests, has been approved by the Commission.

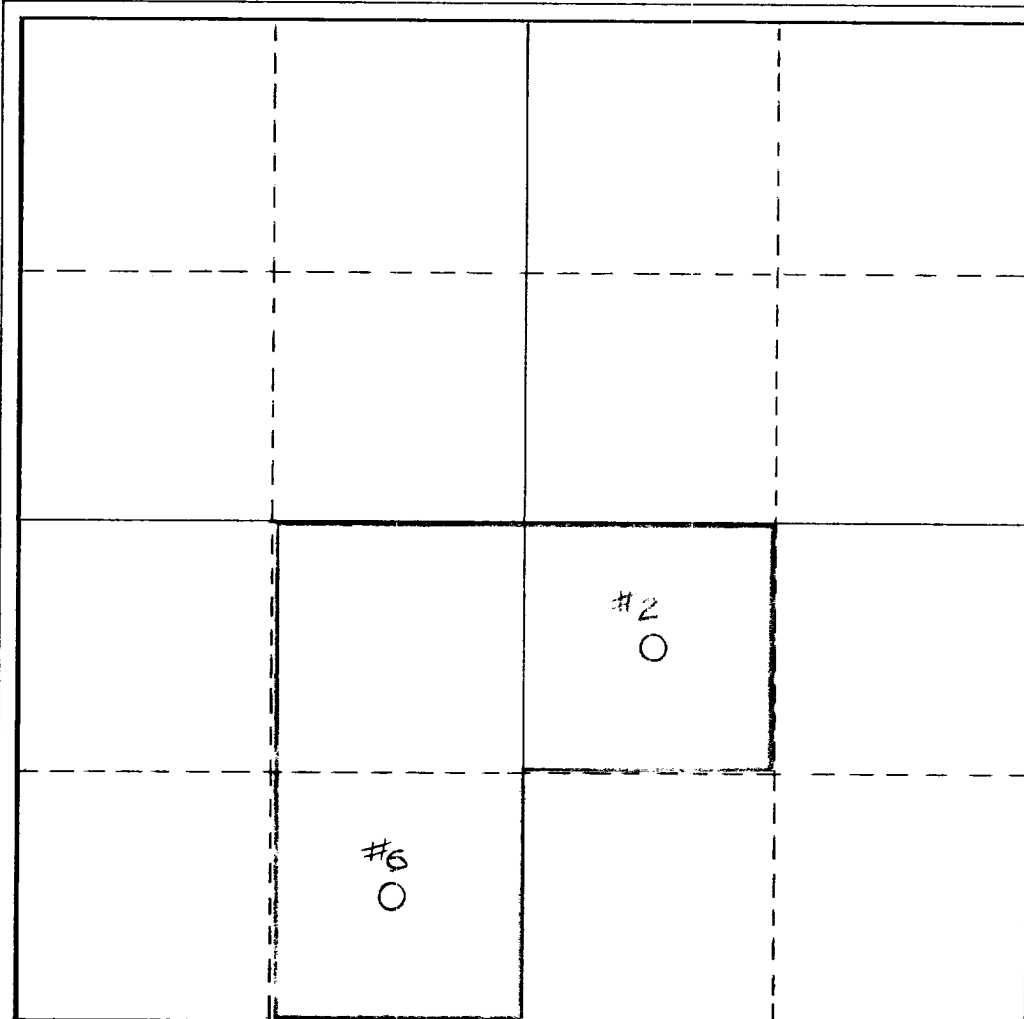

**CERTIFICATION**

*I hereby certify that the information contained herein is true and complete to the best of my knowledge and belief.*

Name  
**HUGH INGRAM**

Position  
**Admin. Supervisor**

Company  
**Continental Oil Co.**

Date  
**December 1, 1970**

*I hereby certify that the well location shown on this plat was plotted from field notes of actual surveys made by me or under my supervision, and that the same is true and correct to the best of my knowledge and belief.*

Date Surveyed

Registered Professional Engineer  
and/or Land Surveyor

Certificate No.

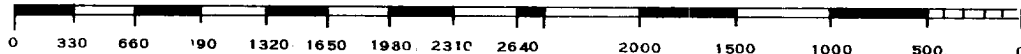

RECEIVED

172 21970  
OIL CONSERVATION COMM.  
HARRIS, R. L.

**NEW MEXICO OIL CONSERVATION COMMISSION  
WELL LOCATION AND ACREAGE DEDICATION PLAT**

Form C-102  
Supersedes C-128  
Effective 1-1-65

All distances must be from the outer boundaries of the Section.

Operator <b>Continental Oil Company</b>			Lease <b>Hawk B-1</b>		Well No. <b>6</b>
Unit Letter <b>N</b>	Section <b>9</b>	Township <b>20 N</b>	Range <b>37</b>	County <b>33 AM '66</b>	
Actual Footage Location of Well: <b>660</b> feet from the <b>South</b> line and <b>1980</b> feet from the <b>West</b> line					
Ground Level Elev. <b>3502'</b>	Producing Formation <b>Blinebry</b>		Pool <b>Blinebry Gas</b>		Dedicated Acreage: <b>80</b> Acres

1. Outline the acreage dedicated to the subject well by colored pencil or hachure marks on the plat below.
2. If more than one lease is dedicated to the well, outline each and identify the ownership thereof (both as to working interest and royalty).
3. If more than one lease of different ownership is dedicated to the well, have the interests of all owners been consolidated by communitization, unitization, force-pooling, etc?

☐ Yes   ☐ No   If answer is "yes," type of consolidation Not Applicable

If answer is "no," list the owners and tract descriptions which have actually been consolidated. (Use reverse side of this form if necessary.) \_\_\_\_\_

No allowable will be assigned to the well until all interests have been consolidated (by communitization, unitization, forced-pooling, or otherwise) or until a non-standard unit, eliminating such interests, has been approved by the Commission.

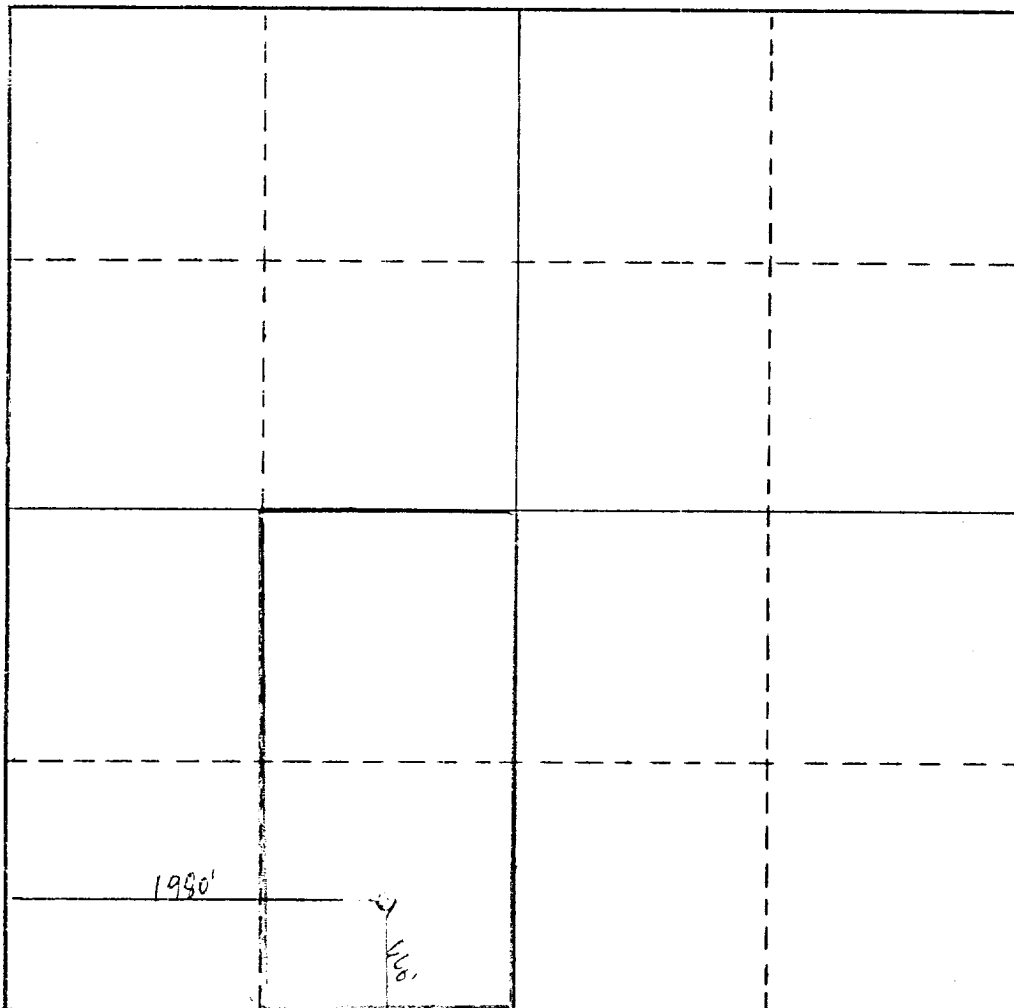

**CERTIFICATION**

I hereby certify that the information contained herein is true and complete to the best of my knowledge and belief.

Name Hal R. Stephens  
Position Staff Supervisor

Company Continental Oil Co.

Date December 29, 1965

I hereby certify that the well location shown on this plat was plotted from field notes of actual surveys made by me or under my supervision, and that the same is true and correct to the best of my knowledge and belief.

Date Surveyed \_\_\_\_\_

Registered Professional Engineer and/or Land Surveyor

Certificate No. \_\_\_\_\_

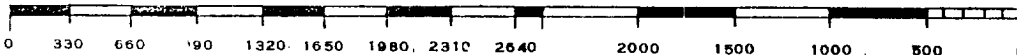

4565(5) FILE

**NEW MEXICO OIL CONSERVATION COMMISSION  
WELL LOCATION AND ACREAGE DEDICATION PLAT**

Form C-102  
Supersedes C-128  
Effective 1-1-65

All distances must be from the outer boundaries of the Section.

Operator <b>Continental Oil Company</b>			Lease <b>Hawk B-1</b>		SEP 17 3 03 PM '65
Unit Letter <b>N</b>	Section <b>9</b>	Township <b>21-S</b>	Range <b>37-E</b>	County <b>Lea</b>	
Actual Footage Location of Well: <div style="display: flex; justify-content: space-between;"> <span>660 feet from the south line and</span> <span>1980 feet from the west line</span> </div>					
Ground Level Elev: <b>3502</b>	Producing Formation <b>Blinebry</b>	Pool <b>Blinebry Gas</b>	Dedicated Acreage: <b>120</b> Acres		

1. Outline the acreage dedicated to the subject well by colored pencil or hachure marks on the plat below.
2. If more than one lease is dedicated to the well, outline each and identify the ownership thereof (both as to working interest and royalty).
3. If more than one lease of different ownership is dedicated to the well, have the interests of all owners been consolidated by communitization, unitization, force-pooling, etc?

**Not applicable**

☐ Yes   ☐ No   If answer is "yes," type of consolidation \_\_\_\_\_

If answer is "no," list the owners and tract descriptions which have actually been consolidated. (Use reverse side of this form if necessary.) \_\_\_\_\_

No allowable will be assigned to the well until all interests have been consolidated (by communitization, unitization, forced-pooling, or otherwise) or until a non-standard unit, eliminating such interests, has been approved by the Commission.

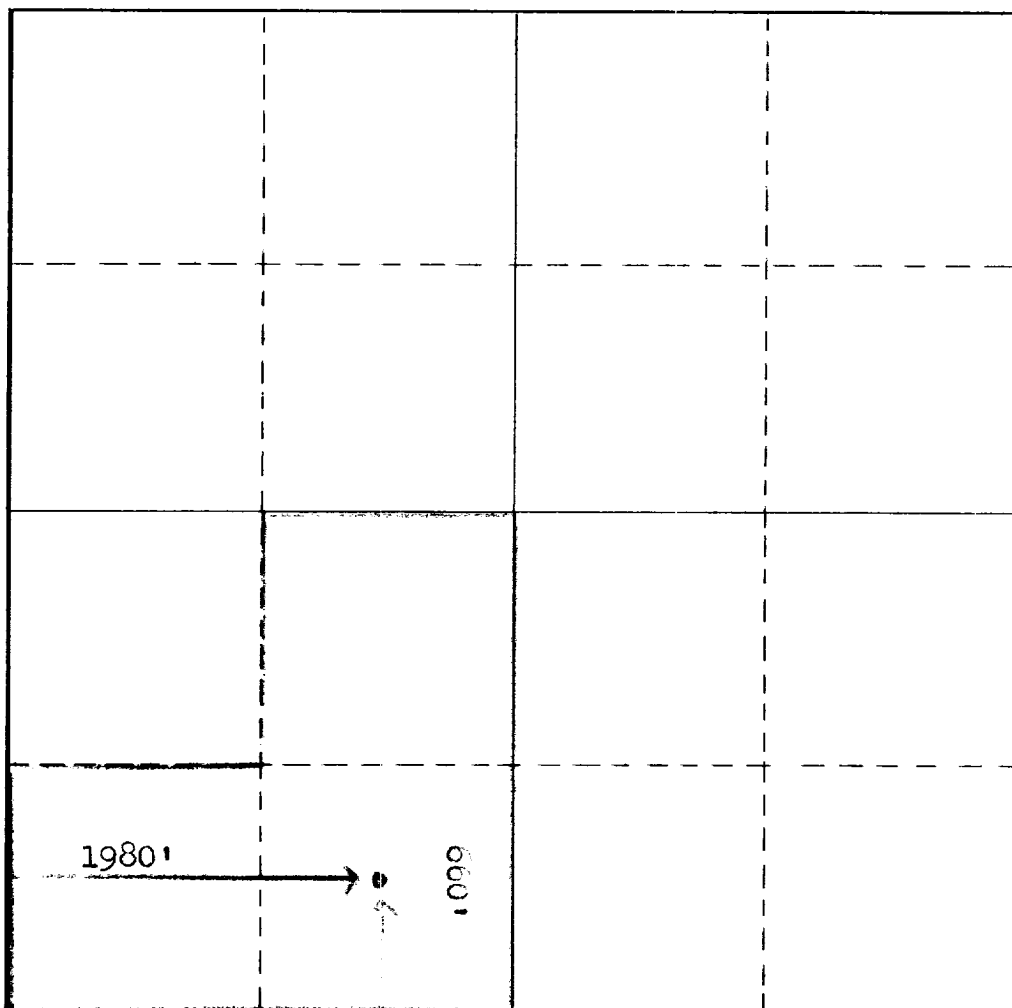

**CERTIFICATION**

*I hereby certify that the information contained herein is true and complete to the best of my knowledge and belief.*

Name 
Position <b>Assistant Dist. Mgr.</b>
Company <b>Continental Oil Company</b>
Date <b>9-14-65</b>

*I hereby certify that the well location shown on this plat was plotted from field notes of actual surveys made by me or under my supervision, and that the same is true and correct to the best of my knowledge and belief.*

Date Surveyed \_\_\_\_\_

Registered Professional Engineer  
and/or Land Surveyor

Certificate No. \_\_\_\_\_

0 330 660 990 1320 1650 1980 2310 2640 2000 1500 1000 500 0

**NMOCC (4) File**

NEW MEXICO SEP 13 AM 10 Gas Well Plat  
OIL CONSERVATION COMMISSION

Date 8/22/55

Continental  
Operator

Hawk D-9  
Lease

6  
Well No.

Name of Producing Formation Blinbry Pool Blinbry

No. Acres Dedicated to the Well 160

SECTION 9 TOWNSHIP 21 RANGE 37

● 4	● 5		
● 9	☀ 6		

I hereby certify that the information given above is true and complete to the best of my knowledge.

Name W. B. Allen  
Position District Superintendent  
Representing Continental Oil Co.  
Address Box 68, Eunice, N. M.

(over)

## INSTRUCTIONS

1. Is this gas well a dual completion? Yes ☒ No ☐
2. If the answer to Question 1 is Yes, are there any other dually completed wells within the dedicated acreage? Yes ☐ No ☒

A separate plat must be filed for each gas well, outlining the area dedicated to such well and showing the location of all other wells (oil and gas) within the outlined area.

Mail in duplicate to the district office for the district in which the well is located.