

NEW MEXICO OIL CONSERVATION COMMISSION

FORM C-128
Revised 5/1/57

WELL LOCATION AND ACREAGE DEDICATION PLAT

SEE INSTRUCTIONS FOR COMPLETING THIS FORM ON THE REVERSE SIDE

SECTION A

Operator GULF OIL CORPORATION		Lease GRAHAM STATE NCT-1		Well No. 2
Unit Letter L	Section 19	Township 21 SOUTH	Range 37 EAST	County LEA

Actual Footage Location of Well:
1980 feet from the **SOUTH** line and **560** feet from the **WEST** line

Ground Level Elev.	Producing Formation Paddock, Blinbry & Drk.	Pool Paddock, Blinbry & Drinkard	Dedicated Acreage: 36.69 to Acres
--------------------	---	--	---

1. Is the Operator the only owner in the dedicated acreage outlined on the plat below? YES ☒ NO ____ ("Owner" means the person who has the right to drill into and to produce from any pool and to appropriate the production either for himself or for himself and another. (65-3-29 (e) NMSA 1935 Comp.)
2. If the answer to question one is "no," have the interests of all the owners been consolidated by communitization agreement or otherwise? YES ____ NO ____ . If answer is "yes," Type of Consolidation ____
3. If the answer to question two is "no," list all the owners and their respective interests below:

Owner	Land Description

SECTION B

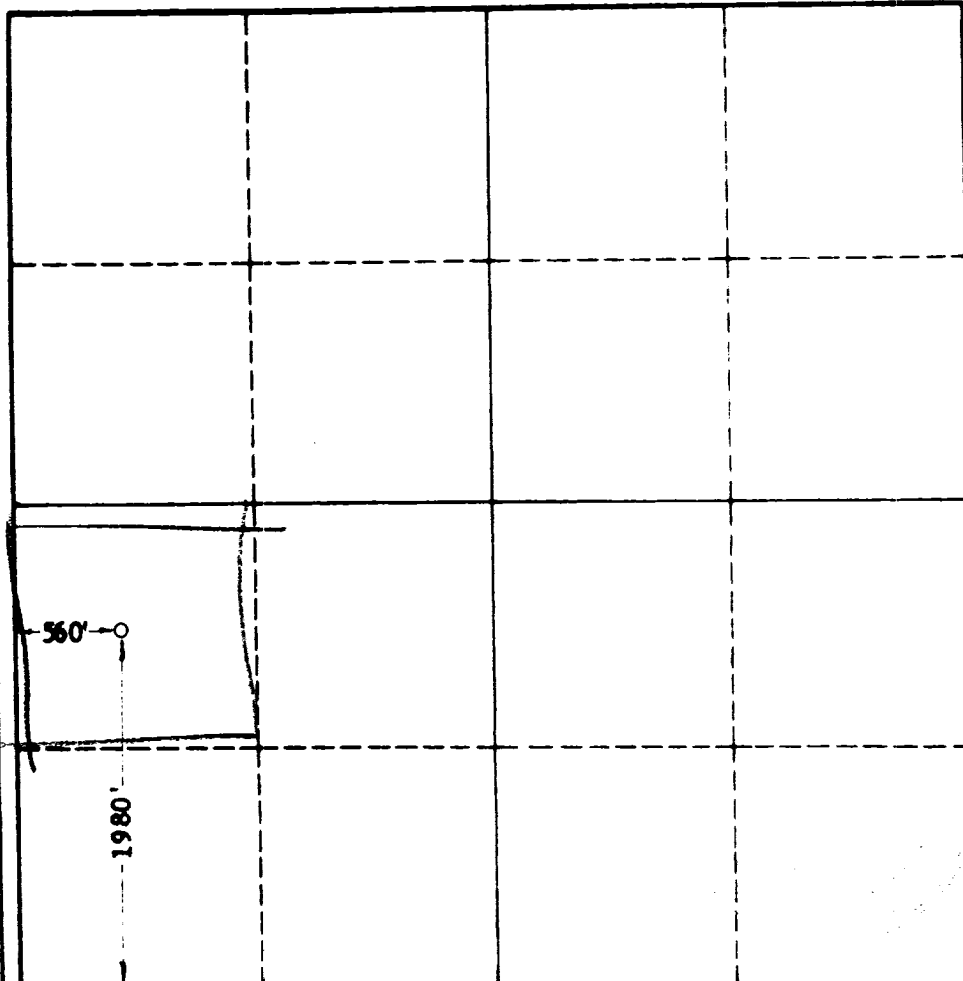

CERTIFICATION

I hereby certify that the information in SECTION A above is true and complete to the best of my knowledge and belief.

Name <i>J. C. Ballinger</i>
Position Area Petroleum Engineer
Company Gulf Oil Corporation
Date October 18, 1962

I hereby certify that the well location shown on the plat in SECTION B was plotted from field notes of actual surveys made by me or under my supervision, and that the same is true and correct to the best of my knowledge and belief.

Date Surveyed 10-13-62
Registered Professional Engineer and/or Land Surveyor, JOHN W. WEST
Certificate No. <i>John W. West</i> N. M. - P. E. & L. S. NO. 676