

## OIL CONSERVATION DIVISION

STATE OF NEW MEXICO  
ENERGY AND MINERALS DEPARTMENT

P. O. BOX 2088

SANTA FE, NEW MEXICO 87501

Form C-102  
Revised 10-1-78

All distances must be from the outer boundaries of the Section.

Operator <b>ME-TEX SUPPLY COMPANY</b>		Lease <b>WALLACE STATE</b>		Well No. <b>106</b>
Unit Letter <b>NK</b>	Section <b>3</b>	Township <b>21 South</b>	Range <b>36 East</b>	County <b>Lea</b>
Actual Footage Location of Well: <b>4290</b> feet from the <b>South</b> line and <b>2310</b> feet from the <b>West</b> line				
Ground Level Elev. <b>3630</b>	Producing Formation <b>Blinebry</b>	Pool <b>Oil Center Blinebry</b>	Dedicated Acreage: <b>80</b> Acres	

1. Outline the acreage dedicated to the subject well by colored pencil or hatchure marks on the plot below.
2. If more than one lease is dedicated to the well, outline each and identify the ownership thereof (both as to working interest and royalty).
3. If more than one lease of different ownership is dedicated to the well, have the interests of all owners been consolidated by communitization, unitization, force-pooling, etc?

☐ Yes ☐ No If answer is "yes," type of consolidation \_\_\_\_\_

If answer is "no," list the owners and tract descriptions which have actually been consolidated. (Use reverse side of this form if necessary.) \_\_\_\_\_

No allowable will be assigned to the well until all interests have been consolidated (by communitization, unitization, forced-pooling, or otherwise) or until a non-standard unit, eliminating such interests, has been approved by the Division.

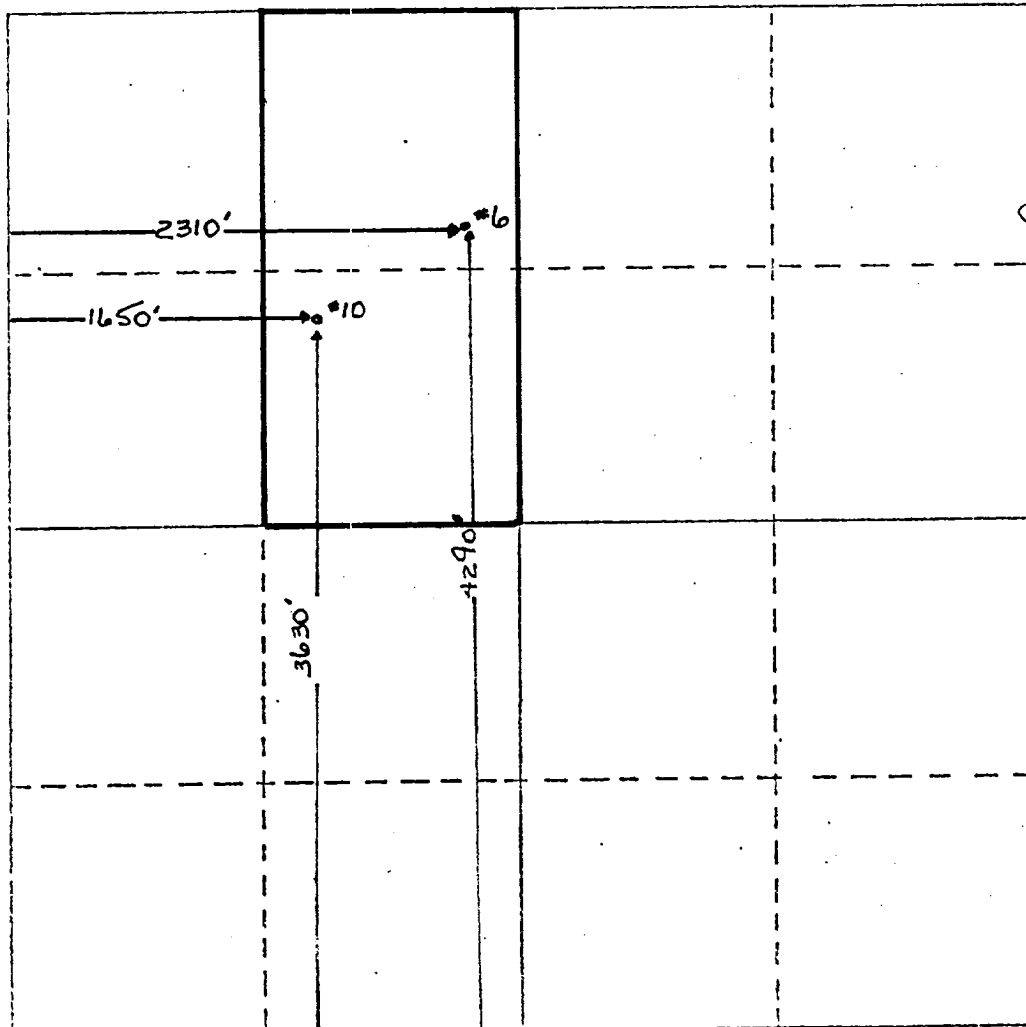

## CERTIFICATION

I hereby certify that the information contained herein is true and complete to the best of my knowledge and belief.

Name Judy Landusky  
 Position Agent  
 Company Me-Tex Supply Company  
 Date March 18, 1983

I hereby certify that the well location shown on this plot was plotted from field notes of actual surveys made by me or under my supervision, and that the same is true and correct to the best of my knowledge and belief.

Date Surveyed \_\_\_\_\_  
 Registered Professional Engineer and/or Land Surveyor \_\_\_\_\_

Certificate No. \_\_\_\_\_

RECEIVED

MAR 18 1983

O.C.D.  
HONAS OFFICE