

NEW MEXICO OIL CONSERVATION COMMISSION
Santa Fe, New Mexico

HOBBS OFFICE Form C-101
Nov 20 10 18 AM '63
Revised (12/1/55)

NOTICE OF INTENTION TO DRILL

Notice must be given to the District Office of the Oil Conservation Commission and approval obtained before drilling or recompletion begins. If changes in the proposed plan are considered advisable, a copy of this notice showing such changes will be returned to the sender. Submit this notice in QUINTUPPLICATE. One copy will be returned following approval. See additional instructions in Rules and Regulations of the Commission. If State Land submit 6 Copies Attach Form C-128 in triplicate to first 3 copies of form C-101

11-19-63

(Date)

Hobbs, New Mexico
(Place)

OIL CONSERVATION COMMISSION
SANTA FE, NEW MEXICO

Gentlemen:

You are hereby notified that it is our intention to commence the Drilling of a well to be known as
Artec Oil & Gas Company
(Company or Operator)

located **1980** feet from the **West** line of Section **11**, T. **213**, R. **37E**, NMPM. County **Lea**
Well No. **2**, in **L** (Unit) The well is **990** feet from the **South** line and **11** feet from the **Undesignated** Pool.

(GIVE LOCATION FROM SECTION LINE)

Section 11-213-37E

D	C	B	A
E	F	G	H
20	K	J	I
M	N	O	P

If State Land the Oil and Gas Lease is No. **Louis & Edward Gutman**

If patented land the owner is **N.Y. - New York**

Address.....

We propose to drill well with drilling equipment as follows:
Rotary from surface to Total depth

The status of plugging bond is **State wide**

Drilling Contractor **Not determined**

We intend to complete this well in the **Wantz Abo** formation at an approximate depth of **7100'** feet.

CASING PROGRAM

We propose to use the following strings of Casing and to cement them as indicated:

Size of Hole	Size of Casing	Weight per Foot	New or Second Hand	Depth	Sacks Cement
17 1/2"	13 3/8"	48 H	New	320'	320
12"	9 5/8"	36 J	New	3000'	550 sz
8 3/4"	7"	20 & 23	New	6000'	See 4 1/2" csg.
7 7/8"	4 1/2"	10.5	New	1100'	320 sz

If changes in the above plans become advisable we will notify you immediately.

ADDITIONAL INFORMATION (If recompletion give full details of proposed plan of work.)

Approved....., 19.....
Except as follows:

OIL CONSERVATION COMMISSION

Sincerely yours,

Artec Oil & Gas Company

original signed by (Company or Operator)

By **LESTER L. DUKE**

District Superintendent

Position..... Send Communications regarding well to

Artec Oil & Gas Company

Name..... **Box 837, Hobbs, New Mexico**

Address.....

NEW MEXICO OIL CONSERVATION COMMISSION

WELL LOCATION AND ACREAGE DEDICATION PLAT

HOBBS OFFICE O. C. C.
FORM C-128
Revised 5/1/57

SEE INSTRUCTIONS FOR COMPLETING THIS FORM ON THE REVERSE SIDE

SECTION A

Operator AZTEC OIL & GAS COMPANY			Lease GUTMAN		Well No. 2
Unit Letter L	Section 11	Township 21 SOUTH	Range 37 EAST	County LEA	
Actual Footage Location of Well: 1980 feet from the SOUTH line and 990 feet from the WEST line					
Ground Level Elev. 3426	Producing Formation Abo		Pool Undesignated	Dedicated Acreage: 40 Acres	

1. Is the Operator the only owner in the dedicated acreage outlined on the plat below? YES ☒ NO ____ . ("Owner" means the person who has the right to drill into and to produce from any pool and to appropriate the production either for himself or for himself and another. (65-3-29 (e) NMSA 1955 Comp.)
2. If the answer to question one is "no," have the interests of all the owners been consolidated by communication agreement or otherwise? YES ____ NO ____ . If answer is "yes," Type of Consolidation ____
3. If the answer to question two is "no," list all the owners and their respective interests below:

Owner	Land Description

SECTION B

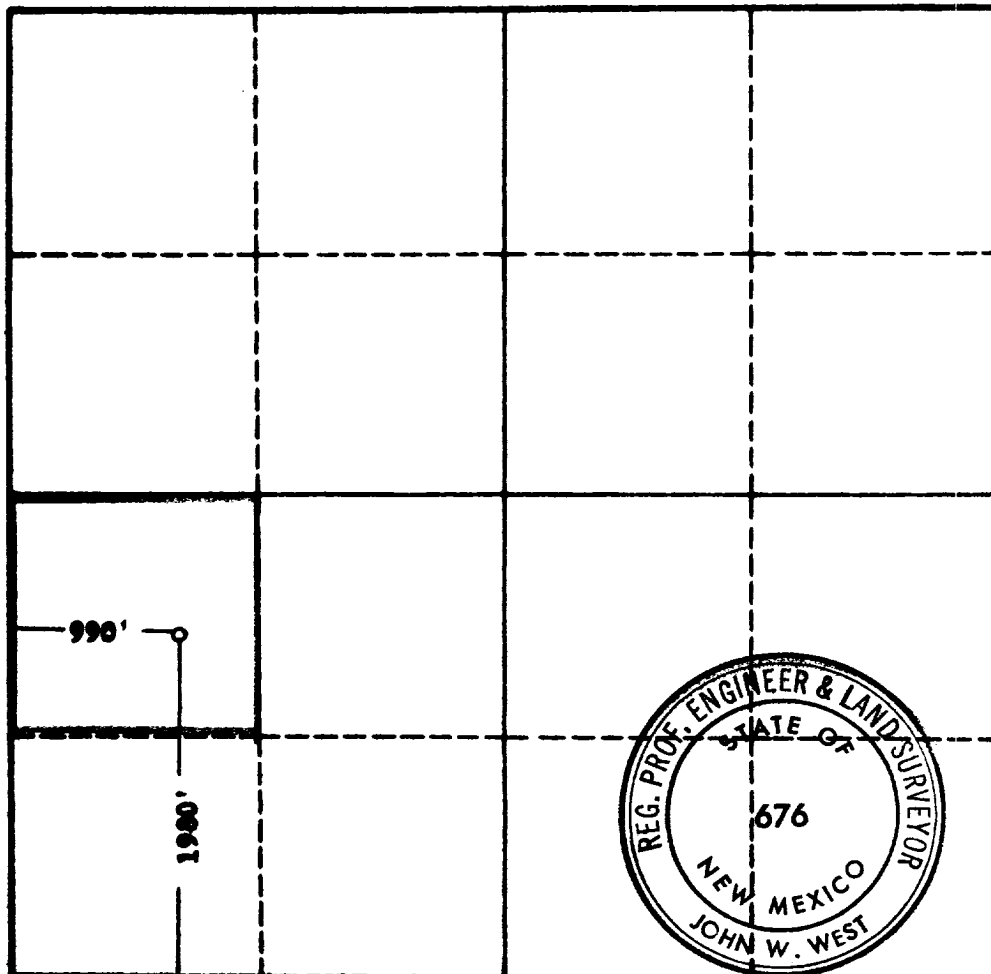

CERTIFICATION

I hereby certify that the information in SECTION A above is true and complete to the best of my knowledge and belief.

Lester L. Duke

Name Lester L. Duke
Position Dist. Superintendent
Company Aztec Oil & Gas Company
Date 11-20-63

I hereby certify that the well location shown on the plat in SECTION B was plotted from field notes of actual surveys made by me or under my supervision, and that the same is true and correct to the best of my knowledge and belief.

Date Surveyed NOV. 18, 1963
Registered Professional Engineer and/or Land Surveyor, JOHN W. WEST
<i>John W. West</i> Certificate No. N. M. - P. E. 676

0 300 600 900 1200 1500 1800 2100 2400 2700 3000 3300 3600 3900 4200 4500