

NUMBER OF COPIES RECEIVED	
DISTRIBUTION	
SANTA FE	
FILE	
U.S.G.S.	
LAND OFFICE	
TRANSPORTER	OIL
	GAS
PRODUCTION OFFICE	
OPERATOR	

NEW MEXICO OIL CONSERVATION COMMISSION  
Santa Fe, New Mexico

Form C-101  
Revised (12/1/55)

# NOTICE OF INTENTION TO DRILL

Notice must be given to the District Office of the Oil Conservation Commission and approval obtained before drilling or recompletion begins. If changes in the proposed plan are considered advisable, a copy of this notice showing such changes will be returned to the sender. Submit this notice in QUINTUPPLICATE. One copy will be returned following approval. See additional instructions in Rules and Regulations of the Commission. If State Land submit 6 Copies Attach Form C-128 in triplicate to first 3 copies of form C-101

Hobbs, New Mexico

September 17, 1963

(Place)

(Date)

OIL CONSERVATION COMMISSION  
SANTA FE, NEW MEXICO

Gentlemen:

You are hereby notified that it is our intention to commence the Drilling of a well to be known as  
**Sunray DX Oil Company**

State Land "15"

(Company or Operator)

6

0

(Lease)

, Well No. , in. The well is

located. 330 feet from the South line and 1650 feet from the

East

South

16

219

37E

line of Section , T. , R. , NMPM.

(GIVE LOCATION FROM SECTION LINE)

Undesignated

Lea

R-36-E

Pool, B-8105 County

If State Land the Oil and Gas Lease is No.

If patented land the owner is

Address

We propose to drill well with drilling equipment as follows:

Rotary Tools  
O-TD

The status of plugging bond is approved

Drilling Contractor

Noble Drilling Corp.  
321 Pan American Bldg.  
Tulsa, Oklahoma

We intend to complete this well in the Wantz-Abe formation at an approximate depth of 7300 feet.

## CASING PROGRAM

We propose to use the following strings of Casing and to cement them as indicated:

Size of Hole	Size of Casing	Weight per Foot	New or Second Hand	Depth	Sacks Cement
Contractor	13-3/8	48#	New	250'	250*
Contractor	8-5/8	24,32#	New	3000'	660*
Contractor	4-1/2	9.5,10.5,11.6#	New	7300'	560**

If changes in the above plans become advisable we will notify you immediately.

ADDITIONAL INFORMATION (If recompletion give full details of proposed plan of work.)

\*To circulate

\*\*To tie to intermediate csg.

Approved, 19

Except as follows:

Sincerely yours,

Sunray DX Oil Company

(Company or Operator)

By

V. R. Mayabb

Position

District Engineer

Send Communications regarding well to

Name C. T. McClanahan

Address P.O. Box 128, Hobbs, N.M.

By

OIL CONSERVATION COMMISSION

NEW MEXICO OIL CONSERVATION COMMISSION  
WELL LOCATION AND ACREAGE DEDICATION PLAT

FORM C-128  
Rev. 5/1/57

SEE INSTRUCTIONS FOR COMPLETING THIS FORM ON THE REVERSE SIDE

17 PM 4:38

SECTION A

Operator <b>SUNRAY OIL COMPANY</b>			Lease <b>STATE LAND 15</b>		Well No. <b>6</b>
Unit Letter <b>O</b>	Section <b>16</b>	Township <b>21 SOUTH</b>	Range <b>37 EAST</b>	County <b>LEA</b>	
Actual Footage Location of Well: <b>330</b> feet from the <b>SOUTH</b> line and <b>1650</b> feet from the <b>EAST</b> line					
Ground Level Elev. <b>3450 (K&amp;L)</b>	Producing Formation		Pool <b>Undesignated</b>	Dedicated Acreage: <b>10</b> Acres	

1. Is the Operator the only owner in the dedicated acreage outlined on the plat below? YES ☒ NO ☐ ("Owner" means the person who has the right to drill into and to produce from any pool and to appropriate the production either for himself or for himself and another. (65-3-29 (c) NMSA 1955 Comp.)
2. If the answer to question one is "no," have the interests of all the owners been consolidated by communitization agreement or otherwise? YES ☐ NO ☐ . If answer is "yes," Type of Consolidation \_\_\_\_\_
3. If the answer to question two is "no," list all the owners and their respective interests below:

Owner	Land Description

SECTION B

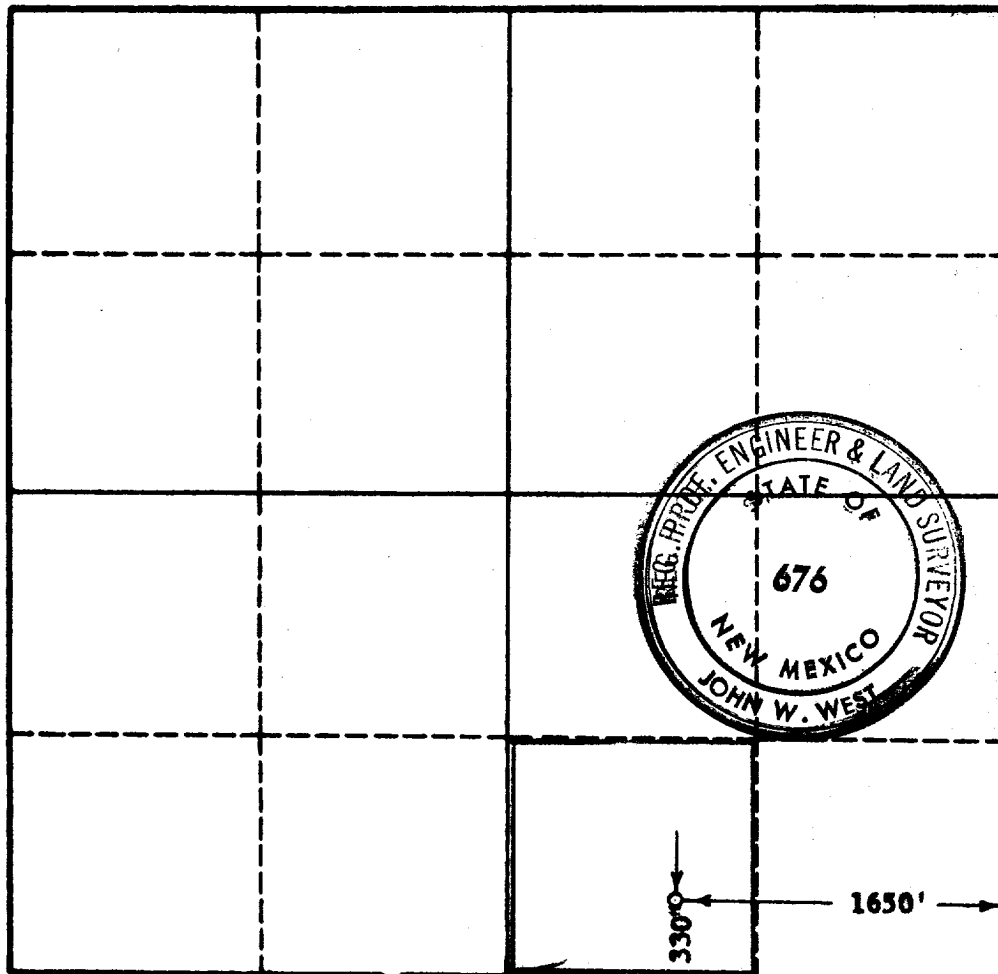

CERTIFICATION

I hereby certify that the information in SECTION A above is true and complete to the best of my knowledge and belief.

Name **J. R. Mayhew**  
Position **Mineral Engineer**  
Company **Sunray Oil Company**  
Date **September 17, 1963**

I hereby certify that the well location shown on the plat in SECTION B was plotted from field notes of actual surveys made by me or under my supervision, and that the same is true and correct to the best of my knowledge and belief.

Date Surveyed **SEPT. 12, 1963**  
Registered Professional Engineer and/or Land Surveyor, **JOHN W. WEST**  
Certificate No. **JOHN W. WEST**  
**N.M. - P.E. & L.S. NO. 676**

0 330 660 990 1320 1650 1980 2310 2640 2970 3300 3630 3960 4290 4620 4950 5280 5610 5940 6270 6600