

WRS COMPLETION REPORT

COMPLETIONS
PI# 30-1-0010 08/08/88 SEC 3 TWP 21S RGE 36E
30-025-20362-0001 PAGE 1

NMEX LEA * 1648FSL 990FEL SEC NE SE
STATE COUNTY FOOTAGE SPCT
SUN EXPL & PROD OPERATOR D X D
9 AKENS J A WELL CLASS INT FIN

WELL NO 3552ES LEASE NAME OIL CENTER
OPER ELEV FIELD POOL AREA

LEASE TYPE NO API 30-025-20362-0001
PERMIT OR WELL ID NO

SPUD DATE 04/27/1987 06/08/1987 WO-UNIT D&AWG
5660 NOT RPTD STATUS

PROJ DEPTH 6296 PROJ FORM CONTRACTOR OTD 6296 FM/TD BLINEBRY
DRILLERS LOG TO PLUG BACK TO OLD TO FORM TO

LOCATION DESCRIPTION

1/2 MI E OIL CENTER, NM

CASING/LINER DATA

RECORDS DO NOT INDICATE THAT WELL IS PLGD TO SURF

PRODUCTION TEST DATA

BLINEBRY PERF 5826- 5863
PERF 5826- 5863
BRPG @ 5660 5826- 5863
PTP 10 MCFD 15BW 24HRS
GLORIETA PERF W/ 55/IT 5197- 5274
PERF 5197- 5274
ACID 5197- 5274 2000GALS
15% NEFE

DRILLING PROGRESS DETAILS

SUN EXPL & PROD
BOX 1861
MIDLAND, TX 79702
915-688-0300
OWWO: OLD INFO: FORMERLY SUN OIL #9 AKENS J A
ELEV 3552 ES. SPUD 9/25/63. 8 5/8 @ 1276 W/500
SX, 5 1/2 @ 6296 W/550 SX. LOG TOPS: SAN
ANDRES 3883, YESO 5194, BLINEBRY 5824. OTD
6296. PBD 6276. COMP 11/13/63. IPP 68 BO, 47

CONTINUED IC# 300257031788

COMPLETIONS SEC 3 TWP 21S RGE 36E
PI# 30-T-0010 08/08/88 30-025-20362-0001 PAGE 2

SUN EXPL & PROD
9 AKENS J A

D X D

DRILLING PROGRESS DETAILS

07/29 BWPD. PROD ZONE: BLINEBRY 5826-5863.
LOC/1988/
08/01 OPER TEMP ABND WELL 6/8/87. PENDING FURTHER
EVALUATION.
08/04 6296 TD
COMP 6/8/87. D&A
FIRST REPORT & COMPLETION

All distances must be from the outer boundaries of the Section.

Operator Sun Exploration & Production Co.			Lease Akins J. A.		Well No. 9
Unit Letter Q	Section 3	Township 21-S	Range 36-E	County Lea	
Actual Footage Location of Well: 990 feet from the East line and 1648.5 feet from the South line					
Ground Level Elev. 3541 GR	Producing Formation Glorieta	Pool Oil Center Glorieta Gas	Dedicated Acreage: 160 Acres		

1. Outline the acreage dedicated to the subject well by colored pencil or hachure marks on the plat below.
2. If more than one lease is dedicated to the well, outline each and identify the ownership thereof (both as to working interest and royalty).
3. If more than one lease of different ownership is dedicated to the well, have the interests of all owners been consolidated by communitization, unitization, force-pooling, etc?

☐ Yes ☐ No If answer is "yes," type of consolidation _____

If answer is "no," list the owners and tract descriptions which have actually been consolidated. (Use reverse side of this form if necessary.) _____

No allowable will be assigned to the well until all interests have been consolidated (by communitization, unitization, forced-pooling, or otherwise) or until a non-standard unit, eliminating such interests, has been approved by the Division.

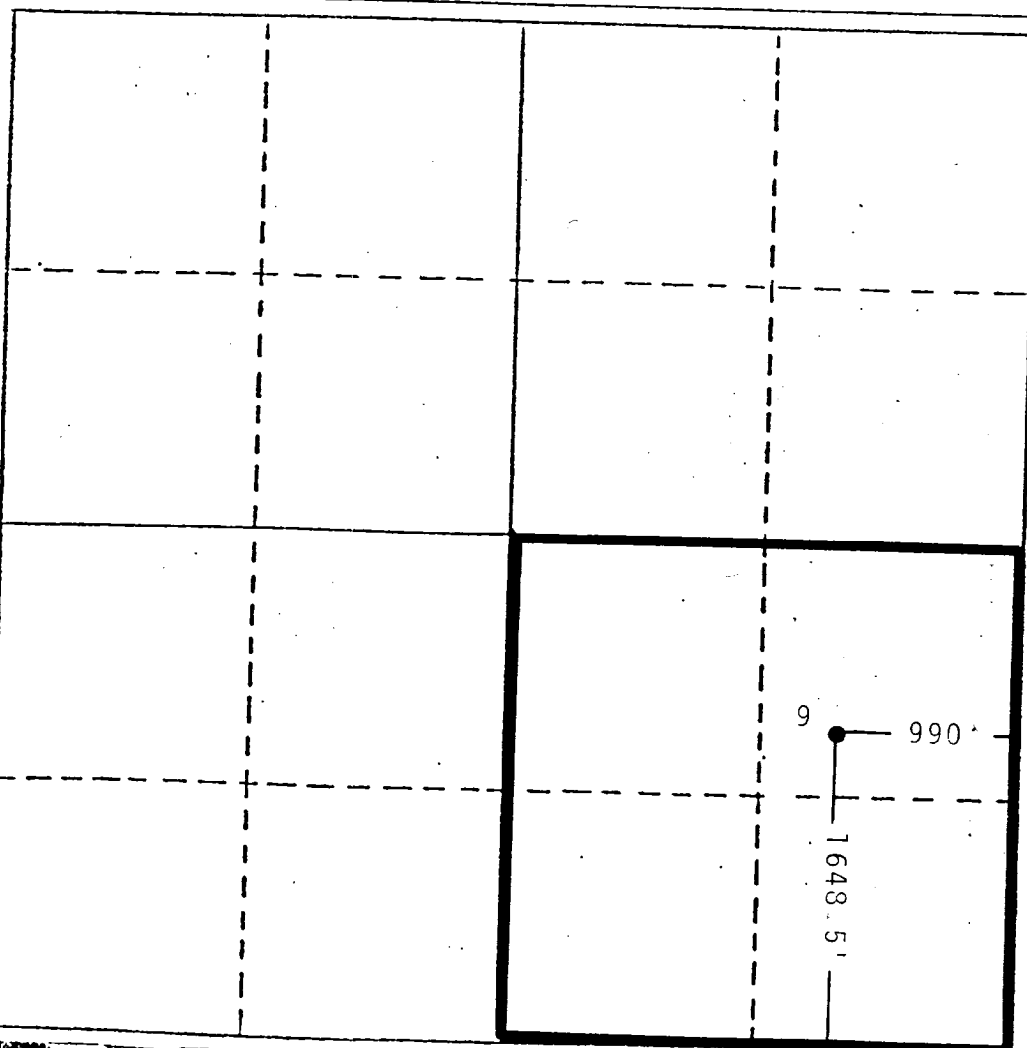

CERTIFICATION

I hereby certify that the information contained herein is true and complete to the best of my knowledge and belief.

Maria L. Perez
Name
Maria L. Perez

Position
Associate Accountant

Company
Sun Expl. & Prod. Co.

Date
4-24-87

I hereby certify that the well location shown on this plat was plotted from field notes of actual surveys made by me or under my supervision, and that the same is true and correct to the best of my knowledge and belief.

Date Surveyed

Registered Professional Engineer and/or Land Surveyor

Certificate No.

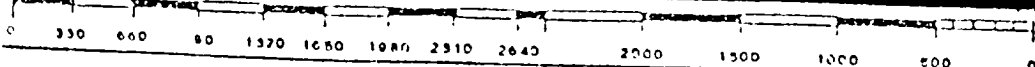

Revised

NEW MEXICO OIL CONSERVATION COMMISSION
WELL LOCATION AND ACREAGE DEDICATION PLAT

Form C-102
Supersedes C-128
Effective 1-1-65

All distances must be from the outer boundaries of the Section.

Operator Sun Oil Company			Lease Akens, J. A.		Well No. 9
Unit Letter Q	Section 3	Township 21-S	Range 36-E	County Lea	
Actual Footage Location of Well: 990 feet from the East line and 1648.5 feet from the South line					
Ground Level Elev. GR 3541'	Producing Formation Blinebry		Pool Oil Center Blinebry	Dedicated Acreage: Acres	

1. Outline the acreage dedicated to the subject well by colored pencil or hatchure marks on the plat below.
2. If more than one lease is dedicated to the well, outline each and identify the ownership thereof (both as to working interest and royalty).
3. If more than one lease of different ownership is dedicated to the well, have the interests of all owners been consolidated by communitization, unitization, force-pooling, etc?

☐ Yes ☐ No If answer is "yes," type of consolidation _____

If answer is "no," list the owners and tract descriptions which have actually been consolidated. (Use reverse side of this form if necessary.) _____

No allowable will be assigned to the well until all interests have been consolidated (by communitization, unitization, forced-pooling, or otherwise) or until a non-standard unit, eliminating such interests, has been approved by the Commission.

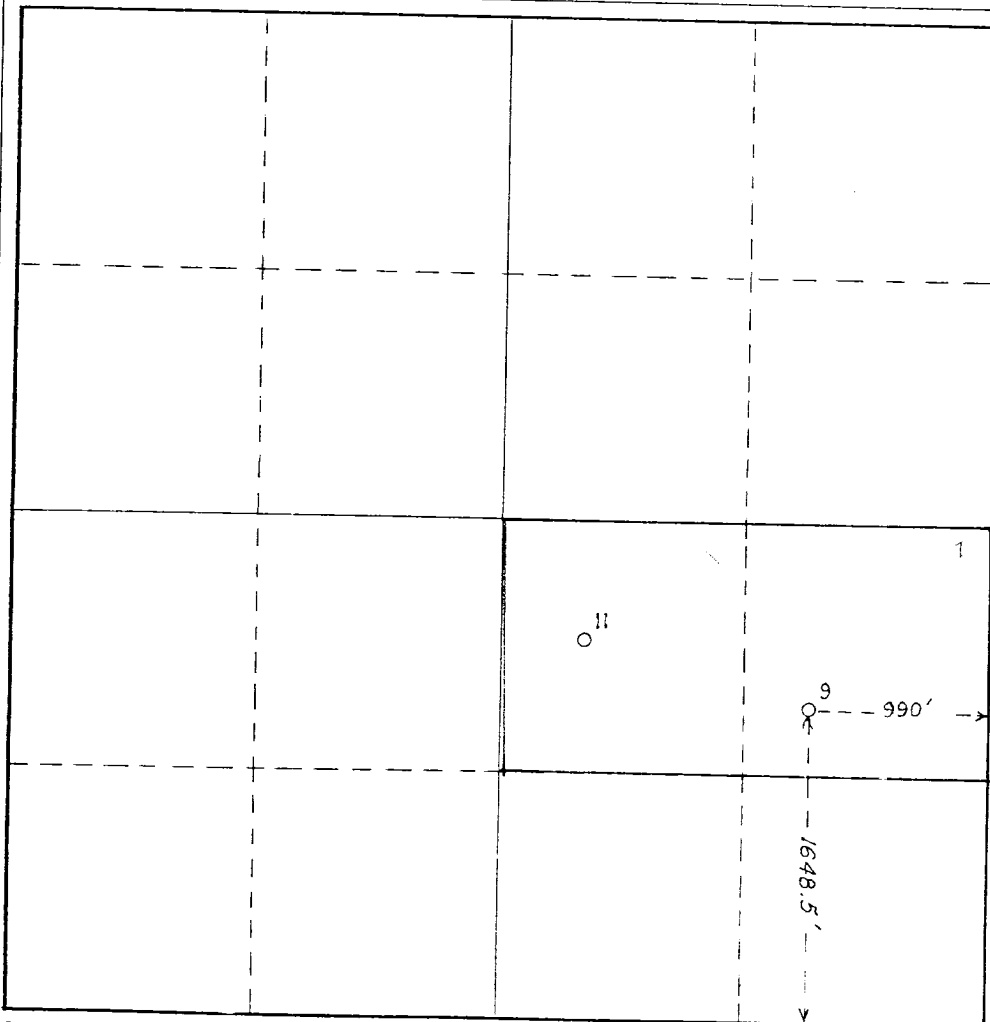

CERTIFICATION

I hereby certify that the information contained herein is true and complete to the best of my knowledge and belief.

Teresa Bradley
Name

Teresa Bradley

Position

Accounting Assistant

Company

Sun Oil Company

Date

7-21-80

I hereby certify that the well location shown on this plat was plotted from field notes of actual surveys made by me or under my supervision, and that the same is true and correct to the best of my knowledge and belief.

Date Surveyed

Registered Professional Engineer
and/or Land Surveyor

Certificate No.

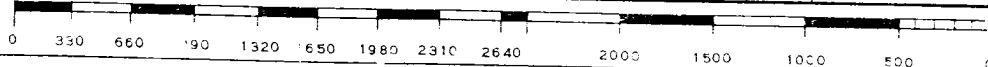

COUNTY	Lea	FIELD	Oil Center-Blinebry	STATE	N.M.	NO.	
OPR	Sun Oil Company	MAP					
NO.	9	LSE	Akens, J.A.				
SEC.	3	T.	21S	BLK R	36E	SUR	CO-ORD
LOC.	1648' fr S Line & 990' fr E Line of Sec.						
MI.	FROM	CLASS.	EL. <u>3552</u>				
SPUD.	9-25-63	COMP.	11-13-63	FORMATION	DATUM	FORMATION	DATUM
IRT.				LOG:			
				Yates	2647		
CSG. & SX.				Qn	3336		
8 5/8"	1276'	500		Grb.	3641		
5 1/2"	6296'	550		SA	3883		
				Yeso	5194		
TBG.	DEPTH	SIZE		Bline	5824		
LOGS	EL	GR	RA	IND	HC	A	
				TD	6296'		PB 6276'
PROD INT.	(DAILY RATE)	BS&W	GH	GOR	GTY	C. P.	T. P. HRS TEST
5826-63'	Pmpd 68	BO + 47	BW	1462	42.5		24 hrs
(Blinebry)							
Distribution limited and publication prohibited by subscribers' agreement. Reproduction rights reserved by Williams & Lee Scouting Service, Inc.							
CONT.				PROP DEPTH	6400'	TYPE	
DATE							

F.R. 9-19-63
 PD 6400', Blinebry.
 9-30-63 Drlg. 2130'.
 10-7-63 Drlg. 4290'.
 10-14-63 TD 6296', rung logs.
 10-21-63 TD 6296', PB 6276', swbg.
 Perf 5730', 5740', 5744', 5749', w/1 SPI.
 Ac. 500, Swb AW to pits/5 hrs w/NS O&G.
 10-28-63 TD 6296', PB 6276', swbg.
 Perfs 5730-49', swb dry.
 Perf 5826', 5830', 5837', 5842', 5850', 5855',
 5856', Set pkr. @ 5754', Ac. 1000 gals,
 Swb 13 BNO + 5 bbls salt wtr. + 7 BA &
 load wtr./7 hrs.
 11-4-63 TD 6296', PB 6276', swbg.
 Flo 39 BO + 3 BL&AW/14 hrs on 20/64",

-cont'd-

Lea Oil Center-Blinebry N.M.
Sun Oil Company #9 Akens, J.A.

Sec. 3-21S-36E
Page #2

11-4-63 -cont'd-
Perf 5828', 5838', 5846', 5848', 5853',
5861', 5863', Ac. perfs (5826-63)
1500 gals, Swb 70 BLO & AW/3 hrs.
11-11-63 TD 6296-, PB 6276', RU Pump.
Re-Ac. (5826-63) 10,000 gals,
Swb 22 BO + 20 BLW/9 hrs.
11-18-63 TD 6296', PB 6276', tstg. on pump.
Ppd 55 BNO + 11 BFW/24 hrs.
11-26-63 TD 6296', PB 6276', COMPLETED.