

NO. OF COPIES RECEIVED	
DISTRIBUTION	
SANTA FE	
FILE	
U.S.G.S.	
LAND OFFICE	
OPERATOR	

NEW MEXICO OIL CONSERVATION COMMISSION, C.

Form C-103  
Supersedes Old  
C-102 and C-103  
Effective 1-1-65

JAN 16 8 12 AM '67

5a. Indicate Type of Lease State <input checked="" type="checkbox"/> Fee <input type="checkbox"/>
5. State Oil & Gas Lease No. <b>00-534</b>
7. Unit Agreement Name
8. Farm or Lease Name <b>State WE "K"</b>
9. Well No. <b>1</b>
10. Field and Pool, or Wildcat <b>Wildcat</b>
12. County <b>Lea</b>

### SUNDRY NOTICES AND REPORTS ON WELLS

(DO NOT USE THIS FORM FOR PROPOSALS TO DRILL OR TO DEEPEN OR PLUG BACK TO A DIFFERENT RESERVOIR. USE "APPLICATION FOR PERMIT -" (FORM C-101) FOR SUCH PROPOSALS.)

1. OIL WELL <input type="checkbox"/> GAS WELL <input type="checkbox"/> OTHER- <b>Drilling Well</b>
2. Name of Operator <b>Amerada Petroleum Corporation</b>
3. Address of Operator <b>P.O. Box 668 - Hobbs, New Mexico</b>
4. Location of Well UNIT LETTER <b>F</b> , <b>1980</b> FEET FROM THE <b>West</b> LINE AND <b>1980</b> FEET FROM THE <b>North</b> LINE, SECTION <b>15</b> TOWNSHIP <b>218</b> RANGE <b>35E</b> NMPM.
15. Elevation (Show whether DF, RT, GR, etc.)

16.

Check Appropriate Box To Indicate Nature of Notice, Report or Other Data

NOTICE OF INTENTION TO:

SUBSEQUENT REPORT OF:

PERFORM REMEDIAL WORK ☐  
TEMPORARILY ABANDON ☐  
PULL OR ALTER CASING ☐  
OTHER ☐

PLUG AND ABANDON ☐  
CHANGE PLANS ☐

REMEDIAL WORK ☐  
COMMENCE DRILLING OPNS. ☒  
CASING TEST AND CEMENT JOB ☒  
OTHER ☐

ALTERING CASING ☐  
PLUG AND ABANDONMENT ☐

17. Describe Proposed or Completed Operations (Clearly state all pertinent details, and give pertinent dates, including estimated date of starting any proposed work) SEE RULE 1103.

Spudded 17-1/2" hole at 11:00 PM 1-10-67.

Finished drilling 17-1/2" hole to 323' at 10:00 AM 1-11-67.

Ran 10 jts. 13-3/8" OD casing set at 321'. Cemented with 400 sacks Class "C" cement with 2% Calcium Chloride. Pumped plug to 280' at 5:00 PM 1-11-67 with 325# Max. PP. Cement circulated. Waited 29 hrs. Tested 13-3/8" OD casing with 1000# for 1/2 hr. Held OK.

Started drilling 12-1/4" hole from 323' at 4:30 AM 1-13-67.

18. I hereby certify that the information above is true and complete to the best of my knowledge and belief.

SIGNED B. D. King TITLE District Superintendent DATE 1-13-67

APPROVED BY \_\_\_\_\_ TITLE \_\_\_\_\_ DATE \_\_\_\_\_

CONDITIONS OF APPROVAL, IF ANY:



NEW MEXICO OIL CONSERVATION COMMISSION  
WELL LOCATION AND ACREAGE DEDICATION PLAT

Form C-102  
Supersedes C-128  
Effective 1-1-65

HOBBS OFFICE O. C. C.

All distances must be from the outer boundaries of the Section.

Operator <b>AMERADA PETROLEUM CORPORATION</b>		Lease <b>JAN 5 STATE 25 PM '67</b>		Well No. <b>1</b>
Unit Letter <b>F</b>	Section <b>15</b>	Township <b>21 SOUTH</b>	Range <b>35 EAST</b>	County <b>LEA</b>
Actual Footage Location of Well: <b>1980</b> feet from the <b>NORTH</b> line and <b>1980</b> feet from the <b>WEST</b> line				
Ground Level Elev.	Producing Formation <b>San Juan</b>	Pool <b>Wildcat - South Gate Area</b>	Dedicated Acreage: <b>320</b> Acres	

1. Outline the acreage dedicated to the subject well by colored pencil or hatchure marks on the plat below.
2. If more than one lease is dedicated to the well, outline each and identify the ownership thereof (both as to working interest and royalty).
3. If more than one lease of different ownership is dedicated to the well, have the interests of all owners been consolidated by communitization, unitization, force-pooling, etc?

☐ Yes ☐ No If answer is "yes," type of consolidation \_\_\_\_\_

If answer is "no," list the owners and tract descriptions which have actually been consolidated. (Use reverse side of this form if necessary.) \_\_\_\_\_

No allowable will be assigned to the well until all interests have been consolidated (by communitization, unitization, forced-pooling, or otherwise) or until a non-standard unit, eliminating such interests, has been approved by the Commission.

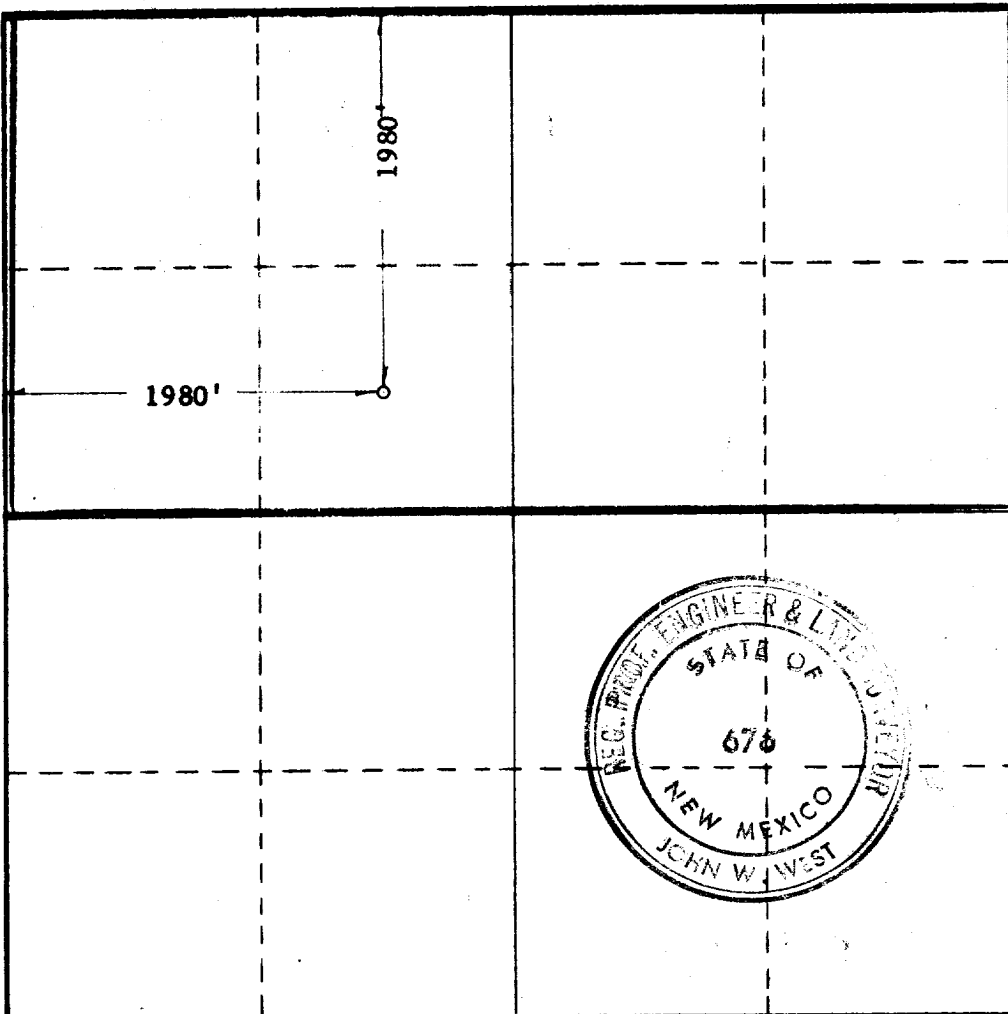

CERTIFICATION

I hereby certify that the information contained herein is true and complete to the best of my knowledge and belief.

Name **B. D. Liny**  
Position **District Superintendent**  
Company **Amerada Petroleum Corporation**  
Date **January 4, 1967**

I hereby certify that the well location shown on this plat was plotted from field notes of actual surveys made by me or under my supervision, and that the same is true and correct to the best of my knowledge and belief.

Date Surveyed **1-4-67**

Registered Professional Engineer and/or Land Surveyor

**John W West**  
Certificate No. **676**



**NEW MEXICO OIL CONSERVATION COMMISSION  
WELL LOCATION AND ACREAGE DEDICATION PLAT**

Form C-102  
Supersedes C-128  
Effective 1-1-65

All distances must be from the outer boundaries of the Section.

Operator <b>Amerada Petroleum Corporation</b>			Lease <b>State of N.M. 57-AM '67</b>		Well No. <b>1</b>
Unit Letter <b>F</b>	Section <b>15</b>	Township <b>21-S</b>	Range <b>35-E</b>	County <b>Lea</b>	
Actual Footage Location of Well:					
<b>1980</b> feet from the <b>North</b> line and		<b>1980</b> feet from the <b>West</b> line			
Ground Level Elev. <b>3615' DF</b>	Producing Formation <b>Wolfcamp</b>	Pool <b>Wildcat</b>	Dedicated Acreage: <b>320</b> Acres		

1. Outline the acreage dedicated to the subject well by colored pencil or hachure marks on the plat below.
2. If more than one lease is dedicated to the well, outline each and identify the ownership thereof (both as to working interest and royalty).
3. If more than one lease of different ownership is dedicated to the well, have the interests of all owners been consolidated by communitization, unitization, force-pooling, etc?

☐ Yes   ☐ No   If answer is "yes," type of consolidation \_\_\_\_\_

If answer is "no," list the owners and tract descriptions which have actually been consolidated. (Use reverse side of this form if necessary.) \_\_\_\_\_

No allowable will be assigned to the well until all interests have been consolidated (by communitization, unitization, forced-pooling, or otherwise) or until a non-standard unit, eliminating such interests, has been approved by the Commission.

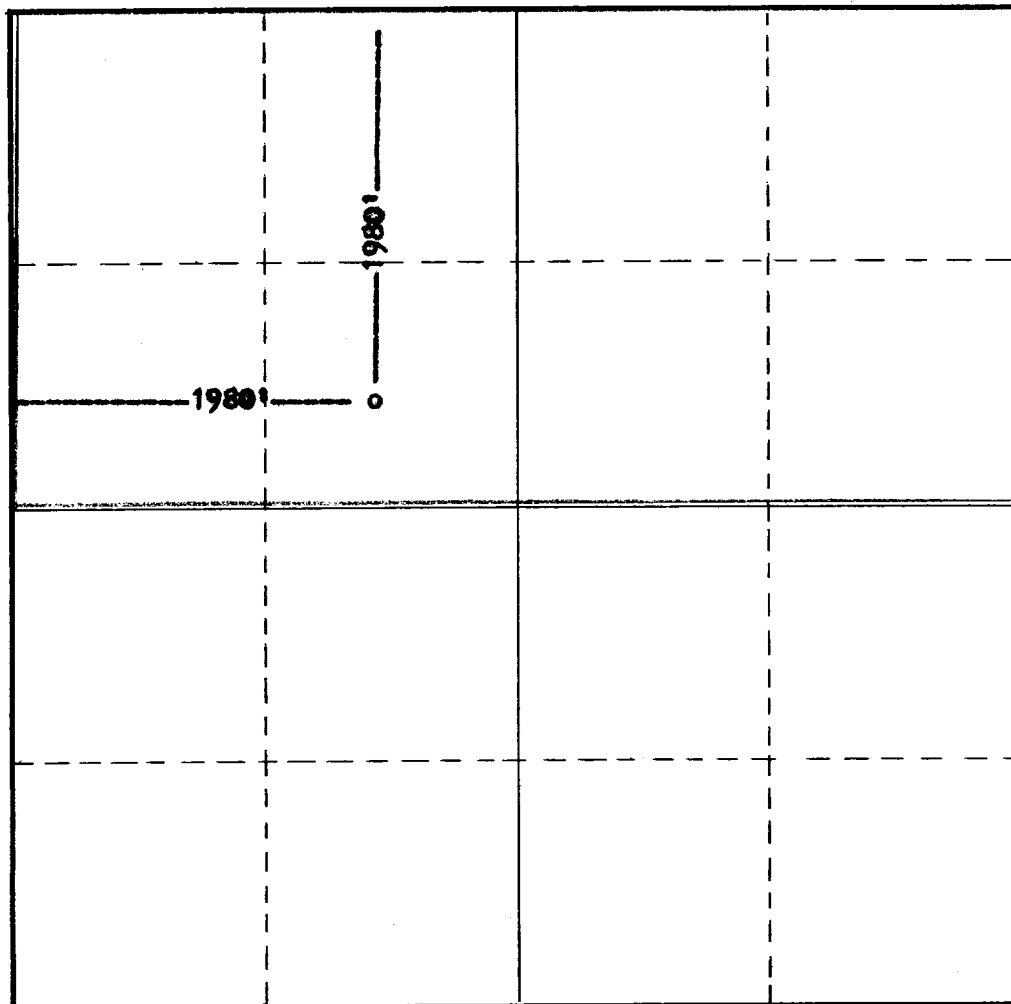

**CERTIFICATION**

I hereby certify that the information contained herein is true and complete to the best of my knowledge and belief.

Name  
**B. J. Sims**  
Position  
**District Superintendent**  
Company  
**Amerada Petroleum Corp.**

Date  
**July 7, 1967**

I hereby certify that the well location shown on this plat was plotted from field notes of actual surveys made by me or under my supervision, and that the same is true and correct to the best of my knowledge and belief.

Date Surveyed

Registered Professional Engineer and/or Land Surveyor

Certificate No.

