

NO. OF COPIES RECEIVED	
DISTRIBUTION	
SANTA FE	
FILE	
U.S.G.S.	
LAND OFFICE	
OPERATOR	

NEW MEXICO OIL CONSERVATION COMMISSION

Form C-101
Revised 1-1-65

JUL 13 10 43 AM '69

5A. Indicate Type of Lease	
STATE <input type="checkbox"/>	FEE <input checked="" type="checkbox"/>
5. State Oil & Gas Lease No.	

APPLICATION FOR PERMIT TO DRILL, DEEPEN, OR PLUG BACK

1a. Type of Work			7. Unit Agreement Name		
b. Type of Well DRILL <input checked="" type="checkbox"/> DEEPEN <input type="checkbox"/> PLUG BACK <input type="checkbox"/> OIL WELL <input checked="" type="checkbox"/> GAS WELL <input type="checkbox"/> OTHER <input type="checkbox"/> SINGLE ZONE <input checked="" type="checkbox"/> MULTIPLE ZONE <input type="checkbox"/>			8. Farm or Lease Name Nancy		
2. Name of Operator SOLAR OIL COMPANY			9. Well No. 1		
3. Address of Operator P. O. Box 5596 Midland, Texas			10. Field and Pool, or Wildcat Undesignated		
4. Location of Well UNIT LETTER <u>N</u> LOCATED <u>660</u> FEET FROM THE <u>South</u> LINE AND <u>1980</u> FEET FROM THE <u>West</u> LINE OF SEC. <u>24</u> TWP. <u>T-21-S</u> RGE. <u>R-37-E</u> N14MPM			12. County Lea		
19. Proposed Depth 7500'			19A. Formation Abo		20. Rotary or C.T. Rotary
21. Elevations (Show whether DF, RT, etc.)	21A. Kind & Status Plug. Bond Blanket-current	21B. Drilling Contractor Not selected	22. Approx. Date Work will start 7-7-69		

23.

PROPOSED CASING AND CEMENT PROGRAM

SIZE OF HOLE	SIZE OF CASING	WEIGHT PER FOOT	SETTING DEPTH	SACKS OF CEMENT	EST. TOP
11"	8-5/8"	24#	850'	325 sx	Circ.
7-7/8"	5-1/2"	17#	7500'	650 sx	Base of salt

It is proposed to drill a well to a depth sufficient to test the Abo formation, estimated at 7500'.

8 5/8

10-11-69

IN ABOVE SPACE DESCRIBE PROPOSED PROGRAM: IF PROPOSAL IS TO DEEPEN OR PLUG BACK, GIVE DATA ON PRESENT PRODUCTIVE ZONE AND PROPOSED NEW PRODUCTIVE ZONE. GIVE BLOWOUT PREVENTER PROGRAM, IF ANY.

I hereby certify that the information above is true and complete to the best of my knowledge and belief.

Signed [Signature] Title Production Clerk Date July 2, 1969

(This space for State Use)

APPROVED BY [Signature] TITLE SUPERVISOR DISTRICT DATE JUL 11 1969

CONDITIONS OF APPROVAL, IF ANY:

NEW MEXICO OIL CONSERVATION COMMISSION
WELL LOCATION AND ACREAGE DEDICATION PLAT

Form C-102
Supersedes C-128
Effective 1-1-65

ALL DISTANCES MUST BE FROM THE OUTER BOUNDARIES OF THE SECTION.

Operator SOLAR OIL COMPANY			Lease JUL 10 10 43 AM '69 NANCY		Well No. 1
Unit Letter N	Section 24	Township 21 SOUTH	Range 37 EAST	County LEA	
Actual Footage Location of Well: 660 feet from the SOUTH line and 1980 feet from the WEST line					
Ground Level Elev. 3423	Producing Formation Abo		Poor Indesignated	Dedicated Acreage: 40 Acres	

1. Outline the acreage dedicated to the subject well by colored pencil or hachure marks on the plat below.
2. If more than one lease is dedicated to the well, outline each and identify the ownership thereof (both as to working interest and royalty).
3. If more than one lease of different ownership is dedicated to the well, have the interests of all owners been consolidated by communitization, unitization, force-pooling, etc?

☐ Yes ☐ No If answer is "yes," type of consolidation _____

If answer is "no," list the owners and tract descriptions which have actually been consolidated. (Use reverse side of this form if necessary.) _____

No allowable will be assigned to the well until all interests have been consolidated (by communitization, unitization, forced-pooling, or otherwise) or until a non-standard unit, eliminating such interests, has been approved by the Commission.

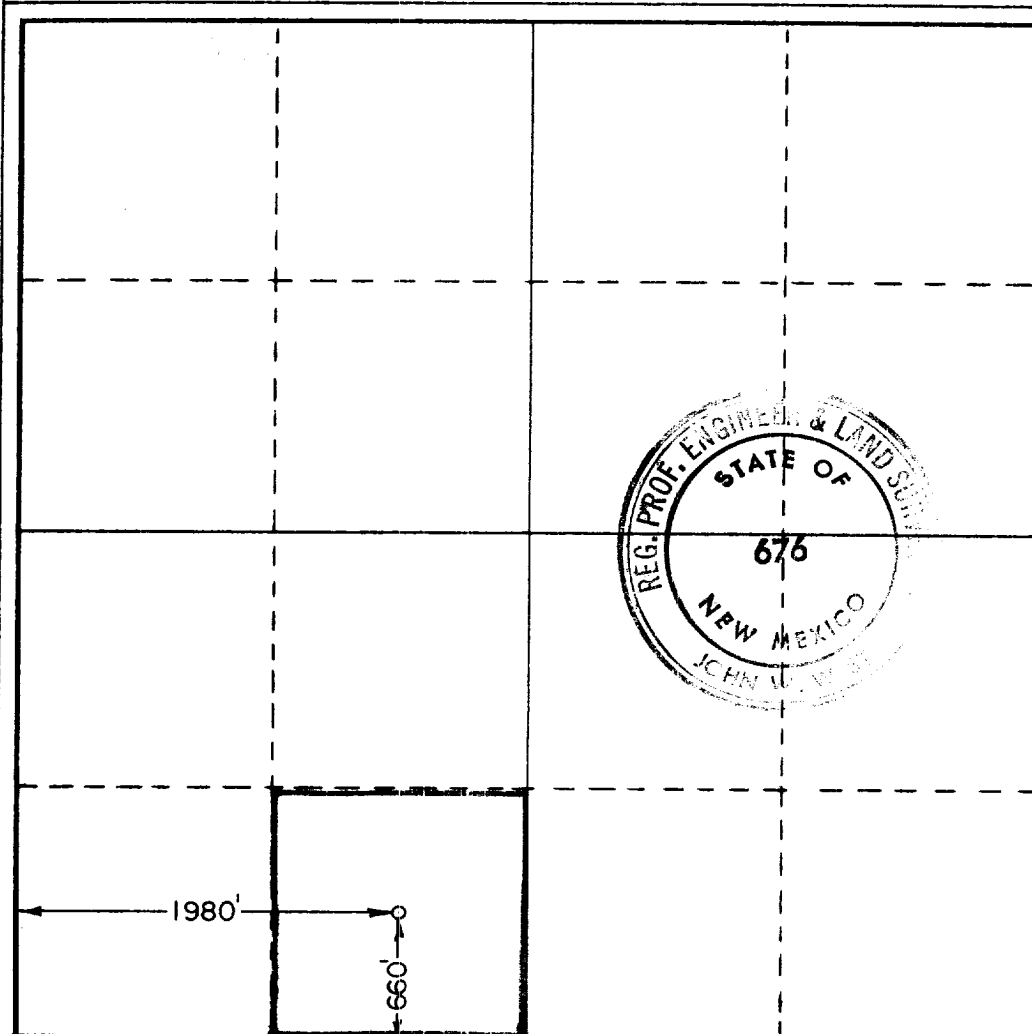

CERTIFICATION

I hereby certify that the information contained herein is true and complete to the best of my knowledge and belief.

Name
M. J. Smith

Position
Production

Company
SOLAR OIL COMPANY

Date
July 2, 1969

I hereby certify that the well location shown on this plat was plotted from field notes of actual surveys made by me or under my supervision, and that the same is true and correct to the best of my knowledge and belief.

Date Surveyed
JULY 2, 1969

Registered Professional Engineer and/or Land Surveyor

John W. West
Certificate No. **676**

