

NO. OF COPIES RECEIVED	
DISTRIBUTION	
SANTA FE	
FILE	
U.S.G.S.	
LAND OFFICE	
OPERATOR	

NEW MEXICO OIL CONSERVATION COMMISSION

Form C-101
Revised 1-1-65

5A. Indicate Type of Lease	
STATE <input type="checkbox"/>	FEE <input checked="" type="checkbox"/>
5. State Oil & Gas Lease No.	

APPLICATION FOR PERMIT TO DRILL, DEEPEN, OR PLUG BACK

1a. Type of Work		7. Unit Agreement Name	
b. Type of Well DRILL <input checked="" type="checkbox"/> DEEPEN <input type="checkbox"/> PLUG BACK <input type="checkbox"/> OIL WELL <input checked="" type="checkbox"/> GAS WELL <input type="checkbox"/> OTHER <input type="checkbox"/> SINGLE ZONE <input checked="" type="checkbox"/> MULTIPLE ZONE <input type="checkbox"/>		8. Farm or Lease Name W. W. Weatherly	
2. Name of Operator SUN OIL COMPANY		9. Well No. 5	
3. Address of Operator P. O. Box 1861, Midland, Texas 79701		10. Field and Pool, or Wildcat Penrose-Skelly (Grayburg)	
4. Location of Well UNIT LETTER <u>B</u> LOCATED <u>660</u> FEET FROM THE <u>North</u> LINE AND <u>1980'</u> FEET FROM THE <u>East</u> LINE OF SEC. <u>17</u> TWP. <u>21-S</u> RGE. <u>37-E</u> NMPM		12. County Lea	
19. Proposed Depth 3900'		19A. Formation Grayburg	
20. Rotary or C.T. Rotary		21. Elevations (Show whether DF, RT, etc.) 3484.8 G.L.	
21A. Kind & Status Plug. Bond Regular		21B. Drilling Contractor Cactus	
22. Approx. Date Work will start 3-1-71			

23. PROPOSED CASING AND CEMENT PROGRAM

SIZE OF HOLE	SIZE OF CASING	WEIGHT PER FOOT	SETTING DEPTH	SACKS OF CEMENT	EST. TOP
12 1/4	8 5/8	24#	1260'	520	Circ.
7 7/8	5 1/2	14#	TD	200	2800'

BOP Size = 10"; API Series 900 Double Gate

EXPIRES 5-24-71

IN ABOVE SPACE DESCRIBE PROPOSED PROGRAM; IF PROPOSAL IS TO DEEPEN OR PLUG BACK, GIVE DATA ON PRESENT PRODUCTIVE ZONE AND PROPOSED NEW PRODUCTIVE ZONE. GIVE BLOWOUT PREVENTER PROGRAM, IF ANY.

I hereby certify that the information above is true and complete to the best of my knowledge and belief.

Signed [Signature] Title Proration Clerk Date Feb. 22, 1971

(This space for State Use)

APPROVED BY [Signature] TITLE SUPERVISOR DATE FEB 24 1971

CONDITIONS OF APPROVAL, IF ANY:

NEW MEXICO OIL CONSERVATION COMMISSION
WELL LOCATION AND ACREAGE DEDICATION PLAT

Form C-102
Supersedes C-128
Effective 1-1-65

All distances must be from the outer boundaries of the Section.

Operator SUN OIL COMPANY		Lease W. W. WEATHERLY		Well No. 5
Unit Letter B	Section 17	Township 21 SOUTH	Range 37 EAST	County LEA
Actual Footage Location of Well: 660 feet from the NORTH line and 1980 feet from the EAST line				
Ground Level Elev. 3484.8	Producing Formation Grayburg	Pool Penrose Shelly Grayburg	Dedicated Acreage: 40 Acres	

- Outline the acreage dedicated to the subject well by colored pencil or hachure marks on the plat below.
- If more than one lease is dedicated to the well, outline each and identify the ownership thereof (both as to working interest and royalty).
- If more than one lease of different ownership is dedicated to the well, have the interests of all owners been consolidated by communitization, unitization, force-pooling, etc?

☐ Yes ☐ No If answer is "yes," type of consolidation _____

If answer is "no," list the owners and tract descriptions which have actually been consolidated. (Use reverse side of this form if necessary.) _____

No allowable will be assigned to the well until all interests have been consolidated (by communitization, unitization, forced-pooling, or otherwise) or until a non-standard unit, eliminating such interests, has been approved by the Commission.

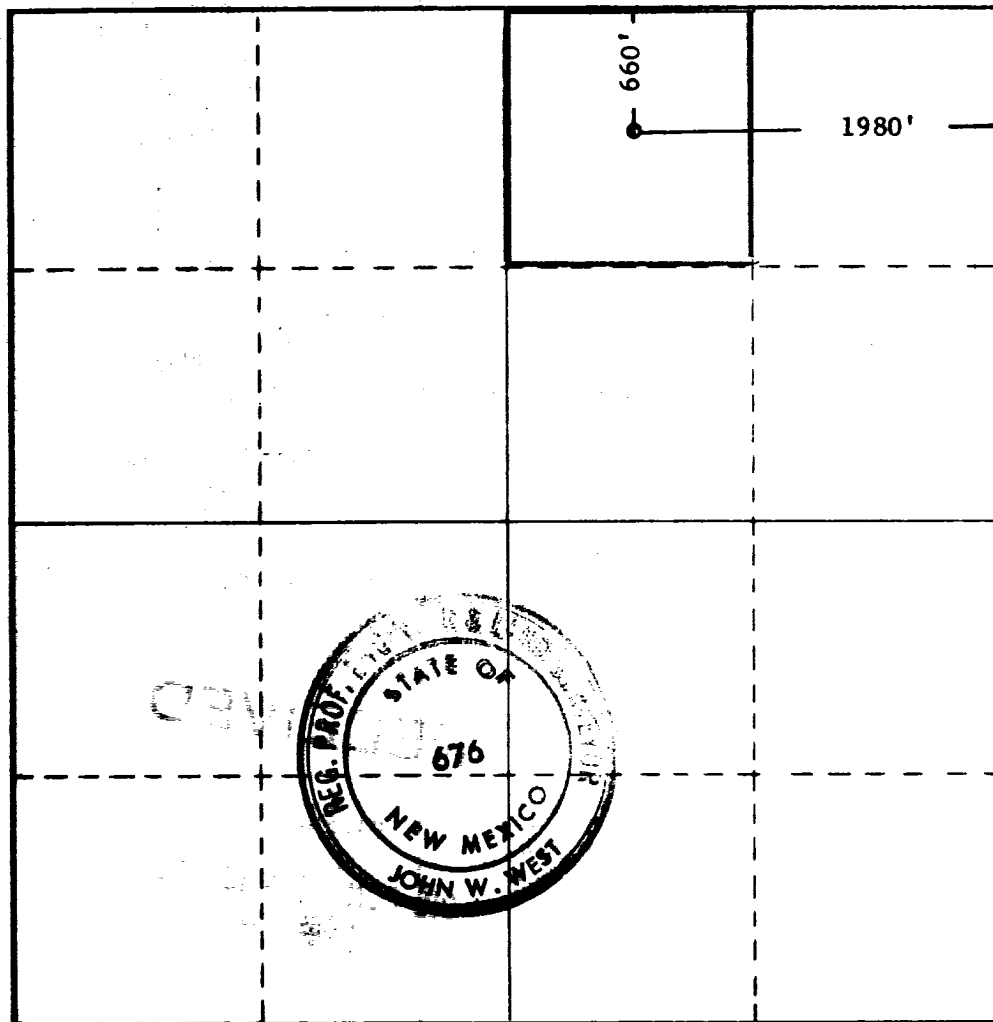

CERTIFICATION

I hereby certify that the information contained herein is true and complete to the best of my knowledge and belief.

Name **Paul Hughes R. M. Hughes**

Position **Production Clerk**

Company **Sun Oil Company**

Date **February 22, 1971**

I hereby certify that the well location shown on this plat was plotted from field notes of actual surveys made by me or under my supervision, and that the same is true and correct to the best of my knowledge and belief.

Date Surveyed
2-15-1971

Registered Professional Engineer
and/or Land Surveyor

John W. West
Certificate No.

676

COUNTY IFA FIELD Penrose Skelly STATE NM 30-025-23717
 MAP

OPR SON OIL CO.
 5 Weatherly, W. W.

Sec 17, T-21-S, R-37-E CO-ORD

660' FNL, 1980' FEL of Sec

Spd 3-4-71 CLASS EL 34972

Comp 3-23-71

FORMATION	DATUM	FORMATION	DATUM

LOGS & SX - TUBING
 8 5/8" at 1259' w/570 sx
 5 1/2" at 3875' w/480 sx.

LOGS EL GR RA IND HC A TD 3875'; PBD 3841'

1P (Grayburg) Perfs 3754-3800' P 381' PD + 185 BW. Pot based on 24 hr test. COR 750; Grav 38.9.

Distribution limited and publication prohibited by subscribers' agreement.
 Reproduction rights reserved by Williams & Lee Logging Service, Inc.

CONT. 3875' PROP. DEPTH 3900' TYPE R
 DATE

3-8-71 F.R. 3-2-71; Opr's Elev. 3485' GL, 3495' DF
 3-15-71 PD 3900' RT (Grayburg)
 3-22-71 Contractor - Jactus
 TD 1260'; WOC
 Drig. 3770' 1m & dolo
 ID 3875'; PBD 3841'; SI Frac
 Perf @ 3754', 3758', 3760', 3762', 3764',
 3766', 3768', 3770', 3781', 3792', 3794',
 3796', 3798', 3800' w/1 SPI
 Acid (3754-3800') 2000 gals (15%)
 Frac (3754-3800') 25,200 gals wtr + 43,000# sd
 3-29-71 TD 3875'; PBD 3841'; TO Pmp
 Ppd 231 EO + 132 BLW in 24 hrs (3754-3800')

TEA
LUB OIL CO.

Lenrose Skelly NM Sec 17, T21S, R37E
5 Weatherly, W. W. Page #2

4-5-71

TD 3875'; FBD 3841'; COMPLETE
LOG TOIS: Anhydrite 1250', Yates 2630',
Grayburg 3688'
COMPLETION REPORTED

4-8-71