

|                        |  |
|------------------------|--|
| NO. OF COPIES RECEIVED |  |
| DISTRIBUTION           |  |
| SANTA FE               |  |
| FILE                   |  |
| U.S.G.S.               |  |
| LAND OFFICE            |  |
| OPERATOR               |  |

# NEW MEXICO OIL CONSERVATION COMMISSION

Form C-101  
Revised 1-1-65

|  |  |
|--|--|
| 5A. Indicate Type of Lease                             |  |
| STATE <input type="checkbox"/>                         | FEE <input checked="" type="checkbox"/>          |
| 5. State Oil & Gas Lease No.                           |  |
| 7. Unit Agreement Name                                 |  |
| 8. Farm or Lease Name<br>Sandy                         |  |
| 9. Well No.<br>1                                       |  |
| 10. Field and Pool, or Wildcat<br>Arrowhead            |  |
| 12. County<br>Lea                                      |  |
| 19. Proposed Depth<br>3900                             | 19A. Formation<br>Grayburg                       |
| 20. Rotary or C.T.<br>Rotary                           |  |
| 21. Elevations (Show whether DE, RT, etc.)<br>3526' GL | 21A. Kind & Status Plug. Bond<br>Blanket on file |
| 21B. Drilling Contractor<br>Leatherwood Drlg. Co.      |  |
| 22. Approx. Date Work will start<br>11-19-71           |  |

## APPLICATION FOR PERMIT TO DRILL, DEEPEN, OR PLUG BACK

|  |  |
|--|--|
| 1a. Type of Work   |  |
| DRILL <input checked="" type="checkbox"/>  | DEEPEN <input type="checkbox"/> PLUG BACK <input type="checkbox"/> |
| b. Type of Well  |  |
| OIL WELL <input checked="" type="checkbox"/>   | GAS WELL <input type="checkbox"/> OTHER <input type="checkbox"/>   |
| 2. Name of Operator<br>Millard Deck  |  |
| 3. Address of Operator<br>P. O. Box 1047, Eunice, New Mexico 88231                                   |  |
| 4. Location of Well  |  |
| UNIT LETTER <u>I</u>   | LOCATED <u>2310</u> FEET FROM THE <u>South</u> LINE                |
| AND <u>800</u> FEET FROM THE <u>East</u> LINE OF SEC. <u>25</u> TWP. <u>21S</u> RGE. <u>36E</u> NMPM |  |
| 21. Elevations (Show whether DE, RT, etc.)<br>3526' GL   |  |
| 21A. Kind & Status Plug. Bond<br>Blanket on file   |  |
| 21B. Drilling Contractor<br>Leatherwood Drlg. Co.  |  |
| 22. Approx. Date Work will start<br>11-19-71   |  |

## PROPOSED CASING AND CEMENT PROGRAM

| SIZE OF HOLE | SIZE OF CASING | WEIGHT PER FOOT | SETTING DEPTH | SACKS OF CEMENT | EST. TOP   |
|--------------|----------------|-----------------|---------------|-----------------|------------|
| 12 1/2"      | 8-5/8"         | 24#             | 300'          | 250             | circulate  |
| 7-7/8"       | 5 1/2"         | 15.5#           | 3900'         | 350             | 2200' est. |

THE COMMISSION HAS REVIEWED

2071

65/8

2-21-72

IN ABOVE SPACE DESCRIBE PROPOSED PROGRAM: IF PROPOSAL IS TO DEEPEN OR PLUG BACK, GIVE DATA ON PRESENT PRODUCTIVE ZONE AND PROPOSED NEW PRODUCTIVE ZONE. GIVE BLOWOUT PREVENTER PROGRAM, IF ANY.

I hereby certify that the information above is true and complete to the best of my knowledge and belief.

Signed \_\_\_\_\_ Title Owner-Operator Date 11-15-71

(This space for State Use)

APPROVED BY

TITLE

SUPERVISOR DISTRICT I

DATE

NOV 22 1971

CONDITIONS OF APPROVAL, IF ANY:

RECEIVED

APR 10 1971

OIL CONSERVATION COMM.  
10268

NEW MEXICO OIL CONSERVATION COMMISSION  
WELL LOCATION AND ACREAGE DEDICATION PLAT

Form C-102  
Supersedes C-128  
Effective 1-1-65

All distances must be from the outer boundaries of the Section.

|   |  |                              |                                       |                      |
|---|--|------------------------------|---------------------------------------|----------------------|
| Operator<br><b>MILLARD DECK</b>   |  | Lease<br><b>SANDY</b>        |                                       | Well No.<br><b>1</b> |
| Unit Letter<br><b>I</b>   | Section<br><b>25</b>                   | Township<br><b>21 SOUTH</b>  | Range<br><b>36 EAST</b>               | County<br><b>LEA</b> |
| Actual Footage Location of Well:<br><b>800</b> feet from the <b>EAST</b> line and <b>2310</b> feet from the <b>SOUTH</b> line |  |                              |                                       |                      |
| Ground Level Elev.<br><b>3525.9</b>   | Producing Formation<br><b>GREYBURG</b> | Pool<br><b>Anteroverland</b> | Dedicated Acreage:<br><b>40</b> Acres |                      |

1. Outline the acreage dedicated to the subject well by colored pencil or hachure marks on the plat below.
2. If more than one lease is dedicated to the well, outline each and identify the ownership thereof (both as to working interest and royalty).
3. If more than one lease of different ownership is dedicated to the well, have the interests of all owners been consolidated by communitization, unitization, force-pooling, etc?

☐ Yes ☐ No If answer is "yes," type of consolidation \_\_\_\_\_

If answer is "no," list the owners and tract descriptions which have actually been consolidated. (Use reverse side of this form if necessary.) \_\_\_\_\_

No allowable will be assigned to the well until all interests have been consolidated (by communitization, unitization, forced-pooling, or otherwise) or until a non-standard unit, eliminating such interests, has been approved by the Commission.

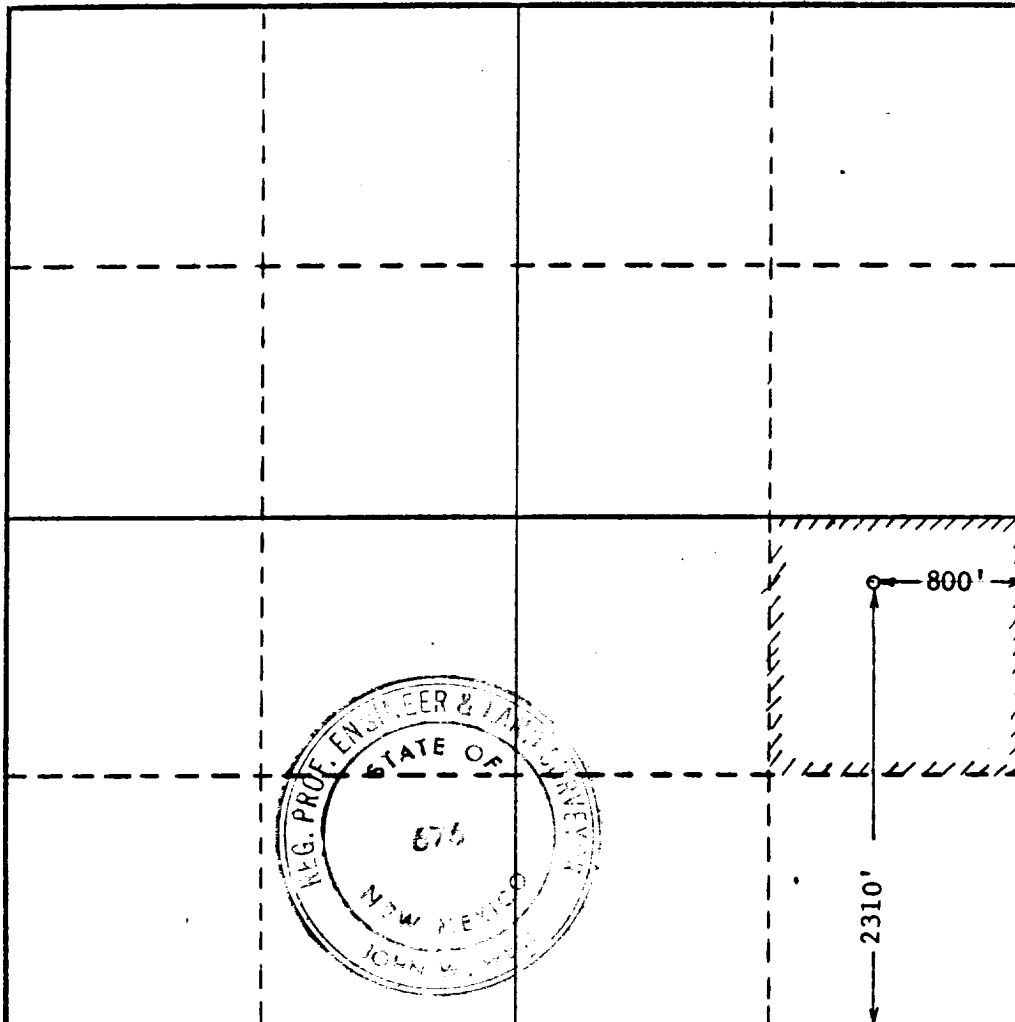

CERTIFICATION

I hereby certify that the information contained herein is true and complete to the best of my knowledge and belief.

Name

*Millard Deck*

Position

OPERATOR - OWNER

Company

MILLARD DECK

Date

NOVEMBER 16, 1971

I hereby certify that the well location shown on this plat was plotted from field notes of actual surveys made by me or under my supervision, and that the same is true and correct to the best of my knowledge and belief.

Date Surveyed

NOVEMBER 12, 1971

Registered Professional Engineer and/or Land Surveyor

*John W. West*

Certificate No.

676

0 330 660 990 1320 1650 1980 2310 2640 2970 3300 3630 3960 4290 4620 4950 5280 5610 5940 6270 6600 6930 7260 7590 7920 8250 8580 8910 9240 9570 9900

RECEIVED

JUN 1 1971

OIL CONSERVATION COMM.  
HOBBS, N. M.

Operator Chevron USA Inc.

36

[illegible]

Pool \_\_\_\_\_ Operator \_\_\_\_\_

Lease \_\_\_\_\_ Well No. \_\_\_\_\_ Unit \_\_\_\_\_ S \_\_\_\_\_ T \_\_\_\_\_ R \_\_\_\_\_

[illegible]