

NO. OF COPIES RECEIVED
DISTRIBUTION
SANTA FE
FILE
U.S.G.S.
LAND OFFICE
OPERATOR

NEW MEXICO OIL CONSERVATION COMMISSION

Date 5-20-74
Permit No. 30 025 24953

16. Indicate type of permit
STATE ☒ FEE ☐

17. Indicate type of permit
St. Loc. No. K-4205-1

APPLICATION FOR PERMIT TO DRILL, DEEPEN, OR PLUG BACK

1a. Type of Work
b. Type of Well DRILL ☒ DEEPEN ☐ PLUG BACK ☐
c. Kind of Well OIL ☒ GAS ☐ OTHER ☐ SINGLE ☒ MULTIPLE ☐
1. Name of Operator TEXACO Inc. % DARRELL SMITH
2. Address of Operator P. O. BOX 3109, MIDLAND, TEXAS 79701
3. Location of Well ORIT LETTER C LOCATED 660' DIST FROM THE North LINE
4. Section 1880 DIST FROM THE West LINE OF SEC. 17 TWP. 21-S RGE. 35-E NEAR
18. County Lea
19. Proposed Depth 12,650'
19A. Formation Morrow
19B. Rotary or C.T. Rotary
20. Elevations (Show whether DE, RL, etc.) DF 3638'
21A. Kind & Status of Bond \$10,000 Blanket
21B. Drilling Contractor Unknown
22. Approx. Date Work will start At Once -

PROPOSED CASING AND CEMENT PROGRAM

SIZE OF HOLE	SIZE OF CASING	WEIGHT PER FOOT	SETTING DEPTH	SACKS OF CEMENT	EST. TOP
20	16	65#	450'	*675 (300% to circulate)	
13 3/4	10 3/4	45 1/2# 51#	5550'	**1700 (150% to tie back not required)	
9 5/8	7 5/8	29.7# 26.4#	10,900'	***1150 (150% to 5,000')	
6 1/2	4 1/2	33.7#	12'		
		13 1/2#	10,700 to TD****212		

CEMENT PROGRAM ATTACHED

FORMATION TOPS EXPECTED ATTACHED

APPROVAL VALID
FOR 90 DAYS UNLESS
DRILLING COMMENCED,

EXPIRES

8/18/74

IN ABOVE SPACE DESCRIBE PROPOSED PROGRAM: IF PROPOSAL IS TO DEEPEN OR PLUG BACK, GIVE DATA ON PRESENT PRODUCTIVE ZONE AND PROPOSED NEW PRODUCTIVE ZONE. GIVE BLEEDOUT PREVENTION PROGRAM, IF ANY.

I hereby certify that the information above is true and complete to the best of my knowledge and belief.

Signed Bethel L. Millard Title Civil Engineer Date 5/20/74

(This space for State Use)

APPROVED BY Leslie A. Clements TITLE OIL & GAS INSPECTOR DATE MAY 20 1974

CONDITIONS OF APPROVAL, IF ANY:

RECEIVED

MAY 25 1974

**OIL CONSERVATION COMM.
HOBBS, N. M.**

Cement Program

- * 475 Sx TLW w/1/4 lb/Sx. Flocele & 2% CaCl, Followed by 200 Sx. Class "C" w/2% CaCl, 300% to circulate (must circulate)
- ** 1500 Sx. TLW w/5 lb/Sx. Gilsonite & 1/4 lb/Sx. Flocele, Followed by 200 Sx. Class "C" Neat, 150% to tie back - not required.
- *** 950 Sx. TLW w/1/4 lb/Sx. Flocele, Followed by 200 Sx. Class "H" w/1% CFR-2 & 5 lb/Sx. salt, 150% to 5000'.
- **** Production liner: 212 Sx. Class "H", 6 % Halad-9 & 3 lb./Sx. salt. squeeze liner top if necessary. Precede cement with 50 Bbls. flush. exact volume to be determined from caliper. (Run thickening tests with rig water prior to cementing).

Formation Tops Expected

Yates	3795
Del. Mtn. Group	5510
Bone Spring	7622
Dean	10125
B. Strawn	11400
Morrow	11610
T. Morrow Clastics	11935
Total Depth	12650

RECEIVED.

MAY 20 1974

**OIL CONSERVATION COMM.
HOBBS, N. M.**

NEW MEXICO OIL CONSERVATION COMMISSION
WELL LOCATION AND ACREAGE DEDICATION PL.

Form O-102
Supersedes O-128
Effective 1-1-65

All distances must be from the outer boundaries of the Section.

Operator TEXACO Inc.			Lease State of New Mexico "DQ"		Well No. 1
Unit Letter C	Section 17	Township 21	Range 35	County Lea	
Actual Footage Location of Well: 660 feet from the North line and 1980 feet from the West line					
Ground Level Elev. 3638	Producing Formation Morrow		Pool Wilson Deep Gas		Dedicated Acreage: 320 Acres

1. Outline the acreage dedicated to the subject well by colored pencil or hachure marks on the plat below.
2. If more than one lease is dedicated to the well, outline each and identify the ownership thereof (both as to working interest and royalty).
3. If more than one lease of different ownership is dedicated to the well, have the interests of all owners been consolidated by communitization, unitization, force-pooling, etc?

☐ Yes ☐ No If answer is "yes," type of consolidation _____

If answer is "no," list the owners and tract descriptions which have actually been consolidated. (Use reverse side of this form if necessary.) _____

No allowable will be assigned to the well until all interests have been consolidated (by communitization, unitization, forced-pooling, or otherwise) or until a non-standard unit, eliminating such interests, has been approved by the Commission.

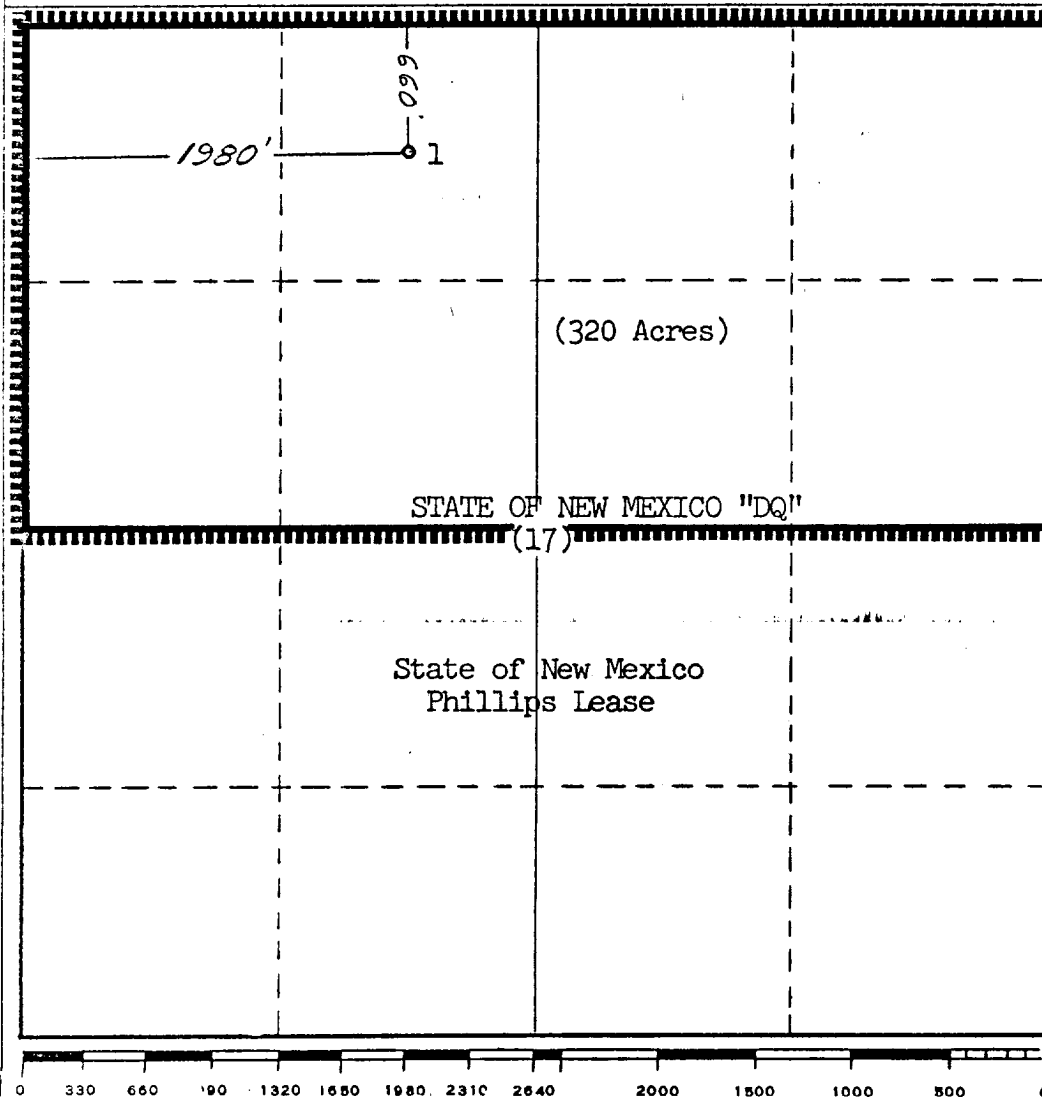

CERTIFICATION

I hereby certify that the information contained herein is true and complete to the best of my knowledge and belief.

Name
B. L. Eiland
Position
Registered Land Surveyor
Company
TEXACO Inc.
Date
4-29-74

I hereby certify that the well location shown on this plat was plotted from field notes of actual surveys made by me or under my supervision, and that the same is true and correct to the best of my knowledge and belief.

May 15, 1974

Date Surveyed
B. L. Eiland
Registered Professional Engineer
and/or Land Surveyor

4386

Certificate No.

413

REMOVED

MAY 1964
OIL CONSERVATION COMM.
HOBBS, N. M.