

NO. OF COPIES RECEIVED		
DISTRIBUTION		
SANTA FE		
FILE		
U.S.G.S.		
LAND OFFICE		
OPERATOR		

NEW MEXICO OIL CONSERVATION COMMISSION

Form C-101
Revised 1-1-65

5A. Indicate Type of Lease	
STATE <input type="checkbox"/>	FEE <input checked="" type="checkbox"/>

5. State Oil & Gas Lease No.

APPLICATION FOR PERMIT TO DRILL, DEEPEN, OR PLUG BACK

1a. Type of Work				7. Unit Agreement Name	
b. Type of Well DRILL <input checked="" type="checkbox"/> DEEPEN <input type="checkbox"/> PLUG BACK <input type="checkbox"/> OIL WELL <input checked="" type="checkbox"/> GAS WELL <input type="checkbox"/> OTHER <input type="checkbox"/> SINGLE ZONE <input checked="" type="checkbox"/> MULTIPLE ZONE <input type="checkbox"/>				8. Farm or Lease Name Taylor-Glenn	
2. Name of Operator Shell Oil Company				9. Well No. 12	
3. Address of Operator P. O. Box 1509, Midland, Texas 79701				10. Field and Pool, or Wildcat Drinkard	
4. Location of Well UNIT LETTER <u>H</u> LOCATED <u>1980</u> FEET FROM THE <u>North</u> LINE AND <u>535</u> FEET FROM THE <u>East</u> LINE OF SEC. <u>4</u> TWP. <u>21S</u> RGE. <u>37E</u> NMPM				12. County Lea	
19. Proposed Depth 6890'				19A. Formation Drinkard	
20. Rotary or C.T. Rotary				21. Elevations (Show whether DF, RT, etc.) 3474 GR	
21A. Kind & Status Plug. Bond Blanket				21B. Drilling Contractor Robinson Bros.	
22. Approx. Date Work will start 7-20-75					

23.

PROPOSED CASING AND CEMENT PROGRAM

SIZE OF HOLE	SIZE OF CASING	WEIGHT PER FOOT	SETTING DEPTH	SACKS OF CEMENT	EST. TOP
11"	8 5/8"	22.36#	1380'	400	Surface
7 7/8"	5 1/2"	15.5#	6890'	650	3300'

Blowout preventer program: 3000# WP. 3 single preventers

APPROVAL VALID
FOR 90 DAYS UNLESS
DRILLING COMMENCED,
EXPIRES Oct 3, 1975

IN ABOVE SPACE DESCRIBE PROPOSED PROGRAM: IF PROPOSAL IS TO DEEPEN OR PLUG BACK, GIVE DATA ON PRESENT PRODUCTIVE ZONE AND PROPOSED NEW PRODUCTIVE ZONE. GIVE BLOWOUT PREVENTER PROGRAM, IF ANY.

I hereby certify that the information above is true and complete to the best of my knowledge and belief.

Signed J. D. D'Agostino Title Senior Drilling Engineer Date 7-1-75

(This space for State Use)

APPROVED BY John W. Runyan TITLE DATE

CONDITIONS OF APPROVAL, IF ANY:

NEW MEXICO OIL CONSERVATION COMMISSION
WELL LOCATION AND ACREAGE DEDICATION PLAT

Form C-112
Supersedes C-128
Effective 1-1-55

All distances must be from the outer boundaries of the Section

Shell Oil Company			Lease Taylor Glenn		Well No. 12
Section H	Section 4	Township 21 South	Range 37 East	County Lea	
Acreage: 1980 feet from the North line and 535 feet from the East line					
Section Level Elev. 3474.0	Producing Formation Drinkard		Pool Drinkard	Dedicated Acreage: 40 Acres	

1. Outline the acreage dedicated to the subject well by colored pencil or hatchure marks on the plat below.
2. If more than one lease is dedicated to the well, outline each and identify the ownership thereof (both as to working interest and royalty).
3. If more than one lease of different ownership is dedicated to the well, have the interests of all owners been consolidated by communitization, unitization, force-pooling, etc?

☐ Yes ☐ No If answer is "yes" type of consolidation _____

If answer is "no," list the owners and tract descriptions which have actually been consolidated. (Use reverse side of this form if necessary.) _____

No allowable will be assigned to the well until all interests have been consolidated (by communitization, unitization, forced-pooling, or otherwise) or until a non-standard unit, eliminating such interests, has been approved by the Commission.

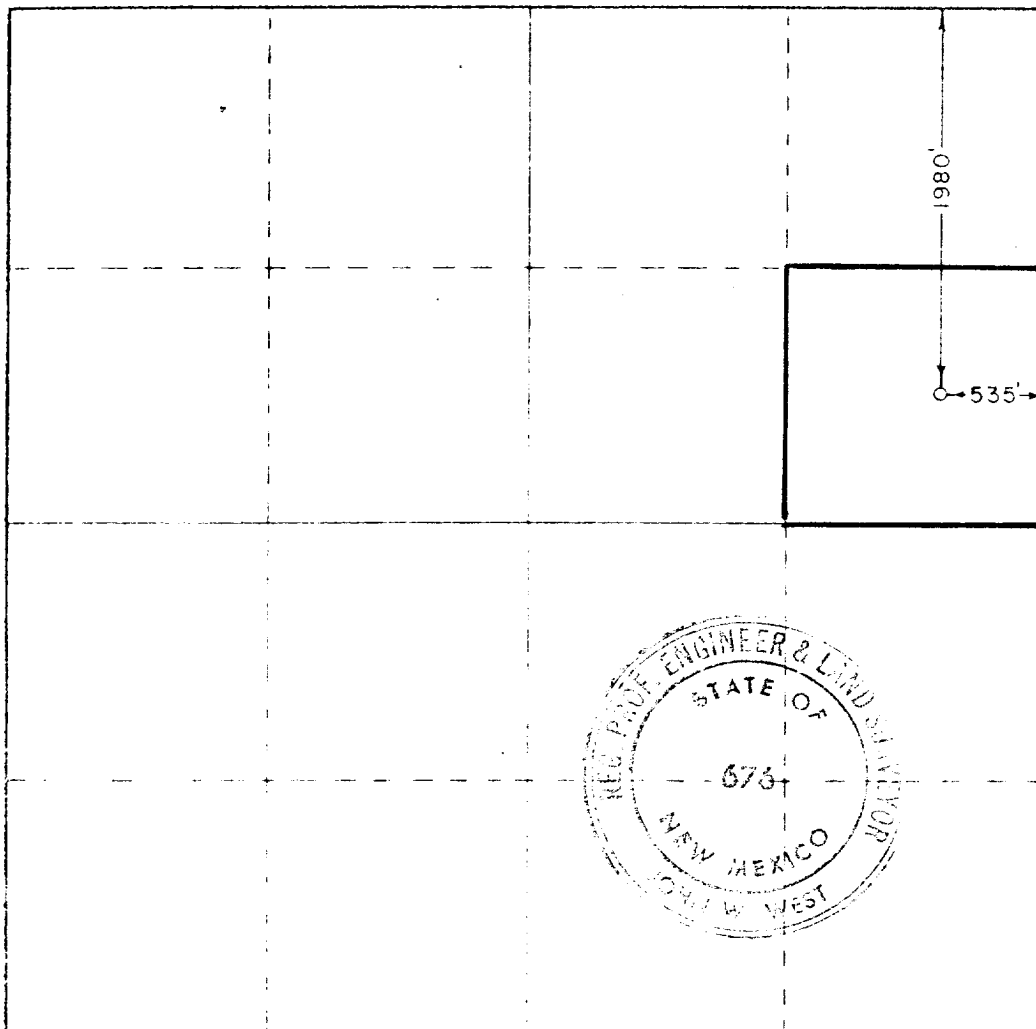

CERTIFICATION

I hereby certify that the information contained herein is true and complete to the best of my knowledge and belief.

J. D. D'Agostino
Name

J. D. D'Agostino

Position

Senior Drilling Engineer

Company

Shell Oil Company

Date

July 1, 1975

I hereby certify that the well location shown on this plat was plotted from field notes of actual surveys made by me or under my supervision, and that the same is true and correct to the best of my knowledge and belief.

Date Surveyed

January 23, 1975

Registered in least one of the following and a current surveyor

John W West
675