

NEW MEXICO OIL CONSERVATION COMMISSION
WELL LOCATION AND ACREAGE DEDICATION F

Form O-102
Supersedes O-128
Effective 1-1-65

All distances must be from the outer boundaries of the Section

Operator BELCO PETROLEUM CORP.		Lease Federal 12			Well No. 1
Tract Letter L	Section 12	Township 21 South	Range 32 East	County Lea	
Actual True True Location of Well:					
1980 feet from the south line and		660 feet from the west line			
Ground Level Elev. 3817.0	Producing Formation Morrow	Pool H&L Mesa Morrow	UNDERSIGNATURE	Dedicated Acreage: 320	Acres

1. Outline the acreage dedicated to the subject well by colored pencil or hachure marks on the plat below.
2. If more than one lease is dedicated to the well, outline each and identify the ownership thereof (both as to working interest and royalty).
3. If more than one lease of different ownership is dedicated to the well, have the interests of all owners been consolidated by communitization, unitization, force-pooling, etc?

Yes No If answer is "yes," type of consolidation _____

If answer is "no," list the owners and tract descriptions which have actually been consolidated (Use reverse side of this form if necessary.) _____

No allowable will be assigned to the well until all interests have been consolidated (by communitization, unitization, forced-pooling, or otherwise) or until a non-standard unit, eliminating such interests, has been approved by the Commission.

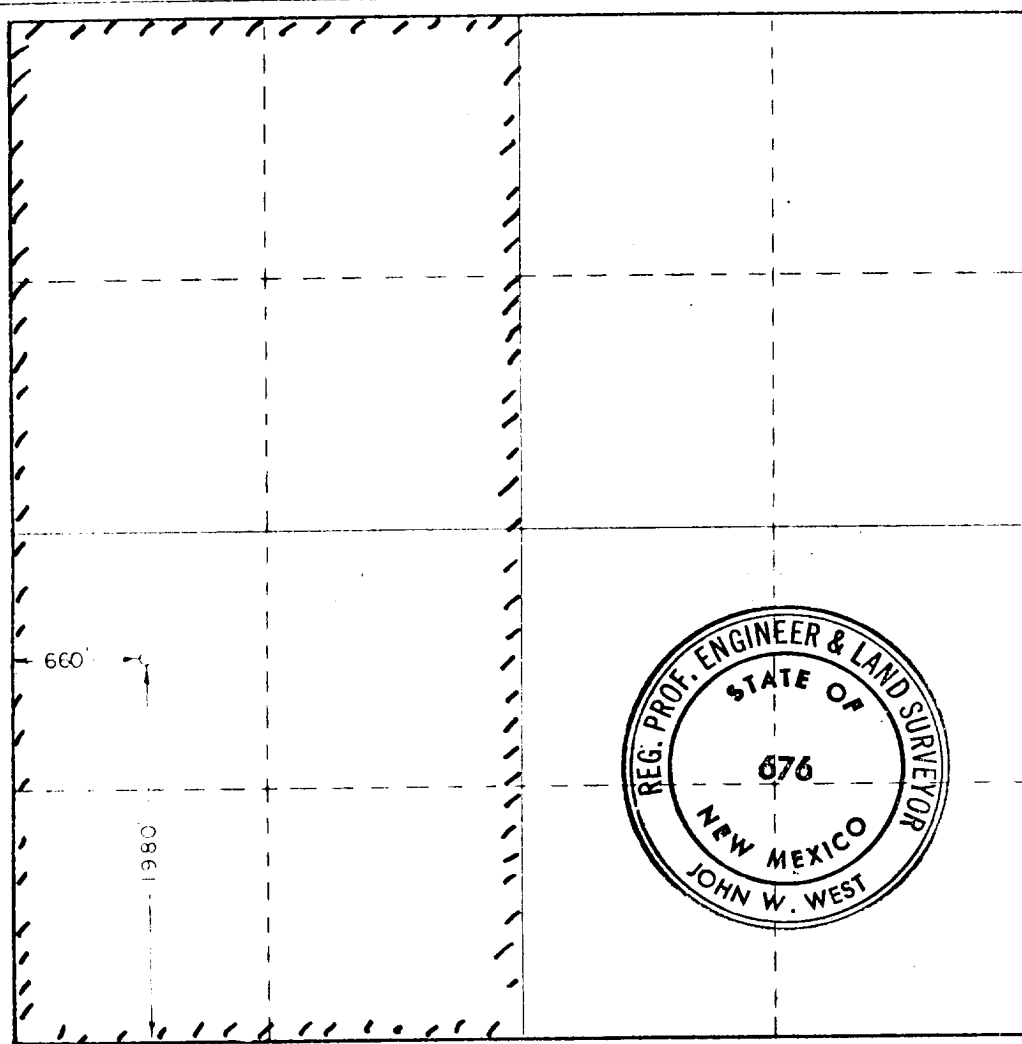

CERTIFICATION

I hereby certify that the information contained herein is true and complete to the best of my knowledge and belief.

Name: *Lee G. Vering*
 Position: *Administrative Geologist*
 Company: *Belco Petroleum Corp*
 Date: *9-27-76*

I hereby certify that the well location shown on this plat was plotted from field notes of actual surveys made by me or under my supervision, and that the same is true and correct to the best of my knowledge and belief.

Date Surveyed: *Sept. 15, 1976*
 Registered Professional Engineer and/or Land Surveyor
John W. West
 Certificate No. **676**

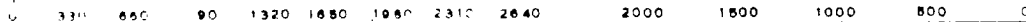

RECEIVED

APR 10 1970
U.S. DEPARTMENT OF JUSTICE
FEDERAL BUREAU OF INVESTIGATION