

NO. OF COPIES RECEIVED		
DISTRIBUTION		
SANTA FE		
FILE		
U.S.G.S.		
LAND OFFICE		
OPERATOR		

NEW MEXICO OIL CONSERVATION COMMISSION

Form C-101
Revised 1-1-65

5A. Indicate Type of Lease

STATE ☐

FEE ☒

5. State Oil & Gas Lease No.

APPLICATION FOR PERMIT TO DRILL, DEEPEN, OR PLUG BACK

1a. Type of Work

DRILL ☒

DEEPEN ☐

PLUG BACK ☐

b. Type of Well

OIL WELL ☒

GAS WELL ☐

OTHER

SINGLE ZONE ☐

MULTIPLE ZONE ☐

2. Name of Operator

Gulf Oil Corporation

3. Address of Operator

Box 670 Hobbs, NM 88240

4. Location of Well

UNIT LETTER 0

LOCATED 660

FEET FROM THE south LINE

AND 1650

FEET FROM THE East

LINE OF SEC. 24

TWP. 21-S

RGE. 36-E

NMPM

7. Unit Agreement Name

8. Farm or Lease Name

H.T. Mattern(NCT-A)

9. Well No.

4

10. Field and Pool, or Village

Drinkard

12. County

Lea

19. Proposed Depth

6800'

19A. Formation

Drinkard

20. Rotary or C.T.

Rotary

21. Elevations (show whether DF, RT, etc.)

3510' GL

21A. Kind & Status Plug. Bond

Blanket

21B. Drilling Contractor

22. Approx. Date Work will start

9-26-77

23.

PROPOSED CASING AND CEMENT PROGRAM

SIZE OF HOLE	SIZE OF CASING	WEIGHT PER FOOT	SETTING DEPTH	SACKS OF CEMENT	EST. TOP
12 1/4"	8 5/8"	24#	1300'	Circulate	
7 7/8"	5 1/2"	15.50#	6800' *	Circulate	

* Will set DV tool at approximately 2800' and circulate cement.

BOP: See drawing No. 3 attached.

IN ABOVE SPACE DESCRIBE PROPOSED PROGRAM: IF PROPOSAL IS TO DEEPEN OR PLUG BACK, GIVE DATA ON PRESENT PRODUCTIVE ZONE AND PROPOSED NEW PRODUCTIVE ZONE. GIVE BLOWOUT PREVENTER PROGRAM, IF ANY.

I hereby certify that the information above is true and complete to the best of my knowledge and belief.

Signed L. F. Berlin Title Assistant Area Production Manager

Date 9-13-77

(This space for State Use)

APPROVED BY [Signature]

TITLE Assistant Area Production Manager

DATE 9-13-77

CONDITIONS OF APPROVAL, IF ANY:

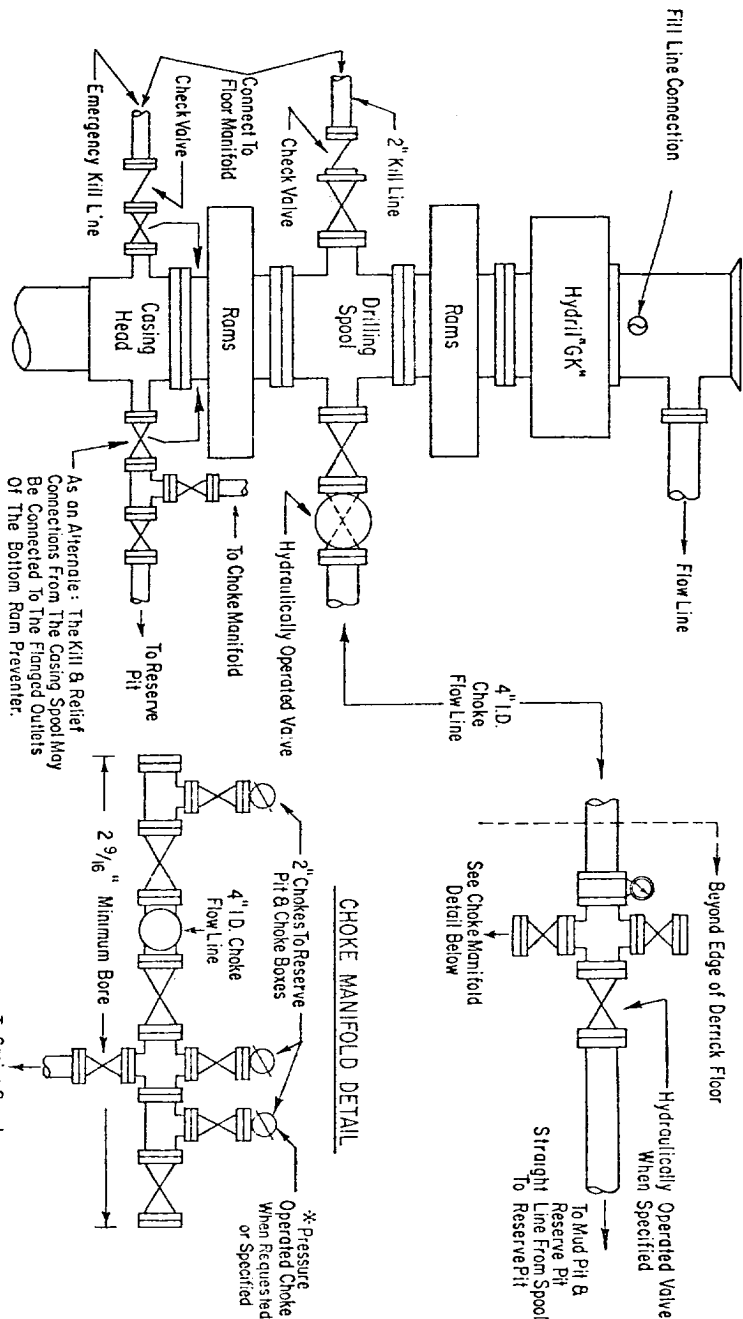

3000 PSI WORKING PRESSURE BLOWOUT PREVENTER HOOK-UP

The blowout preventer assembly shall consist of one blind ram preventer and one pipe ram preventer, both hydraulically operated; a Hydril "GK" preventer; valves; chokes and connections as illustrated. If a tapered drill string is used, a ram preventer must be provided for each size of drill pipe. Casing and tubing rams to fit the preventers are also be available as needed. If correct in size, the flanged outlets of the ram preventer may be used for connecting to the 4-inch I.D. choke flow line and kill line, except when air or gas drilling. The substructure height shall be sufficient to install a rotating blowout preventer.

Minimum operating equipment for the preventers and hydraulically operated valves shall be as follows: (1) Multiple pumps, driven by a continuous source of power, capable of fluid charging the total accumulator volume from the nitrogen precharge pressure to its rated pressure within _____ minutes. Also, the pumps are to be connected to the hydraulic operating system which is to be a closed system. (2) Accumulators, with a precharge of nitrogen of not less than 750 PSI and connected so as to receive the aforementioned fluid charge. With the charging pumps shut down, the pressurized fluid volume stored in the accumulators must be sufficient to close all the pressure-operated devices simultaneously within _____ percent of the original. (3) When requested, an additional source of power, remote and equivalent, is to be available to operate the above pumps; or there shall be additional pumps operated by separate power and equal in performance capabilities.

The closing manifold and remote closing manifold shall have a separate control for each pressure-operated device. Controls are to be labeled, with control handles indicating open and closed positions. A pressure reducer and regulator must be provided for operating the Hydril preventer. When requested, a second pressure reducer shall be available to limit operating fluid pressures to ram preventers. Gulf Legion No. 38 hydraulic oil, or equivalent or better, is to be used as the fluid to operate the hydraulic equipment.

The choke manifold, choke flow line, and choke lines are to be supported by metal stands and adequately anchored. The choke flow line and choke lines shall be constructed as straight as possible and without sharp bends. Easy and safe access is to be maintained to the choke manifold. All valves are to be selected for operation in the presence of oil, gas, and drilling fluids. The choke flow line valves connected to the drilling spool and all ram type preventers must be equipped with stem extensions, universal joints if needed, and hand wheels which are to extend beyond the edge of the derrick substructure. All other valves are to be equipped with handles.

* To include derrick floor mounted controls.

ADDITIONS - DELETIONS - CHANGES
SPECIFY

NEW MEXICO OIL CONSERVATION COMMISSION
WELL LOCATION AND ACREAGE DEDICATION PLAT

Form C-102
Supersedes C-128
Effective 1-1-55

All distances must be from the outer boundaries of the Section

Operator Gulf Oil Corporation			Lease H. T. Mattern N. C. T. - A		Well No. 4
Section Letter O	Section 24	Township 21 South	Range 36 East	County Lea	
Actual Footage Location of Well:					
660	feet from the South	line and	1650	feet from the East	Line
Ground Level Elev. 3509.8	Producing Formation Drinkard		Pool Drinkard	Dedicated Acreage 40	Acreage

- Outline the acreage dedicated to the subject well by colored pencil or hatchure marks on the plat below.
- If more than one lease is dedicated to the well, outline each and identify the ownership thereof (both as to working interest and royalty).
- If more than one lease of different ownership is dedicated to the well, have the interests of all owners been consolidated by communitization, unitization, force-pooling, etc?

☐ Yes ☐ No If answer is "yes," type of consolidation _____

If answer is "no," list the owners and tract descriptions which have actually been consolidated. (Use reverse side of this form if necessary.) _____

No allowable will be assigned to the well until all interests have been consolidated (by communitization, unitization, forced-pooling, or otherwise) or until a non-standard unit, eliminating such interests, has been approved by the Commission.

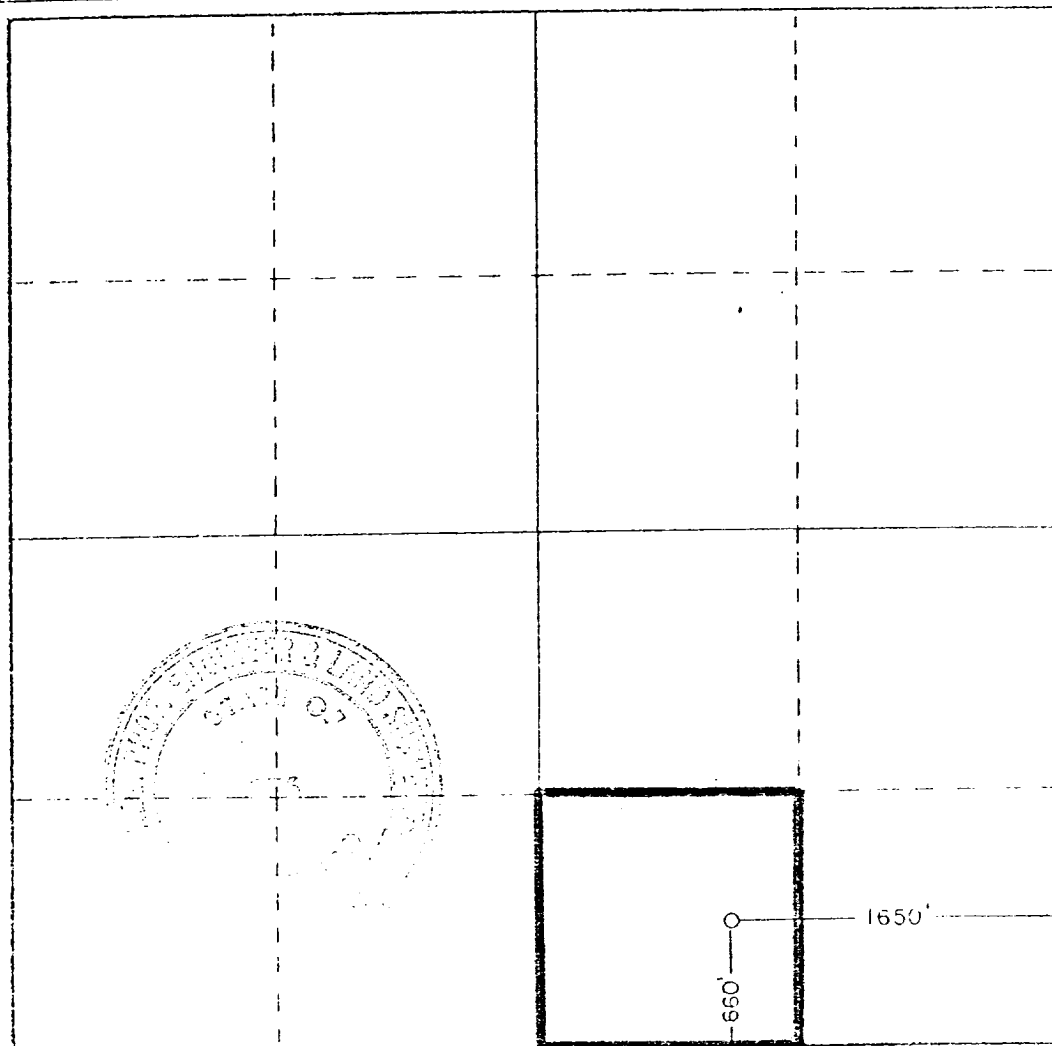

CERTIFICATION

I hereby certify that the information contained herein is true and complete to the best of my knowledge and belief.

C. D. Borland

Name
C. D. Borland

Position
Area Production Manager

Company
Gulf Oil Corporation

Date
March 15, 1977

I hereby certify that the well location shown on this plat was plotted from field notes of actual surveys made by me or under my supervision, and that the same is true and correct to the best of my knowledge and belief.

Date Surveyed
March 11, 1977

Registered Professional Engineer
and Licensed Surveyor

C. J. W. Diet

676