

NEW MEXICO OIL CONSERVATION COMMISSION  
WELL LOCATION AND ACREAGE DEDICATION PLAT

Form 17-112  
Supersedes 6-112  
Effective 1-1-55

All distances must be from the outer boundaries of the Section

Amoco Production Company			State C Tract 11		6
R	2	21 South	36 East	Lea	
2110	South	1650	East		
2510.8	QUEEN	EUMONT QUEEN	320		

On the acreage dedicated to the subject well by colored pencil or hatchure marks on the plat below.

- If more than one lease is dedicated to the well, outline each and identify the ownership thereof (both as to working interest and royalty)
- If more than one lease of different ownership is dedicated to the well, have the interests of all owners been consolidated by communitization, unitization, force-pooling, etc?

☐ Yes ☐ No If answer is "yes," type of consolidation \_\_\_\_\_

If answer is "no" list the owners and tract descriptions which have actually been consolidated. (Use reverse side of this form if necessary) \_\_\_\_\_

No acreage will be assigned to the well until all interests have been consolidated (by communitization, unitization, forced-pooling, or otherwise) or until a non-standard unit, eliminating such interests, has been approved by the Commission.

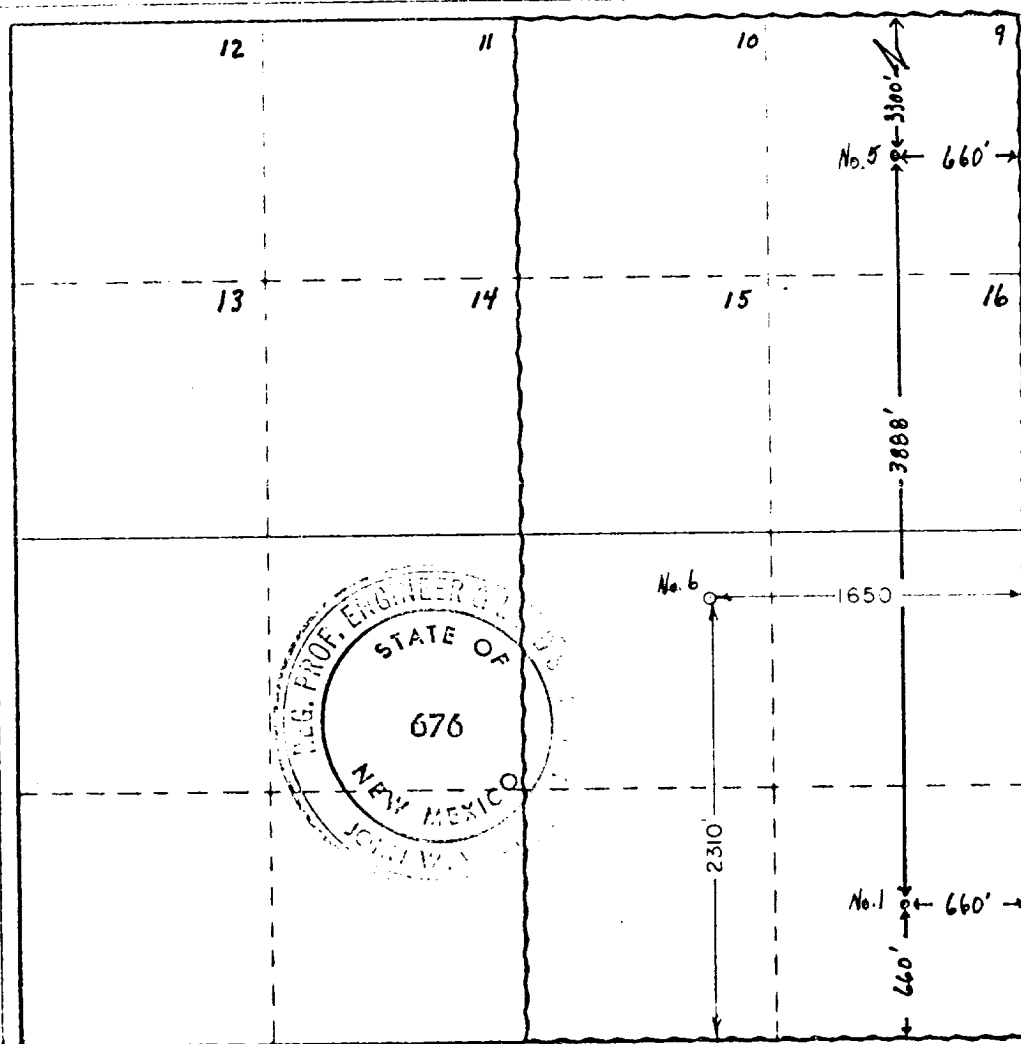

CERTIFICATION

I hereby certify that the information contained herein is true and complete to the best of my knowledge and belief.

Name Ray W. Cox  
Position Administrative Assistant

Company AMOCO PRODUCTION COMPANY

Date 10-27-77

I hereby certify that the well location shown on this plat was plotted from field notes of actual surveys made by me or under my supervision, and that the same is true and correct to the best of my knowledge and belief.

Date Surveyed October 21, 1977

Registered Professional Engineer and/or Land Surveyor

John W. West  
Certificate No. 676

330 660 990 1320 1650 1980 2310 2640 2000 1800 1600 1400 1200 1000 800 600 400 200 0

115

RECEIVED

1 OCT 1 1977

OIL CONSERVATION COMM.  
HOBBS, N. M.