

District I
PO Box 1980, Hobbs, NM 88241 1980
District II
PO Drawer DD, Artesia, NM 88211-0719
District III
1000 Rio Brazos Rd., Aztec, NM 87410
District IV
PO Box 2088, Santa Fe, NM 87504-2088

State of New Mexico
Energy, Minerals & Natural Resources Department

OIL CONSERVATION DIVISION
PO Box 2088
Santa Fe, NM 87504-2088

C-103
Form 8-101
Revised February 10, 1994
Instructions on back
Submit to Appropriate District Office
State Lease - 6 Copies
Fee Lease - 5 Copies

☐ AMENDED REPORT

APPLICATION FOR PERMIT TO DRILL, RE-ENTER, DEEPEN, PLUGBACK, OR ADD A ZONE

Operator Name and Address. Conoco Inc 10 Desta Dr. Ste. 100W Midland, Tx. 79705-4500		OGRID No_ 005073
		API Number 30 - 025-26004
Property Code 3105	Property Name State F-1	Well No. #7

Surface Location

UL or lot no.	Section	Township	Range	Lot Idn	Feet from the	North/South line	Feet from the	East/West line	County
M	1	21S	36E		3300	South	660	West	Lea

s Proposed Bottom Hole Location If Different From Surface

UL or lot no.	Section	Township	Range	Lot Idn	Feet from the	North/South line	Feet from the	East/West line	County
Proposed Pool 1 v Yates Eumont/Seven Rivers/Queen (076480)					Proposed Pool 2				

Work Type Code 16 Multiple	Well Type Code G 17 Proposed Depth	Cable/Rotary 18 Formation	Lease type Code S 19 Contractor	14 Ground Level Elevation 20 Spud Date
-------------------------------	--	------------------------------	---------------------------------------	---

21 Proposed Casing and Cement Program

Hole Size	Casing Size	Casing weight/foot	Setting Depth	Sacks of Cement	Estimated TOC
Same as original					

Describe the proposed program. If this application is to DEEPEN or PLUG BACK give the data on the present productive zone and proposed new productive zone. Describe the blowout prevention program, if any. Use additional sheets if necessary.

The well is currently TA'd with CIBP set at 3470' Conoco proposes to add perforations in the Eumont in this well using the following procedure:

- RIH w/tbg and tag PBTD 3470', spot acid, POH
- Perf Eumont from 2742-3313'
- Frac Eumont with CO2 foam & Proppant
- Blow down well
- RIH w/Prod Tbg, Hang off, Put on line.

Permit Expires 1 Year from Approval
Date on end Drilling License

23 I hereby certify that the information given above is true and complete to the best of my knowledge and belief. Signature: <i>Kay Maddox</i>		OIL CONSERVATION DIVISION	
Printed name: Kay Maddox		Approved by: <i>[Signature]</i>	
Title: Regulatory Agent		Title: <i>[Signature]</i>	
Date: August 7, 2001	Phone: (915) 686-5798	Approval Date: <i>[Signature]</i>	Expiration Date:
		Conditions of Approval: Attached	

S
C
A

NEW MEXICO OIL CONSERVATION COMMISSION
WELL LOCATION AND ACREAGE DEDICATION PLAT

Form C-102
Supersedes C-128
Effective 1-1-65

All distances must be from the outer boundaries of the Section.

Operator <u>CONTINENTAL OIL CO.</u>			Lease <u>STATE F-1</u>		Well No. <u>7</u>
Unit Letter <u>M</u>	Section <u>1</u>	Township <u>21E</u>	Range <u>36E</u>	County <u>LEA</u>	
Actual Footage Location of Well: <u>3300</u> feet from the <u>SOUTH</u> line and <u>660</u> feet from the <u>WEST</u> line					
Ground Level Elev. <u>3555.3</u>	Producing Formation <u>QUEEN</u>		Pool <u>EMMONT YATES 7 RURS. QN</u>	Dedicated Acreage: <u>160</u> Acres	

- Outline the acreage dedicated to the subject well by colored pencil or hachure marks on the plat below.
- If more than one lease is dedicated to the well, outline each and identify the ownership thereof (both as to working interest and royalty).
- If more than one lease of different ownership is dedicated to the well, have the interests of all owners been consolidated by communitization, unitization, force-pooling, etc?

☐ Yes ☐ No If answer is "yes," type of consolidation _____

If answer is "no," list the owners and tract descriptions which have actually been consolidated. (Use reverse side of this form if necessary.) _____

No allowable will be assigned to the well until all interests have been consolidated (by communitization, unitization, forced-pooling, or otherwise) or until a non-standard unit, eliminating such interests, has been approved by the Commission.

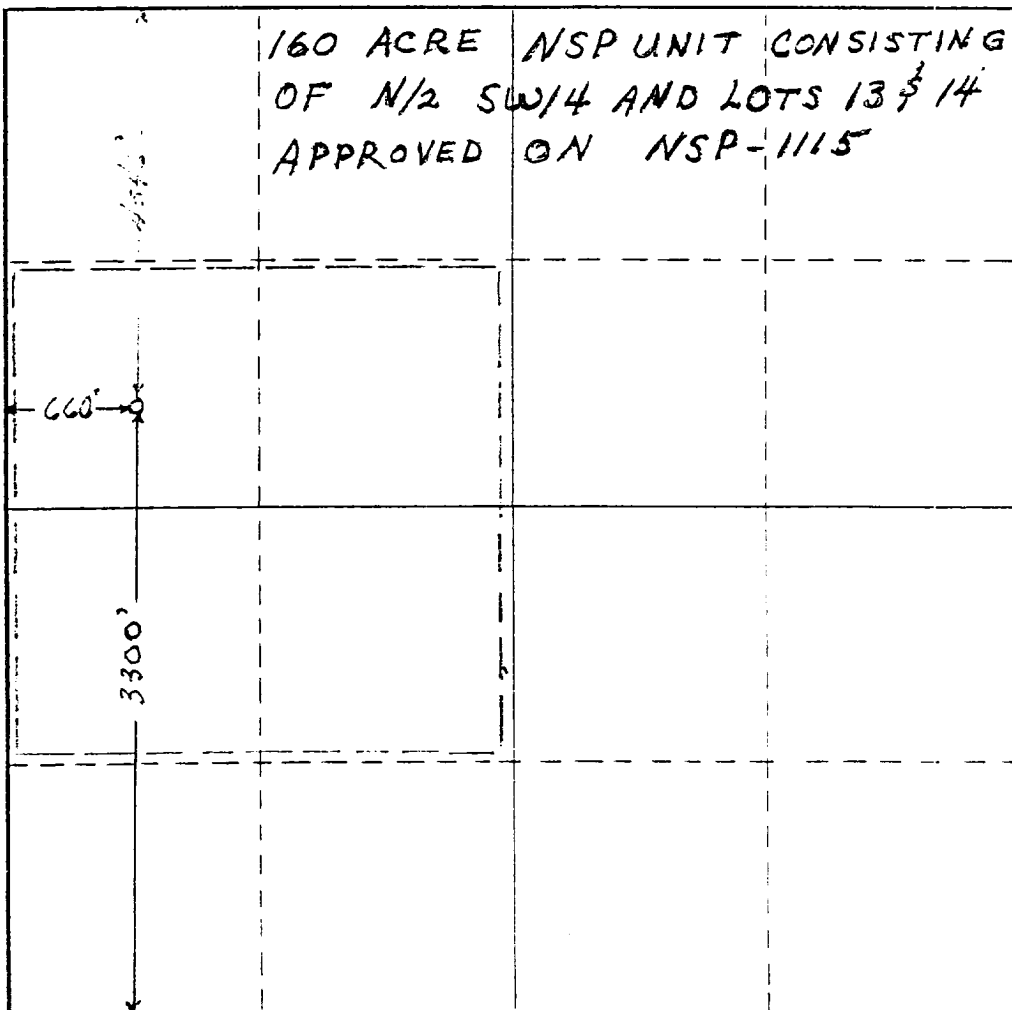

CERTIFICATION

I hereby certify that the information contained herein is true and complete to the best of my knowledge and belief.

Name
Ben R. Lee
Position
ADM. SUPR.
Company
CONTINENTAL OIL CO.
Date
11-14-78

I hereby certify that the well location shown on this plat was plotted from field notes of actual surveys made by me or under my supervision, and that the same is true and correct to the best of my knowledge and belief.

Date Surveyed _____

Registered Professional Engineer
and/or Land Surveyor

Certificate No. _____

0 330 660 990 1320 1650 1980 2310 2640 2000 1500 1000 500 0



STATE OF NEW MEXICO
ENERGY AND MINERALS DEPARTMENT
OIL CONSERVATION DIVISION

JERRY APODACA
GOVERNOR

NICK FRANKLIN
SECRETARY

November 6, 1978

Continental Oil Company
P. O. Box 460
Hobbs, New Mexico 88240

Div. Manager	
Asst. Div. Manager	
Div. Engr.	
Cons'v. Coord.	<i>[initials]</i>
Sup. Prod. Eng.	
Sup. Resv. Eng.	
Prod. Supt.	<i>[initials]</i>
Adm. Supv.	<i>[initials]</i>
Spec. Inv.	
Training Coord.	
Off. Mgr.	<i>[initials]</i>

[Handwritten: FEB 1979]

POST OFFICE BOX 2088
STATE LAND OFFICE BUILDING
SANTA FE, NEW MEXICO 87501
(505) 827-2434

Administrative Order NSP-1115

Gentlemen:

Reference is made to your application for approval of a 160-acre non-standard proration unit consisting of the following acreage in the Eumont Gas Pool:

LEA COUNTY, NEW MEXICO
TOWNSHIP 21 SOUTH, RANGE 36 EAST, NMPM
Section 1: N/2 SW/4 and Lots 13 and 14

It is my understanding that this unit is to be dedicated to your State F-1 Well No. 7 located 3300 feet from the South line and 660 feet from the West line of said Section 1.

By authority granted me under the provisions of Rule 5(c)3 of Order No. R-1670, you are hereby authorized to operate the above-described acreage as a non-standard unit.

Very truly yours,

[Signature of Joe D. Ramey]
JOE D. RAMEY,
Director

JDR/RLS/dr

cc: Oil Conservation Division - Hobbs
Oil & Gas Engineering Committee - Hobbs
Central Leasing - State Land Office - Santa Fe