

D-4-NMOCC-HOBES

1-FILE

1-PHILLIPS, MIDLAND

1-SABINE, MIDLAND

1-R.J. STARRAK

NEW MEXICO OIL CONSERVATION COMMISSION

1-A.B. CARY

WELL LOCATION AND ACREAGE DEDICATION PLAT

1-PJB, ENGR.

Form C-102

Replaces C-128

Effective 1-1-65

1-BH, FIELD CLK.

All distances must be from the outer boundaries of the Section.

Operator Getty Oil Company		Lease Getty 36 State Com.		Well No. 1
Unit Letter F	Section 36	Township 21S	Range 34E	County Lea
Actual Footage Location of Well: 1980 feet from the North line and 1650 feet from the West line				
Ground Level Elev. 3674.1	Producing Formation Wolfcamp		Pool Grama Ridge Wolfcamp	Dedicated Acreage: 160 Acres

1. Outline the acreage dedicated to the subject well by colored pencil or hachure marks on the plat below.
2. If more than one lease is dedicated to the well, outline each and identify the ownership thereof (both as to working interest and royalty).
3. If more than one lease of different ownership is dedicated to the well, have the interests of all owners been consolidated by communitization, unitization, force-pooling, etc?

☒ Yes ☐ No If answer is "yes," type of consolidation Communitization

If answer is "no," list the owners and tract descriptions which have actually been consolidated. (Use reverse side of this form if necessary.) _____

No allowable will be assigned to the well until all interests have been consolidated (by communitization, unitization, forced-pooling, or otherwise) or until a non-standard unit, eliminating such interests, has been approved by the Commission.

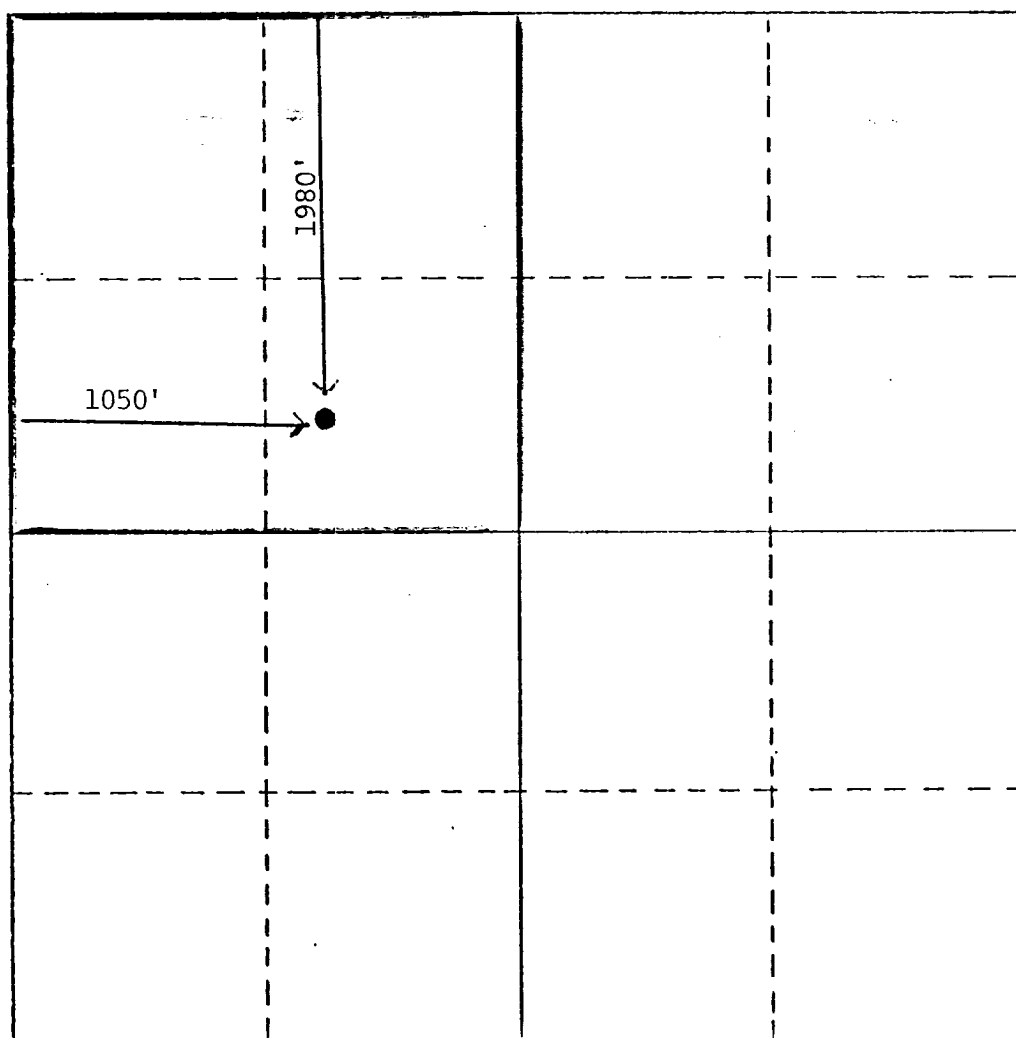

CERTIFICATION

I hereby certify that the information contained herein is true and complete to the best of my knowledge and belief.

Herman Terry
Name

Herman Terry

Position

Area Engineer

Company

Getty Oil Company

Date

September 5, 1979

I hereby certify that the well location shown on this plat was plotted from field notes of actual surveys made by me or under my supervision, and that the same is true and correct to the best of my knowledge and belief.

Date Surveyed

Registered Professional Engineer
and/or Land Surveyor